



**FOR LEASE**

High-Visibility Retail Space on Okeechobee Blvd

6000 Okeechobee Blvd | West Palm Beach, FL





# High-Visibility Retail Space on Okeechobee Blvd

6000 Okeechobee Blvd | West Palm Beach, FL 33417



2,517 SF

Available

Contact  
Broker

Rate

VIEW VIDEO



## ABOUT THE PROPERTY

- Retail space available in the second half of the ground floor building with fully built out professional offices.
- Located on Okeechobee Blvd, a key arterial road.
- Full access from western and eastern traffic.
- The surrounding area has experienced 6% population growth over the last 5 years, with continued expansion projected.
- Conveniently located near I-95 and access to Florida's Turnpike traffic light.

## NEARBY RETAILERS



## TRAFFIC COUNTS

Okeechobee Blvd

Florida's Turnpike

Year: 2024 | Source: FDOT

67,500 VPD

80,300 VPD



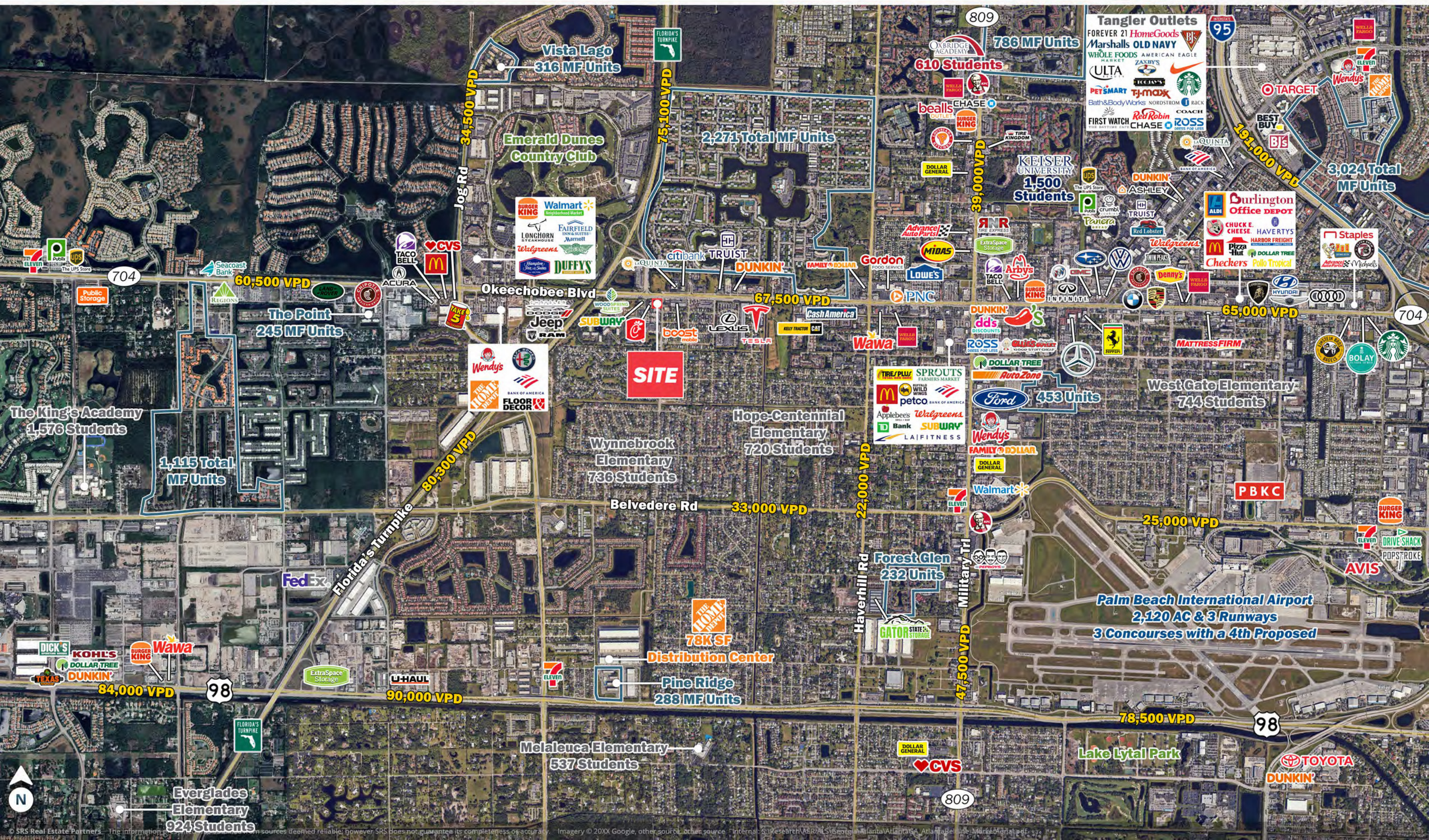



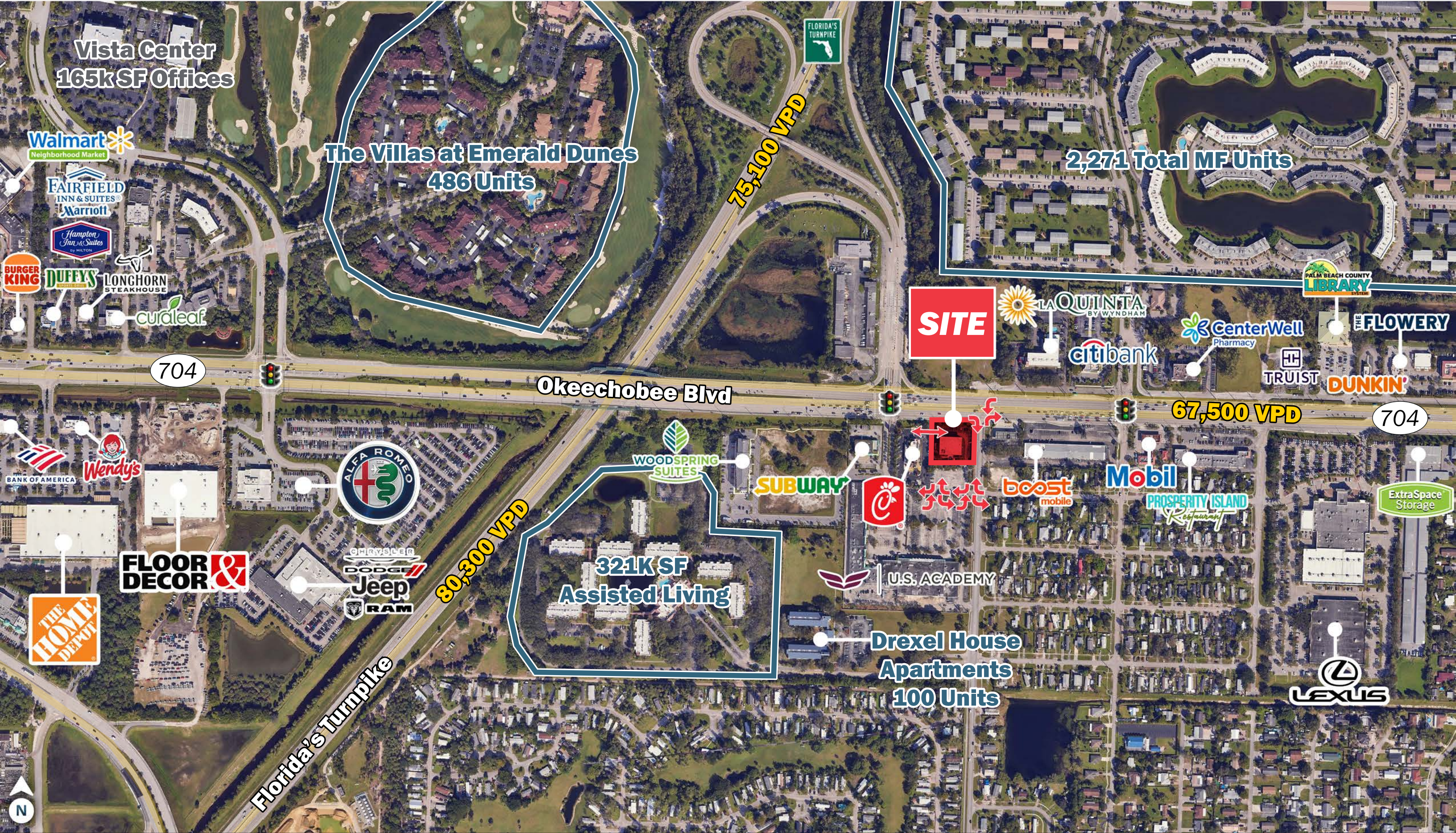





SUBWAY



SITE



boost  
mobile

College Plaza Shopping Center





# High-Visibility Retail Space on Okeechobee Blvd

6000 Okeechobee Blvd | West Palm Beach, FL 33417





# High-Visibility Retail Space on Okeechobee Blvd

6000 Okeechobee Blvd | West Palm Beach, FL 33417



FRONT  
DOOR

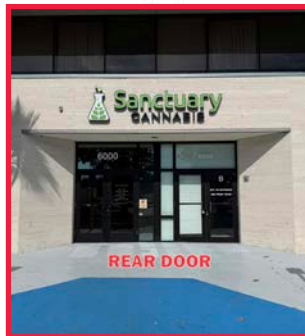

REAR DOOR

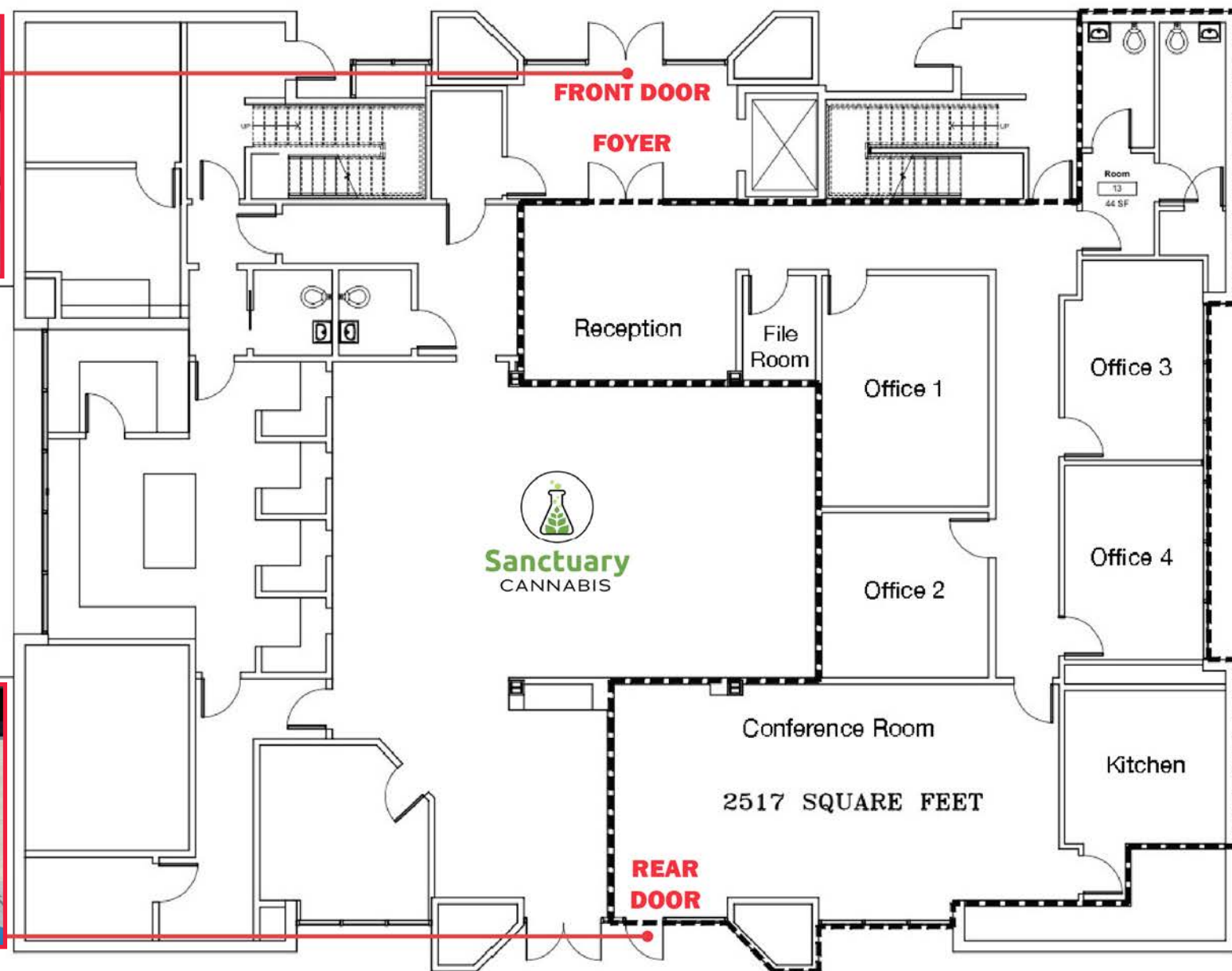

FRONT DOOR

FOYER

Reception

File  
Room

Office 1

Office 3

Office 4

Office 2

Conference Room

Kitchen

2517 SQUARE FEET

REAR  
DOOR



# High-Visibility Retail Space on Okeechobee Blvd

6000 Okeechobee Blvd | West Palm Beach, FL 33417





# High-Visibility Retail Space on Okeechobee Blvd

6000 Okeechobee Blvd | West Palm Beach, FL 33417



## DEMOGRAPHIC HIGHLIGHTS

### 1 MILE

16,242	18,329	\$64,933	7,742
Population	Total Daytime Population	Average Household Income	Total Households

### 3 MILES

99,894	92,506	\$80,022	40,373
Population	Total Daytime Population	Average Household Income	Total Households

### 5 MILES

249,789	240,066	\$86,003	96,713
Population	Total Daytime Population	Average Household Income	Total Households

> **Want more?** Contact us for a complete demographic, foot-traffic, and mobile data insights report.

SOURCE

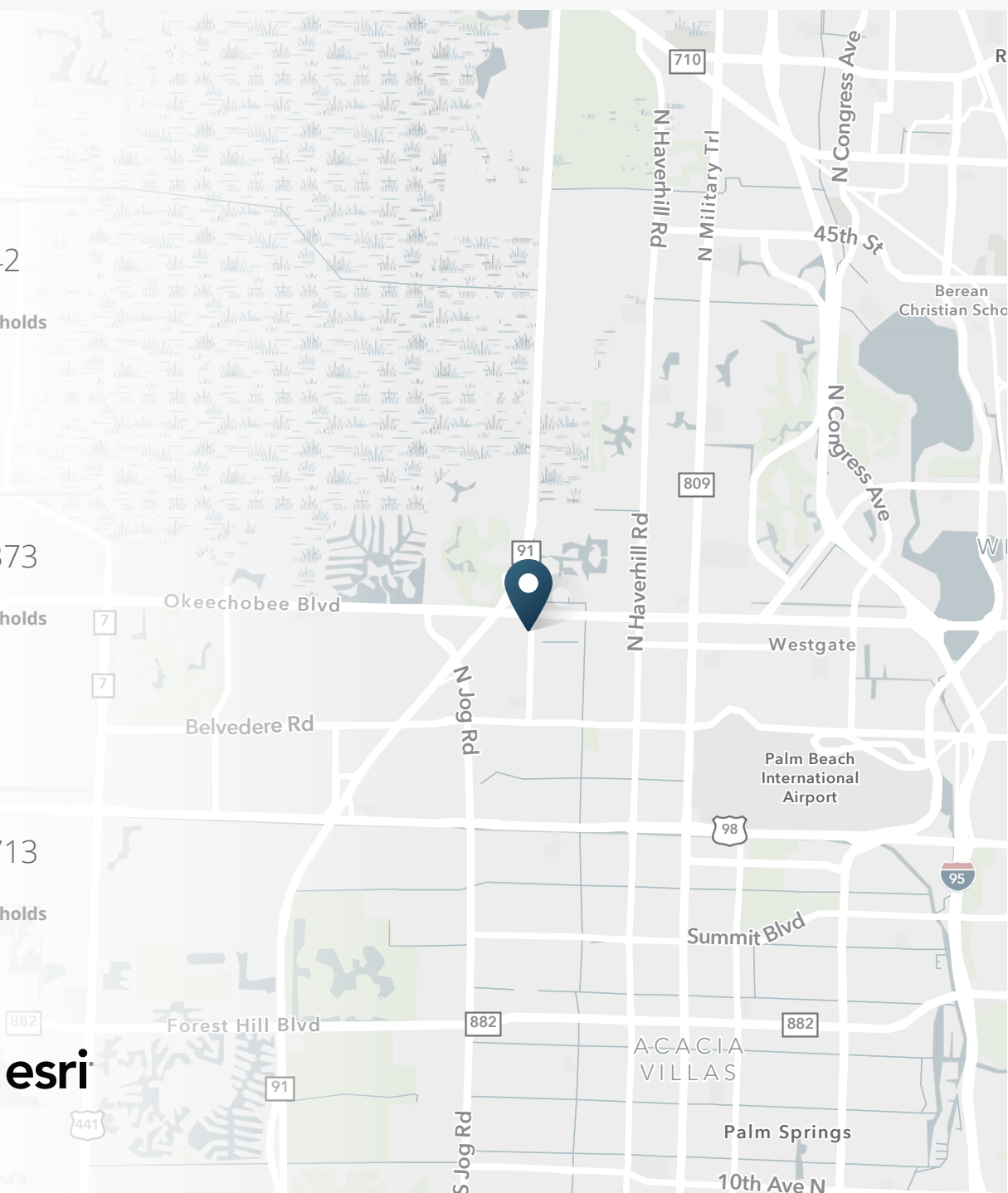





**SRS Real Estate Partners**  
200 SW 1st Avenue, Suite 970  
Fort Lauderdale, FL 33301  
954.703.3600

**Brandon Woulfe**  
954.703.3604  
brandon.woulfe@srsre.com

**Marie Michel**  
954.400.2746  
marie.michel@srsre.com

**SRSRE.COM**

©2024 SRS Real Estate Partners LLC. All Rights Reserved.

The information presented was obtained from sources deemed reliable;  
however SRS Real Estate Partners does not guarantee its completeness or accuracy.