

*For Lease*

**1434**

Crossways Boulevard

**Two Building | Class A Office Campus**  
With Interstate Frontage ±172,976 RSF Available





## Lease Rate

\$22.00 SF/yr (Full Service)



# 1434

## Crossways Boulevard

### Property Highlights

- Two building office campus available with interstate signage
- Two-story, Class A office buildings totaling 222,989 RSF
- Built in 1999 on 17.99 acre site
- Large flexible floor plans with great window lines
- Beautiful two-story atrium and updated common areas showcase contemporary finishes
- 1,357 available parking spaces
- Excellent access to I-64 and Greenbrier Parkway
- Close proximity to hotels, restaurants, banks, retail, and the mixed-use Dollar Tree Headquarters development at Summit Point

### Available Spaces

**Crossways I**      First Floor: 53,711 RSF  
Second Floor: 53,711 RSF  
**Total: 107,422 RSF** (entire wing)

**Crossways II**      First Floor: 49,057 RSF  
Second Floor: 11,291 RSF  
5,206 RSF  
**Total: 65,554 RSF**

# 1434

## Crossways Boulevard

### Asset Profile

**Address** 1434 Crossways Boulevard  
Chesapeake, VA 23320

**Total RSF** 222,989 RSF

**Site Size** 17.99 Acres

**Stories** Two (2)

**Year Built** 1999

**Zoning** M-2 (General Industrial)

**Parking** 6.09/1,000 SF (1,357 spaces)



High Parking Ratio & Flexible  
Layouts Suit Broad Tenant Base

# Crossways I & II Floor Plans

## First Floor

11,207 up to 102,768 RSF

**53,711 RSF**  
SUITE 100

**37,850 RSF**  
SUITE 150/175

**11,207 RSF**  
SUITE 175

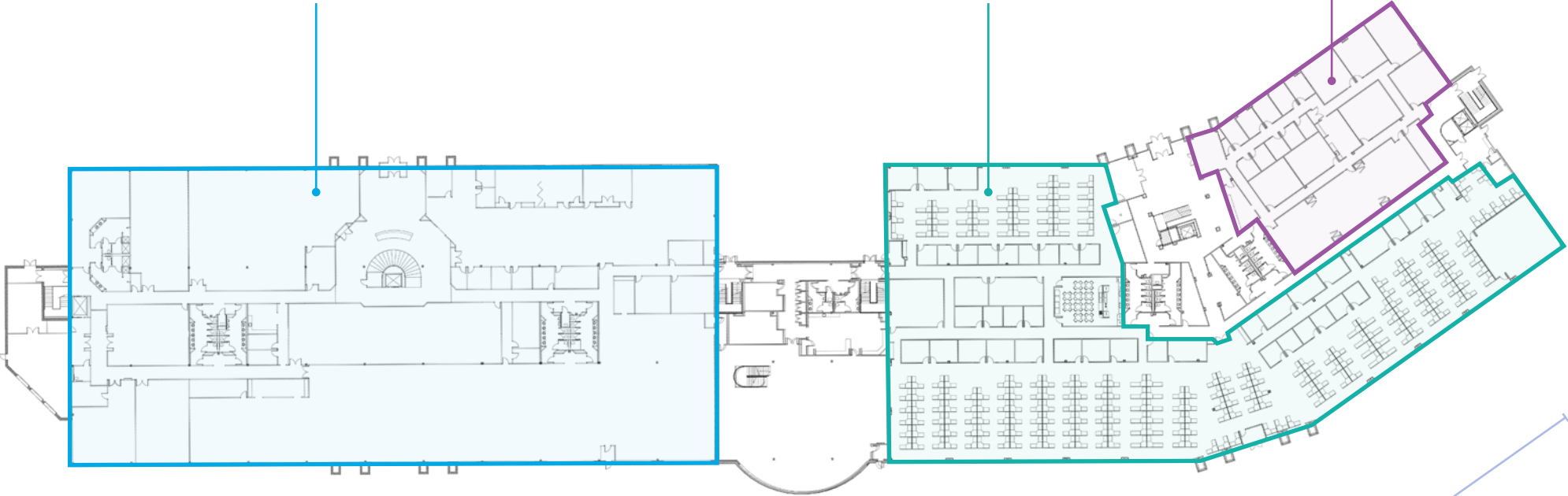

**Crossways I**  
AVAILABLE 2026

**Crossways II**  
AVAILABLE NOW

# Crossways I & II Floor Plans

## Second Floor

5,206 up to 70,208 RSF

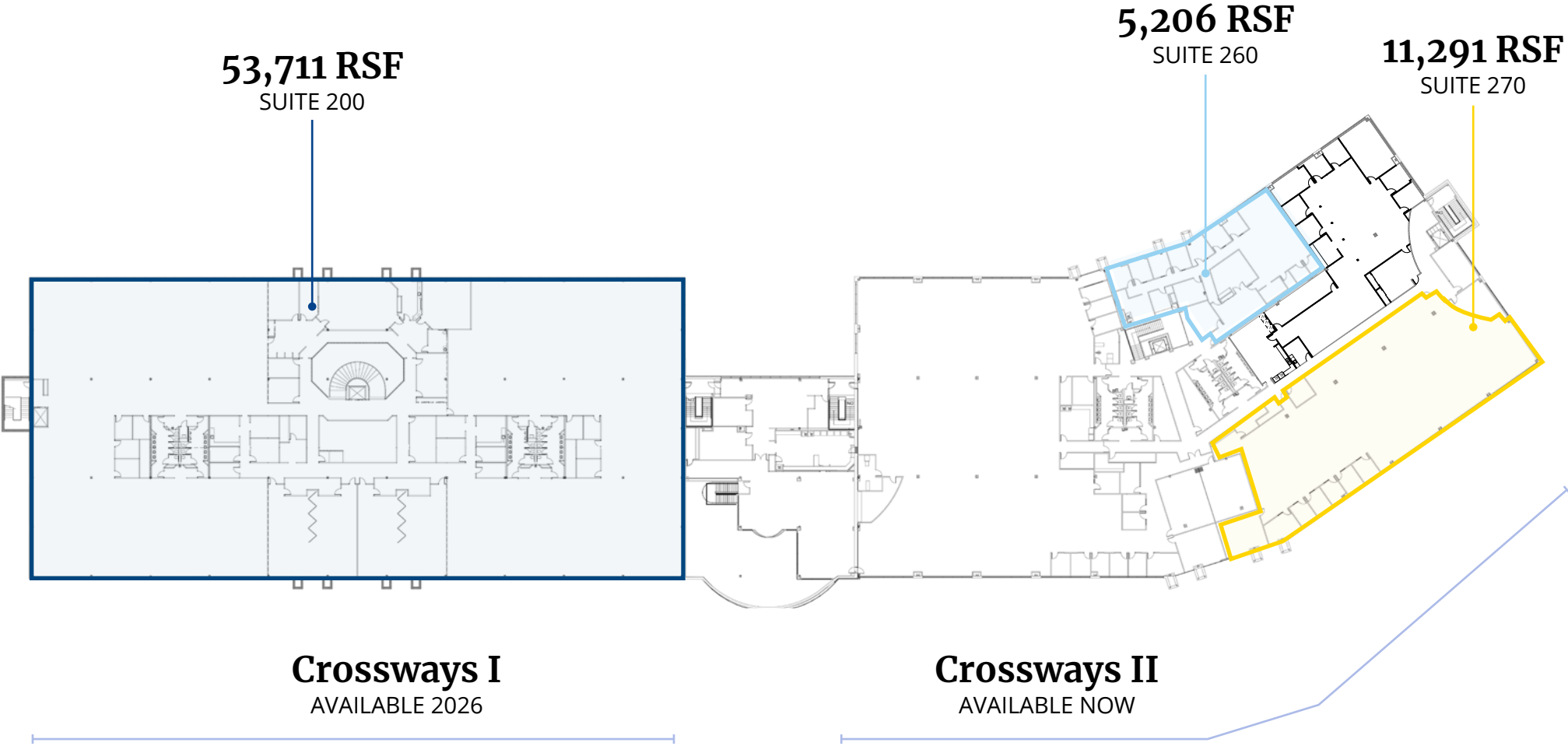

# Site Plan

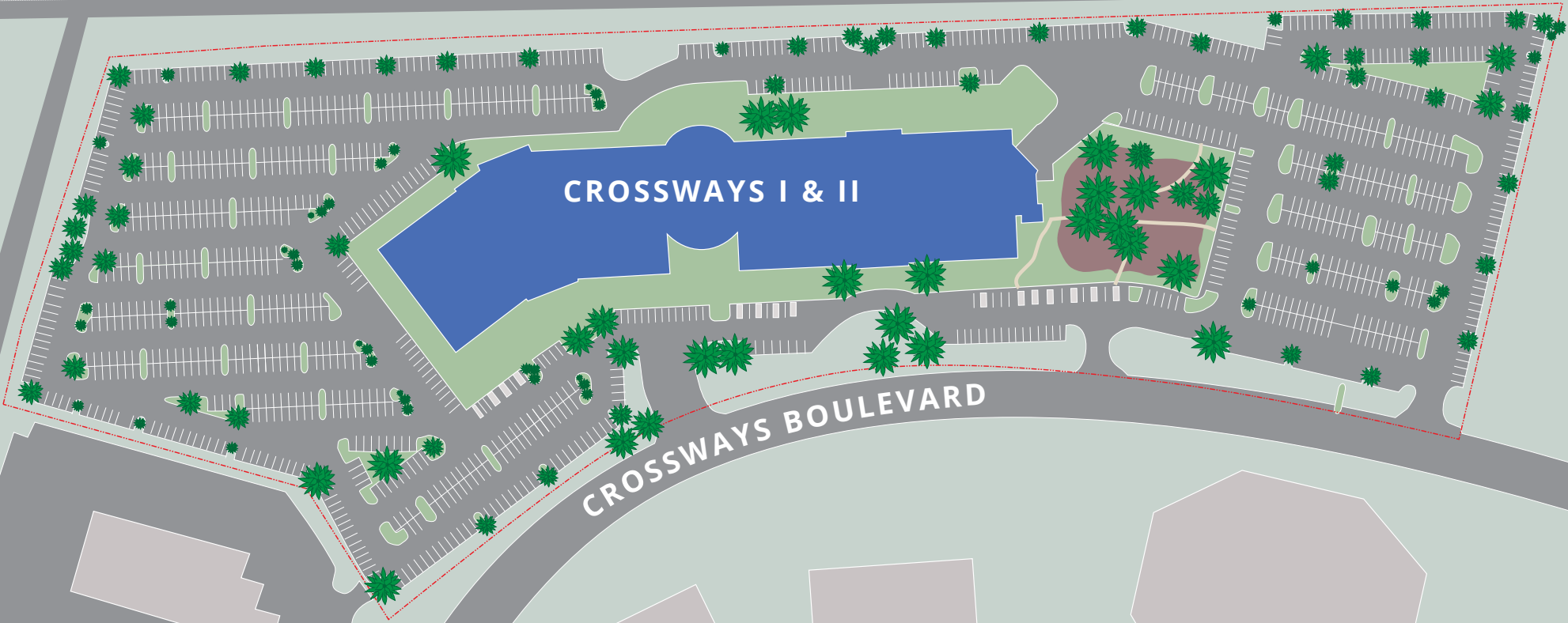

± 222,989 SF building | ± 17.99 acre site

# Site Aerial



± 222,989 SF building | ± 17.99 acre site

# Location & Amenities



**Greenbrier Square**

Kroger DICK'S planet fitness  
HomeGoods Starbucks five BELOW

**Crossways Shopping Center**

Marshall's T.J. Maxx  
ULTA BEAUTY Michaels DSW®  
ROSS DRESS FOR LESS® VCF VALUE CIT FURNITURE!

1434 Crossways Blvd

SUMMIT POINTE  
\$300M mixed-use project  
Dollar Tree Headquarters

Walmart sam's club  
KOHLS at home  
The Home & Holiday Superstore

**Greenbrier Market Center**

BEST BUY BARNES & NOBLE HOBBY LOBBY  
TARGET Harris Teeter Cane's

THE HOME DEPOT LOWE'S

FOOD LION

Immediate access to amenity base of the Greenbrier Submarket



*For Lease*

**1434**

**Crossways Boulevard**

*Leasing Advisors*

**Ricky Anderson**  
Executive Vice President  
+1 757 217 1892  
ricky.anderson@colliers.com

**Chris Kieran**  
Senior Vice President  
+1 757 228 1867  
chris.kieran@colliers.com

This document/email has been prepared by Colliers for advertising and general information only. Colliers makes no guarantees, representations or warranties of any kind, expressed or implied, regarding the information including, but not limited to, warranties of content, accuracy and reliability. Any interested party should undertake their own inquiries as to the accuracy of the information. Colliers excludes unequivocally all inferred or implied terms, conditions and warranties arising out of this document and excludes all liability for loss and damages arising there from. This publication is the copyrighted property of Colliers and /or its licensor(s). © 2025 All rights reserved. This communication is not intended to cause or induce breach of an existing listing agreement. Colliers International Virginia, LLC

150 West Main Street  
Suite 1100  
Norfolk, VA 23510  
Main: +1 757 490 3300  
colliers.com

