

PREPARED FOR:
 MNM Property Management, INC
 570 El Camino Real Suite 150-449
 Redwood City, CA 94063
 Tel (650) 361-4131

BASCOM BUSINESS CENTER
950 S. BASCOM AVENUE
SAN JOSE, CA

THIRD FLOOR
 (As Measured: November 2019)

FLOOR PLAN



*Measured Area:
 27,528 s.f.

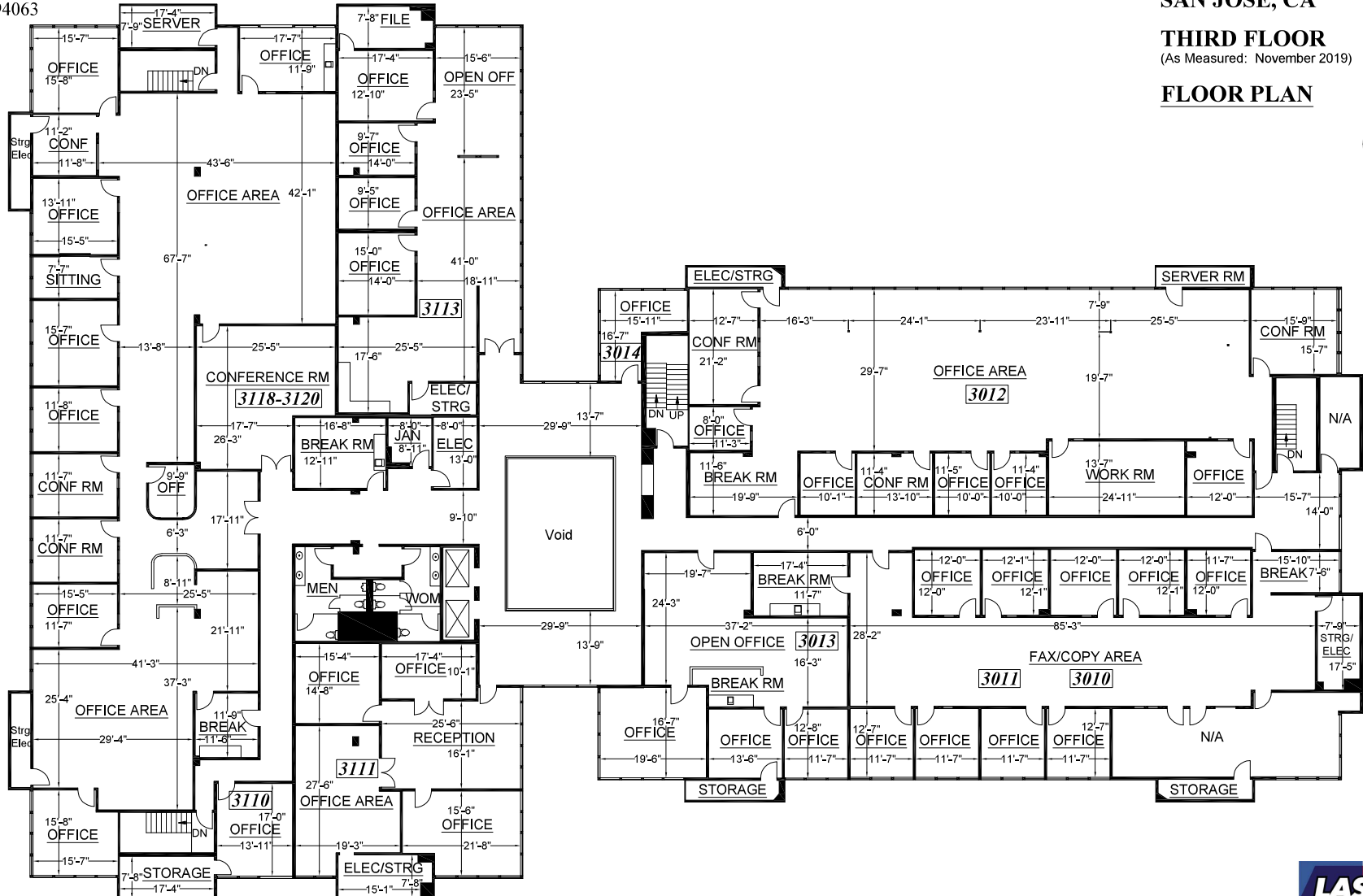

Note: All dimensions shown are rounded to the nearest inch, for informational purposes only. All measurements are recorded to 1/8" accuracy as documented in the final CAD drawing supplied.

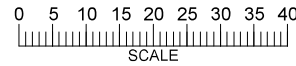

*Measured Area represents the footprint of the floor, and is used solely for billing purposes. It is NOT to be used for leasing purposes.

Survey Accuracy: +/- 0.09 %

LASERTECH® is a registered US trademark of Lasertech® Floorplans Ltd.
 Copyright 1998 Lasertech® Floorplans Ltd., All Rights Reserved



<https://lt-fp.com>
 TEL: (888) 393-6655
 FILE: 19-530