

FOR LEASE

PLAZA 192ND

2011 SE 192nd Avenue | Camas, WA 98607



900 Washington St, Suite 850, Vancouver, WA
360.750.5595 | www.fg-cre.com



PROPERTY HIGHLIGHTS

Building A

- **Suite 106:** 1,575 \$24.00/SF NNN
- Class A retail / office center
- Nearby new retail development including 192nd Station, Candlewood Suites and Holiday Inn Express
- Surrounding major employers include Karcher, Sharp Electronics, Furuno USA, Columbia Tech Center, Banfield, Fisher Investments, and Hewlett Packard
- Fellow tenants include Tapped Brew House & Pub, State Farm, Allure Salon and Spa, Regus and more

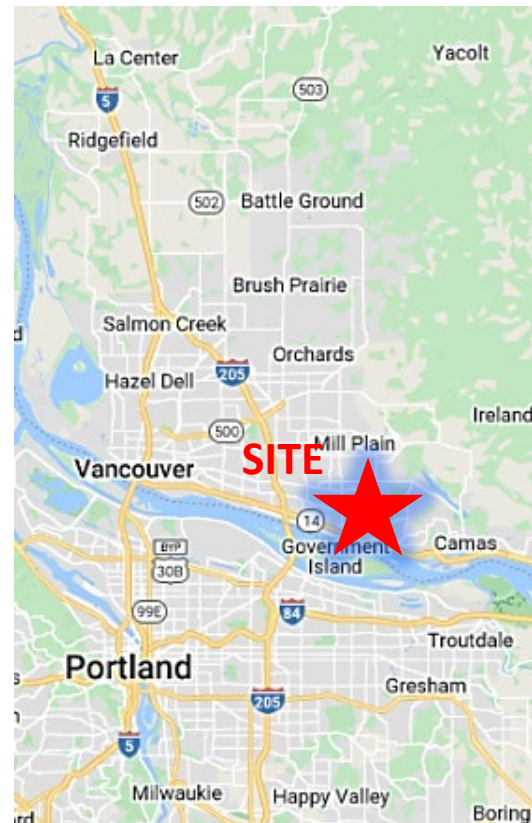

FOR MORE INFORMATION:

KC Fuller | 360.597.0569 | kfuller@fg-cre.com

FOR LEASE

PLAZA 192ND

2011 SE 192nd Avenue | Camas, WA 98607



900 Washington St, Suite 850, Vancouver, WA
360.750.5595 | www.fg-cre.com



Suite 106

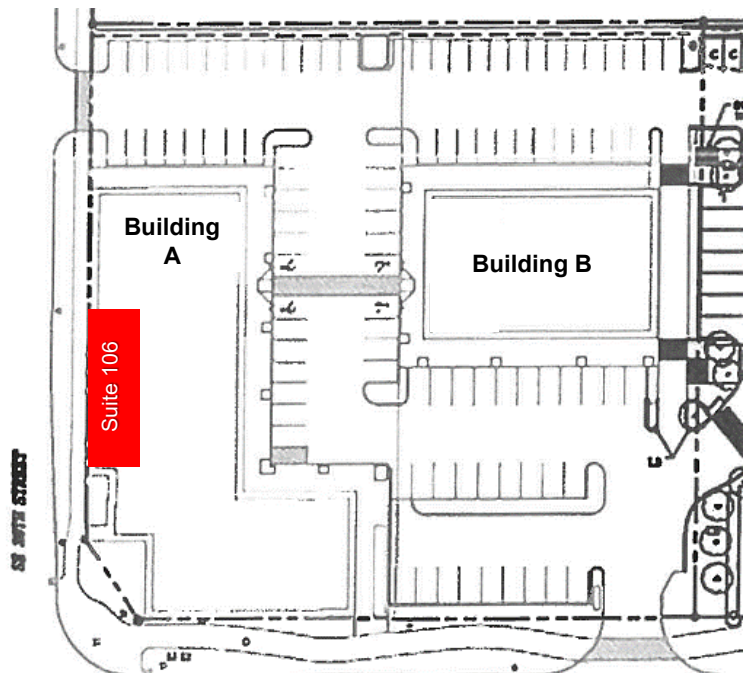
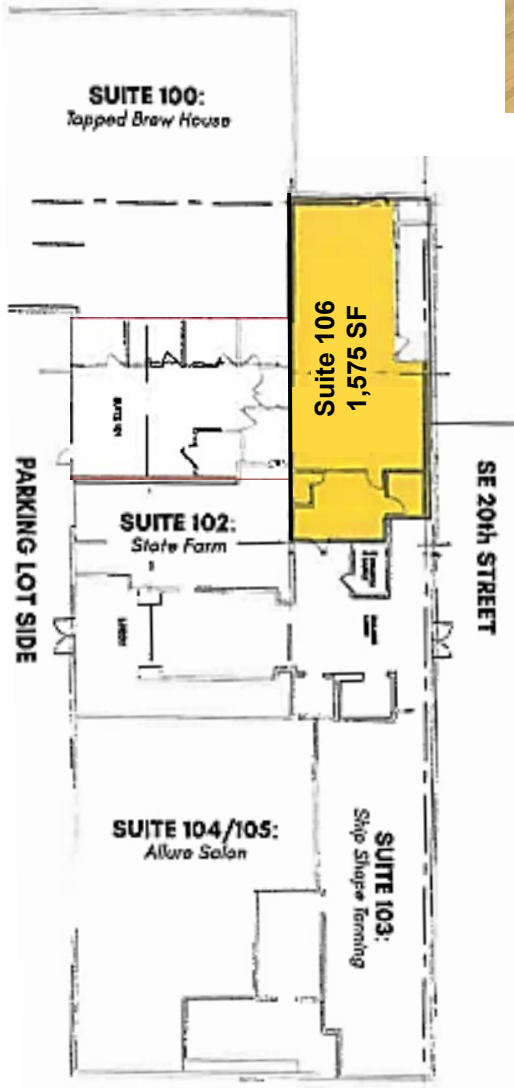

FOR LEASE

PLAZA 192ND

2011 SE 192nd Avenue | Camas, WA 98607



900 Washington St, Suite 850, Vancouver, WA
360.750.5595 | www.fg-cre.com

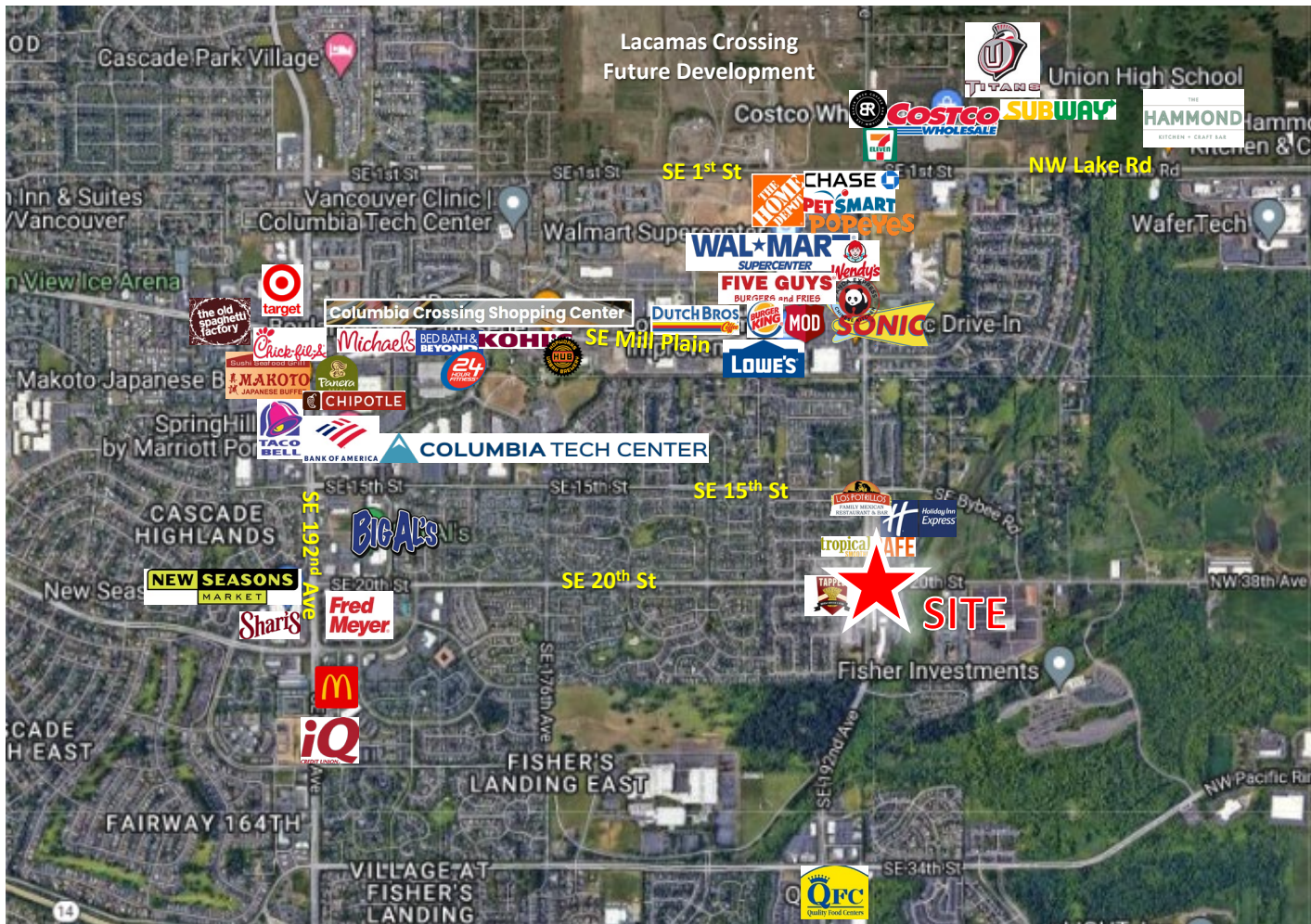

2024 DEMOGRAPHICS

	1 Mile	3 Mile	5 Mile
Est. Population	9,851	74,495	165,834
2029 Projected Population	10,709	80,333	177,072
Est. Average Household Income	\$122,495	\$119,888	\$107,491
Est. Total Businesses	468	2,445	6,930
Est. Total Employees	6,699	21,671	69,591

Average Daily Traffic

SE 192nd Ave @ SE 15th St N – 19,304

SE 192nd Ave @ SE 15th St S – 19,836

SE 192nd Ave @ SE Westridge Blvd S – 20,762

This statement with the information it contains is given with the understanding that all the negotiations relating to the purchase, rental or leasing of the property described above shall be conducted through this office. The above information, while not guaranteed, has been secured from sources we believe to be reliable.