



# APEX

## FORT WASHINGTON

600-602 Office Center Drive  
Fort Washington, PA 19034

Over 100,000 SF of  
Class A Office Space Available



- Efficient 49,000± SF floor plates
- 9' finished ceiling heights and ribbon glass system maximize natural light
- Courtyard transformed into an urban plaza with walking paths and outdoor seating
- Apex Café completely redesigned with new finishes, furniture and outdoor patio seating
- Apex Conference / Training Center with complete technology package
- Apex Fitness Center - Tenant only, fully equipped with locker rooms and showers
- Apex Hub - brand new, centralized lounge with Wifi and TV's
- Upgraded finishes throughout all common areas: lobbies, restrooms, elevators and breeze ways
- Parking ratio 5.3/1,000 SF, including 35% covered parking
- On-site property management
- Dual-feed power with automatic transfer switch
- Easy access to the PA Turnpike and Route 309
- On-site public transportation with access to SEPTA regional rail.

For leasing information please contact one of our exclusive brokers:

**Patrick Nowlan** | Managing Director | t 610.755.6965 | [patrick.nowlan@nmrk.com](mailto:patrick.nowlan@nmrk.com)

**Justin Bell** | Senior Managing Director | t 610.755.6979 | [justin.bell@nmrk.com](mailto:justin.bell@nmrk.com)

**Jeff Mack** | Executive Managing Director | t 610.755.6960 | [jeff.mack@nmrk.com](mailto:jeff.mack@nmrk.com)

[apex-fw.com](http://apex-fw.com)

**NEWMARK**

1000 Continental Drive, Suite 200, King of Prussia, PA 19406 t 610.265.0600 [nmrk.com](http://nmrk.com)

Licensed in Pennsylvania as Newmark Real Estate





# APEX

## FORT WASHINGTON

600-602 Office Center Drive  
Fort Washington, PA 19034



Apex Conference & Training Center



Apex Fitness Center



Outdoor Seating



## NEWMARK

For leasing information please contact one of our exclusive brokers:

**Patrick Nowlan** | Managing Director | t 610.755.6965 | patrick.nowlan@nmrk.com

**Justin Bell** | Senior Managing Director | t 610.755.6979 | justin.bell@nmrk.com

**Jeff Mack** | Executive Managing Director | t 610.755.6960 | jeff.mack@nmrk.com

[apex-fw.com](http://apex-fw.com)

The information contained herein has been obtained from sources deemed reliable but has not been verified and no guarantee, warranty or representation, either express or implied, is made with respect to such information. Terms of sale or lease and availability are subject to change or withdrawal without notice.



600 OFFICE CENTER DRIVE  
FIRST FLOOR: 28,827 SF

FULL SERVICE CAFÉ

GYM & LOCKER ROOMS

# APEX

FORT WASHINGTON

600-602 Office Center Drive  
Fort Washington, PA 19034

## NEWMARK

For leasing information please contact one of our exclusive brokers:

**Patrick Nowlan** | Managing Director | t 610.755.6965 | patrick.nowlan@nmrk.com

**Justin Bell** | Senior Managing Director | t 610.755.6979 | justin.bell@nmrk.com

**Jeff Mack** | Executive Managing Director | t 610.755.6960 | jeff.mack@nmrk.com

[apex-fw.com](http://apex-fw.com)

The information contained herein has been obtained from sources deemed reliable but has not been verified and no guarantee, warranty or representation, either express or implied, is made with respect to such information. Terms of sale or lease and availability are subject to change or withdrawal without notice.



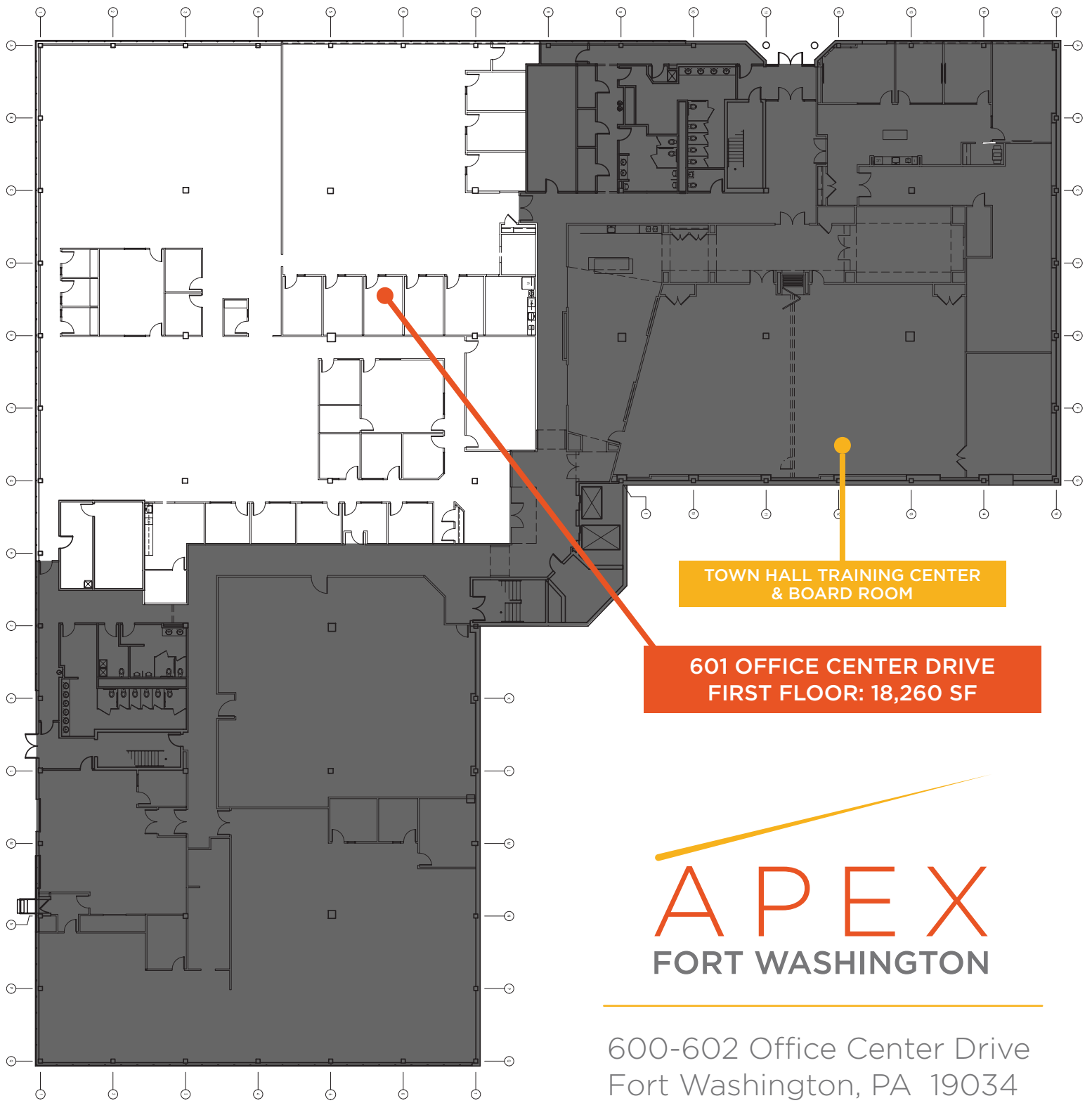

TOWN HALL TRAINING CENTER  
& BOARD ROOM

601 OFFICE CENTER DRIVE  
FIRST FLOOR: 18,260 SF

# APEX

## FORT WASHINGTON

600-602 Office Center Drive  
Fort Washington, PA 19034

**NEWMARK**

For leasing information please contact one of our exclusive brokers:

**Patrick Nowlan** | Managing Director | t 610.755.6965 | patrick.nowlan@nmrk.com

**Justin Bell** | Senior Managing Director | t 610.755.6979 | justin.bell@nmrk.com

**Jeff Mack** | Executive Managing Director | t 610.755.6960 | jeff.mack@nmrk.com

[apex-fw.com](http://apex-fw.com)

The information contained herein has been obtained from sources deemed reliable but has not been verified and no guarantee, warranty or representation, either express or implied, is made with respect to such information. Terms of sale or lease and availability are subject to change or withdrawal without notice.

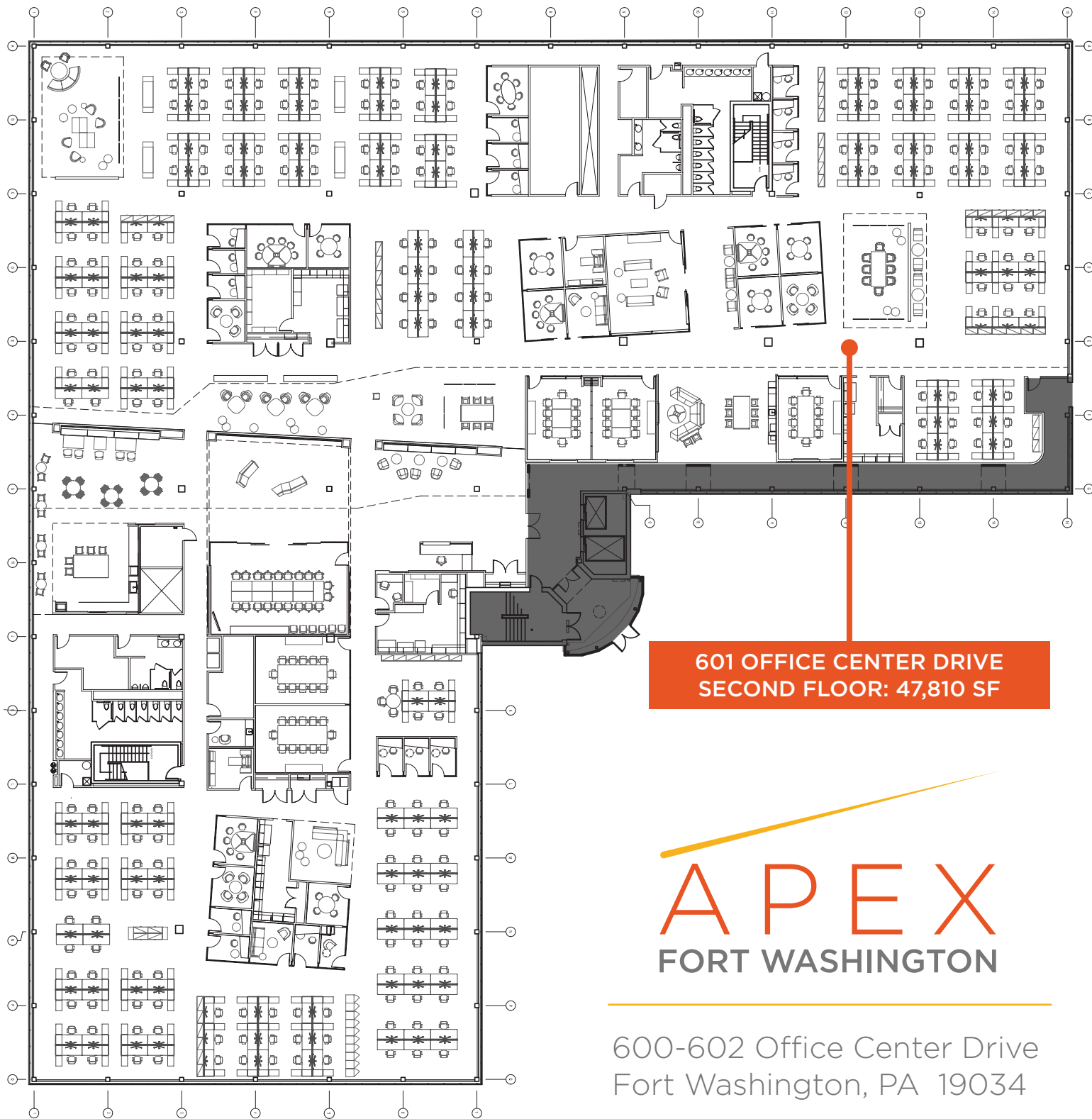

601 OFFICE CENTER DRIVE  
SECOND FLOOR: 47,810 SF

# APEX

FORT WASHINGTON

600-602 Office Center Drive  
Fort Washington, PA 19034

## NEWMARK

For leasing information please contact one of our exclusive brokers:

**Patrick Nowlan** | Managing Director | t 610.755.6965 | patrick.nowlan@nrmk.com

**Justin Bell** | Senior Managing Director | t 610.755.6979 | justin.bell@nrmk.com

**Jeff Mack** | Executive Managing Director | t 610.755.6960 | jeff.mack@nrmk.com

[apex-fw.com](http://apex-fw.com)

The information contained herein has been obtained from sources deemed reliable but has not been verified and no guarantee, warranty or representation, either express or implied, is made with respect to such information. Terms of sale or lease and availability are subject to change or withdrawal without notice.

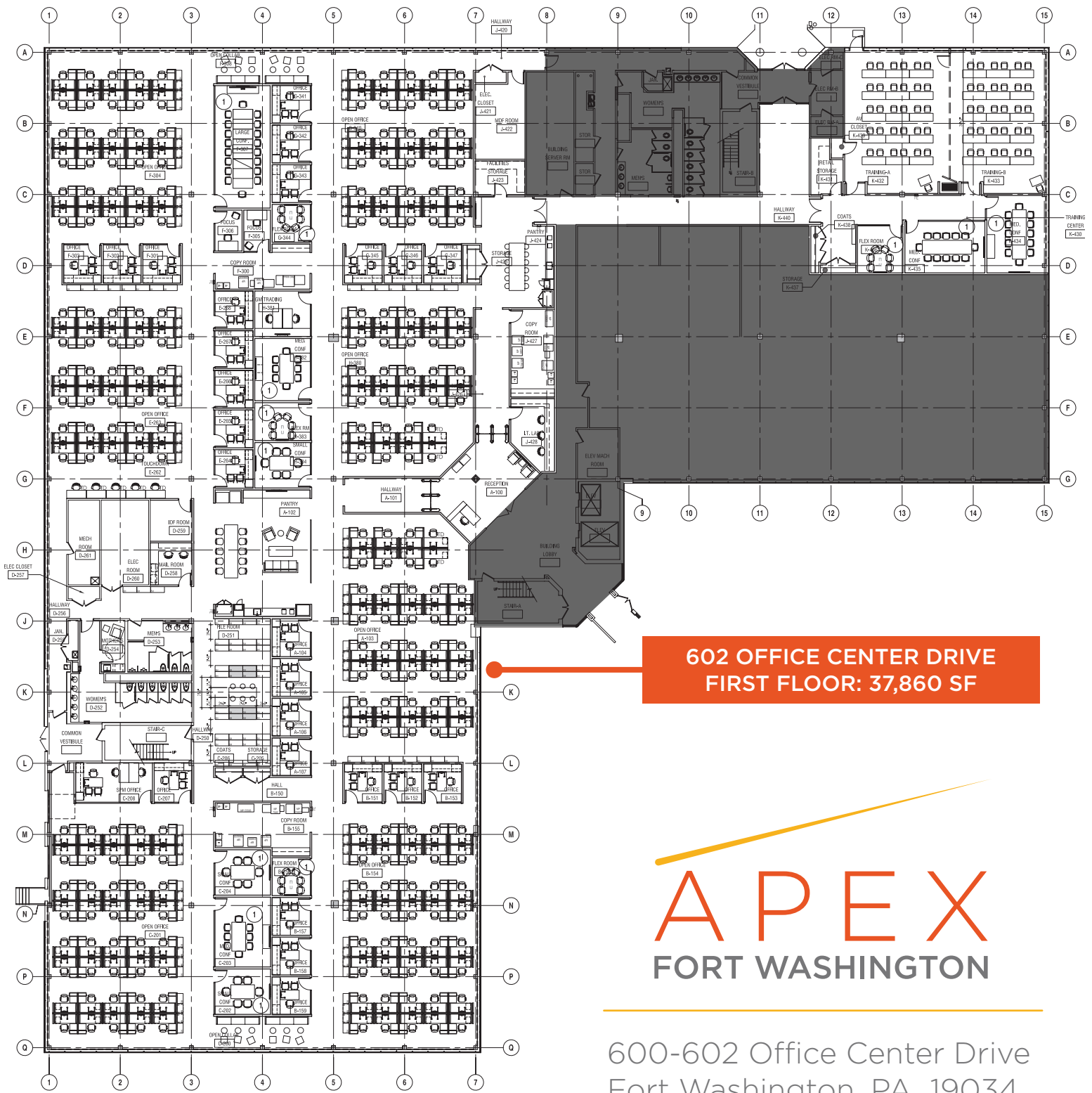

**602 OFFICE CENTER DRIVE  
FIRST FLOOR: 37,860 SF**

# APEX

## FORT WASHINGTON

600-602 Office Center Drive  
Fort Washington, PA 19034

**NEWMARK**

For leasing information please contact one of our exclusive brokers:

**Patrick Nowlan** | Managing Director | t 610.755.6965 | patrick.nowlan@nrmk.com

**Justin Bell** | Senior Managing Director | t 610.755.6979 | justin.bell@nrmk.com

**Jeff Mack** | Executive Managing Director | t 610.755.6960 | jeff.mack@nrmk.com

[apex-fw.com](http://apex-fw.com)

The information contained herein has been obtained from sources deemed reliable but has not been verified and no guarantee, warranty or representation, either express or implied, is made with respect to such information. Terms of sale or lease and availability are subject to change or withdrawal without notice.



# APEX

FORT WASHINGTON

600-602 Office Center Drive  
Fort Washington, PA 19034

Now is your opportunity to join our  
exciting roster of existing tenants



## NEWMARK

For leasing information please contact one of our exclusive brokers:

**Patrick Nowlan** | Managing Director | t 610.755.6965 | patrick.nowlan@nmrk.com

**Justin Bell** | Senior Managing Director | t 610.755.6979 | justin.bell@nmrk.com

**Jeff Mack** | Executive Managing Director | t 610.755.6960 | jeff.mack@nmrk.com

[apex-fw.com](http://apex-fw.com)

The information contained herein has been obtained from sources deemed reliable but has not been verified and no guarantee, warranty or representation, either express or implied, is made with respect to such information. Terms of sale or lease and availability are subject to change or withdrawal without notice.