

# Hillsboro Center

938—980 SE Oak Street, Hillsboro, OR 97123



**Centrally located** in Hillsboro at the corner of Oak Street and 10th Avenue. This building has **high traffic, plenty of parking and exterior signage**. Average daily traffic on 10th Avenue is **28,000 cars per day** and **17,200 cars per day** on SE Oak Street. Neighboring tenant's include Human Bean Coffee, Paisanos Plaza, Super Mercado and several others.



Ashley Rhea | 503.616.2942 D | 503.675.0900 O | [ashley@barnardcommercial.com](mailto:ashley@barnardcommercial.com)  
[www.barnardcommercial.com](http://www.barnardcommercial.com) | 5200 Meadows Road, Suite 150, Lake Oswego OR 97035



Your Sign Here



**Available:**  
**900 SE Oak**

**Suite 202—7,005 SF\***  
*\*Divisible down to  
approximately 2,500 SF*

Fully built out and equipped  
medical space

2nd floor, elevator served

**\$26.00 SF/Year,**  
**modified gross**

Ashley Rhea | 503.616.2942 D | 503.675.0900 O | ashley@barnardcommercial.com  
www.barnardcommercial.com | 5200 Meadows Road, Suite 150, Lake Oswego OR 97035

Suite 202—7005 SF

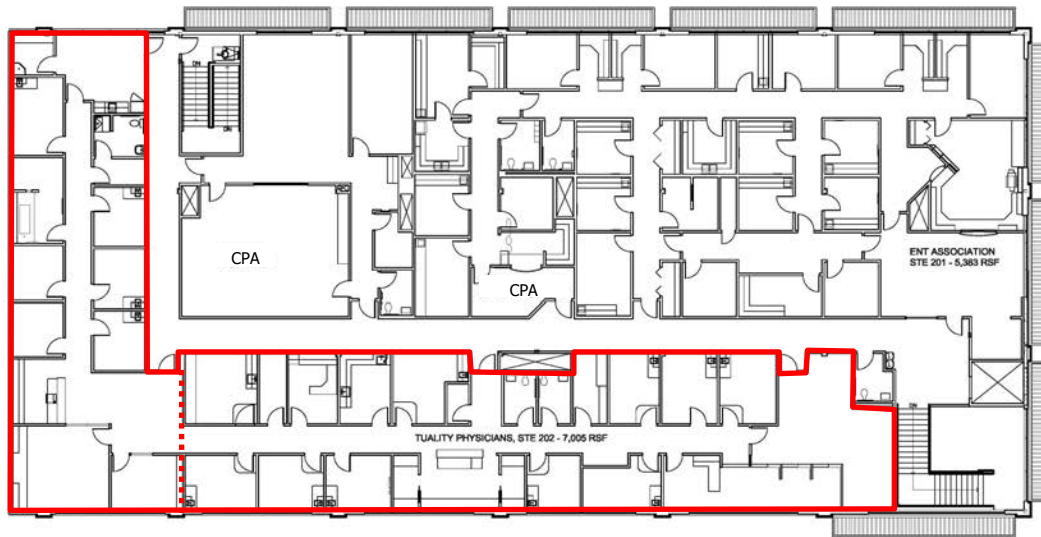

Fully built out medical  
space

### Space Comes With:

- X-ray machine
- 8 Exam rooms each with exam tables, blood pressure cuffs, sphygmomanometer, stool, sinks
- EKG Machine
- Defibrillator
- Ultrasound machine
- Chairs, desks, and many other supplies

Ashley Rhea | 503.616.2942 D | 503.675.0900 O | [ashley@barnardcommercial.com](mailto:ashley@barnardcommercial.com)  
[www.barnardcommercial.com](http://www.barnardcommercial.com) | 5200 Meadows Road, Suite 150, Lake Oswego OR 97035

# Hillsboro Center

## SPACE HIGHLIGHTS:

Waiting area, reception, 3 restrooms (one full restroom with shower), break room, nurses station, x ray room, lab, 13 patient rooms with sinks, 4 offices.



Ashley Rhea | 503.616.2942 D | 503.675.0900 O | [ashley@barnardcommercial.com](mailto:ashley@barnardcommercial.com)  
[www.barnardcommercial.com](http://www.barnardcommercial.com) | 5200 Meadows Road, Suite 150, Lake Oswego OR 97035

# Hillsboro Center

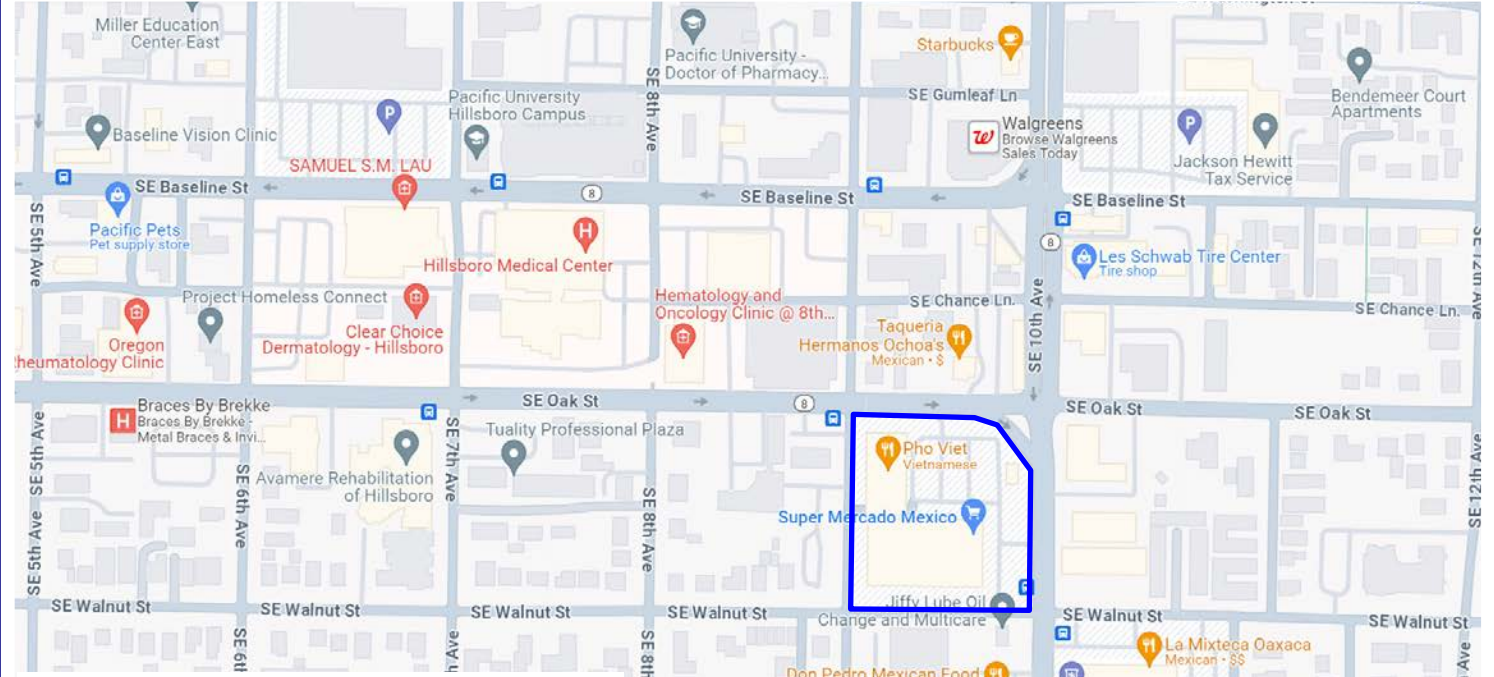

**Demographics**

	1 Mile	3 Mile	5 Mile
<b>Population:</b>	22,276	77,531	147,615
<b>Average HH Income:</b>	\$71,168	\$102,573	\$99,709

Ashley Rhea | 503.616.2942 D | 503.675.0900 O | ashley@barnardcommercial.com  
www.barnardcommercial.com | 5200 Meadows Road, Suite 150, Lake Oswego OR 97035

All information contained herein was obtained from sources deemed reliable. No guarantee is made with respect to accuracy. Specifications subject to change without notice.