

MESA QUADRANGLE

2135 E UNIVERSITY DR | MESA, AZ 85213

±14,296 SF Multi-Tenant Professional Office Building

FOR LEASE



Building Features

- Less than 1/4 mile west of Gilbert Rd
- Dominant University Dr location (±21,000 VPD)
- Southwest architecture with lush landscaping
- Parking ratio of 4:1,000



LEASE RATE \$18.50 MG

Dallin Pace
D 480.522.2774
M 480.815.8275
dpace@cpiaz.com



COMMERCIAL PROPERTIES INC.

Locally Owned. Globally Connected. CORFAC INTERNATIONAL

TEMPE: 2323 W University Drive, Tempe, AZ 85281 | 480.966.2301
SCOTTSDALE: 8767 E Via de Commercio, Suite 101, Scottsdale, AZ 85258 | www.cpiaz.com

MESA QUADRANGLE

2135 E UNIVERSITY DR | MESA, AZ 85213

Available Suites ■

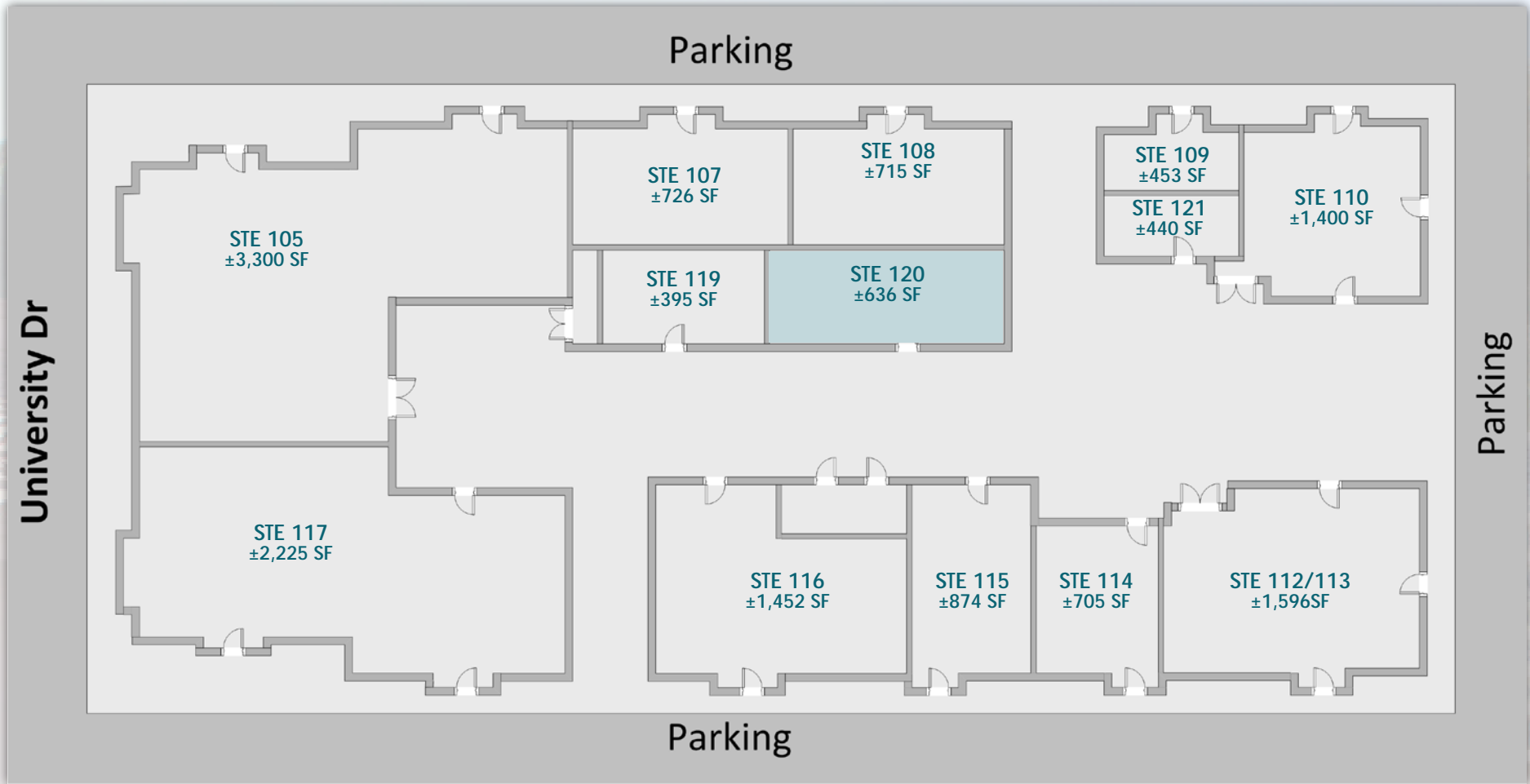

The information contained herein has been obtained from various sources. We have no reason to doubt its accuracy; however, J & J Commercial Properties, Inc. has not verified such information and makes no guarantee, warranty or representation about such information. The prospective buyer or lessee should independently verify all dimensions, specifications, floor plans, and all information prior to the lease or purchase of the property. All offerings are subject to prior sale, lease, or withdrawal from the market without prior notice. Effective 01 23 26

Dallin Pace
D 480.522.2774
M 480.815.8275
dpac@cpiaz.com



COMMERCIAL PROPERTIES INC.

Locally Owned. Globally Connected. CORFAC INTERNATIONAL

TEMPE: 2323 W University Drive, Tempe, AZ 85281 | 480.966.2301
SCOTTSDALE: 8767 E Via de Commercio, Suite 101, Scottsdale, AZ 85258 | www.cpiaz.com