

123, 125 & 127 S. Main Street



July 15, 2025

Streets and Highways

- FREEWAY
- INTERSTATE
- BOULEVARD
- THOROUGHFARE
- COLLECTOR

- Local Roads
- Parcels

THIS IS NOT A SURVEY.

All information or data provided, whether subscribed, purchased or otherwise distributed, whether in hard copy or digital media, shall be at the user's own risk. Henderson County makes no warranties or guarantees, including the warranties of merchantability or of fitness for a particular purpose. Map data is not appropriate for, and is not to be used as, a geodetic, legal, or engineering base system. The data is not intended as a substitute for surveyed locations such as can be determined by a registered Public Land Surveyor, and does not meet the minimum accuracy standards of a Land Information System/Geographic Information System Survey in North Carolina (21 NCAC 56.1608).

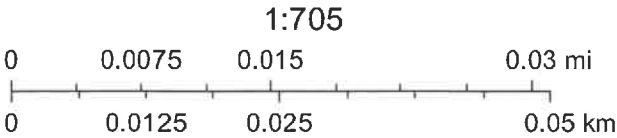

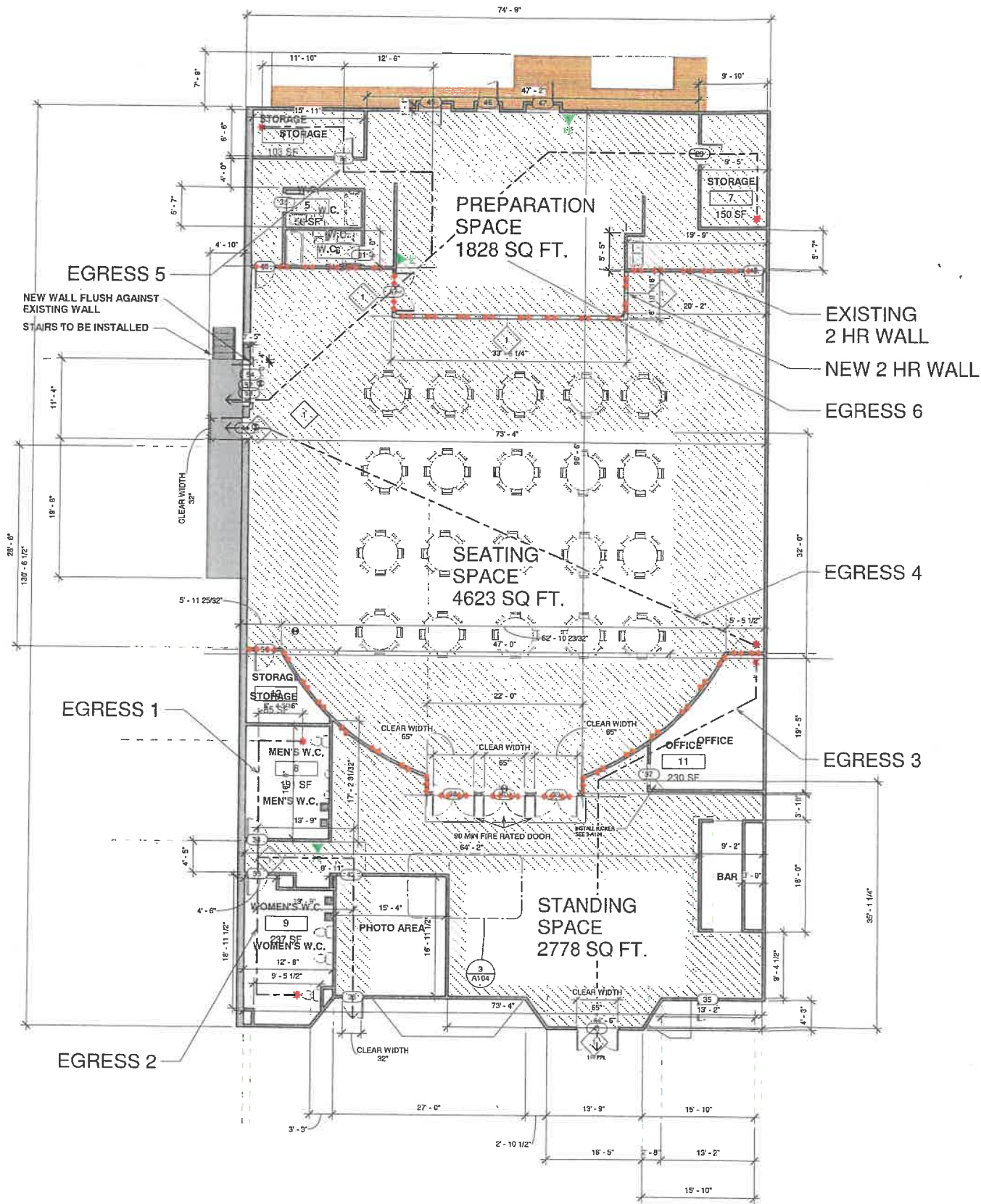

OCCUPANT LOAD					
AREA	SQUARE FT.	SPACE	OCCUPANCY AND LOAD FACTOR		
	500 SQ FT	STANDING AREA 1	ASSEMBLY 5 SQ FT/PERSON (STANDING SPACE)	100 PERSONS	
	1500 SQ FT	SEATING AREA	ASSEMBLY 15 SQ FT/PERSON (TABLES AND CHAIRS)	100 PERSONS	
	500 SQ FT	STANDING AREA 2	ASSEMBLY 5 SQ FT/PERSON (STANDING SPACE)	100 PERSONS	1ST FLOOR

EGRESS ROUTES			
ROUTE	DISTANCE (MAX 200')	OCCUPANCY AND LOAD FACTOR	
EGRESS 1	56' 7"	MENS BATHROOM TO FRONT DOOR	
EGRESS 2	58' 11"	WOMENS BATHROOM TO FRONT DOOR	
EGRESS 3	65' 8"	OFFICE TO FRONT DOOR	
EGRESS 4	78' 5"	ASSEMBLY SPACE TO SIDE DOOR	
EGRESS 5	95' 0"	STORAGE SPACE TO SIDE DOOR	
EGRESS 6	61' 4"	STORAGE SPACE TO SIDE DOOR	

- SMOKE PARTITION - NON RATED
- RATED - EXISTING 1 HOUR
- RATED - 1 HOUR
- RATED SMOKE - 1 HOUR
- RATED - EXISTING 2 HOUR
- RATED - 2 HOUR
- RATED SMOKE - 2 HOUR

FIRE RATING AND FIRE PROOFING NOTES:
1. SEE FLOOR PLAN(S) AND WALL TYPE SCHEDULE FOR WALL ASSEMBLY TYPES AND CONSTRUCTION
2. FIRE CAULK AROUND ALL ELECTRICAL CONDUIT PASSING THROUGH WALLS.
3. SEE MECHANICAL AND PLUMBING DRAWINGS FOR SPECIAL DETAILS WHERE DUCTWORK AND PIPING PASS THROUGH WALLS.
4. REFER TO SHEET GXXX.XX FOR GENERAL FLOOR, ROOF, AND STRUCTURAL RATING REQUIREMENTS AND RELEVANT PROPOSED PROTECTION SYSTEMS.

- EGRESS PATH OF TRAVEL
- SMOKE COMPARTMENT PATH OF TRAVEL
- DOOR EXIT OCCUPANT LOAD
- DOOR EXIT OCCUPANT CAPACITY
- DOOR CLEAR EXIT WIDTH (IN INCHES)
- BRACKET MOUNTED FIRE EXTINGUISHER
- RECESSED OR SEMI-RECESSED FIRE EXTINGUISHER CABINET
- CEILING MOUNTED EXIT SIGN (ARROWS WHEN INDICATED)
- WALL MOUNTED EXIT SIGN (ARROWS WHEN INDICATED)
- SMOKE DETECTOR

LIFE SAFETY LEGEND
1/4" = 1'-0"

THE TAMARA PEACOCK COMPANY

Architects
104 FIRST AVENUE EAST, SUITE A
HENDERSONVILLE, NC 28792
PHONE: 828.676.6000

PROJECT DESIGN TEAM:
THE TAMARA PEACOCK CO. ARCHITECTS
104 FIRST AVENUE EAST, SUITE A
HENDERSONVILLE, NC 28792
PH: 828-676-6000

OWNER:
BRITTANY BETTINI
813 S MAIN STREET
HENDERSONVILLE, NC 28792

THE MAIN EVENT WNC

125 S MAIN STREET
HENDERSONVILLE, NC 28792



Tamara Peacock, R.A.
LADDER #147128

ISSUED FOR:

DATE:
08/20/2023 8:46:17 AM

LIFE SAFETY PLAN

REVISIONS:

This document is property of Tamara Peacock Company and no part shall be copied or reproduced without the written consent of Tamara Peacock Company. This document was prepared by the Tamara Peacock Company and is intended for the use of the client only. The client is responsible for the accuracy and completeness of the information provided. The client is responsible for the accuracy and completeness of the information provided. The client is responsible for the accuracy and completeness of the information provided.

DATE: 8/20/2023 8:46:17 AM
FILED BY: CHECKER
DRAWN BY: AUTHOR
DESIGNED BY: DESIGNER
CHECKED BY: CHECKER
APPROVED BY: APPROVER

SHEET NO.:
A102