



ARES  
INDUSTRIAL  
MANAGEMENT

# 7405 GRAHAM ROAD

7405 GRAHAM RD, FAIRBURN, GA, 30213

FOR LEASE | 71,978 - 204,310 SQ FT



MIKE SUTTER, SIOR

Executive VP / Principal  
msutter@lee-associates.com  
404-442-2804

RICK TUMLIN, CCIM, SIOR

Executive VP / Principal  
rtumlin@lee-associates.com  
404-442-2816

TREY TUMLIN

Director  
ttumlin@lee-associates.com  
404-442-2828

ELIZABETH KENNEDY

Associate  
ekennedy@lee-associates.com  
404-781-2106

# Property

## FEATURES

- 71,978 - 204,310 SF
- 5,153 - 11,189 SF of office
- 22' clear height
- 40 total dock high doors
- 13 pit levelers
- 1 ramp

- LED lights on motion sensors
- 38' x 31' column spacing
- 120' truck court depth
- Wet Sprinkler System
- Power: 800 amps @ 277/480v

### Suite A

Total SF: 71,978 SF  
Office SF: 6,036 SF  
12 Docks

### Suite B

Total SF: 132,332 SF  
Office SF: 5,153 SF  
28 Docks

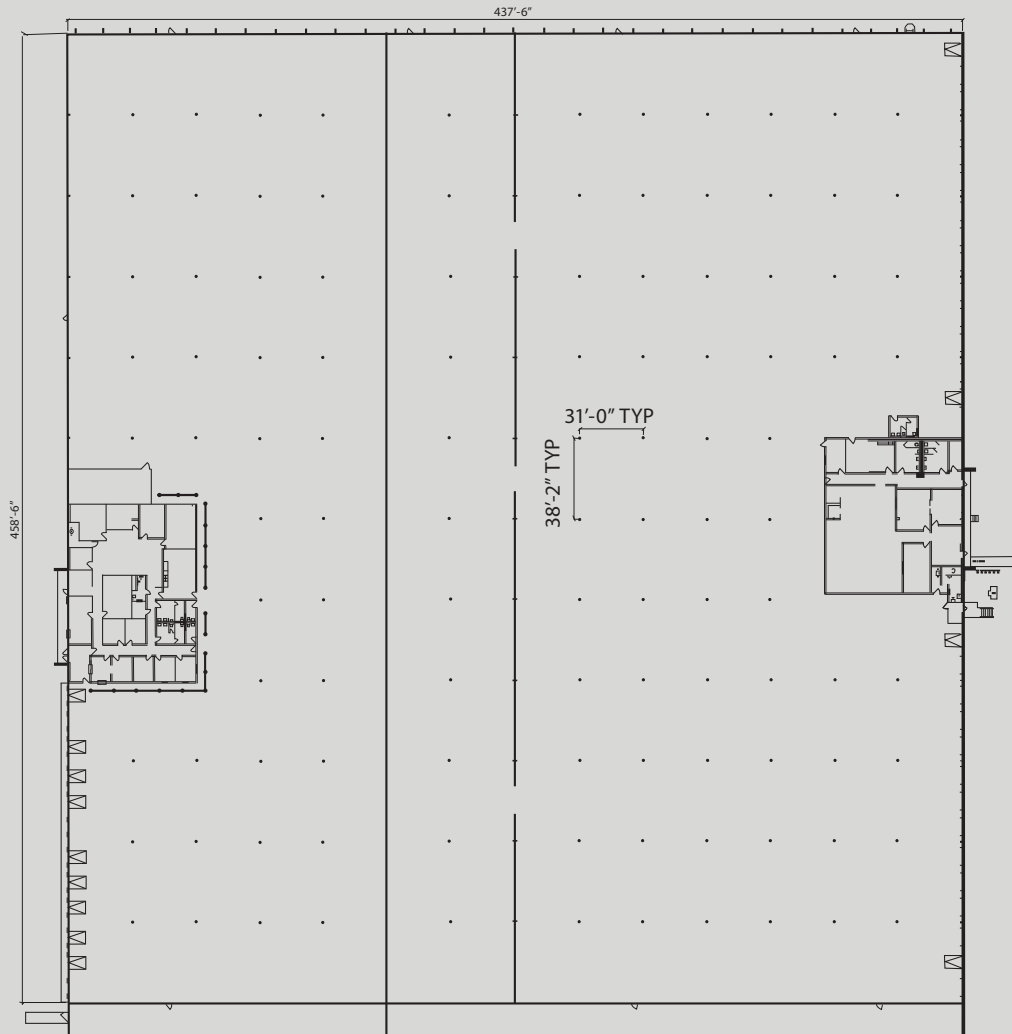

# Location HIGHLIGHTS

- I-85: 2.3 miles
- I-285: 7.5 miles
- CSX Intermodal: 5.3 miles
- Hartsfield-Jackson Atlanta International Airport: 13.7 mi



ARES  
INDUSTRIAL  
MANAGEMENT

### ABOUT ARES MANAGEMENT CORPORATION

Ares Management Corporation (NYSE: ARES) is a leading global alternative investment manager offering clients complementary primary and secondary investment solutions across the credit, private equity, real estate and infrastructure asset classes. We seek to provide flexible capital to support businesses and create value for our stakeholders and within our communities. By collaborating across our investment groups, we aim to generate consistent and attractive investment returns throughout market cycles. For more information, please visit [www.aresmgmt.com](http://www.aresmgmt.com).

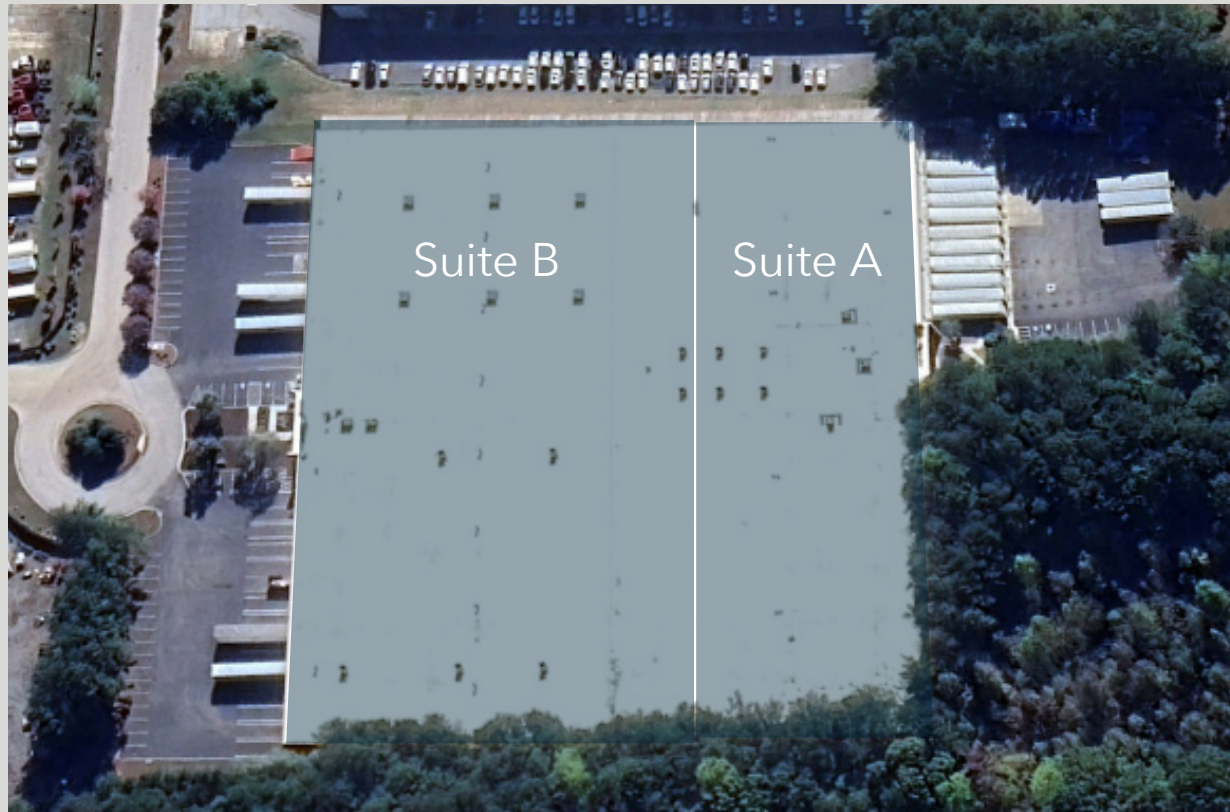

MIKE SUTTER, SIOR  
msutter@lee-associates.com  
404-442-2804

TREY TUMLIN  
ttumlin@lee-associates.com  
404-442-2828

RICK TUMLIN, CCIM, SIOR  
rtumlin@lee-associates.com  
404-442-2816

ELIZABETH KENNEDY  
ekennedy@lee-associates.com  
404-781-2106



ARES  
INDUSTRIAL  
MANAGEMENT