

138,563 – 650,887 SF
FOR LEASE

5400 Fulton Industrial Blvd.
ATLANTA, GA 30336

Contact Us:

Nathan Anderson
NAI Brannen Goddard
+1 404 713 8532
nanderson@naibg.com

Chris Cummings
OnPace Cold
+1 678 612 9958
chris.cummings@onpacepartners.com

Turner Wisehart
OnPace Cold
+1 770 654 4334
turner.wisehart@onpacepartners.com

Cater Cosgrove
OnPace Cold
+1 404 317 0930
cater.cosgrove@onpacepartners.com

5400 Fulton Industrial Boulevard | Atlanta, GA



Suite 100

296,444 SF

Office: 4,055 SF

Loading: 26 Dock-Highs with Pit Levelers; 1 Drive-In

Suite 150

138,563 SF

Office: 1,707 SF

Loading: 26 Dock-Highs with Pit Levelers

Suites 100 & 150

435,007 SF

Office: 5,762 SF

Loading: 52 Dock-Highs with Pit Levelers; 1 Drive-In

Suite 200

215,800 SF

Office: 4,613 SF

Loading: 31 Dock-Highs; 2 Drive-Ins

Suites 100, 150 & 200

650,807 SF

Office: 14,430 SF

Loading: 83 Dock-High; 2 Drive-Ins

Additional Features:

Clear Height 28'

Sprinklered

Heavy Power

Column Spacing 40' W x 32' D

**All SF's are approximate*

5400 Fulton Industrial Boulevard | Atlanta, GA

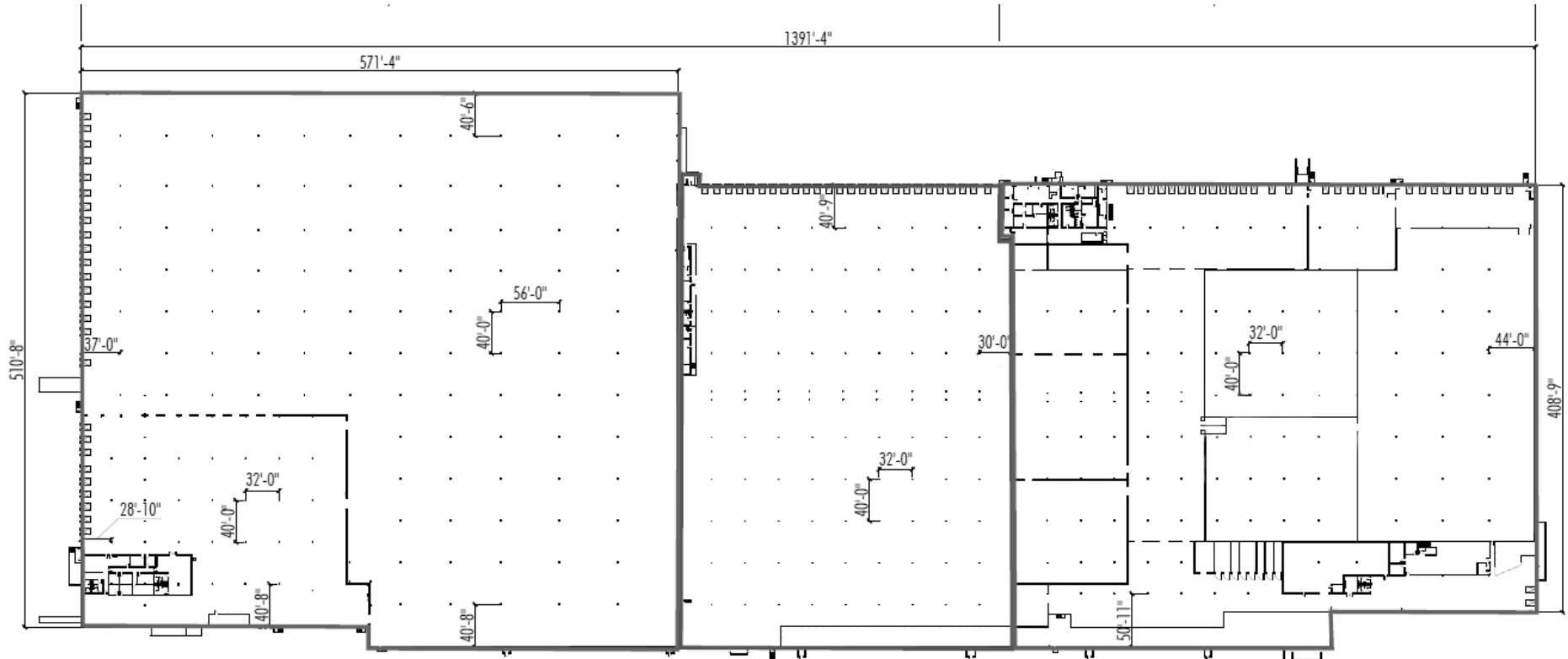

SUITE 100
296,444 SF
4,055 SF Office

SUITE 150
138,563 SF
1,707 SF Office

SUITE 200
215,880 SF
4,613 SF Office
67,652 SF Freezer
71,931 SF Cooler
26,430 SF Cold Dock
45,254 SF Dry Space

5400 Fulton Industrial Boulevard | Atlanta, GA

The facility is located in Atlanta's most mature industrial submarket with over 120 million SF of industrial space. 5400 Fulton Industrial offers connectivity into Atlanta via I-20 (3.5 mi) and I-285 (5.2 mi) and Hartsfield Jackson Airport is 14.2 miles away.

Recent Facility & Site Upgrades

- Roof Repairs/Replacement - 2017
- New Lighting - 2022
- Parking Lot Seal and Re-Stripe - 2023
- Painting - 2022



Contact Us:

Nathan Anderson
NAI Brannen Goddard
+1 404 713 8532
nanderson@naibg.com

Turner Wisehart
OnPace Cold
+1 770 654 4334
turner.wisehart@onpacepartners.com

Chris Cummings
OnPace Cold
+1 678 612 9958
chris.cummings@onpacepartners.com

Cater Cosgrove
OnPace Cold
+1 404 317 0930
cater.cosgrove@onpacepartners.com

