

533 Myatt Dr, Madison, TN 37115

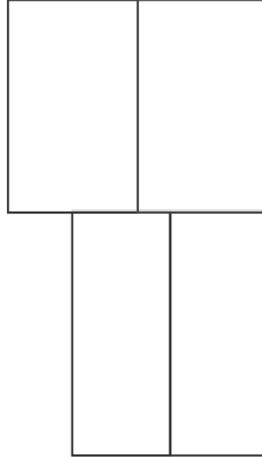

In this 3D model, facets appear as semi-transparent to reveal overhangs.

Report Details

Report: 63969118

Roof/Wall Details

Total Roof Area = 10,201 sq ft  
Total Roof Facets = 4  
Predominant Pitch = 1/12  
Number of Stories <=1  
Total Ridges/Hips = 144 ft  
Total Valleys = 0 ft  
Total Rakes = 226 ft  
Total Eaves = 288 ft  
Total Penetrations = 15  
Total Penetrations Perimeter = 60 ft  
Total Penetrations Area = 15 sq ft  
Total Wall Area = 8019.4 sq ft  
Total Wall Facets = 8

Report Contents

Images .....	1
Length Diagram.....	4
Pitch Diagram .....	5
Area Diagram .....	6
Notes Diagram .....	7
Penetrations Diagram .....	8
3D Wall Area Diagram.....	9
Alternate 3D Wall View.....	10
Window and Door Diagram.....	11
Report Summary .....	16
Wall Report Summary .....	18

Contact: Clyde Tant  
Company: Wright Fire & Forensics, LLC  
Address: 401 S Mount Juliet Rd Suite 235-313  
Mt Juliet TN 37122-6359  
Phone: 865-271-7152

Measurements provided by [www.eagleview.com](http://www.eagleview.com)



**Certified Accurate**  
Certified accuracy on all roof reports.



**Satisfaction Guaranteed**  
Satisfaction guaranteed on all wall reports.

## Images

The following aerial images show different angles of this structure for your reference.



North Side



South Side

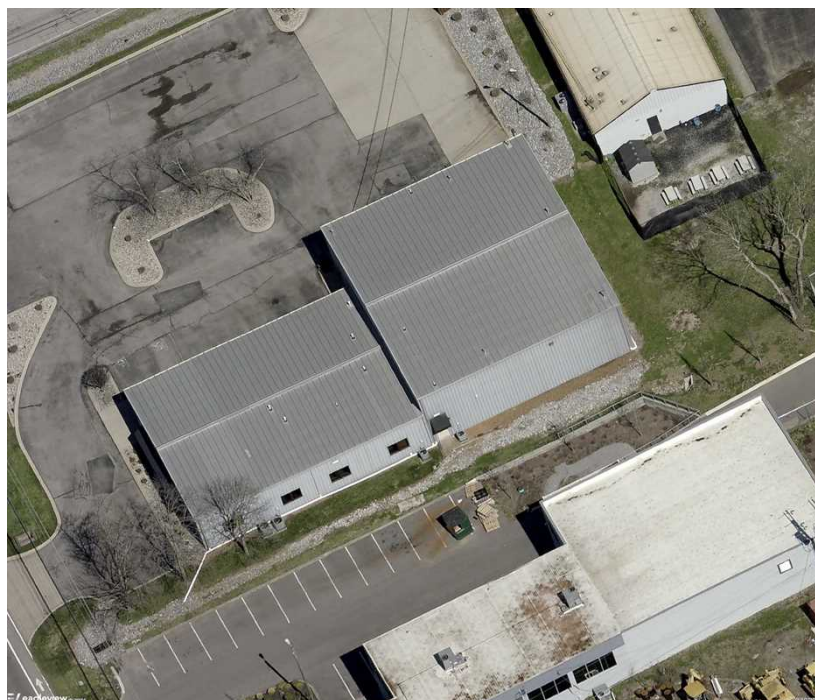



East Side



West Side

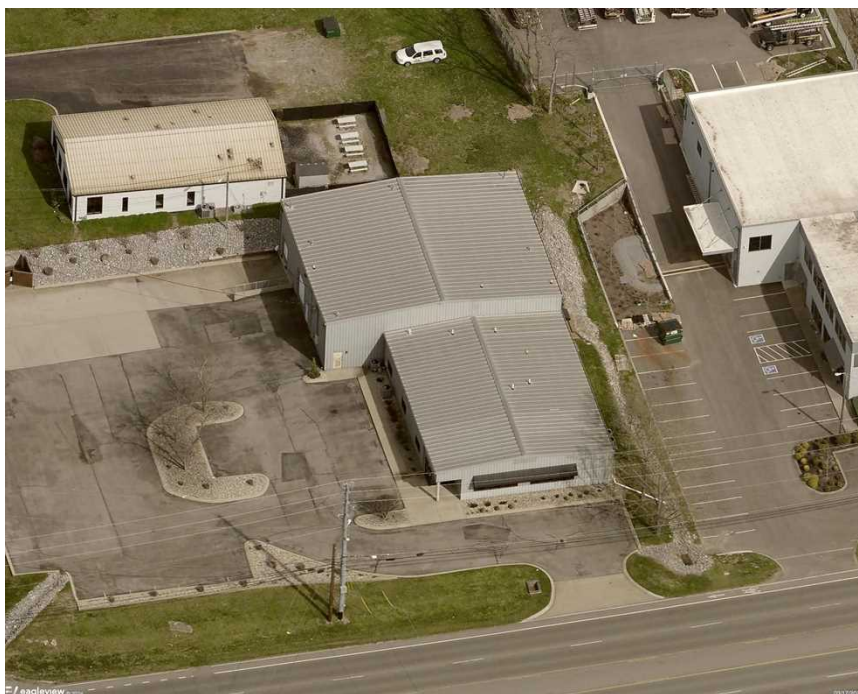

**Length Diagram**

Total Line Lengths:

**Ridges = 144 ft****Hips = 0 ft**

Valleys = 0 ft

Rakes = 226 ft

Eaves = 288 ft

Flashing = 0 ft

Step flashing = 62 ft

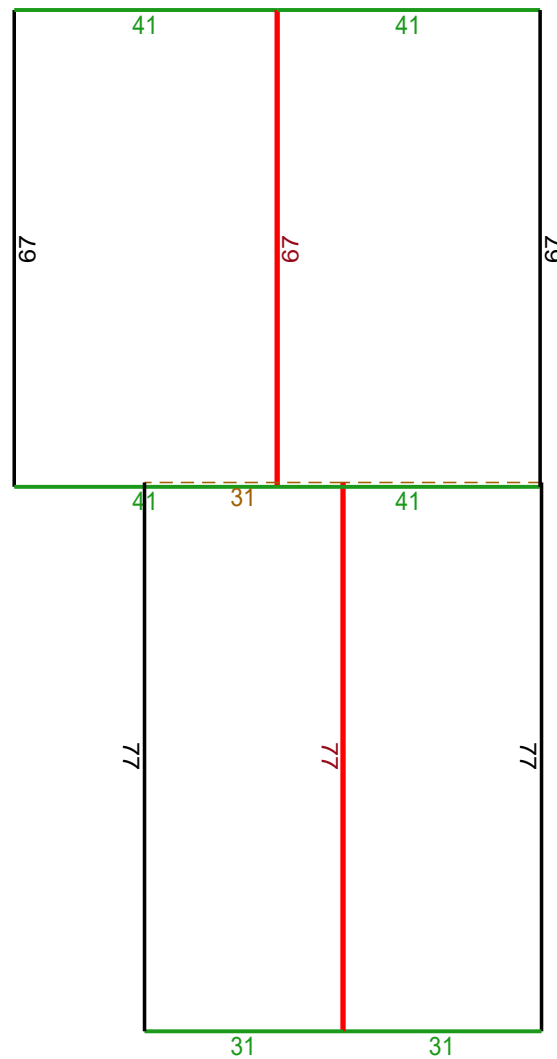
**Parapets = 0 ft**

©2025 Eagle View Technologies, Inc., All Rights Reserved.

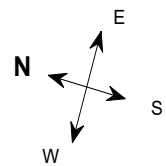

**Note:** This diagram contains segment lengths (rounded to the nearest whole number) over 5 feet. In some cases, segment labels have been removed for readability. Plus signs preface some numbers to avoid confusion when rotated (e.g. +6 and +9).



Report: 63969118

© 2008-2025 Eagle View Technologies, Inc. and Pictometry International Corp. – All Rights Reserved – Covered by one or more of U.S. Patent Nos. 8,078,436; 8,145,578; 8,170,840; 8,209,152; 8,515,125; 8,825,454; 9,135,737; 8,670,961; 9,514,568; 8,818,770; 8,542,880; 9,244,589; 9,329,749; 9,599,466. Other Patents Pending.

## Pitch Diagram

Pitch values are shown in inches per foot, and arrows indicate slope direction. The predominant pitch on this roof is 1/12.

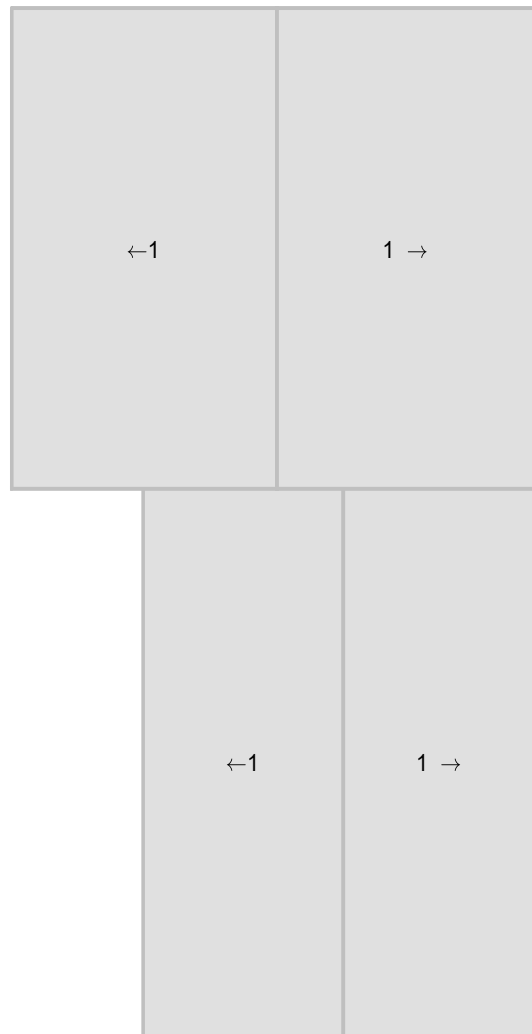

©2025 Eagle View Technologies, Inc., All Rights Reserved.

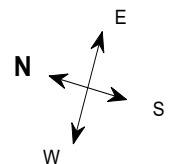

**Note:** This diagram contains labeled pitches for facet areas larger than 20 square feet. In some cases, pitch labels have been removed for readability. Plus signs preface some numbers to avoid confusion when rotated (e.g. +6 and +9). Gray shading indicates flat, 1/12 or 2/12 pitches.



Report: 63969118

© 2008-2025 Eagle View Technologies, Inc. and Pictometry International Corp. – All Rights Reserved – Covered by one or more of U.S. Patent Nos. 8,078,436; 8,145,578; 8,170,840; 8,209,152; 8,515,125; 8,825,454; 9,135,737; 8,670,961; 9,514,568; 8,818,770; 8,542,880; 9,244,589; 9,329,749; 9,599,466. Other Patents Pending.

**Area Diagram**

Total Area = 10,201 sq ft, with 4 facets.

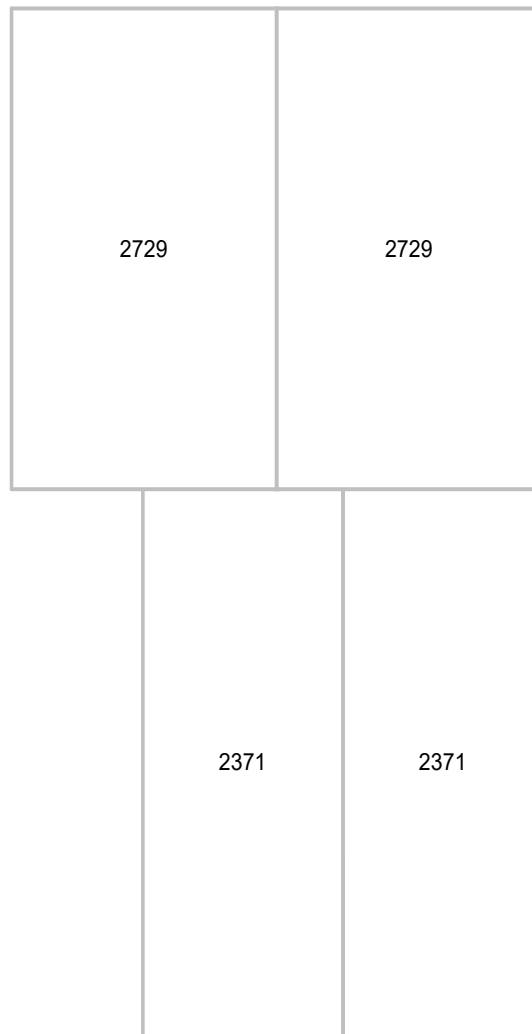

© 2025 Eagle View Technologies, Inc., All Rights Reserved.

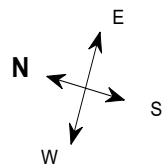

**Note:** This diagram shows the square feet of each roof facet (rounded to the nearest foot). The total area in square feet, at the top of this page, is based on the non-rounded values of each roof facet (rounded to the nearest square foot after being totaled).



Report: 63969118

© 2008-2025 Eagle View Technologies, Inc. and Pictometry International Corp. – All Rights Reserved – Covered by one or more of U.S. Patent Nos. 8,078,436; 8,145,578; 8,170,840; 8,209,152; 8,515,125; 8,825,454; 9,135,737; 8,670,961; 9,514,568; 8,818,770; 8,542,880; 9,244,589; 9,329,749; 9,599,466. Other Patents Pending.

Notes Diagram

Roof facets are labeled from smallest to largest (A to Z) for easy reference.

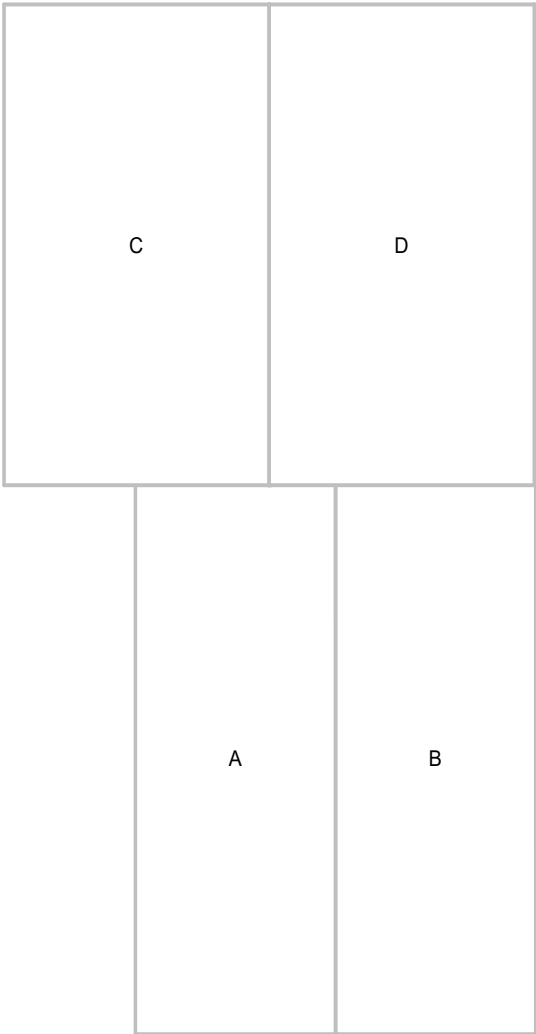

© 2025 Eagle View Technologies, Inc., All Rights Reserved.

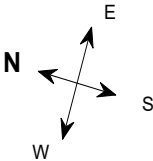



**Penetrations Notes Diagram**  
Penetrations are labeled from smallest to largest for easy reference.

Total Penetrations = 15

Total Penetrations Area = 15 sq ft

Total Penetrations Perimeter = 60 ft

Total Roof Area Less Penetrations = 10,186 sq ft

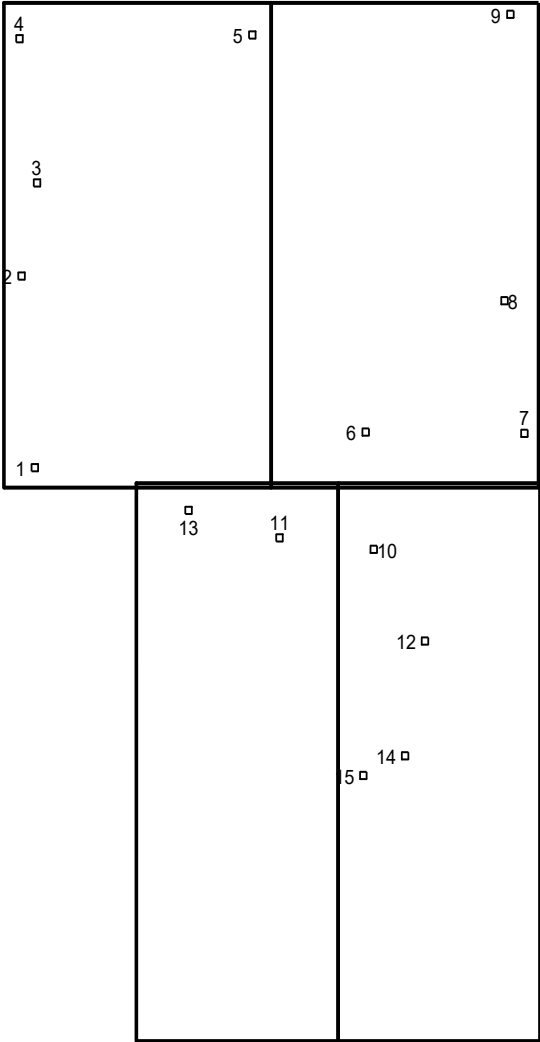

©2025 Eagle View Technologies, Inc., All Rights Reserved.

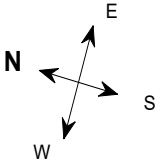

**Wall Area Diagram**

Total Wall Area = 8019.4 sq ft, with 8 facets.

Total Wall Area with Windows and Doors = 8,605 sq ft

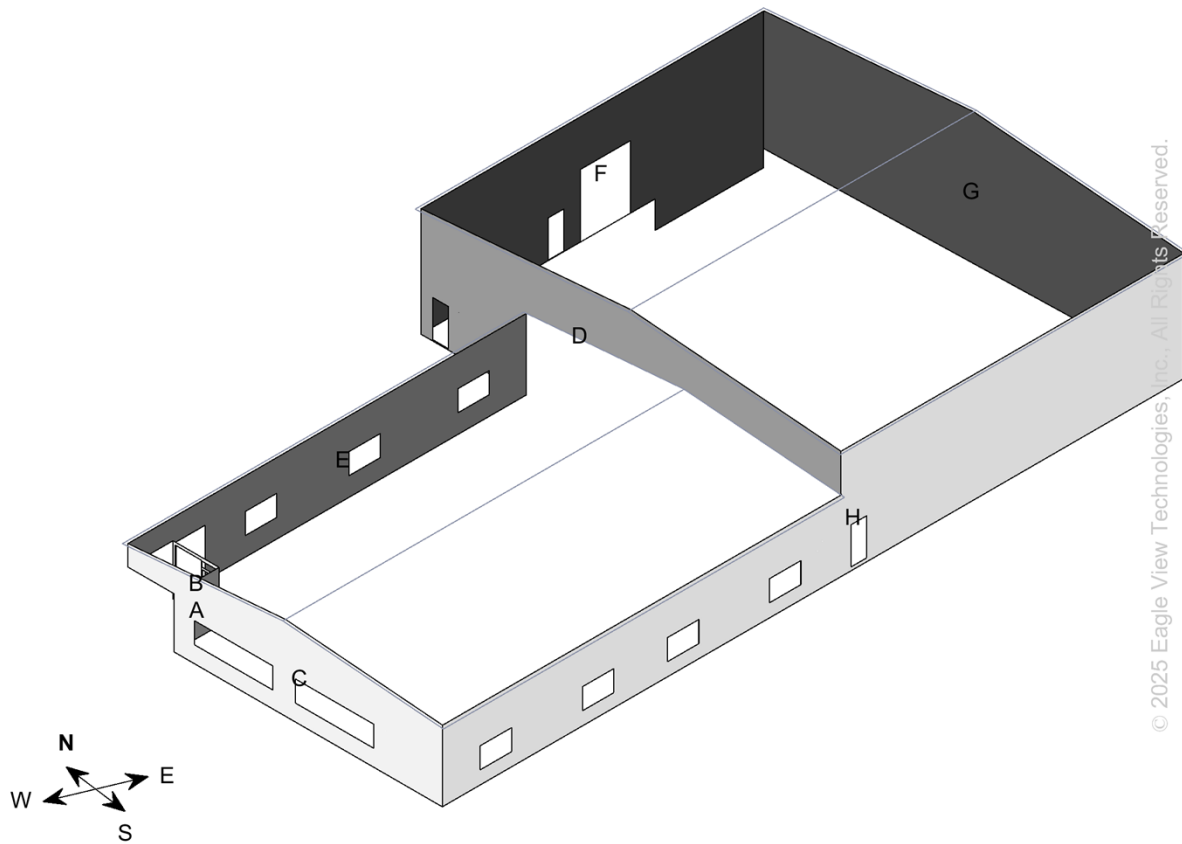

© 2025 Eagle View Technologies, Inc. All Rights Reserved.

**Wall Area by Direction**

<b><u>North</u></b>	<b><u>East</u></b>	<b><u>South</u></b>	<b><u>West</u></b>
A - 83.8 sq ft E - 829.2 sq ft F - 1331.1 sq ft	G - 1892.3 sq ft	H - 2279.7 sq ft	B - 18.8 sq ft C - 687.9 sq ft D - 896.1 sq ft
<b>2244.1 sq ft</b>	<b>1892.3 sq ft</b>	<b>2279.7 sq ft</b>	<b>1602.8 sq ft</b>

**Alternate Wall View**

Total Wall Area = 8019.4 sq ft, with 8 facets.

Total Wall Area with Windows and Doors = 8,605 sq ft

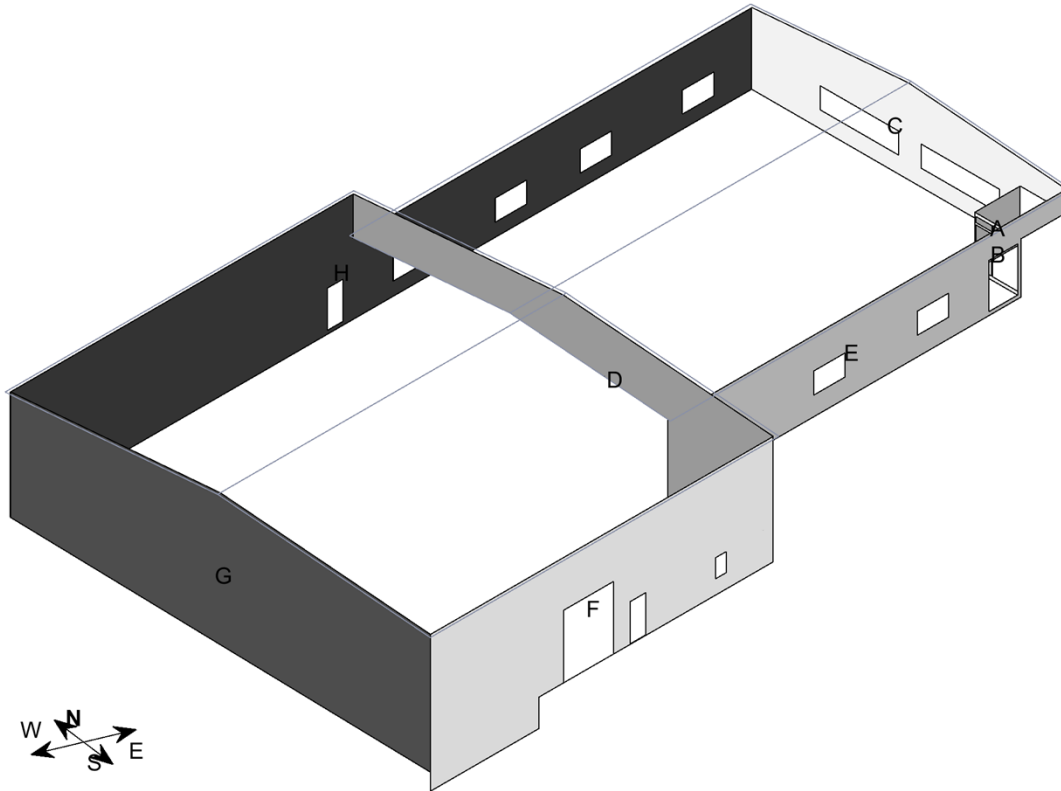

© 2025 Eagle View Technologies, Inc., All Rights Reserved.

**Wall Area by Direction**

<b><u>North</u></b>	<b><u>East</u></b>	<b><u>South</u></b>	<b><u>West</u></b>
A - 83.8 sq ft E - 829.2 sq ft F - 1331.1 sq ft	G - 1892.3 sq ft	H - 2279.7 sq ft	B - 18.8 sq ft C - 687.9 sq ft D - 896.1 sq ft
<b>2244.1 sq ft</b>	<b>1892.3 sq ft</b>	<b>2279.7 sq ft</b>	<b>1602.8 sq ft</b>

Window and Door Diagram

Total Window and Door Area = 586 sq ft, with 18 windows and doors

Total Window and Door Perimeter = 413 ft

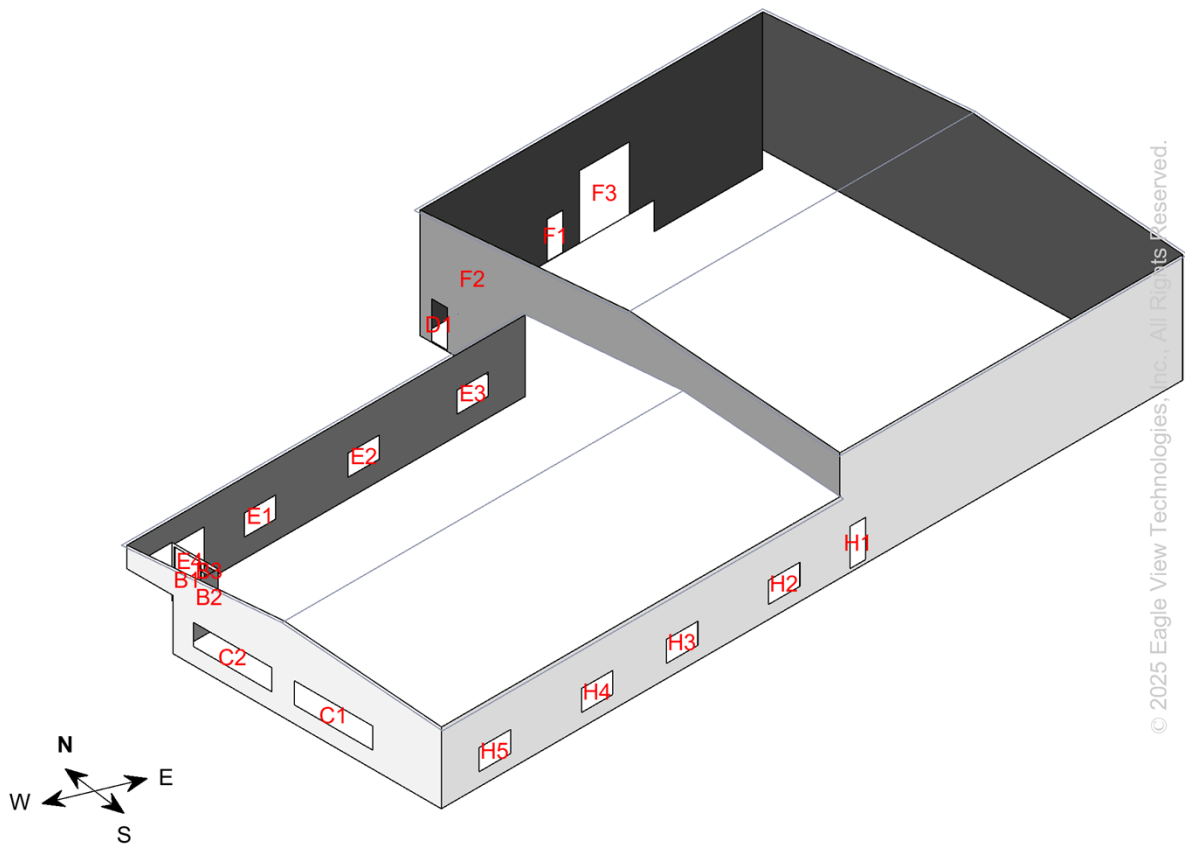

Window and Door Measurements

North	East	South	West
E1 - 24 sq ft E2 - 24 sq ft E3 - 24 sq ft E4 - 46.7 sq ft F1 - 21 sq ft F2 - 7 sq ft F3 - 114.4 sq ft		H1 - 21 sq ft H2 - 24 sq ft H3 - 24 sq ft H4 - 24 sq ft H5 - 24 sq ft	B1 - 42.5 sq ft B2 - 21 sq ft B3 - 3 sq ft C1 - 60 sq ft C2 - 60 sq ft D1 - 21 sq ft
261.1 sq ft	0 sq ft	117 sq ft	207.5 sq ft

North Elevation Diagram

Top of Walls = 151 ft

Bottom of Walls = 151 ft

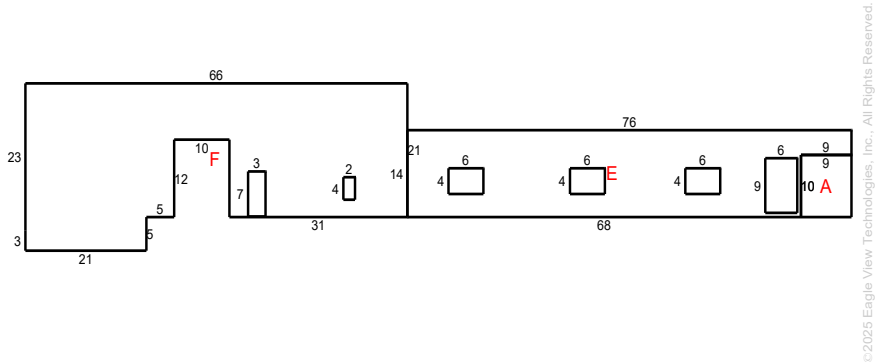

North Elevation Details

Wall	Wall Area	Window & Door Area	Window & Door Perimeter	Window & Door Count
A	83.8	0.0	0.0	0
E	829.2	118.7	88.0	4
F	1331.1	142.4	74.0	3
Total	2244.1 sq ft	261.1 sq ft	162 ft	7

**Note:** On-site verification of yellow shaded areas is needed. Details are on the Wall Report Summary Page. This diagram shows segment lengths rounded to the nearest whole number. The window & door and wall area in square feet (rounded to the nearest tenth) is based on the actual (non-rounded) value of each segment length.



East Elevation Diagram

Top of Walls = 81 ft

Bottom of Walls = 81 ft

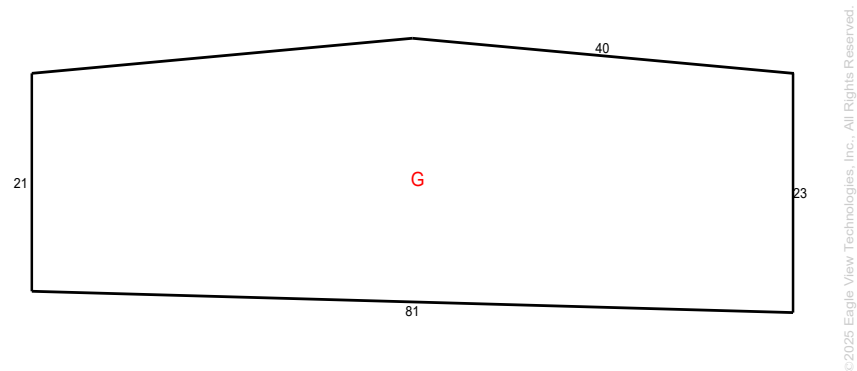

East Elevation Details

Wall	Wall Area	Window & Door Area	Window & Door Perimeter	Window & Door Count
G	1892.3	0.0	0.0	0
Total	1892.3 sq ft	0 sq ft	0 ft	0

**Note:** On-site verification of yellow shaded areas is needed. Details are on the Wall Report Summary Page. This diagram shows segment lengths rounded to the nearest whole number. The window & door and wall area in square feet (rounded to the nearest tenth) is based on the actual (non-rounded) value of each segment length.

**South Elevation Diagram**

Top of Walls = 143 ft

Bottom of Walls = 142 ft

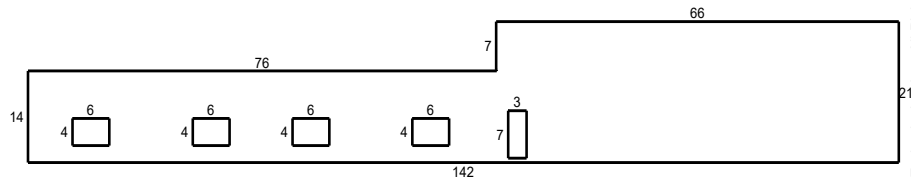
**South Elevation Details**

Wall	Wall Area	Window & Door Area	Window & Door Perimeter	Window & Door Count
H	2279.7	117.0	100.0	5
<b>Total</b>	<b>2279.7 sq ft</b>	<b>117 sq ft</b>	<b>100 ft</b>	<b>5</b>

**Note: On-site verification of yellow shaded areas is needed. Details are on the Wall Report Summary Page.** This diagram shows segment lengths rounded to the nearest whole number. The window & door and wall area in square feet (rounded to the nearest tenth) is based on the actual (non-rounded) value of each segment length.



Report: 63969118

© 2008-2025 Eagle View Technologies, Inc. and Pictometry International Corp. – All Rights Reserved – Covered by one or more of U.S. Patent Nos. 8,078,436; 8,145,578; 8,170,840; 8,209,152; 8,515,125; 8,818,770; 8,542,880; 9,244,589; 9,329,749; 9,599,466. Other Patents Pending.

West Elevation Diagram

Top of Walls = 151 ft

Bottom of Walls = 150 ft

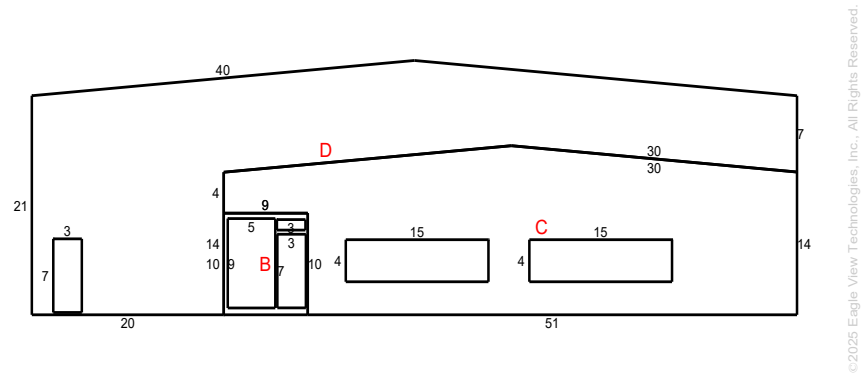

West Elevation Details

Wall	Wall Area	Window & Door Area	Window & Door Perimeter	Window & Door Count
B	18.8	66.5	55.0	3
C	687.9	120.0	76.0	2
D	896.1	21.0	20.0	1
Total	1602.8 sq ft	207.5 sq ft	151 ft	6

**Note:** On-site verification of yellow shaded areas is needed. Details are on the Wall Report Summary Page. This diagram shows segment lengths rounded to the nearest whole number. The window & door and wall area in square feet (rounded to the nearest tenth) is based on the actual (non-rounded) value of each segment length.

## Report Summary

Below is a measurement summary using the values presented in this report.

### All Structures

#### Areas per Pitch

Roof Pitches	1/12
Area (sq ft)	10200.2
% of Roof	100%

The table above lists each pitch on this roof and the total area and percent (both rounded) of the roof with that pitch.

#### Waste Calculation Table

Waste %	0%	10%	12%	15%	17%	20%	22%
Area (sq ft)	10,201	11221.1	11425.1	11731.2	11935.2	12241.2	12445.2
Squares	102.0	112.2	114.3	117.3	119.4	122.4	124.5

This table shows the total roof area and squares (rounded up to the nearest decimal) based upon different waste percentages. The waste factor is subject to the complexity of the roof, individual roofing techniques and your experience. Please consider this when calculating appropriate waste percentages. Note that only roof area is included in these waste calculations. Additional materials needed for ridge, hip, valley, and starter lengths are not included.

Penetrations	1-15									
Area (sq ft)	1									
Perimeter (ft)	4									

Any measured penetration smaller than 3x3 feet may need field verification. Accuracy is not guaranteed. The total penetration area is not subtracted from the total roof area.

### All Structures Totals

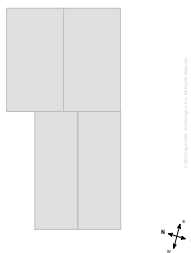

Total Roof Facets = 4  
Total Penetrations = 15

#### Lengths, Areas and Pitches

Ridges = 144 ft (2 Ridges)  
Hips = 0 ft (0 Hips).  
Valleys = 0 ft (0 Valleys)  
Rakes † = 226 ft (6 Rakes)  
Eaves/Starter ‡ = 288 ft (4 Eaves)  
Drip Edge (Eaves + Rakes) = 514 ft (10 Lengths)  
Parapet Walls = 0 (0 Lengths).  
Flashing = 0 ft (0 Lengths)  
Step flashing = 62 ft (2 Lengths)  
Total Penetrations Area = 15 sq ft  
Total Roof Area Less Penetrations = 10,186 sq ft  
Total Penetrations Perimeter = 60 ft  
Predominant Pitch = 1/12  
**Total Area (All Pitches) = 10,201 sq ft**

#### Property Location

Longitude = -86.6912342  
Latitude = 36.2814614

#### Notes

This was ordered as a commercial property. There were no changes to the structure in the past four years.

† Rakes are defined as roof edges that are sloped (not level).  
‡ Eaves are defined as roof edges that are not sloped and level.

**Online Maps**

Online map of property

[http://maps.google.com/maps?f=g&source=s\\_q&hl=en&geocode=&q=533+Myatt+Dr,Madison,TN,37115](http://maps.google.com/maps?f=g&source=s_q&hl=en&geocode=&q=533+Myatt+Dr,Madison,TN,37115)

Directions from Wright Fire & Forensics, LLC to this property

[http://maps.google.com/maps?f=d&source=s\\_d&saddr=401+S+Mount+Juliet+Rd,Suite+235-313,Mt+Juliet,TN,37122-6359&daddr=533+Myatt+Dr,Madison,TN,37115](http://maps.google.com/maps?f=d&source=s_d&saddr=401+S+Mount+Juliet+Rd,Suite+235-313,Mt+Juliet,TN,37122-6359&daddr=533+Myatt+Dr,Madison,TN,37115)

Enclosed is your ClaimsReady report. Please click the link to supplement your report with a walls report that includes areas of facets and cut-outs, line lengths, a notes diagram, and waste table calculations. [Request a walls report.](#)



Report: 63969118

© 2008-2025 Eagle View Technologies, Inc. and Pictometry International Corp. – All Rights Reserved – Covered by one or more of U.S. Patent Nos. 8,078,436; 8,145,578; 8,170,840; 8,209,152; 8,515,125; 8,825,454; 9,135,737; 8,670,961; 9,514,568; 8,818,770; 8,542,880; 9,244,589; 9,329,749; 9,599,466. Other Patents Pending.



## Wall Report Summary

Below is a measurement summary using the values presented in this report.

**Wall Area Waste Calculation Table** (excluding windows and doors)

Waste %	0%	10%	11%	12%	13%	14%	15%	20%
Area (sq ft)	8019.4	8821.3	8901.5	8981.7	9061.9	9142.1	9222.3	9623.3
Squares	80.2	88.2	89.0	89.8	90.6	91.4	92.2	96.2

This table shows the total wall area excluding windows and doors, based upon different waste percentages. The waste factor is subject to the complexity of the structure, image quality, siding techniques and your experience. Please consider this when calculating appropriate waste percentages. Note that only the wall area is included in these waste calculations. Accessories may require additional material.

### Report Comments

**Due to obstructions in available images of this property, please verify measurements on portion of structure highlighted in yellow.**

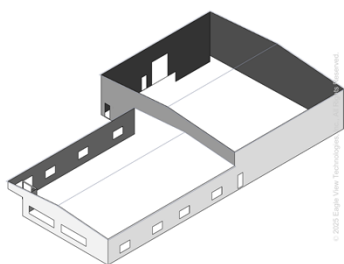

### Total Lengths & Areas

Wall Area = 8019.4 sq ft  
 Wall Area with Windows and Doors = 8,605 sq ft  
 Top of Walls = 524 ft  
 Bottom of Walls = 523 ft  
 Inside Corners = 32 ft  
 Outside Corners = 109 ft  
 Inside Corners > 90° = 0 ft  
 Outside Corners > 90° = 0 ft  
 Window and Door Area = 586 sq ft  
 Window and Door Perimeter = 413 ft

Total Wall Facets = 8

Total Windows and Doors = 18

Enclosed is your ClaimsReady report. Please click the link to supplement your report with a walls report that includes areas of facets and cut-outs, line lengths, a notes diagram, and waste table calculations. [Request a walls report.](#)

Wall measurements should be field verified to confirm accuracy. Wall areas assume that flat soffits exist at the eaves. If sloped soffits are present, wall height and wall area measurements will likely be off.



Report: 63969118

© 2008-2025 Eagle View Technologies, Inc. and Pictometry International Corp. – All Rights Reserved – Covered by one or more of U.S. Patent Nos. 8,078,436; 8,145,578; 8,170,840; 8,209,152; 8,515,125; 8,825,454; 9,135,737; 8,670,961; 9,514,568; 8,818,770; 8,542,880; 9,244,589; 9,329,749; 9,599,466. Other Patents Pending.

## Important Legal Notice and Disclaimer

### Notice and Disclaimer

No Warranty: The Copyrighted Materials are provided to you "as is," and you agree to use it at your own risk.

EagleView Technologies makes no guarantees, representations or warranties of any kind, express or implied, arising by law or otherwise, including but not limited to, content, quality, accuracy, completeness, effectiveness, reliability, fitness for a particular purpose, usefulness, use or results to be obtained from the Copyrighted Materials.

Contractors agree to always conduct a preliminary site survey to verify Roof Report ordered. In the event of an error in a Report, your sole remedy will be a refund of the fees paid by you to obtain this Report.

