



FOR LEASE—Eastside Industrial Space

1011 Hawkins, Suite A, El Paso, TX 79915

PROPERTY DESCRIPTION

- Office/Warehouse with a storage yard
- Great Corner Location with easy I-10 Access
- Clear Height approx. 19'
- 2 Docks
- 3 Phase Power
- Grade level entrances

LEASE INFORMATION

- Side A 14,200 SF with up to .37 acres of outdoor storage
- Side B 19,600 SF with up to .63 acres of outdoor storage
- Full Building of 33,800 SF also available
- NNN lease price negotiable
- 5+ Year lease preferred

AREA INFORMATION



AREA ATTRACTIONS



DEMOGRAPHICS (2015)

	1 mi	3 mi	5 mi
Population	7,257	100,010	223,859
Avg HH Income	\$48,520	\$46,155	\$47,878

For more information please contact:

Becca McBroom

915-613-5376 Direct

McBroom.Becca@gmail.com

JMT PROPERTIES, INC

FLOOR PLAN

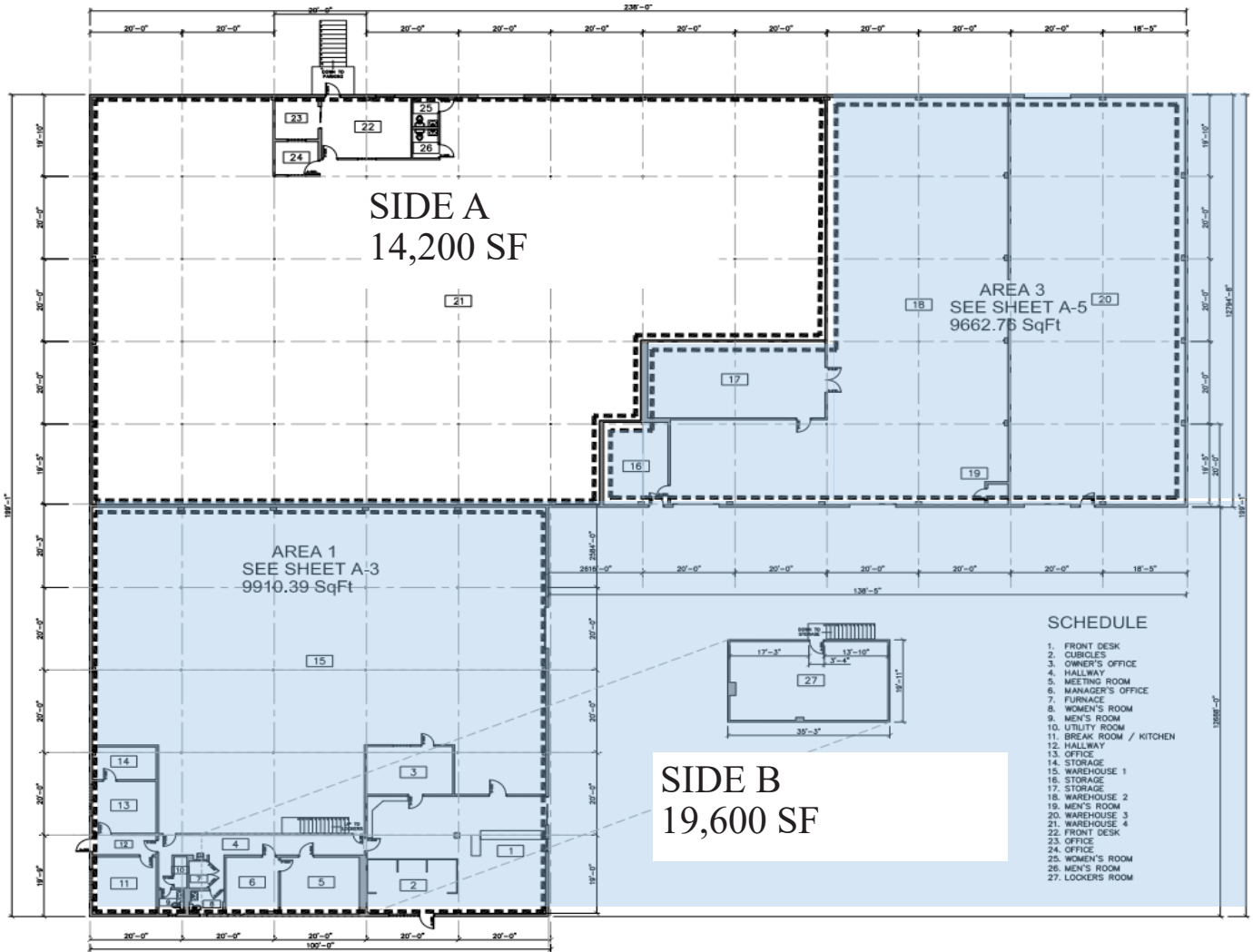

For more information please contact:

Becca McBroom

915-613-5376 Direct

McBroom.Becca@gmail.com

JMT PROPERTIES, INC