



FOR LEASE

1,500 SF OFFICE SPACE FOR SUBLEASE

303 SW 18th Street | Bentonville, AR 72712

Property Highlights

- Suite 15
 - 1,500 SF available
- \$17.50/SF MG
- Sublease through July 31, 2027
- Turn-key office space
- 4 offices, 2 storage closets, open area for professional use, 1 private restroom
- Steps away from Osage Park's trails, food trucks, pickleball courts, dog parks, and more

For more information, please contact:

Johnny Galloway

713 203 5491

jgalloway@sagepartners.com

Olivia Funderburk

417 818 6875

ofunderburk@sagepartners.com

Marshall Saviers

479 845 3042

mtsaviers@sagepartners.com

479 845 3000

[sagepartners.com](https://www.sagepartners.com)

*information deemed reliable but not guaranteed

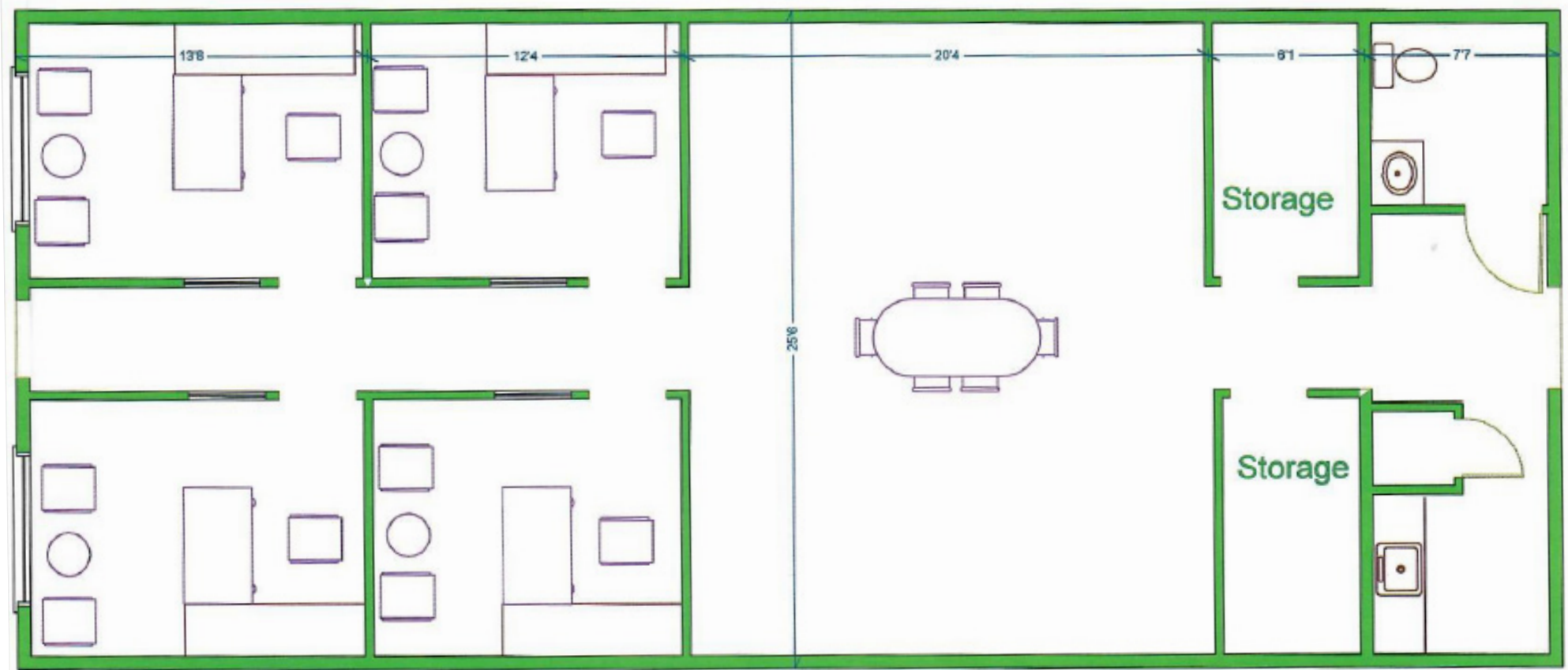





Walmart 
Global Headquarters



SUBJECT PROPERTY

OSAGE
PARK

Bentonville Municipal Airport

sam's club 
Home Office



**NORTHWEST
HEALTH**