

FOR LEASE

SHOPPERS SQUARE

31712-31724 CASINO DRIVE | LAKE ELSINORE, CA



CASINO DRIVE
±7,205 CPD







JANET F. KRAMER, JD, CCIM
951.600.8634 x702
janetk@svn.com
CalDRE #01351570

STEVE CASTELLANOS
951.600.8634 x703
stevec@svn.com
CalDRE #01922901

PROPERTY SUMMARY

SHOPPERS SQUARE | 31712-31724 CASINO DRIVE | LAKE ELSINORE, CA



-  Retail Suites Available Now; Dedicated Freeway Signage!
-  Former Italian Restaurant Coming Soon!
-  Fully fixtured restaurant with a grease interceptor
-  Pad Available for Ground Lease - Drive-Thru Potential
-  Pad Lease Rate Negotiable
-  Asking \$1.50 PSF
-  Excellent Freeway Visibility



JANET F. KRAMER, JD, CCIM
 951.600.8634 x702
 janetk@svn.com
 CaDRE #01351570

STEVE CASTELLANOS
 951.600.8634 x703
 stevec@svn.com
 CaDRE #01922901



PROPERTY SUMMARY

SHOPPERS SQUARE | 31712-31724 CASINO DRIVE | LAKE ELSINORE, CA

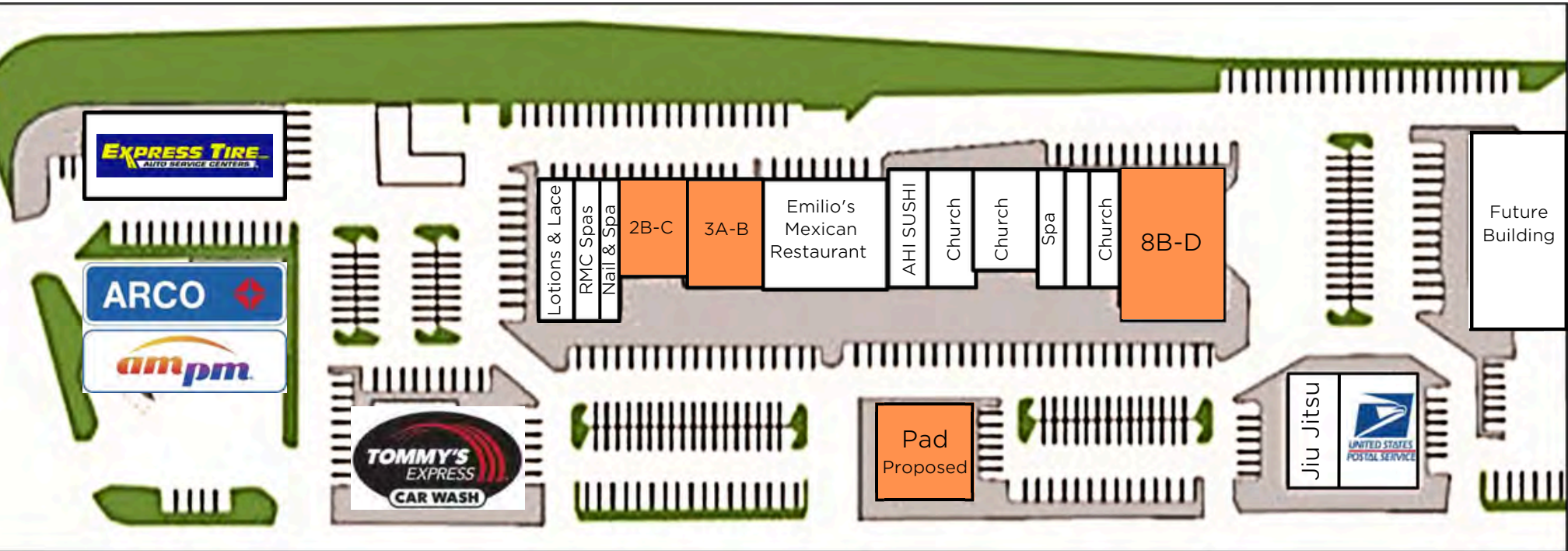

SUITE	TENANT	SF
1A-B	LOTIONS & LACE	±3,600
1C	RMC SPAS	±1,800
2A	NAIL & SPA	±1,000
2B-C	VACANT	±2,000
3A-B	COMING SOON	±4,200
4A-B	EMILIO'S	±6,730
5A	AHI SUSHI	±1,900

SUITE	TENANT	SF
5B-C/6A-B-C/7B-C	CHURCH	±7,100
Pad	PROPOSED DRIVE-THRU	±3,000
7A	SPA SWAN	±1,400
8B-D	VACANT	±8,000
31724 - 101	USPS	±3,720
31724 - 102	JIU-JITSU	±3,475

JANET F. KRAMER, JD, CCIM
 951.600.8634 x702
 janetk@svn.com
 CaIDRE #01351570

STEVE CASTELLANOS
 951.600.8634 x703
 stevec@svn.com
 CaIDRE #01922901



DEMOGRAPHICS

SHOPPERS SQUARE | 31712-31724 CASINO DRIVE | LAKE ELSINORE, CA



- State** California
- County** Riverside
- Mayor** Steve Manos
- Website** lake-elsinore.org

POPULATION

Source: ESRI



48,123
POPULATION



34.4
MEDIAN AGE



14,669
HOUSEHOLDS

3-Mile Radius



EMPLOYMENT



56%
WHITE COLLAR



26%
BLUE COLLAR



21%
SERVICES



6%
UNEMPLOYMENT RATE

EDUCATION



27%

HIGH SCHOOL
GRADUATE



34%

SOME COLLEGE



24%

BACHELORS/GRAD/
PROF DEGREE

INCOME



\$82,043

MEDIAN HOUSEHOLD
INCOME



\$32,250

PER CAPITA
INCOME



\$171,181

MEDIAN NET
WORTH

JANET F. KRAMER, JD, CCIM
951.600.8634 x702
janetk@svn.com
CaIDRE #01351570

STEVE CASTELLANOS
951.600.8634 x703
stevec@svn.com
CaIDRE #01922901

