

FOR LEASE | FALCON CORPORATE CENTER

4711 E Falcon Drive | Mesa, AZ 85215



LEASE RATE: \$18 PSF + Modified Gross

Joan Krueger | joan.krueger@naihonorizon.com | 602 393 6727

Troy Giammarco | troy.giammarco@naihonorizon.com | 602 393 6693

2944 N 44th Street, Suite 200 | Phoenix, AZ 85018 | 602 955 4000 | naihonorizon.com

All information furnished regarding property for sale, rental or financing is from sources deemed reliable, but no warranty or representation is made to the accuracy thereof and same is submitted subject to errors, omissions, change of price, rental or other conditions prior to sale, lease or financing or withdraw without notice. No liability of any kind is to be imposed on the broker herein.



Property Information

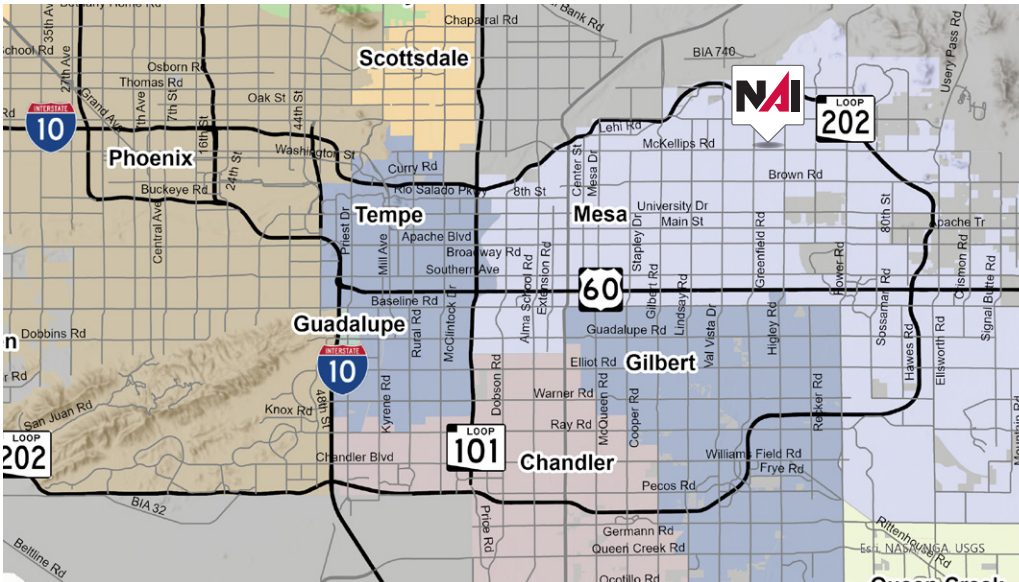

Location: 4711 E Falcon Dr | Mesa, AZ 85215

Available Sizes: 542 SF - 2,011 SF

Lease Rate: \$18 PSF + Modified Gross

Zoning: M-1

Year Built: 1978

Building Class: B

APN #: 141-36-001E

Property Features

- Well-maintained asset with recent capital upgrades completed
- Community kitchen area with refrigerator, microwave and seating
- Conveniently located adjacent to Falcon Field Airport
- Minutes to Loop 202, SR-60, Loop 101 with connecting access to I-10 & I-17 Highways
- City of Mesa land lease meets requirement for Falcon Field Airport use/access

Demographics	1 Mile	3 Miles	5 Miles
Population	5,250	79,489	210,157
Average Age	45.3	45.5	44.3
Average HH Income	\$112,536	\$121,133	\$111,085
Employed Population	2,405	37,553	97,923

Traffic Counts	VPD
N 48th St	1,400
E McKellips Rd	42,626

Joan Krueger | joan.krueger@naihormon.com | 602 393 6727

Troy Giammarco | troy.giammarco@naihormon.com | 602 393 6693

2944 N 44th Street, Suite 200 | Phoenix, AZ 85018 | 602 955 4000 | naihormon.com

All information furnished regarding property for sale, rental or financing is from sources deemed reliable, but no warranty or representation is made to the accuracy thereof and same is submitted subject to errors, omissions, change of price, rental or other conditions prior to sale, lease or financing or withdraw without notice. No liability of any kind is to be imposed on the broker herein.



Suite Photos | 152 & 201



Joan Krueger | joan.krueger@naihorizon.com | 602 393 6727

Troy Giammarco | troy.giammarco@naihorizon.com | 602 393 6693

2944 N 44th Street, Suite 200 | Phoenix, AZ 85018 | 602 955 4000 | naihorizon.com

All information furnished regarding property for sale, rental or financing is from sources deemed reliable, but no warranty or representation is made to the accuracy thereof and same is submitted subject to errors, omissions, change of price, rental or other conditions prior to sale, lease or financing or withdraw without notice. No liability of any kind is to be imposed on the broker herein.



Suite Photos | 322



Joan Krueger | joan.krueger@naihonorizon.com | 602 393 6727

Troy Giammarco | troy.giammarco@naihonorizon.com | 602 393 6693

2944 N 44th Street, Suite 200 | Phoenix, AZ 85018 | 602 955 4000 | naihonorizon.com

All information furnished regarding property for sale, rental or financing is from sources deemed reliable, but no warranty or representation is made to the accuracy thereof and same is submitted subject to errors, omissions, change of price, rental or other conditions prior to sale, lease or financing or withdraw without notice. No liability of any kind is to be imposed on the broker herein.



1st Floor Site Plan

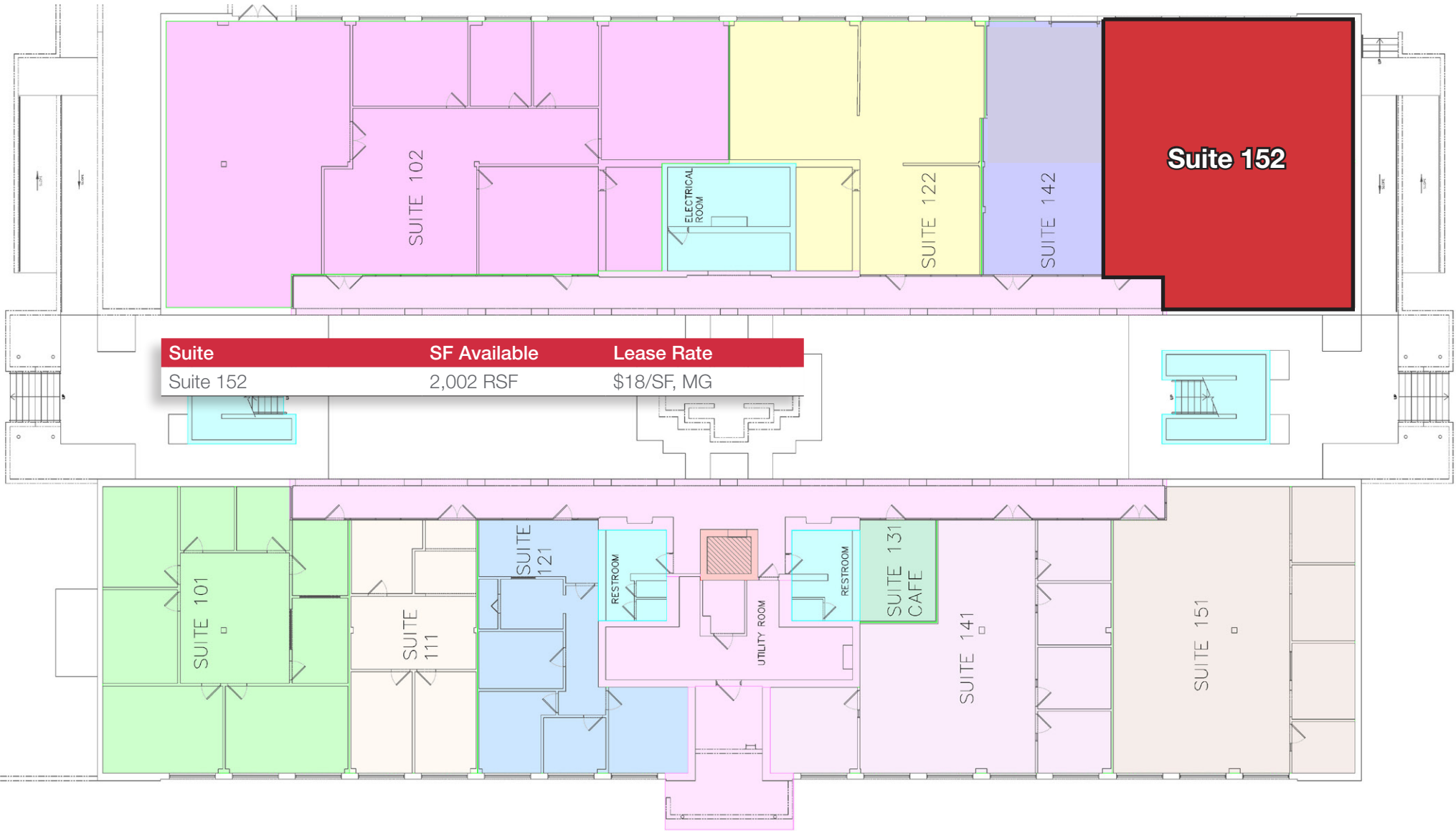

Joan Krueger | joan.krueger@naihorizon.com | 602 393 6727

Troy Giammarco | troy.giammarco@naihorizon.com | 602 393 6693

2944 N 44th Street, Suite 200 | Phoenix, AZ 85018 | 602 955 4000 | naihorizon.com

All information furnished regarding property for sale, rental or financing is from sources deemed reliable, but no warranty or representation is made to the accuracy thereof and same is submitted subject to errors, omissions, change of price, rental or other conditions prior to sale, lease or financing or withdraw without notice. No liability of any kind is to be imposed on the broker herein.



2nd Floor Site Plan



Joan Krueger | joan.krueger@naihorizon.com | 602 393 6727

Troy Giammarco | troy.giammarco@naihorizon.com | 602 393 6693

2944 N 44th Street, Suite 200 | Phoenix, AZ 85018 | 602 955 4000 | naihorizon.com

All information furnished regarding property for sale, rental or financing is from sources deemed reliable, but no warranty or representation is made to the accuracy thereof and same is submitted subject to errors, omissions, change of price, rental or other conditions prior to sale, lease or financing or withdraw without notice. No liability of any kind is to be imposed on the broker herein.



3rd Floor Site Plan

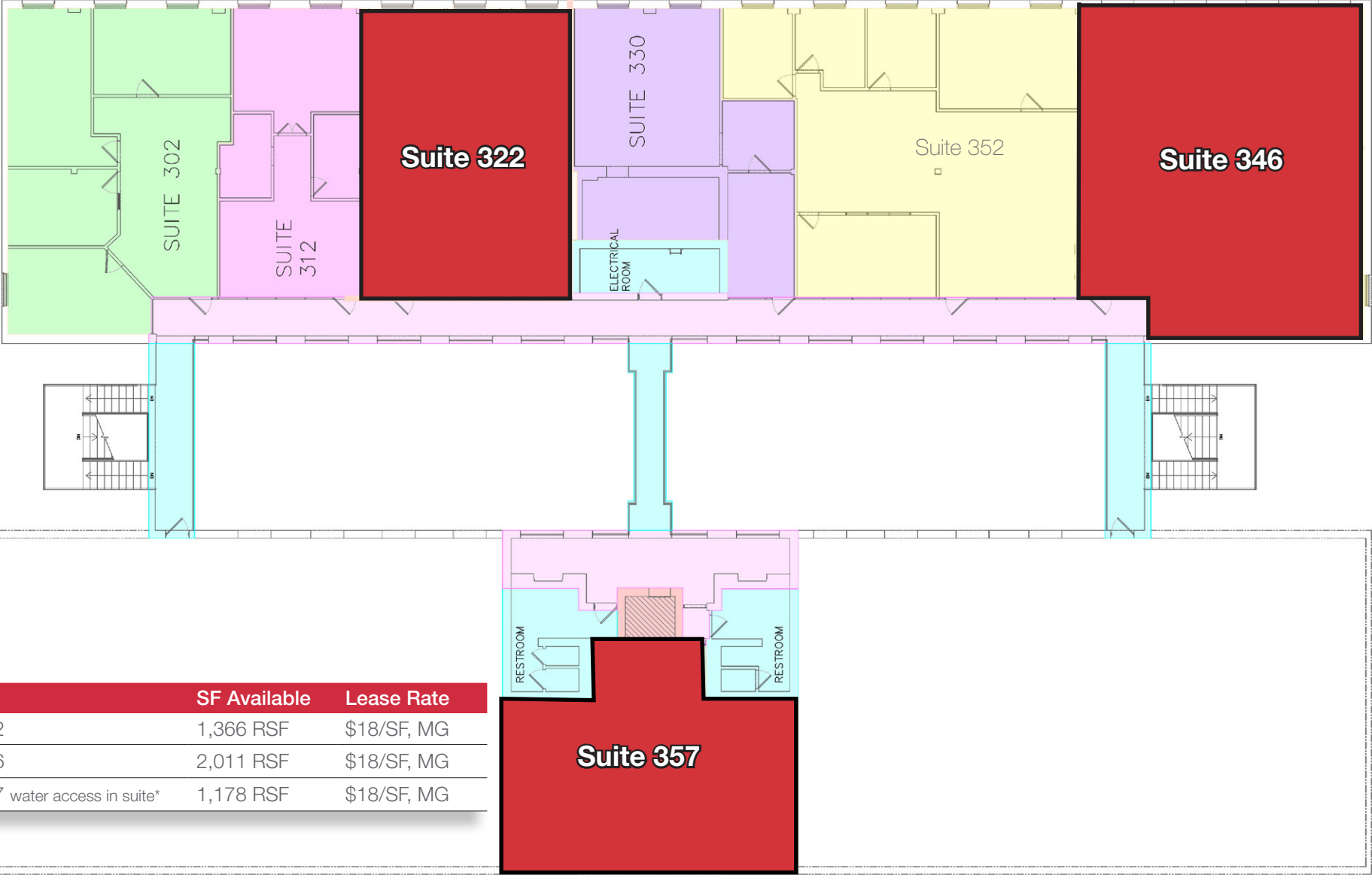

Suite	SF Available	Lease Rate
Suite 322	1,366 RSF	\$18/SF, MG
Suite 346	2,011 RSF	\$18/SF, MG
Suite 357 water access in suite*	1,178 RSF	\$18/SF, MG

Joan Krueger | joan.krueger@naihonorizon.com | 602 393 6727

Troy Giammarco | troy.giammarco@naihonorizon.com | 602 393 6693

2944 N 44th Street, Suite 200 | Phoenix, AZ 85018 | 602 955 4000 | naihonorizon.com

All information furnished regarding property for sale, rental or financing is from sources deemed reliable, but no warranty or representation is made to the accuracy thereof and same is submitted subject to errors, omissions, change of price, rental or other conditions prior to sale, lease or financing or withdraw without notice. No liability of any kind is to be imposed on the broker herein.



Aerial Map



20-04-037

Joan Krueger | joan.krueger@naihonorizon.com | 602 393 6727

Troy Giammarco | troy.giammarco@naihonorizon.com | 602 393 6693

2944 N 44th Street, Suite 200 | Phoenix, AZ 85018 | 602 955 4000 | naihonorizon.com

All information furnished regarding property for sale, rental or financing is from sources deemed reliable, but no warranty or representation is made to the accuracy thereof and same is submitted subject to errors, omissions, change of price, rental or other conditions prior to sale, lease or financing or withdraw without notice. No liability of any kind is to be imposed on the broker herein.

