

# FOR SALE

1120 E ASH AVE, FULLERTON

±5,600 SF INDUSTRIAL BUILDING



## PROPERTY FEATURES

- ±5,600 SF Industrial Building
- ±350 SF Office Space
- ±11,983 SF (±0.23 AC) Parcel Size
- Two (2) GL Doors
- ±15' Ceiling Height
- 200 Amps Power - Buyer to Verify
- Fenced Yard Possible
- Built 1961
- **Asking — \$1,988,000**

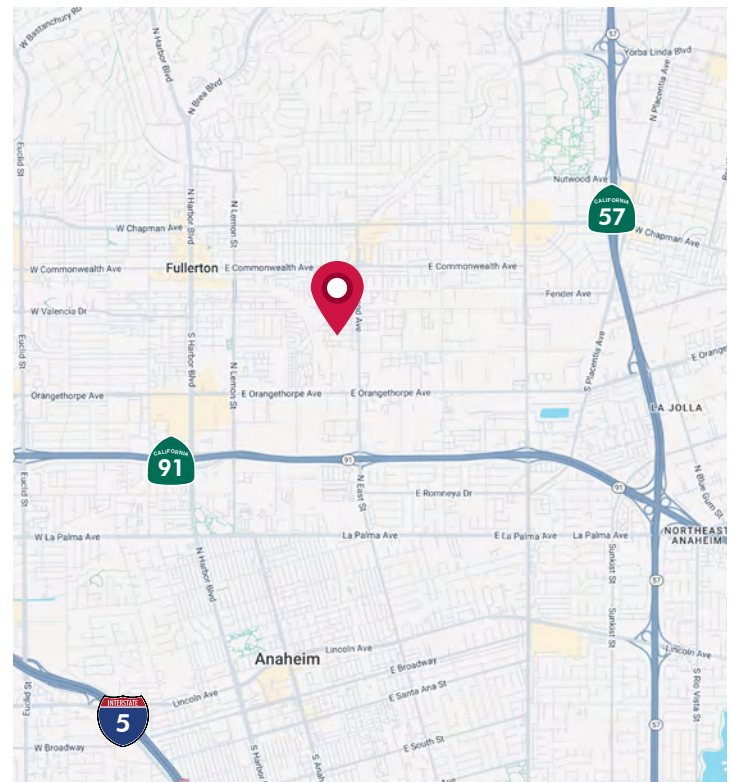

DALE CAMERA  
Senior Vice President  
License ID# 01313921  
949.790.3132  
dcamera@leeirvine.com

JASON HELMICK  
Senior Vice President  
License ID# 01786729  
949.790.3119  
jhelmick@leeirvine.com

ZACH SCHWANER  
Senior Vice President  
License ID# 02009623  
949.790.3159  
zschwaner@leeirvine.com

DYLAN DAVEY  
Associate  
License ID# 02219560  
949.790.3162  
ddavey@leeirvine.com

**LEE & ASSOCIATES**  
COMMERCIAL REAL ESTATE SERVICES

**ORANGE COUNTY INDUSTRIAL**

# FOR SALE

1120 E ASH AVE, FULLERTON

±5,600 SF INDUSTRIAL BUILDING

## SITE PLAN

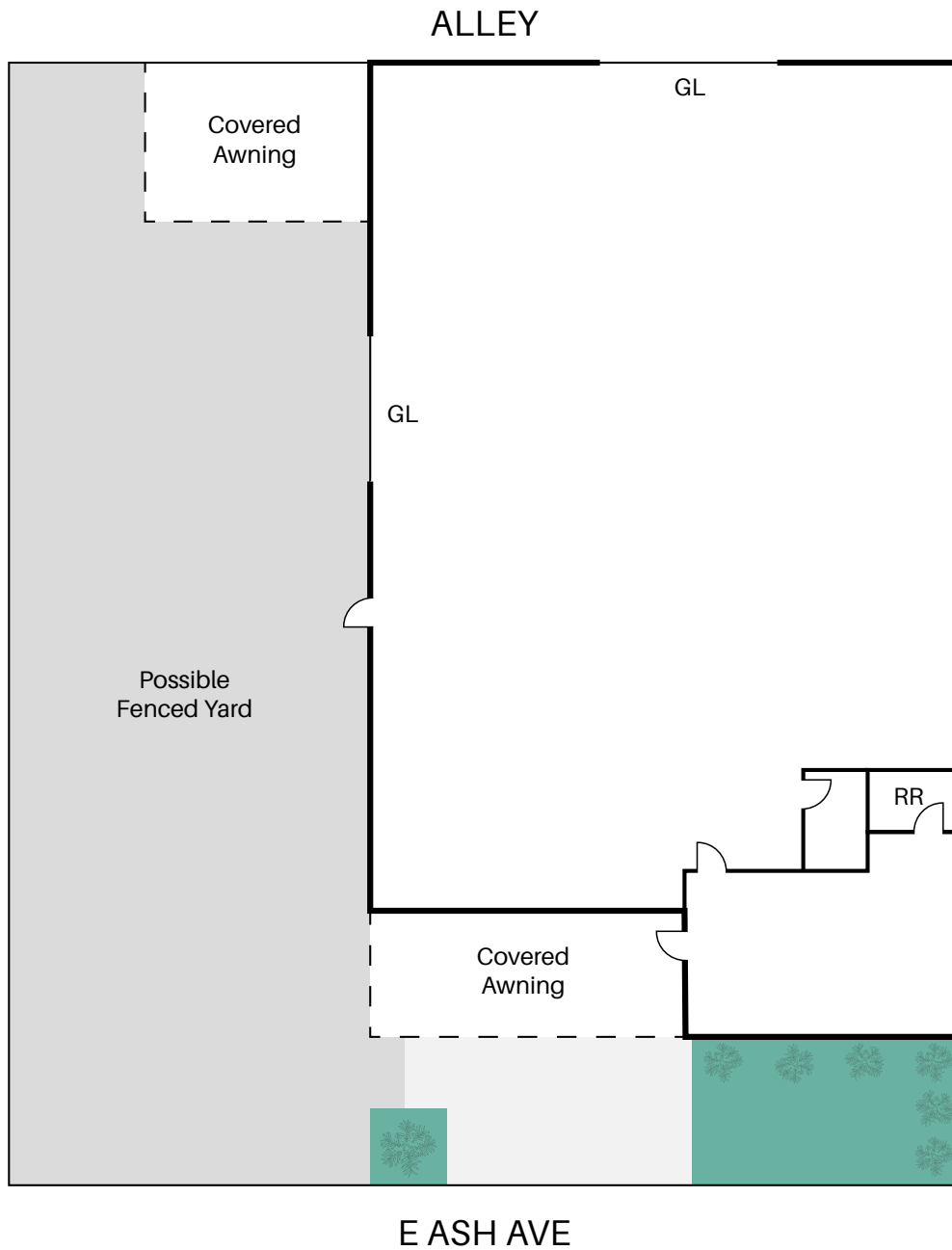

DALE CAMERA  
Senior Vice President  
License ID# 01313921  
949.790.3132  
dcamera@leeirvine.com

JASON HELMICK  
Senior Vice President  
License ID# 01786729  
949.790.3119  
jhelmick@leeirvine.com

ZACH SCHWANER  
Senior Vice President  
License ID# 02009623  
949.790.3159  
zschwaner@leeirvine.com

DYLAN DAVEY  
Associate  
License ID# 02219560  
949.790.3162  
ddavey@leeirvine.com





# FOR SALE

1120 E ASH AVE, FULLERTON

±5,600 SF INDUSTRIAL BUILDING

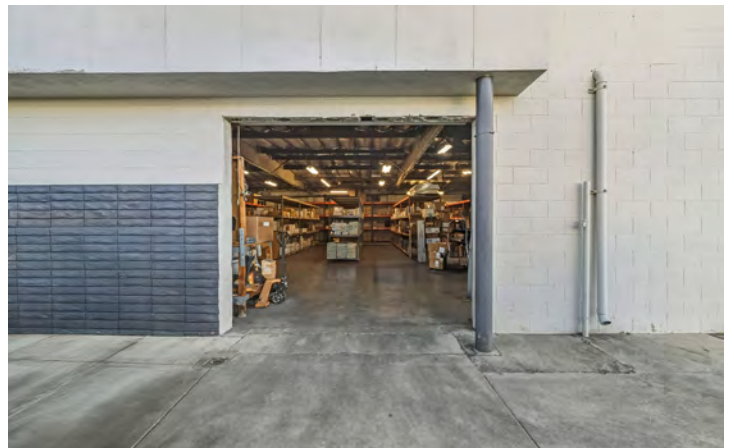

**DALE CAMERA**  
Senior Vice President  
License ID# 01313921  
949.790.3132  
dcamera@leeirvine.com

**JASON HELMICK**  
Senior Vice President  
License ID# 01786729  
949.790.3119  
jhelmick@leeirvine.com

**ZACH SCHWANER**  
Senior Vice President  
License ID# 02009623  
949.790.3159  
zschwaner@leeirvine.com

**DYLAN DAVEY**  
Associate  
License ID# 02219560  
949.790.3162  
ddavey@leeirvine.com

**LEE & ASSOCIATES**  
COMMERCIAL REAL ESTATE SERVICES

**ORANGE COUNTY INDUSTRIAL**