



## For Lease

1401-1515 S. Santa Fe Avenue  
Chanute, Kansas

### Property Features

- 8,400-19,800 SF junior boxes available
- Dominant shopping center within a 40-mile radius
- Co-tenants include Tractor Supply, Bealls, Factory Connection, McDonald's, and Scooter's
- Strong visibility to 15,000 cars per day
- Ample parking
- Potential pad sites

### Demographics



#### Total Population

5-mile: 10,155  
10-mile: 12,532  
20-mile: 29,004



#### Daytime Population

5-mile: 11,508  
10-mile: 13,210  
20-mile: 29,001



#### Household Income (Avg.)

5-mile: \$69,390  
10-mile: \$70,785  
20-mile: \$70,570

**Chris Newkirk**  
Vice President  
+1 816 556 1180  
chris.newkirk@colliers.com

**Colliers Kansas City**  
4900 Main Street, Suite 400  
Kansas City, Missouri 64112  
+1 816 531 5303  
colliers.com/kansascity

# Site Aerial

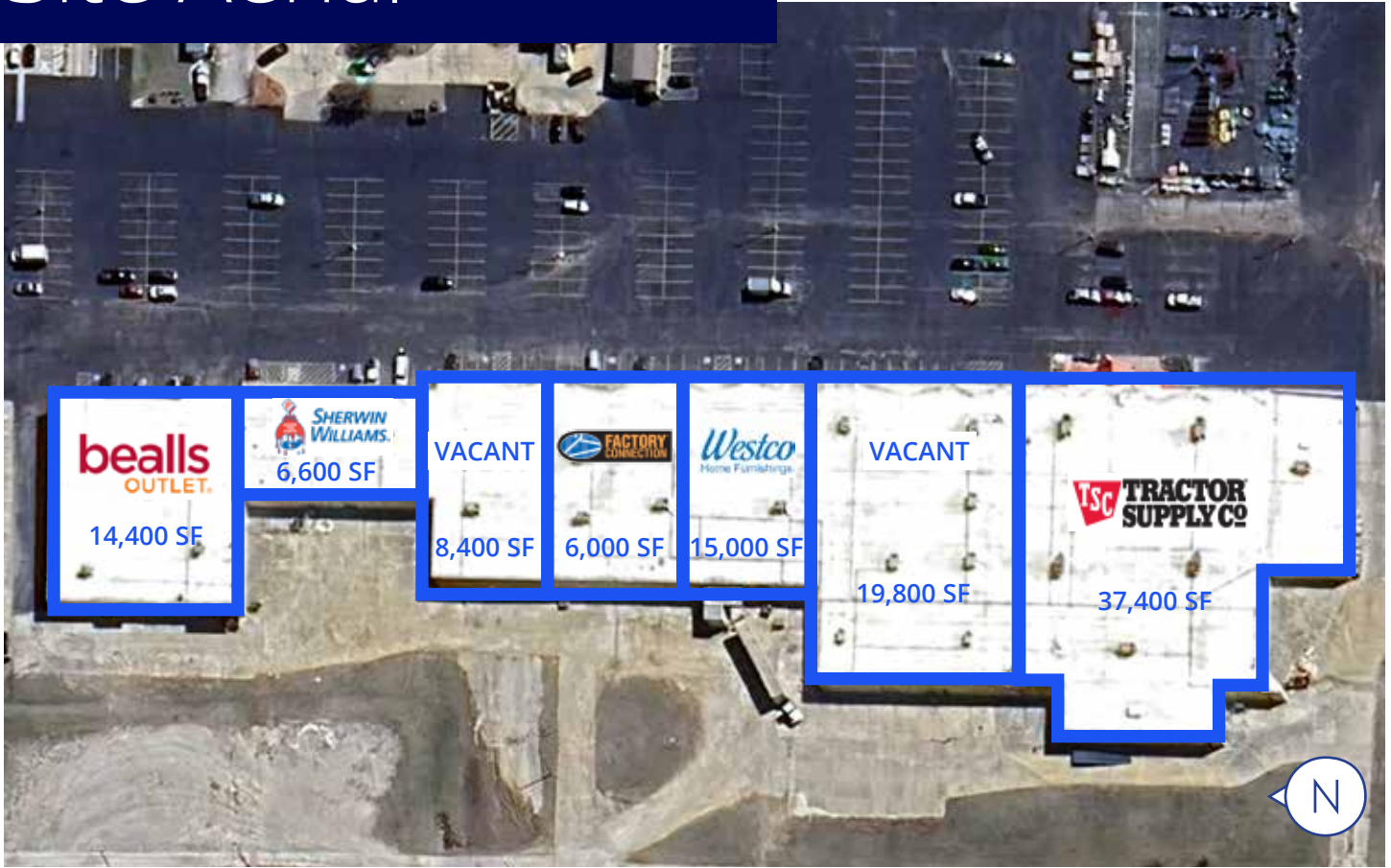

# Aerials

1401 S. Santa Fe Avenue | For Lease

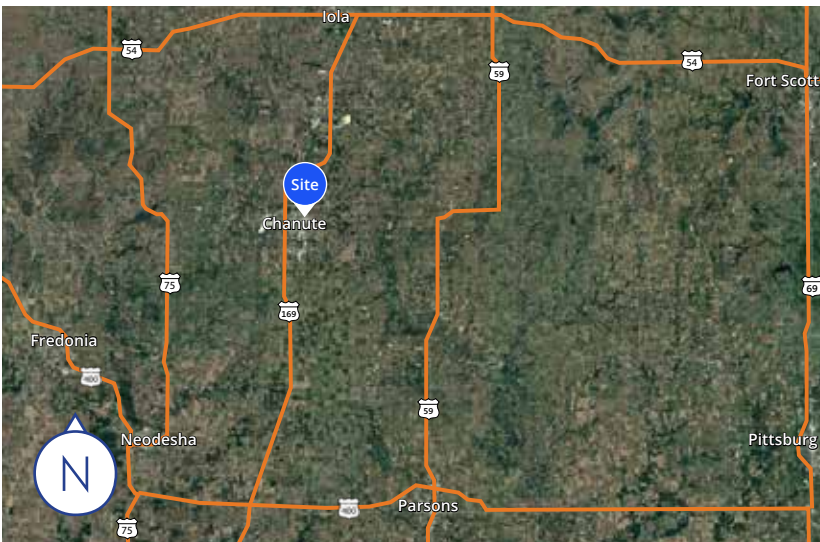

19,800 SF Available



8,400 SF Available



**Chris Newkirk**  
Vice President  
+1 816 556 1180  
chris.newkirk@colliers.com

**Colliers Kansas City**  
4900 Main Street, Suite 400  
Kansas City, Missouri 64112  
+1 816 531 5303  
colliers.com/kansascity