

RETAIL PROPERTY FOR SALE OR LEASE



749 SOUTH WASHINGTON STREET

North Attleboro, MA 02760

DAN FEINER

Vice President
401.751.3200 x3310
dan@mgcommercial.com

MICHAEL GIUTTARI, SIOR

President Emeritus
401.751.3200 x3305
mike@mgcommercial.com

MG COMMERCIAL

365 Eddy Street, Penthouse Suite
Providence, RI 02903
401.751.3200 | mgcommercial.com

EXECUTIVE SUMMARY

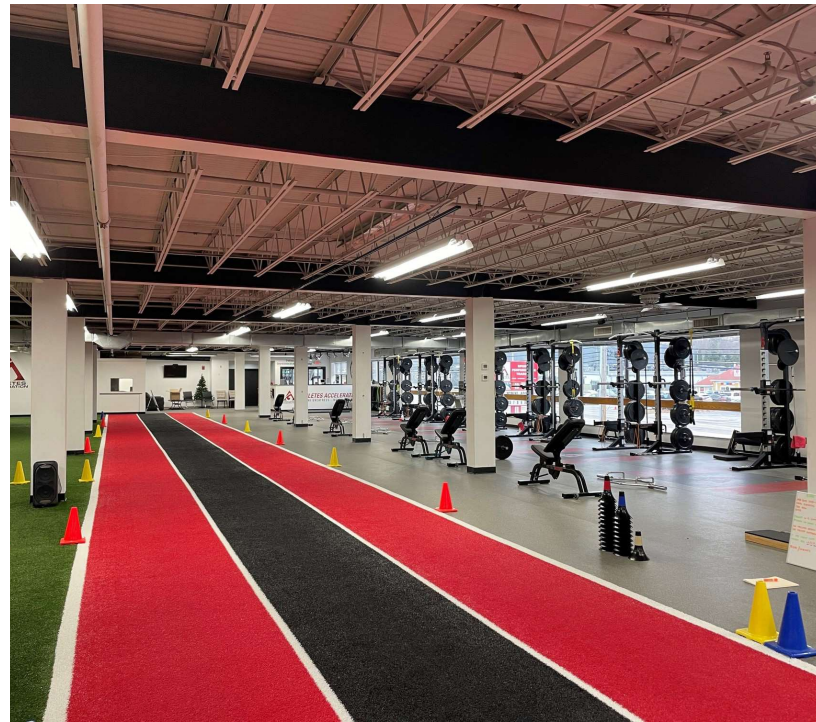

PROPERTY DESCRIPTION

21,440' (which includes stairwell and elevator space) free-standing former fitness center facility for sale or lease. 10,720' first-floor space is fully leased. The 10,000' second-floor space is available with the potential of leasing both floors together. This opportunity offers easy highway access, tremendous visibility, and strong pylon signage directly on Route 1. (Map 22; Lot 70)

OFFERING SUMMARY

Sale Price:	\$3,000,000
Building Size:	21,440 SF (2nd Floor available 10,000')
Lot Size:	2.2 Acres
Lease Rate:	\$10.00 SF/yr (NNN)
Available Space	10,000 SF (2nd Floor)
Zoning:	C30 (Commercial up to 30,000 SF)
Taxes:	\$16,900

LOCATION DESCRIPTION

This property is located on South Washington Street (Route 1) on a 4 lane road. It is ¼ mile from the on/off ramps to Route 295 N/S, in close proximity to Simon Properties Emerald Square Mall and across from the Showcase Cinema. Very busy trade area from Route 95 to Route 295.

PROPERTY HIGHLIGHTS

- Turn-key fitness center (less equipment)
- Building is equipped with an elevator to all levels
- 88 on-site parking spaces
- Close proximity to highway system
- Property has versatility for many types of uses

DEMOGRAPHICS

	2 MILES	3 MILES	5 MILES
Total Households	6,625	17,541	51,315
Total Population	16,510	43,570	124,582
Average HH Income	\$117,343	\$111,775	\$96,157

DAN FEINER

Vice President
401.751.3200 x3310
dan@mgcommercial.com

MICHAEL GIUTTARI, SIOR

President Emeritus
401.751.3200 x3305
mike@mgcommercial.com

365 Eddy Street, Penthouse Suite
Providence, RI 02903
mgcommercial.com



749 SOUTH WASHINGTON STREET

North Attleboro, MA 02760

RETAIL PROPERTY FOR SALE OR LEASE

ADDITIONAL PHOTOS

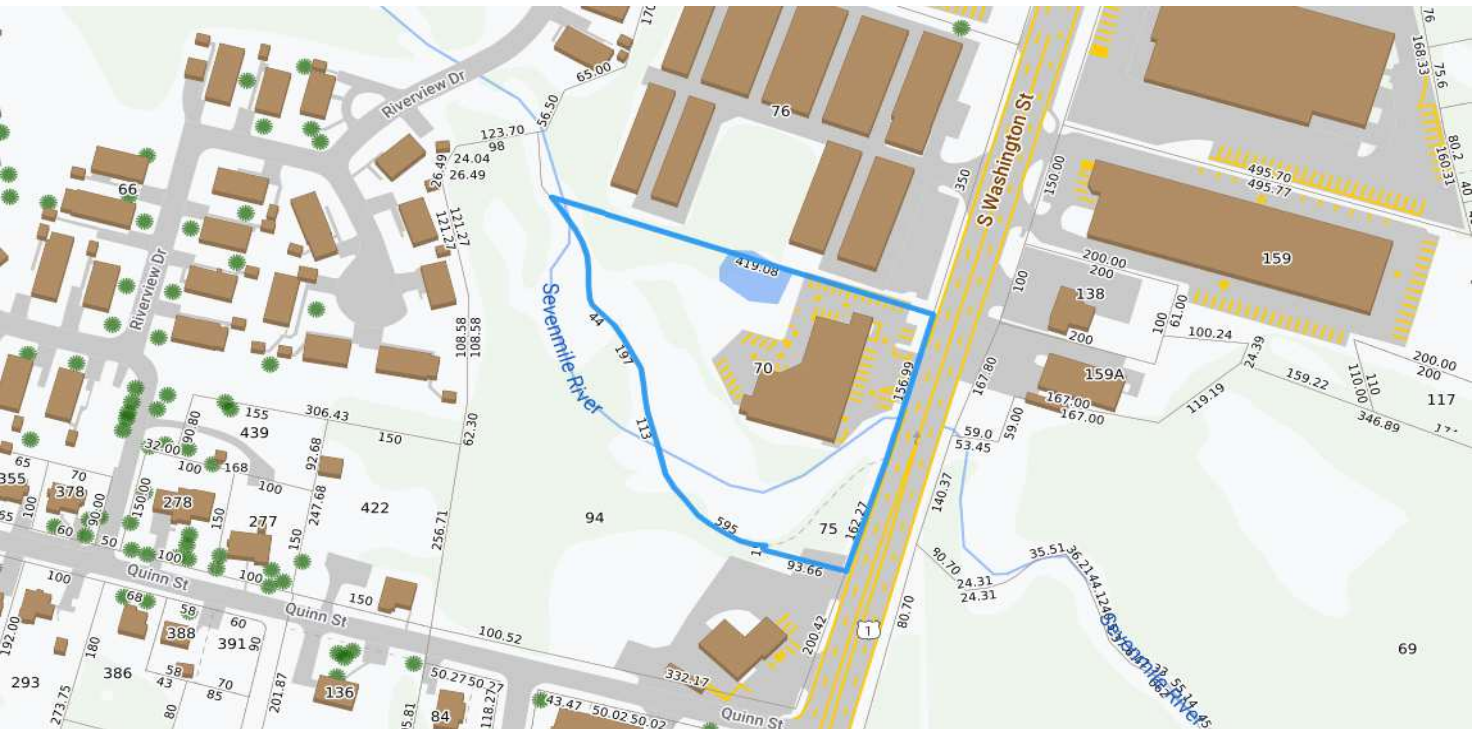

DAN FEINER

Vice President
401.751.3200 x3310
dan@mgcommercial.com

MICHAEL GIUTTARI, SIOR

President Emeritus
401.751.3200 x3305
mike@mgcommercial.com

365 Eddy Street, Penthouse Suite
Providence, RI 02903
mgcommercial.com



This information has been secured from sources we believe to be reliable, but we make no representation or warranties, expressed or implied, as to the accuracy of the information. All references to age, sq. footage, income, and expenses are approximate. Buyers should conduct their own independent investigations and rely only on those results.

749 SOUTH WASHINGTON STREET

North Attleboro, MA 02760

RETAIL PROPERTY FOR SALE OR LEASE

RETAILER MAP



DAN FEINER

Vice President
401.751.3200 x3310
dan@mgcommercial.com

MICHAEL GIUTTARI, SIOR

President Emeritus
401.751.3200 x3305
mike@mgcommercial.com

365 Eddy Street, Penthouse Suite
Providence, RI 02903
mgcommercial.com



This information has been secured from sources we believe to be reliable, but we make no representation or warranties, expressed or implied, as to the accuracy of the information. All references to age, sq. footage, income, and expenses are approximate. Buyers should conduct their own independent investigations and rely only on those results.