



37,443 SF AVAILABLE

2800 Lithonia Industrial Blvd
Suite 100 | Lithonia, Georgia 30058



FOR LEASE



PROPERTY HIGHLIGHTS

- Total Size:** 37,443 SF
- Office:** 4,057 SF
- Warehouse:** 33,386 SF
- Loading:** Eleven (11) Dock High Doors
One (1) Oversized Drive-In Door
- Clear Height:** 22'
- Fire Sprinkler:** ESFR
- Available:** Immediately
- Access:** +/- 1 mile from I-20
+/- 6.7 miles from I-285
+/- 19.2 miles from Atlanta Airport

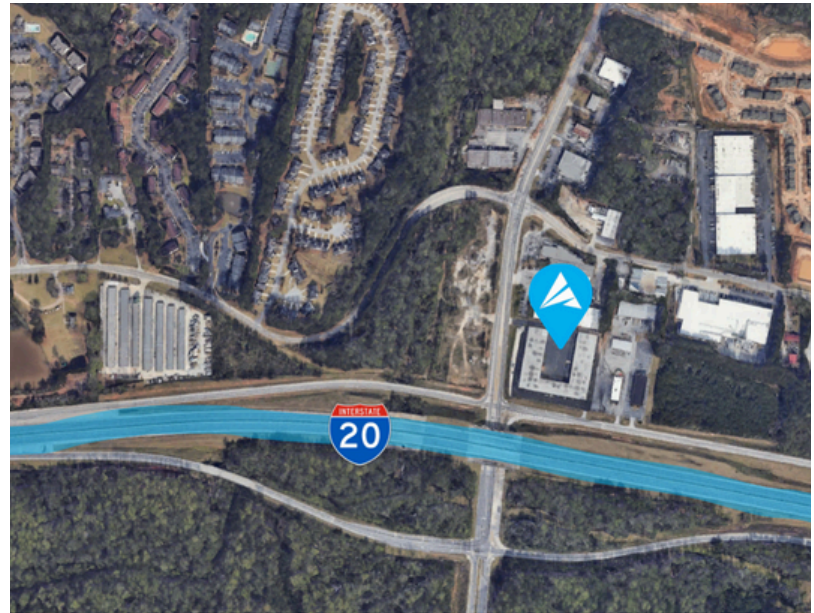

APEX INDUSTRIAL
REAL ESTATE ADVISORS

3500 Lenox Road, Suite 1275 | Atlanta, GA 30326 | apexindustrialre.com

For more information, please contact:

TREY WEGHORST

Office: (770) 264-9420
Cell: (404) 276-9314
tweghorst@apexindustrialre.com

RECE MOORE

Office: (404) 574-6311
Cell: (770) 861-8140
rmoore@apexindustrialre.com

BRYCE MCCAIN

Office: (404) 595-1552
Cell: (770) 845-3559
bmccain@apexindustrialre.com

Although the information contained therein was provided from sources believed to be reliable, Apex Industrial makes no representation, expressed or implied, as to its accuracy and said information is subject to errors, omissions or changes.



37,443 SF AVAILABLE

2800 Lithonia Industrial Blvd
Suite 100 | Lithonia, Georgia 30058



FLOOR PLAN

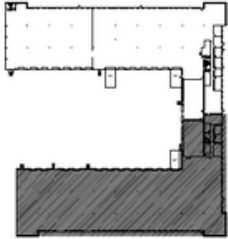

KEYPLAN

37,443 RSF
OVERALL WAREHOUSE: 33,386 SF
OVERALL OFFICE: 2,193 SF
SHOWROOM: 1,864 SF

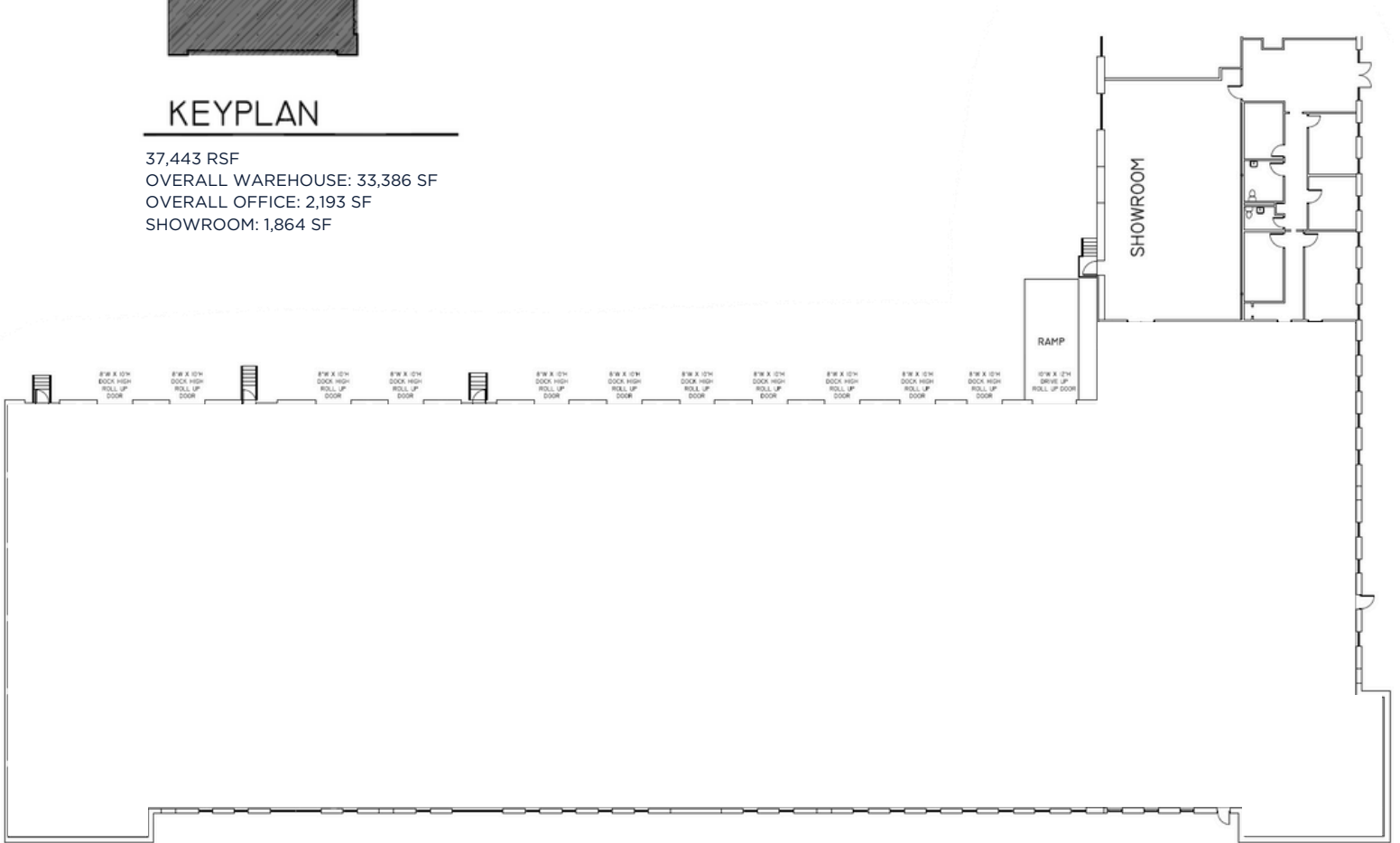

APEX INDUSTRIAL
REAL ESTATE ADVISORS

3500 Lenox Road, Suite 1275 | Atlanta, GA 30326 | apexindustrialre.com

For more information, please contact:

TREY WEGHORST

Office: (770) 264-9420
Cell: (404) 276-9314
tweghorst@apexindustrialre.com

RECE MOORE

Office: (404) 574-6311
Cell: (770) 861-8140
rmoore@apexindustrialre.com

BRYCE MCCAIN

Office: (404) 595-1552
Cell: (770) 845-3559
bmccain@apexindustrialre.com

Although the information contained therein was provided from sources believed to be reliable, Apex Industrial makes no representation, expressed or implied, as to its accuracy and said information is subject to errors, omissions or changes.