

888 Portola Road

Portola Valley, CA 94028

Marcus & Millichap

FOR LEASE

± 1,800 Sq. Ft with Private On Site - Parking (9 spaces)

± 1,750 Sq. Ft of On - Site Storage also Available
Available Immediately

YURI SERGUNIN, CCIM

SENIOR MANAGING DIRECTOR INVESTMENTS
C: (650) 701-5590 | O: (650) 391-0764
Yuri.Sergunin@marcusmillichap.com
License: CA 01908322

J.J. TAUGHINBAUGH

SENIOR MANAGING DIRECTOR INVESTMENTS
C: (408) 348-8821 | O: (650) 391-1807
JJ.Taughinbaugh@marcusmillichap.com
License: CA 01413305

TASSO DOUGLAS

SENIOR DIRECTOR INVESTMENTS
C: (650) 391-1818 | O: (650) 391-1700
Tasso.Douglas@marcusmillichap.com
License: CA 02012848

PROPERTY HIGHLIGHTS

- Open Floor Plan with plenty of natural light
- High ceilings & large windows
- Back patio & private parking lot
- Prominent street - front presence
- 888 Portola Road offers convenient access with 3 private parking spaces in front and 6 reserved commercial spaces located in the rear lot.



FLOOR PLAN

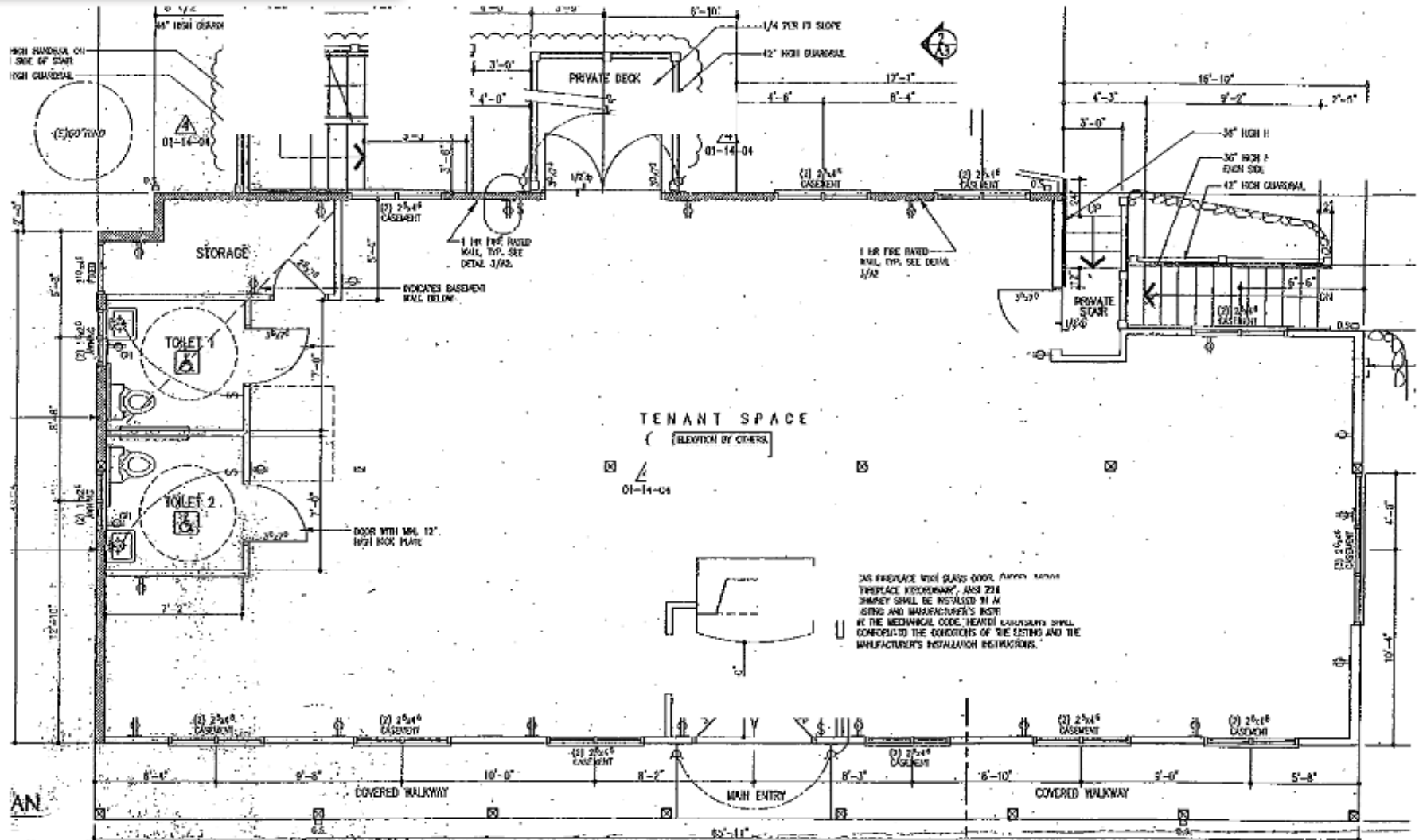

May not be accurate / to scale

SITE LOCATION

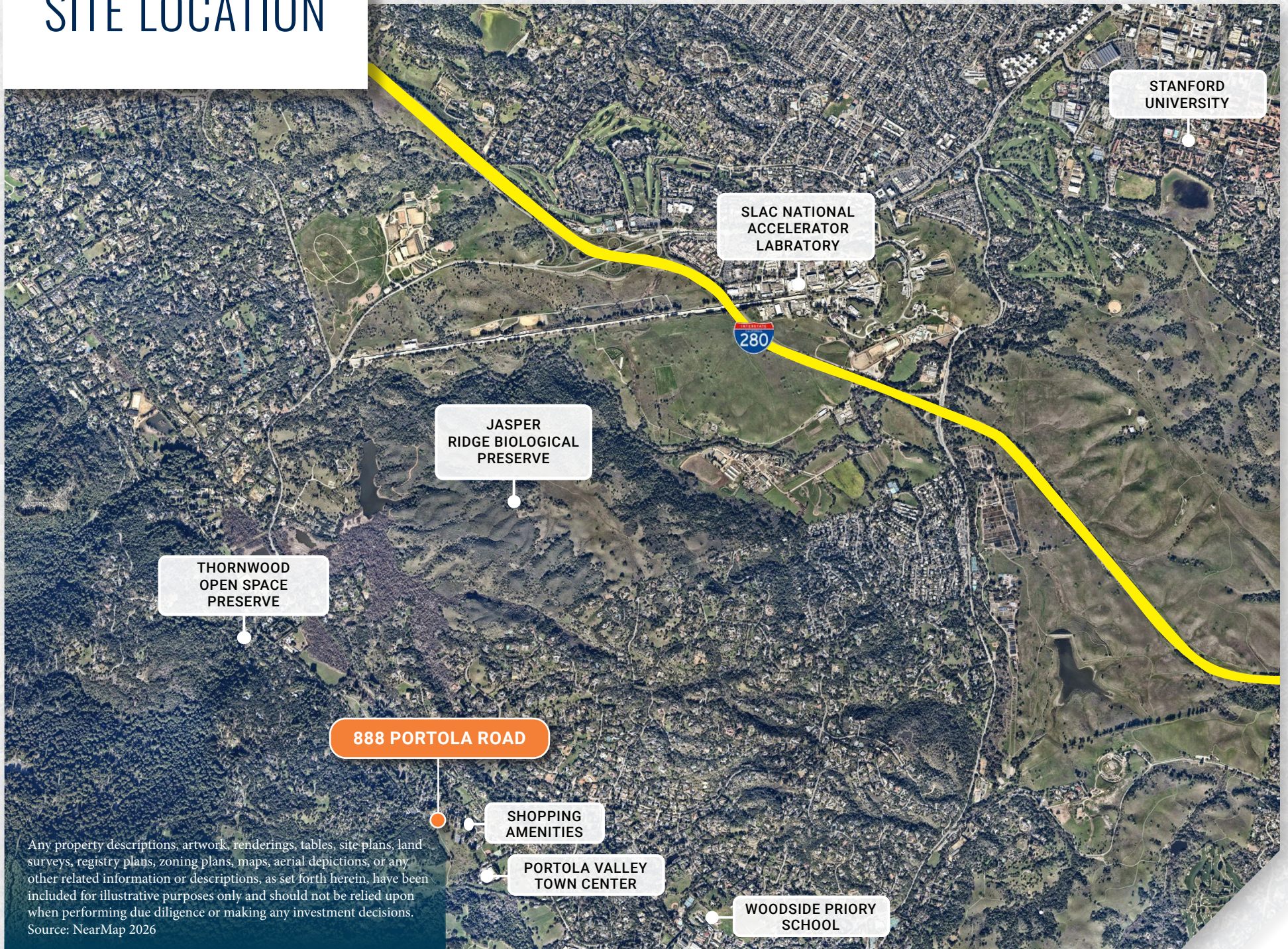

Any property descriptions, artwork, renderings, tables, site plans, land surveys, registry plans, zoning plans, maps, aerial depictions, or any other related information or descriptions, as set forth herein, have been included for illustrative purposes only and should not be relied upon when performing due diligence or making any investment decisions.
Source: NearMap 2026