

24445 Northwestern Hwy

Southfield, MI

- Up to 6,266 Square Feet Available
- Fully Renovated Building
- Professionally Owned & Managed
- Fantastic Highway Exposure/
Access
- Building Signage Available
- Common Café &
Training Room
- Convenient Parking
- Best Rental Value in Southfield

OFFICE BUILDING FOR LEASE

FOR MORE INFORMATION:

Aaron Smith
Vice President
248.637.3515
asmith@LMCap.com

Michael Elle
Sales Associate
248.637.3526
melle@LMCap.com

248.637.9700 | LMCap.com



L. MASON CAPITANI

CORFAC INTERNATIONAL

CELEBRATING 60 YEARS

24445 Northwestern Hwy

Southfield, MI



L. MASON CAPITANI

CORFAC INTERNATIONAL

CELEBRATING 60 YEARS



24445 Northwestern Hwy

Southfield, MI



L. MASON CAPITANI

CORFAC INTERNATIONAL

CELEBRATING 60 YEARS

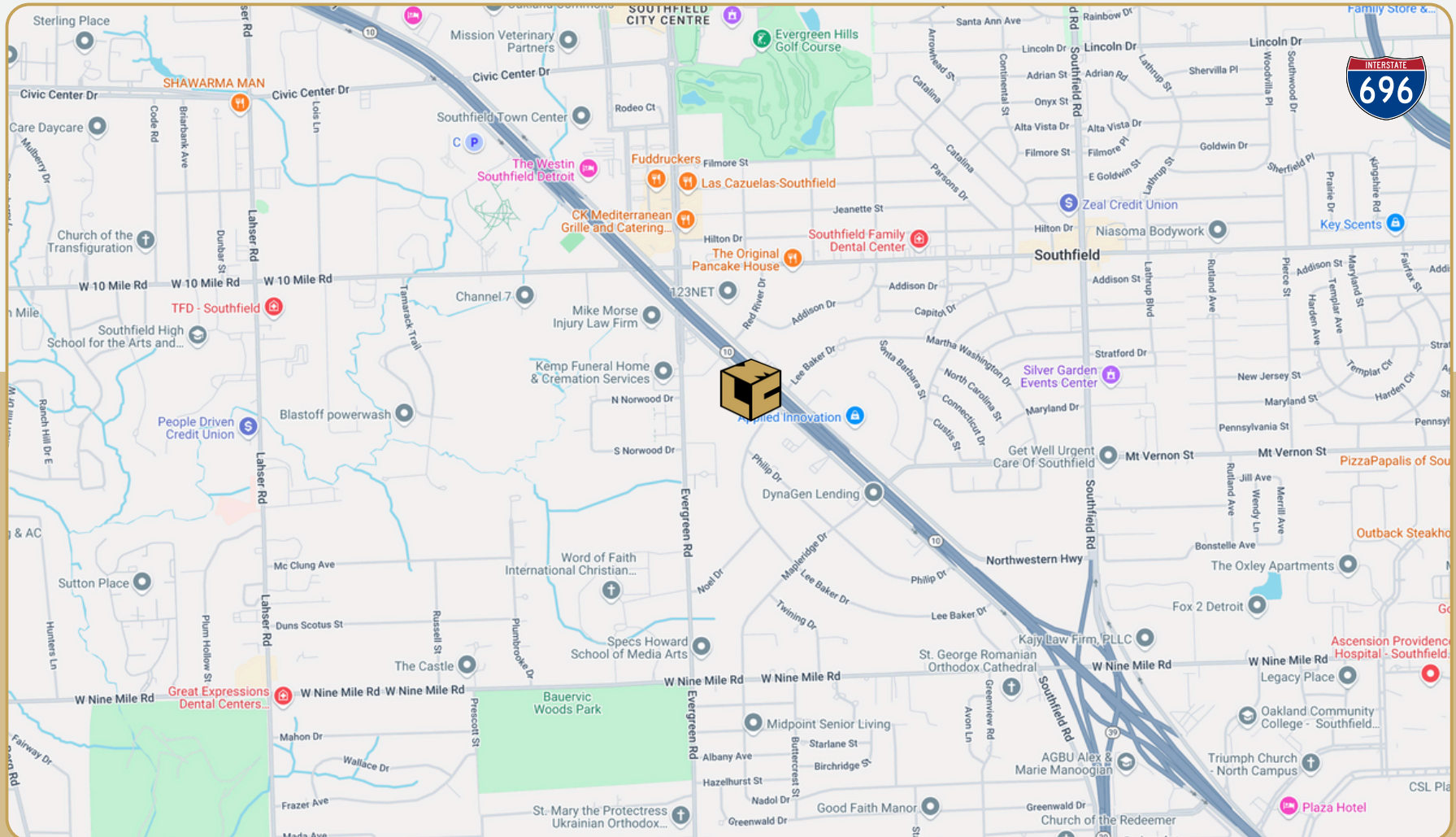

248.637.9700 | LMCap.com

24445 Northwestern Hwy

Southfield, MI



L. MASON CAPITANI

CORFAC INTERNATIONAL

CELEBRATING 60 YEARS

Office Property Details:

Details:

| | |
|------------------------------|---------------------|
| Location Description: | S of Evergreen Road |
| Building Type: | Office |
| Class: | B |
| Zoning: | Office |
| Floors: | 2 |
| Year Built: | 1974 |
| Year Rennovated | 2018 |
| Gross SF: | 69,580 SF |
| Total Rentable SF: | 69,580 SF |
| Available SF: | 13,584 SF |
| Min/Max SF: | 1,932 SF - 6,266 SF |
| Acres: | 3.44 |
| Multientant: | Yes |
| Parcel ID: | 24-26-151-015 |

Property Description: Professionally owned and managed multi-tenant office building featuring recently renovated common areas, shared conference and break rooms. Central geographic location with quick access to all major freeways.

Economic

| | |
|-----------------------------|------------|
| Min/Max Rental Rate: | \$12.50 SF |
| Rental Terms: | + Electric |
| Annual Escalations: | \$0.50/SF |
| Occupancy: | Immediate |
| Parking: | 282 Spaces |
| Partition Allowance: | Negotiable |
| Signage: | Negotiable |
| Status: | Existing |

24445 Northwestern Hwy

Southfield, MI



L. MASON CAPITANI

CORFAC INTERNATIONAL

CELEBRATING 60 YEARS

Available Suites:

Suite 205: 3,643 SF

Suite 206: 2,623 SF

Suite 205/206: 6,266 SF

Suite 208: 1,932 SF

Suite 230: 3,931 SF



24445 Northwestern Hwy

Southfield, MI



L. MASON CAPITANI

CORFAC INTERNATIONAL

CELEBRATING 60 YEARS

Second Floor Vacancies

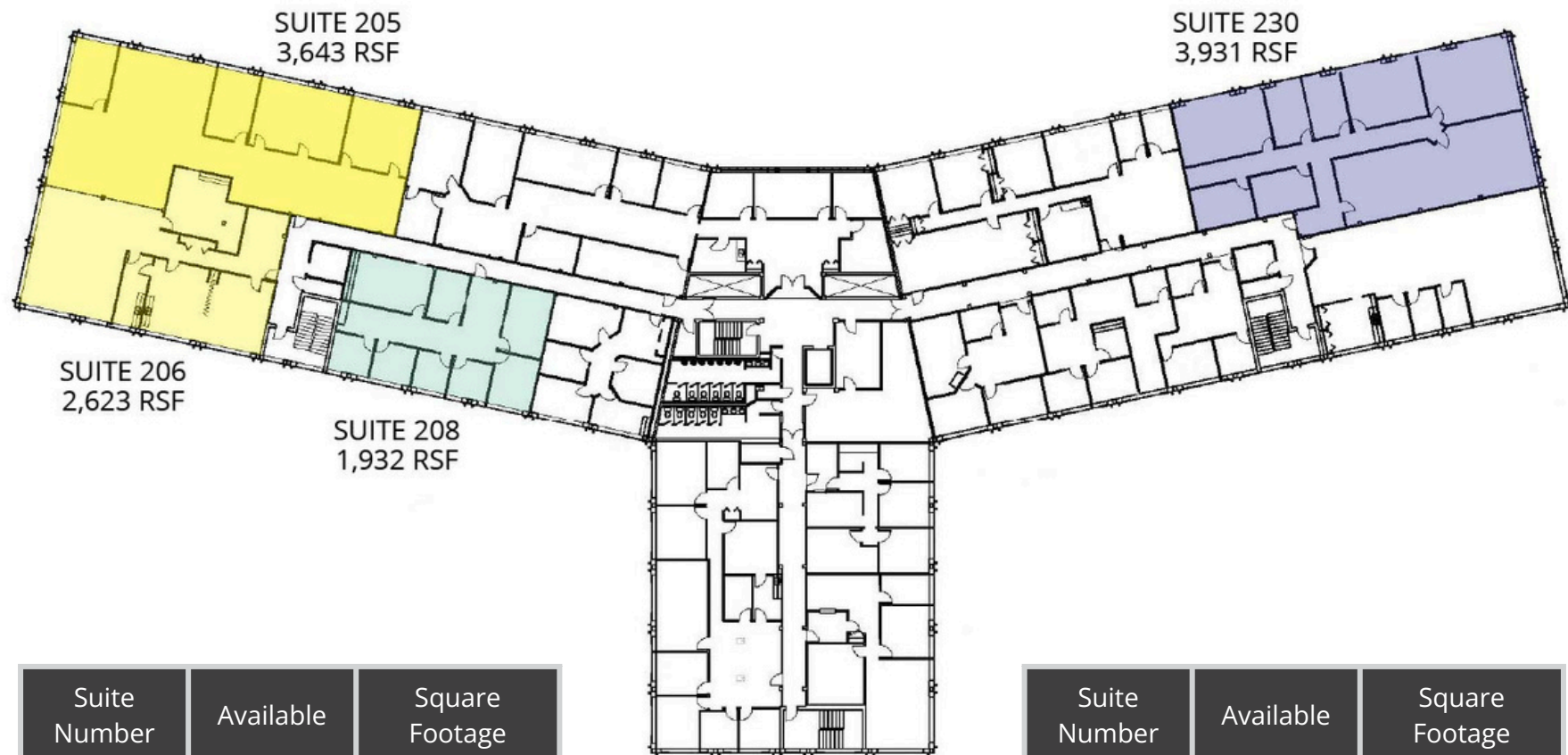

| Suite Number | Available | Square Footage |
|--------------|-----------|----------------|
| 205 | Imm. | 3,643 SF |
| 206 | Imm. | 2,623 SF |
| 205/206 | Imm. | 2,623-6,266 SF |

| Suite Number | Available | Square Footage |
|--------------|-----------|----------------|
| 208 | 3/30/2026 | 1,932 SF |
| 230 | Imm. | 3,931 SF |