

3350 McFaddin
Beaumont, TX 77702

FEMA MAP

DEFINITION KEY

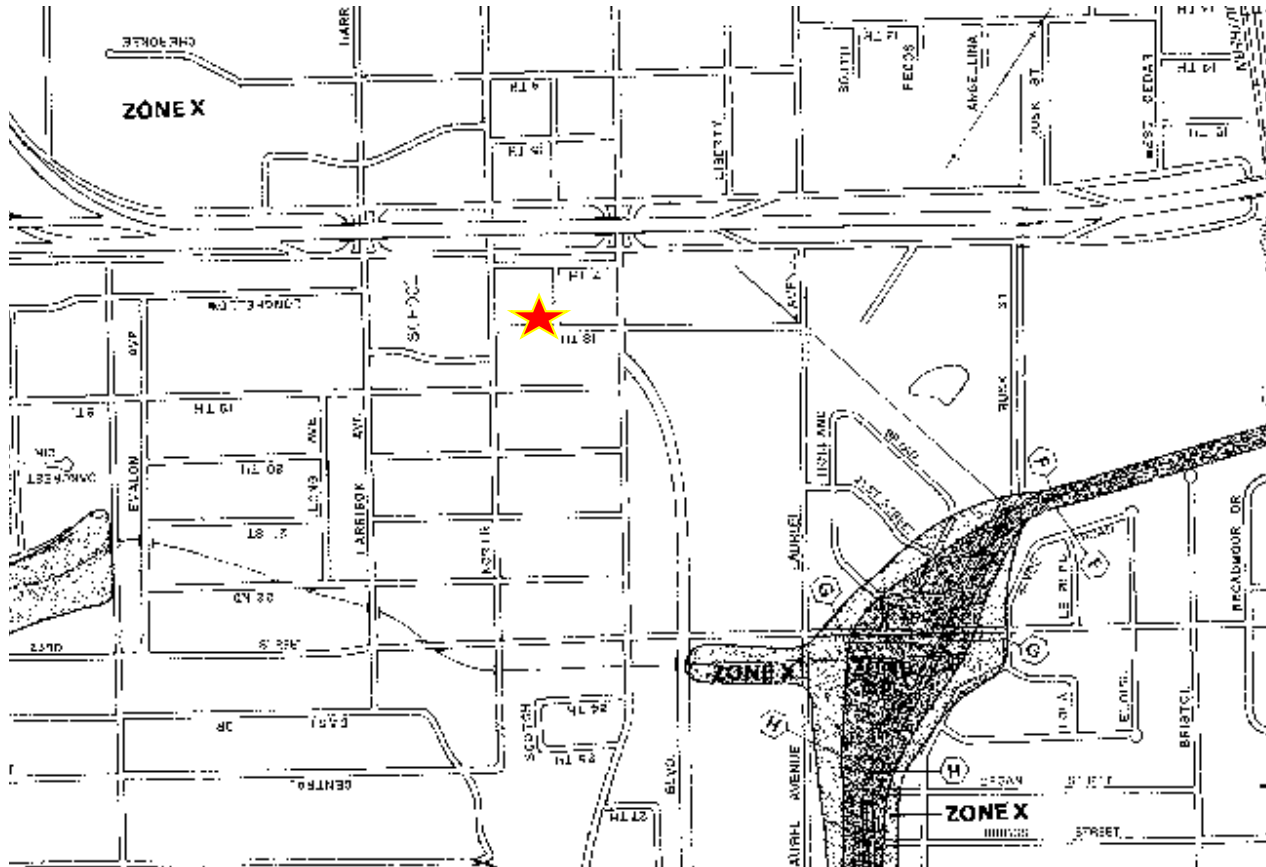

ZONE	DESCRIPTION
A	Areas subject to inundation by the 1-percent-annual-chance flood event. Because detailed hydraulic analyses have not been performed, no Base Flood Elevations (BFEs) or flood depths are shown.
AE, A1-A30	Areas subject to inundation by the 1-percent-annual-chance flood event determined by detailed methods. BFEs are shown within these zones. (Zone AE is used on new and revised maps in place of Zones A1-A30.)
AH	Areas subject to inundation by 1-percent-annual-chance shallow flooding (usually areas of ponding) where average depths are 1-3 feet. BFEs derived from detailed hydraulic analyses are shown in this zone.
AO	Areas subject to inundation by 1-percent-annual-chance shallow flooding (usually sheet flow on sloping terrain) where average depths are 1-3 feet. Average flood depths derived from detailed hydraulic analyses are shown within this zone.
AR	Areas that result from the decertification of a previously accredited flood protection system that is determined to be in the process of being restored to provide base flood protection.
A99	Areas subject to inundation by the 1-percent-annual-chance flood event, but which will ultimately be protected upon completion of an under-construction Federal flood protection system. These are areas of special flood hazard where enough progress has been made on the construction of a protection system, such as dikes, dams, and levees, to consider it complete for insurance rating purposes. Zone A99 may be used only when the flood protection system has reached specified statutory progress toward completion. No BFEs or flood depths are shown.
V	Areas along coasts subject to inundation by the 1-percent-annual-chance flood event with additional hazards associated with storm-induced waves. Because detailed coastal analyses have not been performed, no BFEs or flood depths are shown.
VE, V1-V30	Areas along coasts subject to inundation by the 1-percent-annual-chance flood event with additional hazards due to storm-induced velocity wave action. BFEs derived from detailed hydraulic coastal analyses are shown within these zones. (Zone VE is used on new and revised maps in place of Zones V1-V30.)
B, X (shaded)	Moderate risk areas within the 0.2-percent-annual-chance floodplain, areas of 1-percent-annual-chance flooding where the contributing drainage area is less than 1 square mile, and areas protected from the 1-percent-annual-chance flood by a levee. No BFEs or base flood depths are shown within these zones. (Zone X (shaded) is used on new and revised maps in place of Zone B.)
C, X (unshaded)	Minimal risk areas outside the 1-percent and .2-percent-annual-chance floodplains. No BFEs or base flood depths are shown within these zones. (Zone X (unshaded) is used on new and revised maps in place of Zone C.)
D	Unstudied areas where flood hazards are undetermined, but flooding is possible. No mandatory flood insurance purchase requirements apply, but coverage is available in participating communities.



Tammiey Linscomb
409 - 673 - 6057
tammiey@cbcaaa.com



The information contained in this Marketing Brochure has been obtained from sources we believe to be reliable. However, Coldwell Banker Commercial has not and will not verify any of this information, nor has Coldwell Banker Commercial conducted any investigation regarding these matters. Coldwell Banker Commercial makes no guarantee, warranty or representation about the accuracy or completeness of any information provided.