

FOR SUBLEASE

## WATERFRONT CORPORATE CENTER I

111 River Street, Hoboken, NJ

6,500-13,662 RSF | 12<sup>TH</sup> FLOOR

### Property Highlights

- Rent: Negotiable
- Term: Through February 28, 2030
- Square Footage: 13,662 SF (premises is divisible)
- Premises can be delivered fully furnished
- Building amenities include on-site parking, fitness center, café, and banking
- Adjacent to the W Hotel, 1 block from Hoboken Terminal, NJ Transit, PATH, NJ Light Rail, NY Waterway ferries and Wolfgang Puck's Express restaurant
- Walkable to virtually every type of restaurant and retail



**BEN BRENNER**

+1 973 292 4617

[ben.brenner@cushwake.com](mailto:ben.brenner@cushwake.com)

**MARIAGRACE IANTOSCA**

+1 973 292 4605

[mariagrace.iantosca@cushwake.com](mailto:mariagrace.iantosca@cushwake.com)

One Meadowlands Plaza, 7<sup>th</sup> Floor  
East Rutherford, NJ 07073 | USA  
[cushmanwakefield.com](http://cushmanwakefield.com)



# 12<sup>TH</sup> FLOOR 6,500-13,662 RSF **FLOORPLAN**

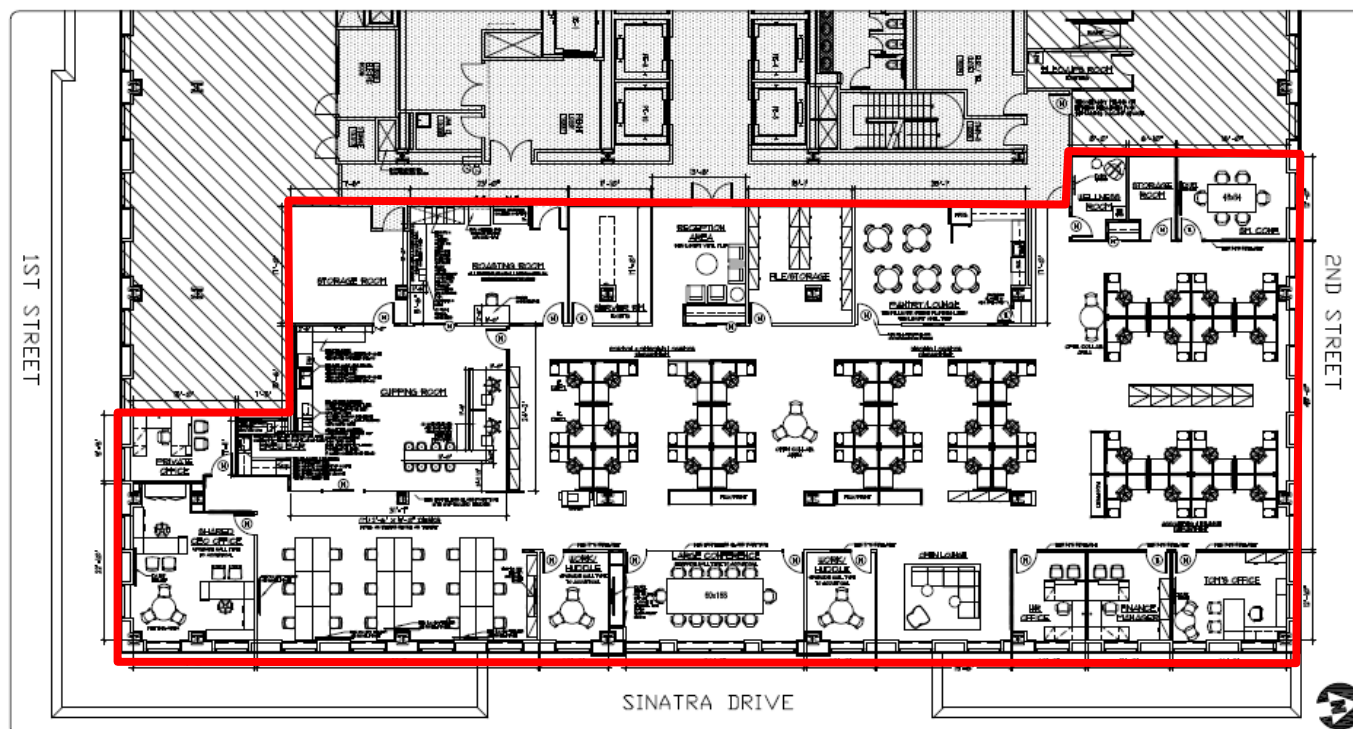

**BEN BRENNER**

+1 973 292 4617

ben.brenner@cushwake.com

**MARIAGRACE IANTOSCA**

+1 973 292 4605

mariagrace.iantosca@cushwake.com

