

FOR LEASE

NEW RETAIL DEVELOPMENT – PAD SITES AND RETAIL CENTER

NE QUADRANT OF HIGHWAY 152 AND SARA ROAD, MUSTANG, OK



PROPERTY INFO

FREESTANDING RETAIL BUILDING, PAD SITES AND DEVELOPMENT LAND AVAILABLE

This offering near the corner of Highway 152 and Sara Road is a prime location for any retailer or service provider looking to expand into the rapidly growing Mustang Trade Area.

- + Neighbors Include
 - Walmart Supercenter, St. Anthony Hospital, Lowe's, Dollar Tree, Sally Beauty Supply, Anytime Fitness, My Dentist, Cato, Supercuts, Applebee's, IHop, Taco Bell, Wendy's, Zaxby's, OnCue, Hampton Inn, Midfirst Bank and more

AVAILABLE SPACE

- + Space Size
 - ±8,000 SF Proposed Retail Center
 - 4 – ±1 Acre Pad Sites
 - ±17.57 Total Acres
- + Pricing
 - Call for Rates



Traffic Counts

Highway 152	23,400 ADT
Sara Road	12,500 ADT

Source: Oklahoma Department of Transportation

2020 Demographics

	3 Miles	5 Miles	7 Miles
Population	25,040	54,041	95,796
Households	9,234	19,613	35,166
Average Household Income	\$84,089	\$88,966	\$83,521
Daytime Employment	7,358	19,547	58,803

Retail Science from CBRE

cbre.us/southcentralretail

CBRE

FOR LEASE | NEW RETAIL DEVELOPMENT – PAD SITES AND RETAIL CENTER | NE QUADRANT OF HWY 152 AND SARA RD, MUSTANG, OK

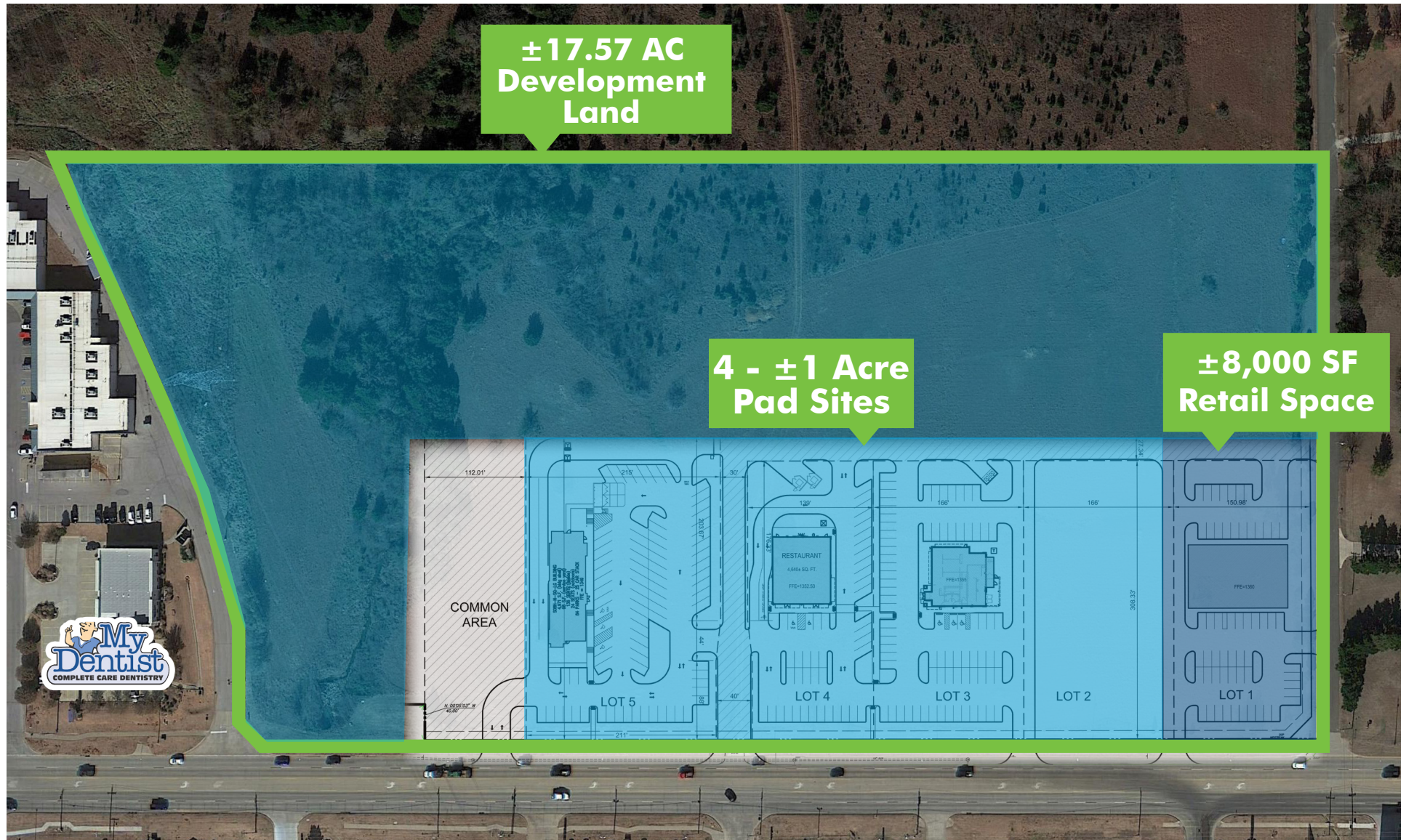

FOR LEASE | NEW RETAIL DEVELOPMENT – PAD SITES AND RETAIL CENTER | NE QUADRANT OF HWY 152 AND SARA RD, MUSTANG, OK



CONTACT US

Stuart Graham

Senior Vice President
405 607 6027
stuart.graham@cbre.com

Mark W. Inman, CPA

Senior Vice President
405 607 6272
mark.inman@cbre.com

Kendra Roberts

Associate
405 607 6050
kendra.roberts@cbre.com

© 2020 CBRE, Inc. All rights reserved. This information has been obtained from sources believed reliable, but has not been verified for accuracy or completeness. You should conduct a careful, independent investigation of the property and verify all information. Any reliance on this information is solely at your own risk. CBRE and the CBRE logo are service marks of CBRE, Inc. All other marks displayed on this document are the property of their respective owners. Photos herein are the property of their respective owners. Use of these images without the express written consent of the owner is prohibited.