

KASOTA BUSINESS CENTER I

MINNEAPOLIS
MIDWAY

739 Kasota Ave SE
Minneapolis, MN 55414



FOR LEASE

Suite 739 B

±8,103 SF



LEASED BY





PROPERTY OVERVIEW

Suite 739B in Kasota Business Center I is a functional Office/Lab/Warehouse space with 20' clear height and drive-in loading. Situated in a prime Minneapolis location with immediate access to I-35W and I-94 via Highway 280, the site is highly visible to Kasota Ave with tenant and monument signage available.

- > 196,707 SF high-image office/warehouse building
- > Heavy Power: 800 amps, 480-volt, 3-phase
- > Abundant parking: 2.19/1,000 SF
- > Immediate access to I-35W and I-94 via Highway 280

BUILDING SPECIFICATIONS

Available SF	8,103 SF
Clear Height	20'
Dock Doors	Specification
Drive-in Doors	One (1) (12'W x 14'H)
Year Built	1996
Lease Rate	Negotiable
2026 Tax & CAM	\$5.14 PSF

EXISTING
DRIVE-IN

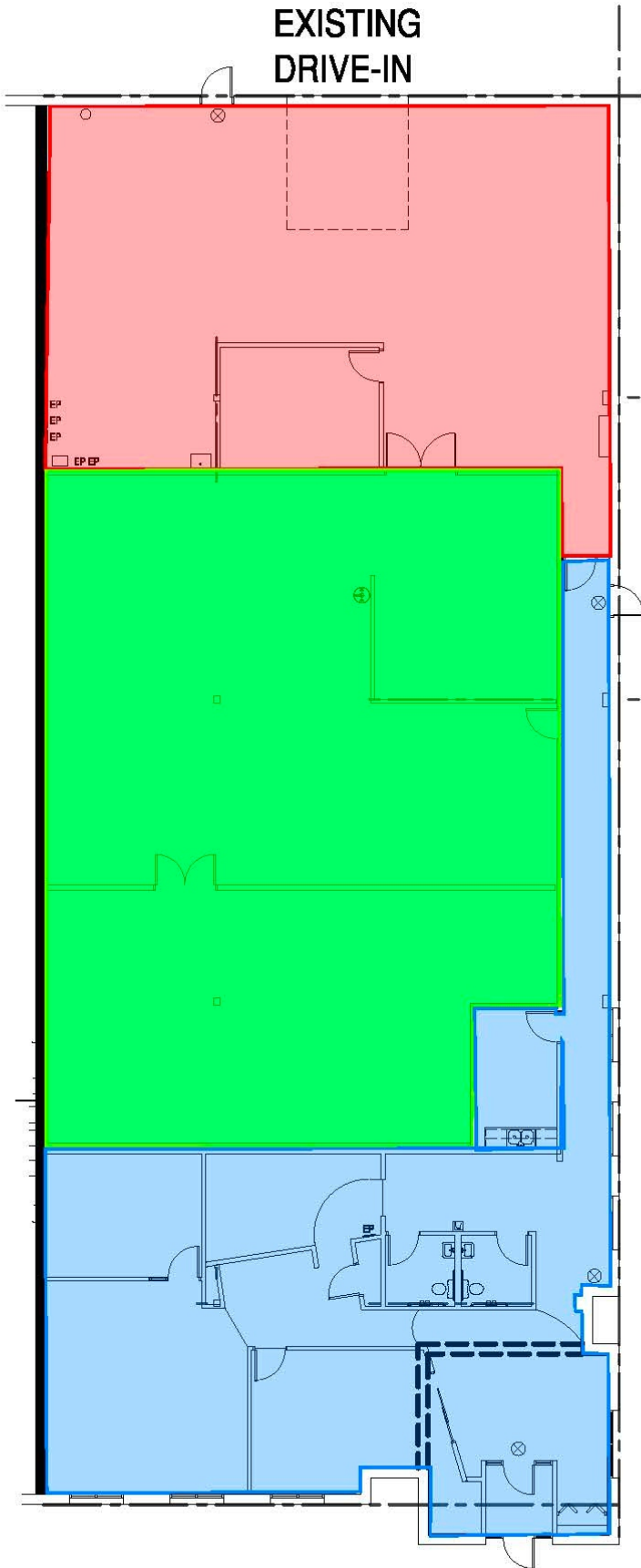

Office:	2,575 SF
Lab:	3,338 SF
Warehouse:	2,190 SF
Total:	8,103 SF



Committed to Driving Value for Our Customers

Properties with a Competitive Edge

Our scale, proprietary data and local relationships allow our 1,200+ skilled team members to help customers stay ahead of market trends.



Best-in-Class Customer Service

Our on-the-ground regional teams provide you with local expertise, leveraging data-driven insights to find the right solutions for your business.

Link+

Our digital customer experience platform provides easy access to your property management teams, lease documents, billing and service requests. Sign up today!

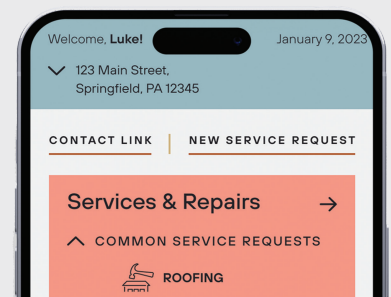

500 Million Square Foot Portfolio

Energy Solutions

Link Logistics' award-winning utility management program helps customers save time and money while unlocking energy efficiency opportunities. Enroll today through Link+.



CONTACT INFORMATION

739 Kasota Ave SE
Minneapolis, MN 55414

Eric Batiza, SIOR

eric.batiza@jll.com

(612) 217-5123

Dan Larew, CCIM SIOR

dan.larew@jll.com

(612) 217-6726

This document is for informational purposes only and does not constitute an offer or acceptance of a lease. Any lease agreement must be in writing and signed by the landlord. No representations or warranties are made except as expressly stated in a signed lease. Information is provided "as is" and may be subject to errors or change without notice.



LEASED BY

