



# Crums Mills Corporate Center

4250 Crums Mill Road, Suite 302  
Harrisburg, PA 17112



## Property Overview

Rental Rate:	\$20.95/SF/YR	Lot Size:	7.98 AC
Property Type:	Office	Rentable Building Area:	75,472 SF
Lease Type:	GROSS (excl. in-suite janitorial)	Year Built/Renovated:	2001/2020
TI Allowance:	Available	Security:	Secured Access
Façade Signage:	Available	Parking:	4.0/1,000 SF

### Major Roadway(s) Access:

US Rt. 322, I-81, I-83, I-76 PA Turnpike

### Property Highlights:

Large windows, convenient location, natural light, local ownership and Property management.

# THANK YOU

Thank you for your interest in this office space and Linlo Properties. If you would like additional information on this property, please contact a member of our leasing team or visit our website at [www.linloproperties.com](http://www.linloproperties.com).

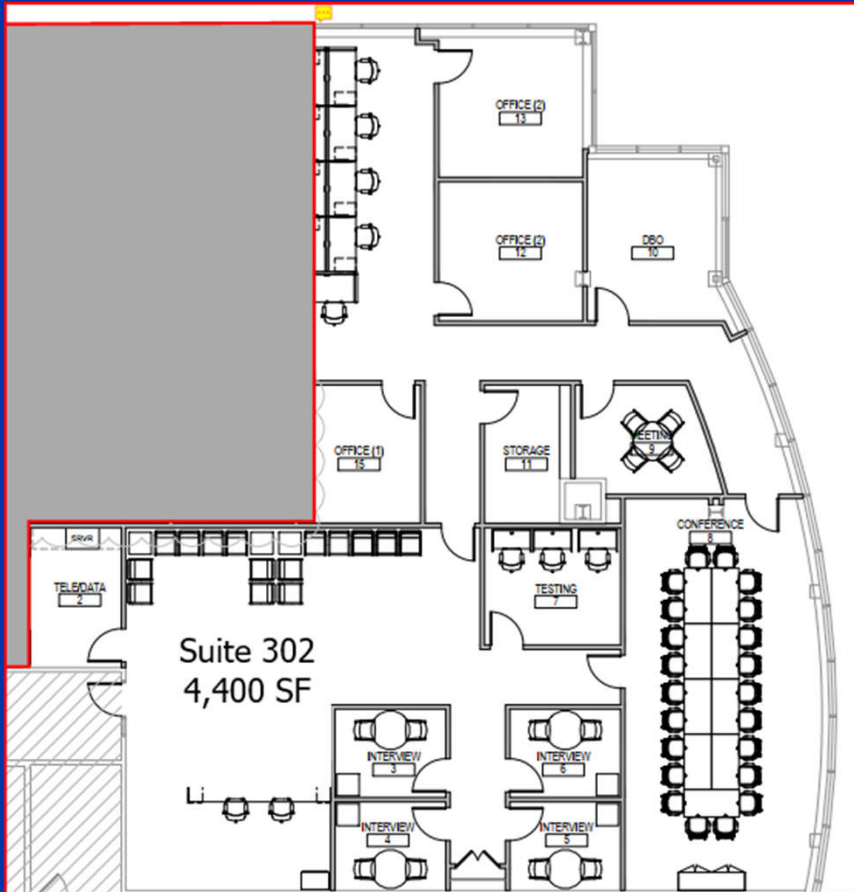

## Leasing Team Contacts:

**Tracey J. Tressler**

Sr. Director of Real Estate  
[ttressler@linloproperties.com](mailto:ttressler@linloproperties.com)  
(717) 307-2002 Ext. 16

**James R. Casey**

VP Leasing and Administration  
[jcasey@linloproperties.com](mailto:jcasey@linloproperties.com)  
(717) 307-2002 Ext. 19



# LINLO PROPERTIES

150 Corporate Center Drive; Suite 100  
Camp Hill, PA 17011  
(717) 307-2002