

— 4211 —

ROSEWOOD DR

*PLEASANTON*

3,000 RSF

*RETAIL AVAILABLE  
FOR SUBLEASE*

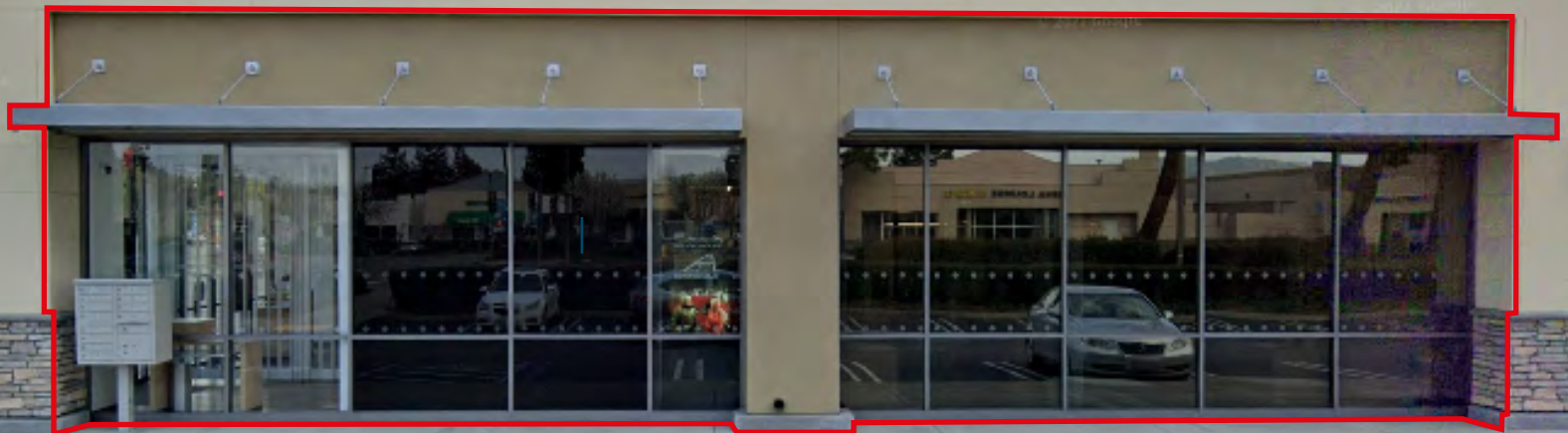

15 MINUTE PARKING

15 MINUTE PARKING

15 MINUTE PARKING

Jones Lang LaSalle Brokerage, Inc.  
Real Estate License #: 01856260



## HIGHLIGHTS

Pleasanton  
**4211**  
 Rosewood Dr

**40,763**  
 households within  
 3 miles

**212,544**  
 ADT on I-580

**94,203**  
 ADT along Santa  
 Rita Rd

# PLEASANTON (4211 ROSEWOOD DR)

## NEIGHBORHOOD DEMOGRAPHICS

**26,525**

Owner Occupied Housing Units

**14,237**

Renter Occupied Housing Units

**\$220,940**

Average Household Income

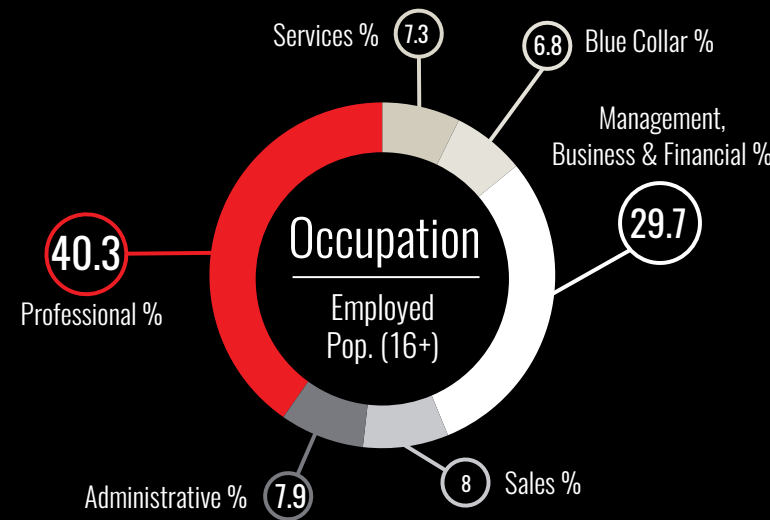

## POPULATION PROFILES

**24.6%**  
 Millennials

**24.7%**  
 Single

**69.7%**  
 Bachelor's Degree  
 or Higher

**97.1%**  
 Employed

**120,139**  
 Total Population

**133,161**  
 Daytime Population

## AVERAGE ANNUAL SPENDING

**Apparel** \$4,949

**Entertainment** \$7,412

**Eating Out** \$8,903

**HH Goods** \$5,297

**Health + Beauty** \$2,092

**Travel** \$6,307

HACIENDA CROSSINGS SHOPPING CENTER

ROSEWOOD COMMONS

4211 ROSEWOOD DR



3,000 RSF

## HIGHLIGHTS

- » Lease expiration on 11/30/2029
- » Prominent end cap
- » Located within dominant power center in Pleasanton trade area
- » Excellent visibility at entrance to center
- » Buildout and finishes completed in 2018

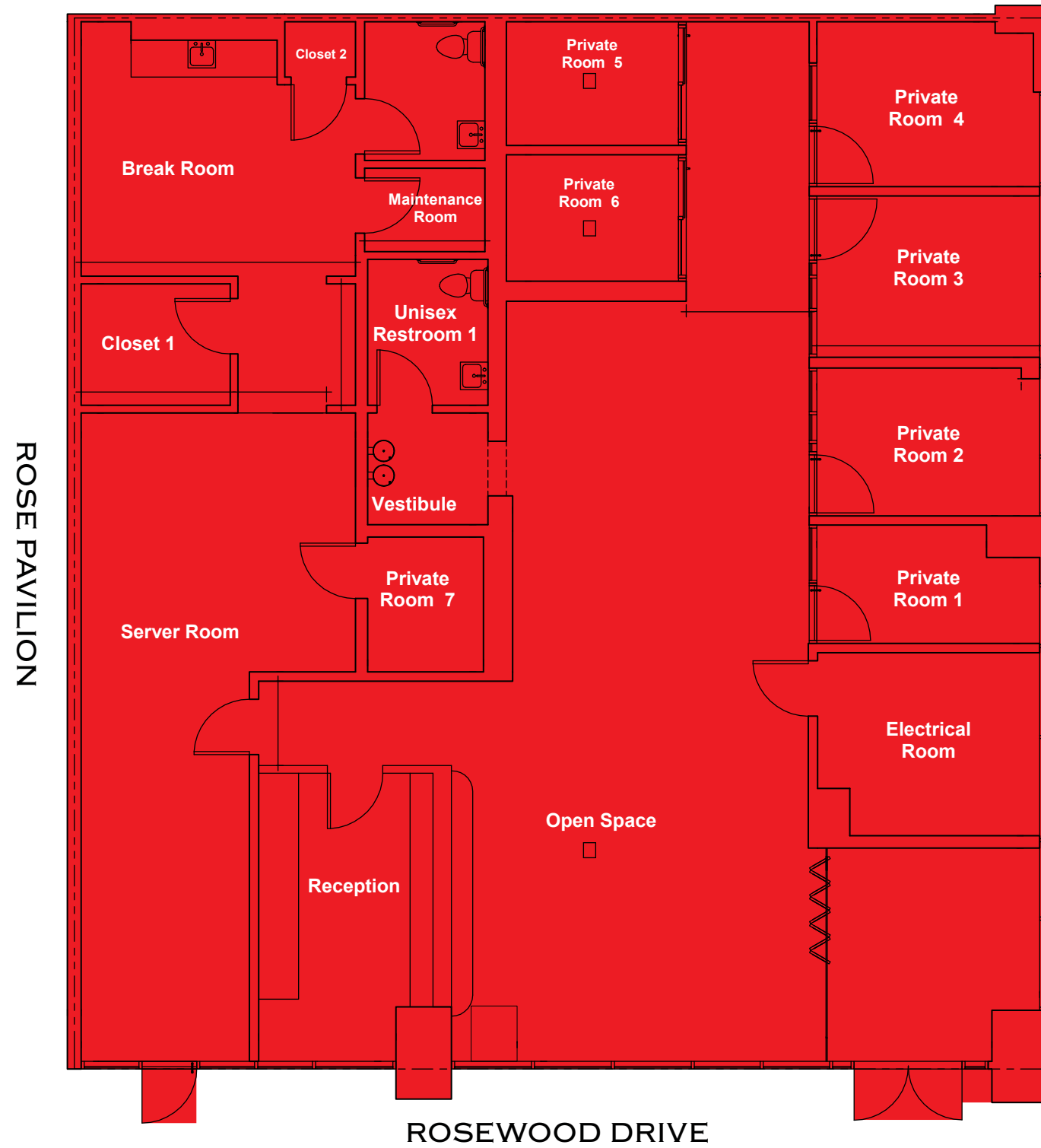



**Laura Tinetti**  
+1 415 228 3072  
laura.tinetti@jll.com  
RE Lic # 01358500

**Jeff Badstubner**  
+1 415 395 4916  
jeff.badstubner@jll.com  
RE Lic # 01155279

Although information has been obtained from sources deemed reliable, neither Owner nor JLL makes any guarantees, warranties or representations, express or implied, as to the completeness or accuracy as to the information contained herein. Any projections, opinions, assumptions or estimates used are for example only. There may be differences between projected and actual results, and those differences may be material. The Property may be withdrawn without notice. Neither Owner nor JLL accepts any liability for any loss or damage suffered by any party resulting from reliance on this information. If the recipient of this information has signed a confidentiality agreement regarding this matter, this information is subject to the terms of that agreement. © 2023. Jones Lang LaSalle IP, Inc. All rights reserved.