

MRC

For Lease

+MEDRITE
URGENT CARE

243 4th Ave

Newly Built Out Medical For Lease
3,200 sq ft | 243 4th Ave | Brooklyn, NY 11215

PROPERTY DETAILS



OVERVIEW

- **Address:** 243 4th Ave, Brooklyn, NY 11215
- **Cross Streets:** Carroll Street and President Street
- **Neighborhood:** Park Slope

SPACE DETAILS

- **Size:** 3,200 sq ft
- **Ceiling Height:** 12 ft
- **Frontage:** 40 ft

HIGHLIGHTS

- Glass Storefronts
- Built out Medical space
- Former Medrite
- New Development

TRANSPORTATION

- 4 min walk to B37, 5 min walk to B63
- 1 min walk to the R train
- 23 min drive to LGA, 27 min drive to JFK, 29 min drive to EWR

DEMOGRAPHICS

- **Population:** 146,797
- **Median Household Income:** \$140,385
- **Median Home Value:** \$1,046,236

NEIGHBORS

Blink Fitness, Starbucks, UPS, Bank of America, NY Kidz Club, Blackcat Wines, Guacamole, Bumble Bee Daycare, Purple Crayon Daycare, Root Hill Cafe, Green Ivy Organics, Delilah Salon, Union Street Pizza, Brownstone Bagel & Bread Co, Public Display and Affection, Dinosaur Bar-B-Que, Hemo's spot Juice Bar & Cafe, Runner & Stone, Annie's Blue Ribbon General Store, DNA Footwear Park Slope, 5th Ave Fitness

FLOOR PLAN

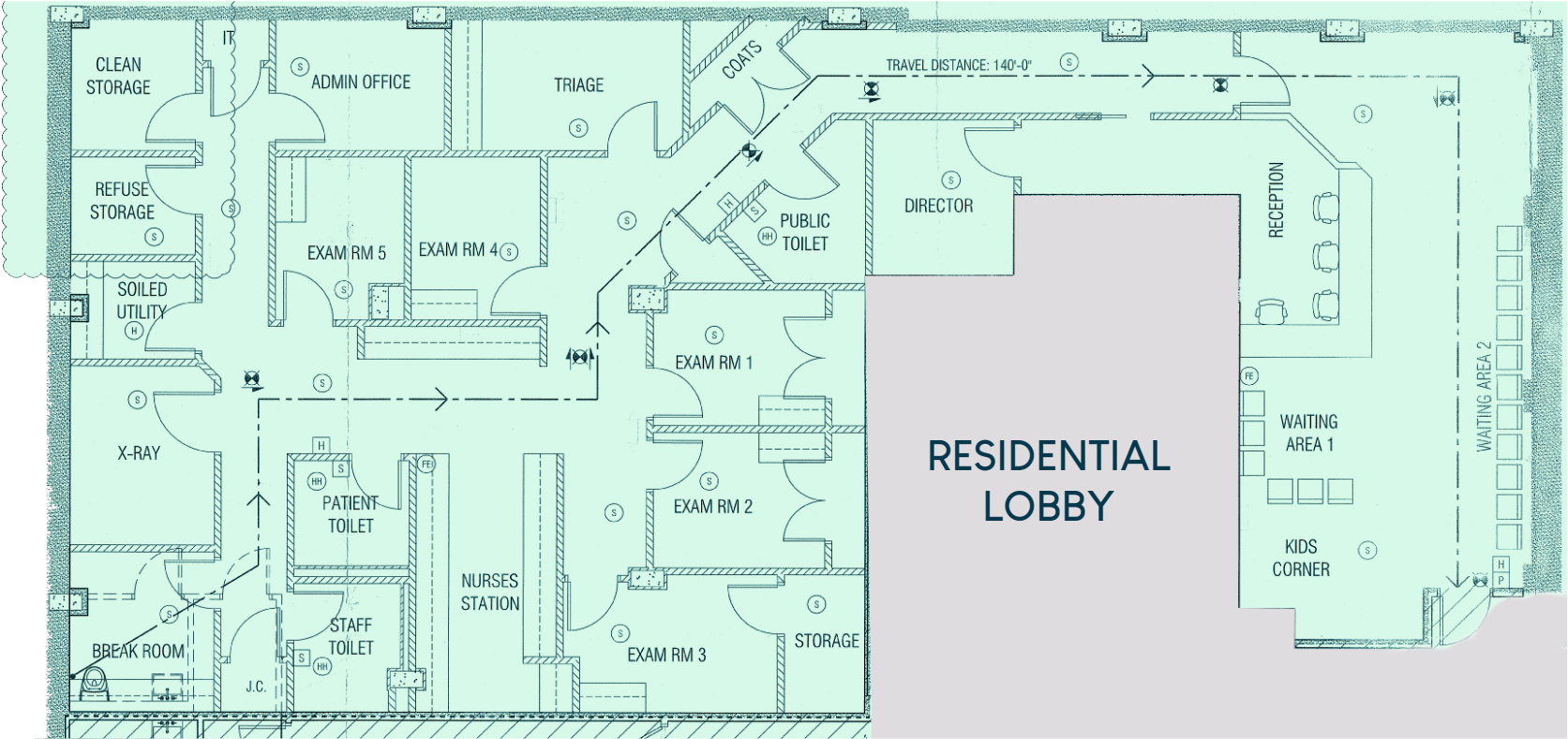

4TH AVE

INTERIOR PHOTOS

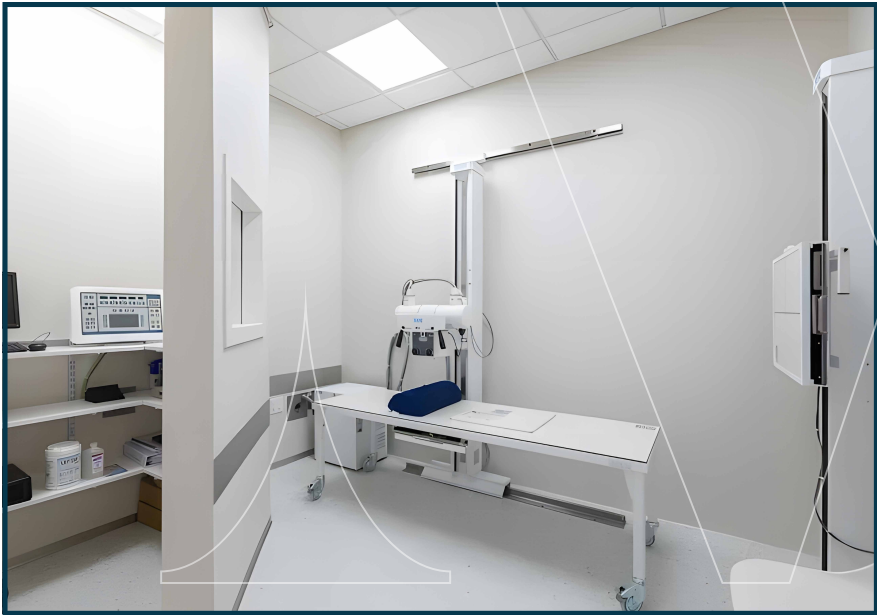

MRG

243 4th Ave Brooklyn, NY 11215

FOR MORE INFORMATION
PLEASE CONTACT:

MOSHE AKIVA
212-314-4684 Ext. 103
Moshe@mrgny.com

