

**\$0.85 per sq. ft.
+ CAMS**

4,000 Sq. Ft. (approx.)

FOR LEASE



326 N Street Fresno, CA 93721

Property Features

- \$0.85 per sq. ft. + CAMS per month
- Inside available space: 4,000 Sq. Ft. (approx.)
- Office available 800 sq. ft. (approx.)
- Three-phase electrical service
- Paint booth
- Can be ADA compliant
- North side: Loading dock and Fenced storage area w/ base rock
- Alley access
- Near Downtown Fresno
- Zoning: Commercial
- APN # 468-202-016
- Built in 1957



For more information contact:

Bill Whitlatch,
GRI, RE Masters™, CCIM
Real Estate Broker
DRE License #00874715
559-679-6611
bill@whitlatch.net

(see reverse side for more pictures)

NO WARRANTY OR REPRESENTATION, EXPRESS OR IMPLIED, IS MADE AS TO THE ACCURACY OF THE INFORMATION CONTAINED HEREIN, AND THE SAME IS SUBMITTED SUBJECT TO ERRORS, OMISSIONS, CHANGE OF PRICE, RENTAL OR OTHER CONDITIONS, PRIOR SALE, LEASE OR FINANCING, OR WITHDRAWAL WITHOUT NOTICE, AND OF ANY SPECIAL LISTING CONDITIONS IMPOSED BY OUR PRINCIPALS NO WARRANTIES OR REPRESENTATIONS ARE MADE AS TO THE CONDITION OF THE PROPERTY OR ANY HAZARDS CONTAINED THEREIN ARE ANY TO BE IMPLIED.



326 N Street, Fresno CA

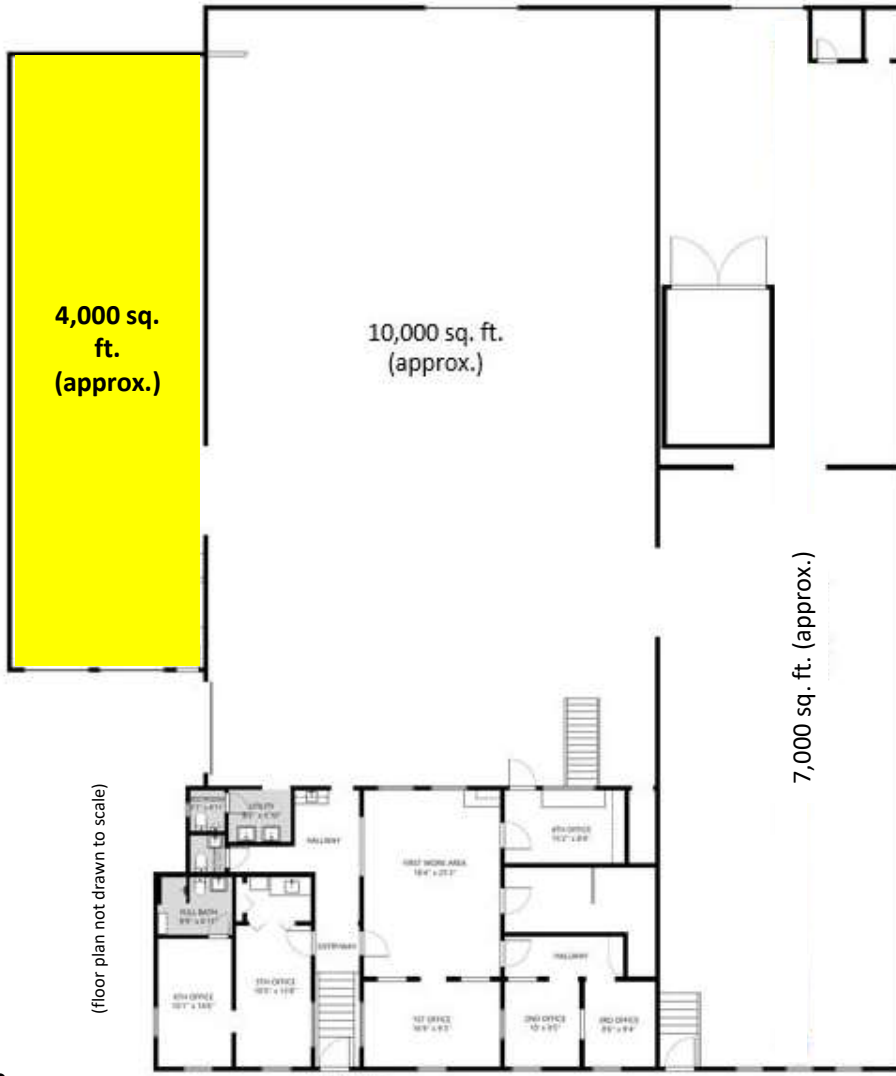

(floor plan not drawn to scale)

 = Space available

SIZE AND DIMENSIONS ARE APPROXIMATE, ACTUAL MAY VARY.



Rent \$0.85 per sq. ft. + CAMS per month



Scan w/ your camera for an interactive tour

For more information contact:

Bill Whitlatch,
GRI, RE Masters™, CCIM
Real Estate Broker
DRE License #00874715
559-679-6611
bill@whitlatch.net



4,000 Sq. ft. (approx.)

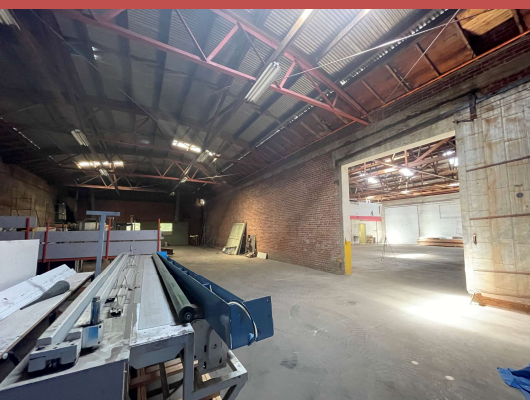

Rent \$0.85 per sq. ft. + CAMS per month

NO WARRANTY OR REPRESENTATION, EXPRESS OR IMPLIED, IS MADE AS TO THE ACCURACY OF THE INFORMATION CONTAINED HEREIN, AND THE SAME IS SUBMITTED SUBJECT TO ERRORS, OMISSIONS, CHANGE OF PRICE, RENTAL OR OTHER CONDITIONS, PRIOR SALE, LEASE OR FINANCING, OR WITHDRAWAL WITHOUT NOTICE, AND OF ANY SPECIAL LISTING CONDITIONS IMPOSED BY OUR PRINCIPALS NO WARRANTIES OR REPRESENTATIONS ARE MADE AS TO THE CONDITION OF THE PROPERTY OR ANY HAZARDS CONTAINED THEREIN ARE ANY TO BE IMPLIED.

Bill Whitlatch,
GRI, RE Master's™, CCIM
Real Estate Broker,
DRE License #00874715
559-679-6611
bill@whitlatch.net





Commercial Real Estate Services DRE Lic. 02202718

For more information contact:

Bill Whitlatch,
GRI, RE Masters™, CCIM
Real Estate Broker
DRE License #00874715
559-679-6611
bill@whitlatch.net

Rent \$0.85 per sq. ft. + CAMS per month

Near DOWNTOWN Fresno, Convention Center, & Fwy Access

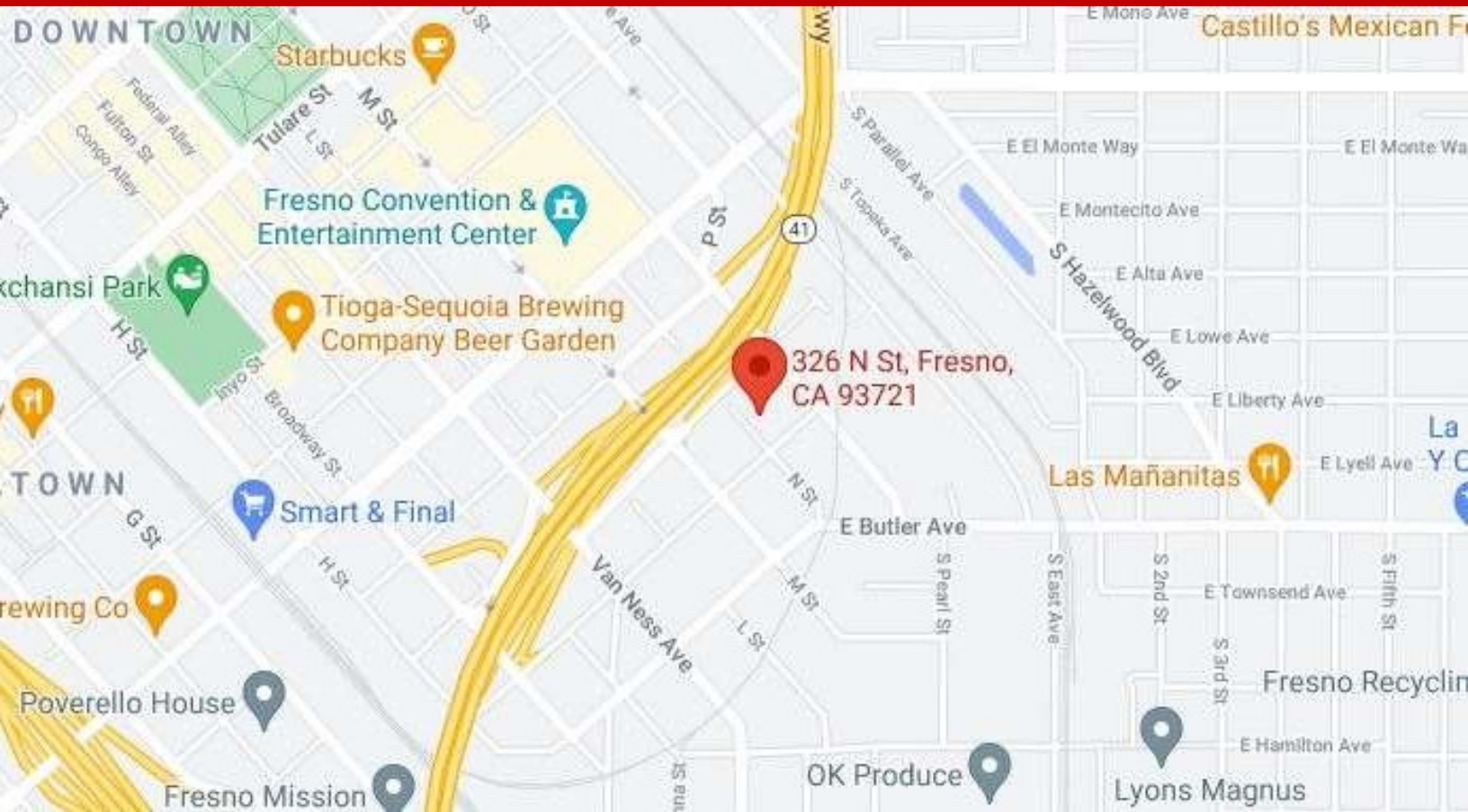

Inside-space Available for Lease: 4,000 Sq. ft. (approx.)

NO WARRANTY OR REPRESENTATION, EXPRESS OR IMPLIED, IS MADE AS TO THE ACCURACY OF THE INFORMATION CONTAINED HEREIN, AND THE SAME IS SUBMITTED SUBJECT TO ERRORS, OMISSIONS, CHANGE OF PRICE, RENTAL OR OTHER CONDITIONS, PRIOR SALE, LEASE OR FINANCING, OR WITHDRAWAL WITHOUT NOTICE, AND OF ANY SPECIAL LISTING CONDITIONS IMPOSED BY OUR PRINCIPALS NO WARRANTIES OR REPRESENTATIONS ARE MADE AS TO THE CONDITION OF THE PROPERTY OR ANY HAZARDS CONTAINED THEREIN ARE ANY TO BE IMPLIED.

Bill Whitlatch,
GRI, RE Master's™, CCIM
Real Estate Broker,
DRE License #00874715
559-679-6611
bill@whitlatch.net

