

INDUSTRIAL FLEX

12150 28th St N - North Wing
ST PETERSBURG, FL 33176

FOR LEASE



EXECUTIVE SUMMARY

Apex Capital Realty is pleased to present the North Wing of the C&D Packaging Building for lease. This ±12,000 SF flex space features approximately 4,000 SF of warehouse and 8,000 SF of fully built-out office, including multiple private suites. The wing offers exclusive use of three bathrooms, two bay doors, and abundant onsite parking.

This space is ideal for companies seeking a headquarters-style setup with a balanced combination of warehouse and office to support their operations.

PROPERTY OVERVIEW	
UNIT	North Wing
AVAILABLE SPACE	12,500 SF
TOTAL BUILDING SF	31,719 SF
AIR CONDITIONED	Yes
LOADING DOORS	2
RAMP LOADING	Yes
PARKING	+/- 12 Spots
BATHROOMS	3
OFFICE	+/- 10 suites
ZONING	AE



ASKING PRICE

\$8 PSF + NNN
(\$3.40 PSF)

MONTHLY ASKING RENT

\$11,900 per month

FLOOR PLAN

GROUND FLOOR

For Lease Area

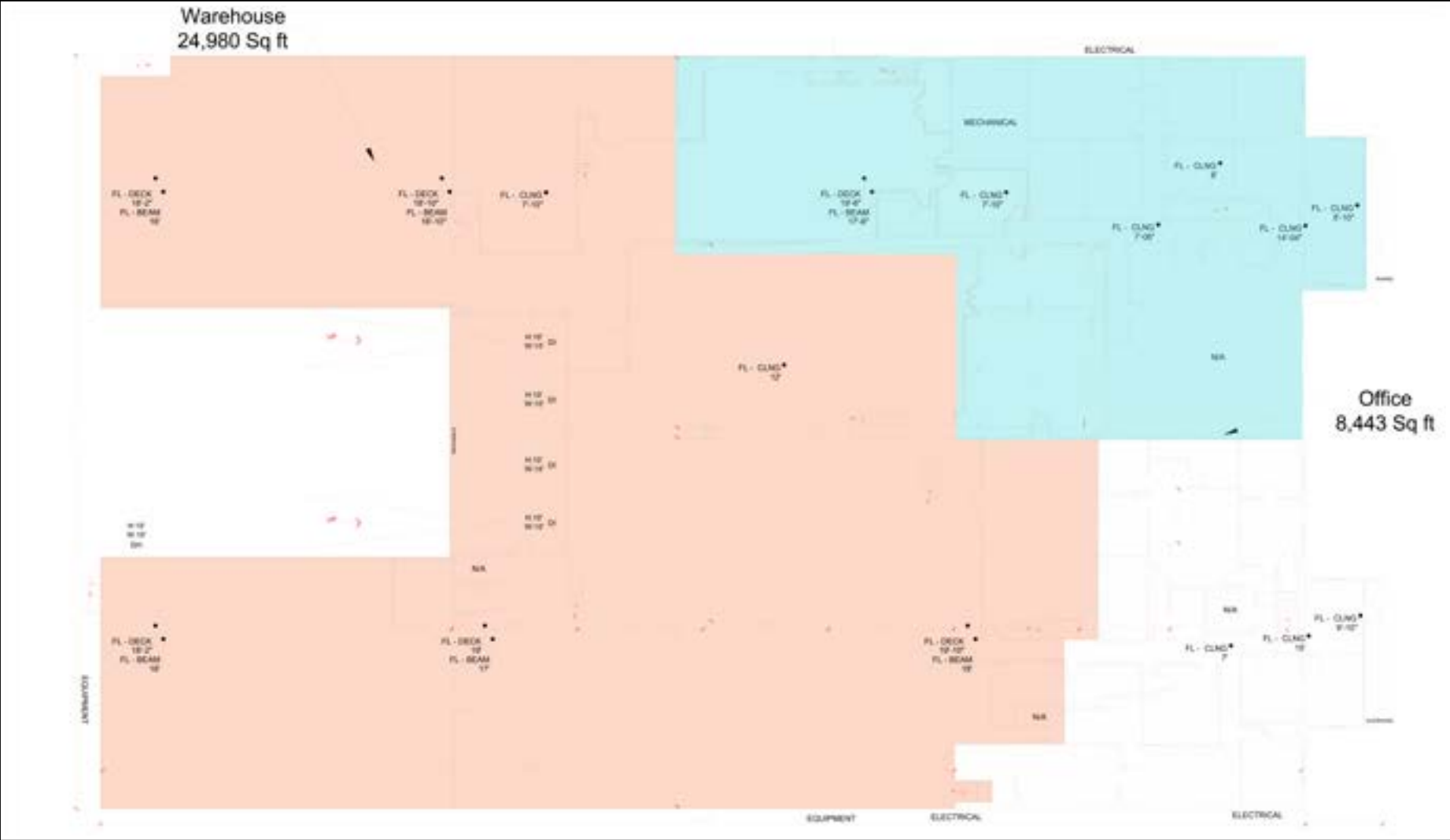

FLOOR PLAN

SECOND FLOOR

 For Lease Area

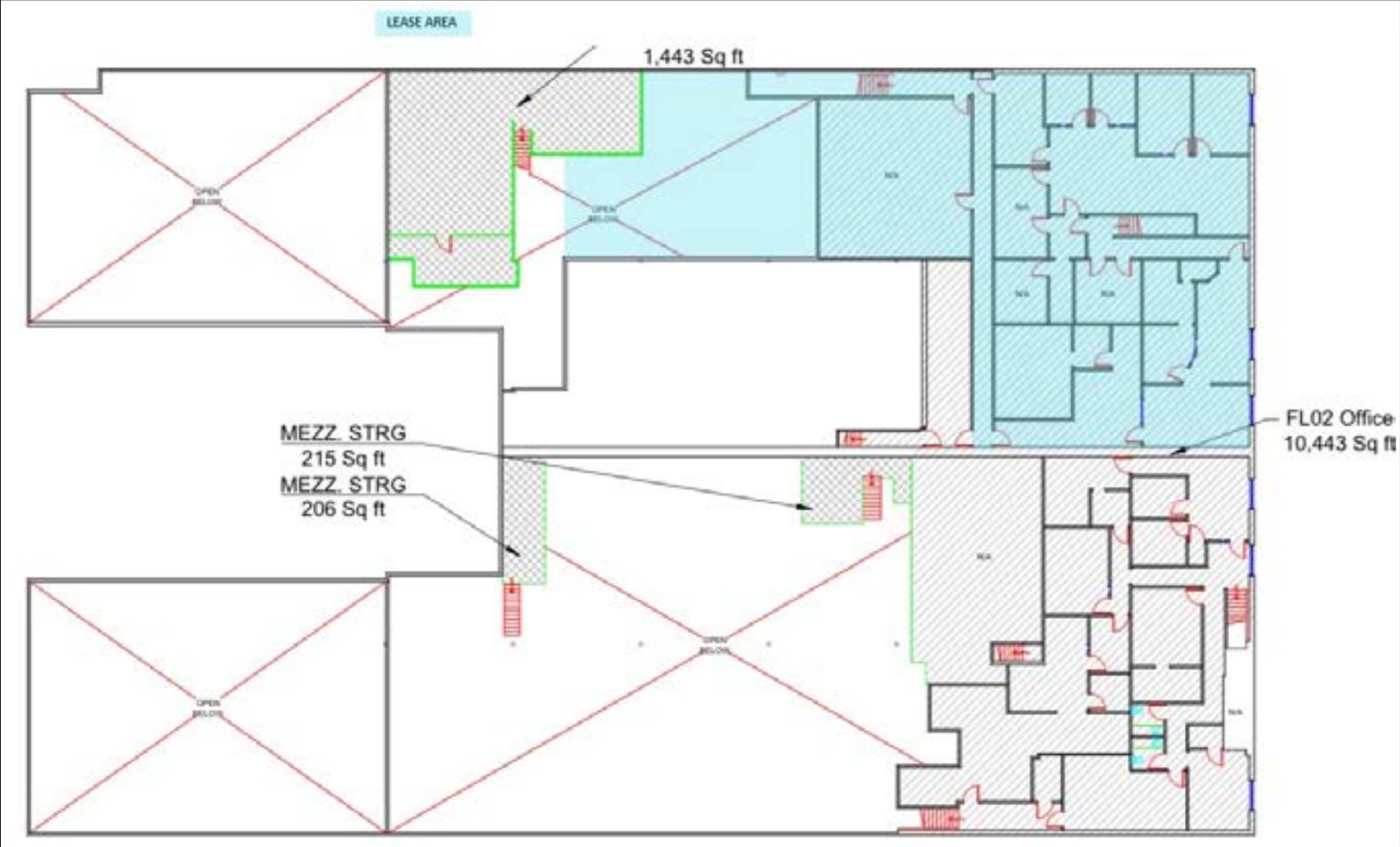

BIRD'S EYE VIEW



AERIAL VIEW



ABOUT APEX CAPITAL REALTY

APEX Capital Realty is an independent commercial real estate brokerage firm. We work directly with a diverse number of real estate and business owners in order to create unique, fulfilling, and lucrative opportunities in the market.

APEX Capital Realty is composed of industry experts and specialists which possess an unparalleled understanding of the unique dynamics and trends that drive the current real estate and business markets. We believe in having a transformative impact in our industry through leadership and advocacy which helps push the creative boundary of what can be achieved. With collaboration ingrained in our company culture, our commercial advisors work hand-in-hand with our clients in order to reach optimal results.





561 NE 79 ST - SUITE 420

Miami, FL 33138

www.APEXCAPITALREALTY.com

YONI SUNSHINE

COMMERCIAL ADVISOR

(216) 973-9534

YONI@APEXCAPITALREALTY.COM

JASON ABITBOL

COMMERCIAL ADVISOR

(561) 542-3704

JASON@APEXCAPITALREALTY.COM

LET'S SIMPLIFY YOUR DEAL!

REAL ESTATE + COMMERCIAL INSURANCE
IN ONE SEAMLESS PROCESS.

**GET A QUOTE FROM
APEX INSURANCE TODAY!**