

FOR LEASE

Denton Center 3

2200 Denton Dr – Suite 103, Austin, TX 78758

11,545 SF



Explore Virtual Tour



BUILDING SPECIFICATIONS

Suite Size:	11,545 SF
Office:	1,370 SF (12%)
Warehouse:	10,175 SF (88%)
Truck Loading:	(2) Dock High (1) Ramp
Clear Height:	22'
Car Parking:	1.32/1000 SF (15 Spaces)
Occupancy:	Available Now



LEASING INFO & CONTACT

Darryl Dadon	(512) 499-4953 / darryl.dadon@cbre.com
Olivia Reed	(512) 482-5591 / olivia.reed@cbre.com
Jake Frickenschmidt	(512) 418-3238 / jake.frickenschmidt@cbre.com

CBRE

LEGEND

- Dock High
- Ramp

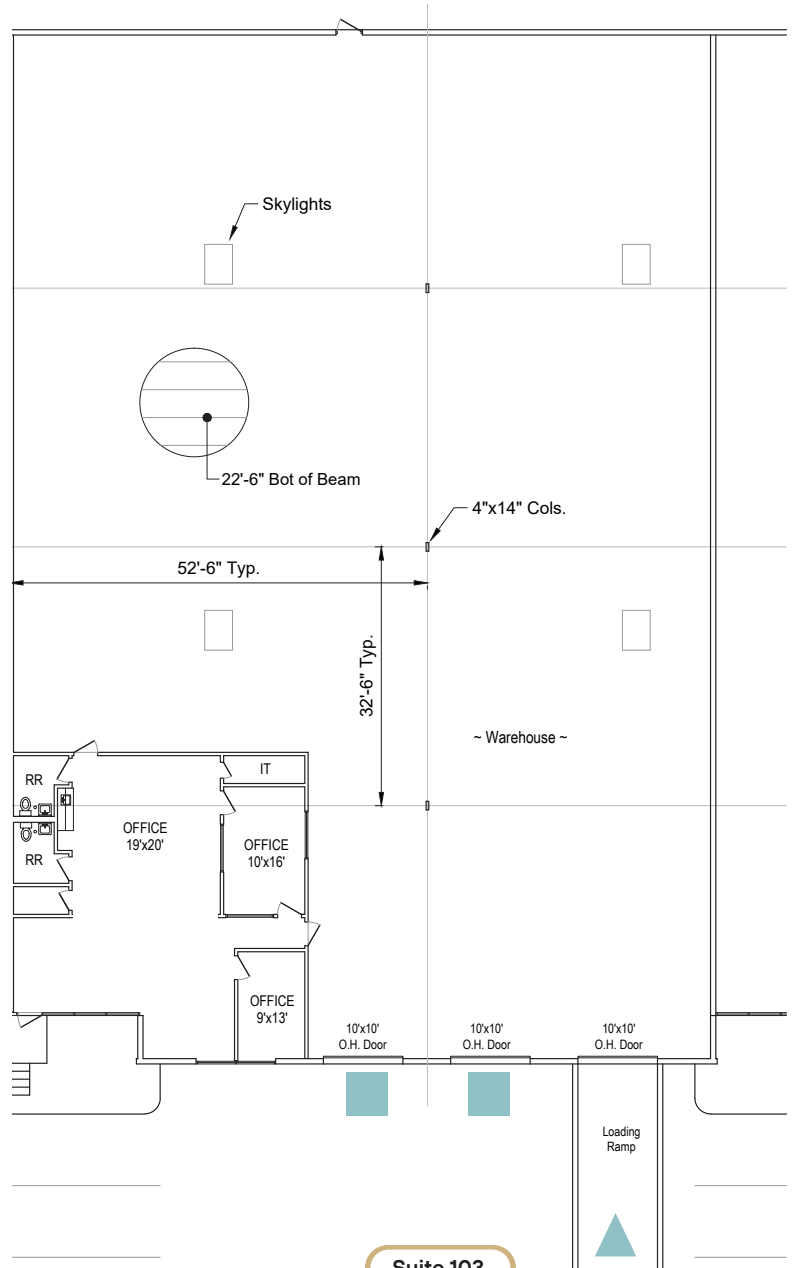

Suite 103

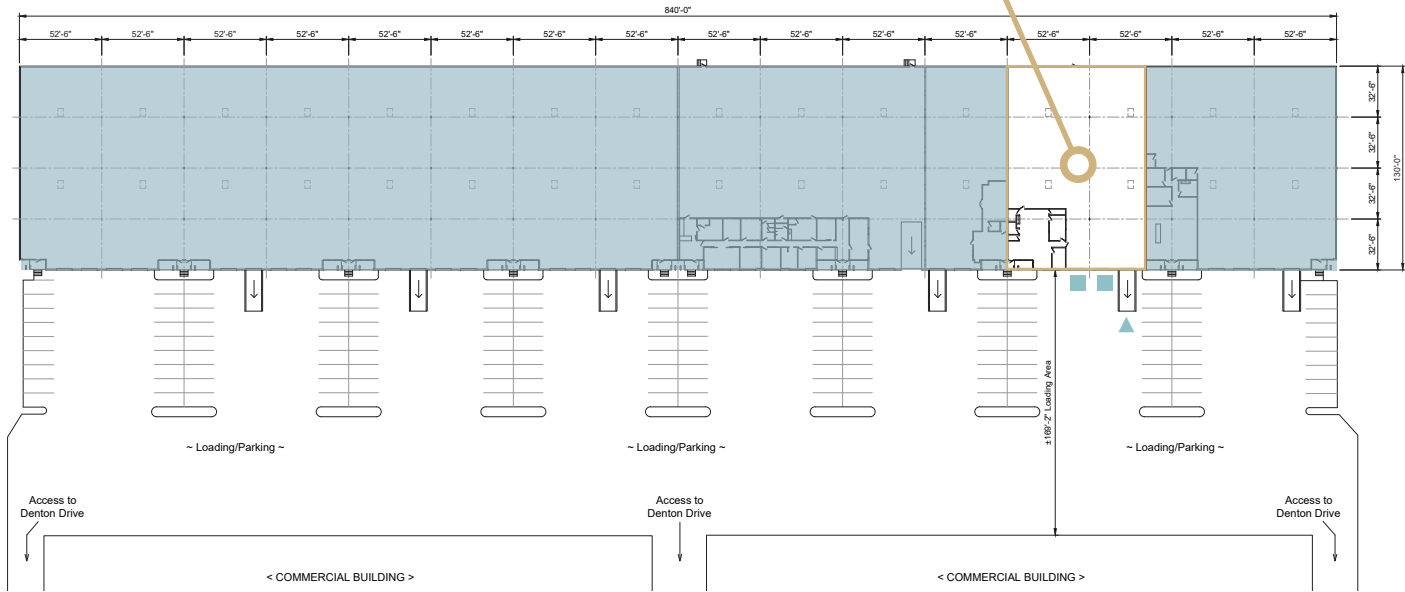

TRANSIT OVERVIEW

TRANSPORTATION

US 183	0.5 miles
MoPac	1.0 mile
Loop 360	2.0 miles
IH-35	3.5 miles
US 290	4.9 miles
Austin-Bergstrom International Airport	15.1 miles

ATTRACTIONS

Q2 Stadium	1.0 mile
Domain	1.0 mile
Shops at Arbor Walk	2.5 miles
Arboretum	3.5 miles
University of Texas	8.3 miles

MAJOR CITIES

Downtown Austin	9.9 miles
Round Rock	13.1 miles
Georgetown	22.0 miles
San Marcos	39.8 miles
San Antonio	104.4 miles
Houston	160.5 miles
Dallas	189.1 miles

