

1,656 SF INDUSTRIAL SUITE FOR LEASE



OCEAN VISTA INDUSTRIAL PARK

2605 TEMPLE HEIGHTS DRIVE, OCEANSIDE, CA 92056

property description

- Corner of Oceanside Blvd. and Temple Heights Drive
- 16' clear height
- 2.2/1,000 SF parking
- 100 amps 120/208 power
- Grade level loading
- Proximity to bus stop, major retail and restaurants
- Quick access to 78 Freeway and Highway 76
- **LEASE RATE: \$1.55 PSF + CAM (\$0.10 PSF)**



Address	Suites	SF	Base Rent	CAM	Availability	Comments
2605 Temple Heights Drive	E	1,656 SF	\$1.55 PSF	\$0.10 PSF	Now	Reception, Office, Restroom, & Warehouse with 1 Grade Level Door

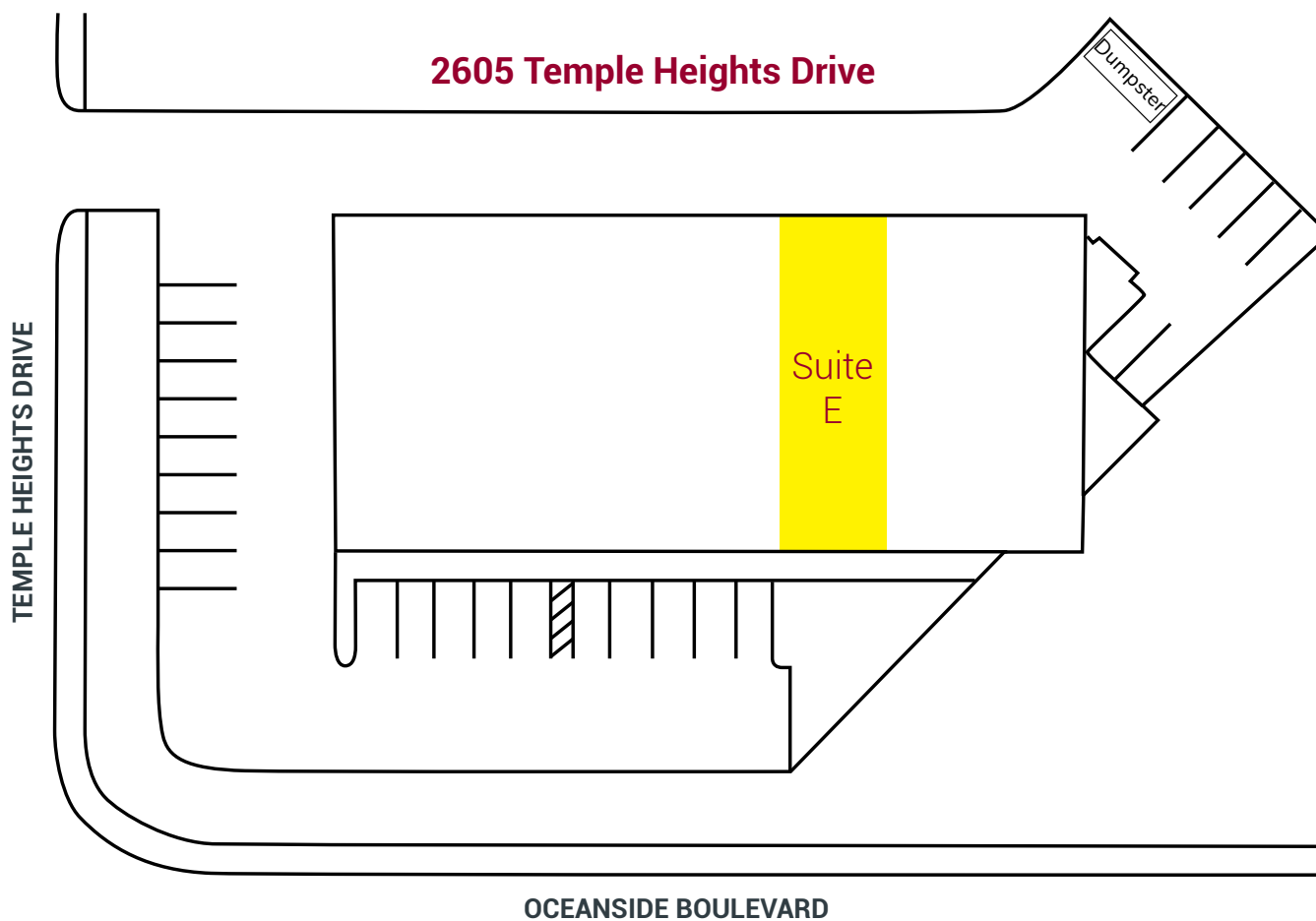

SUITE DESCRIPTION

BUILDING ADDRESS:	2605 Temple Heights Drive
SUITE:	E
SQUARE FEET:	1,656 SF
LEASE RATE:	\$1.55 PSF + CAM (\$0.10 PSF)
COMMENTS:	Reception, Office, Restroom, & Warehouse with 1 Grade Level Door
AVAILABILITY:	Now

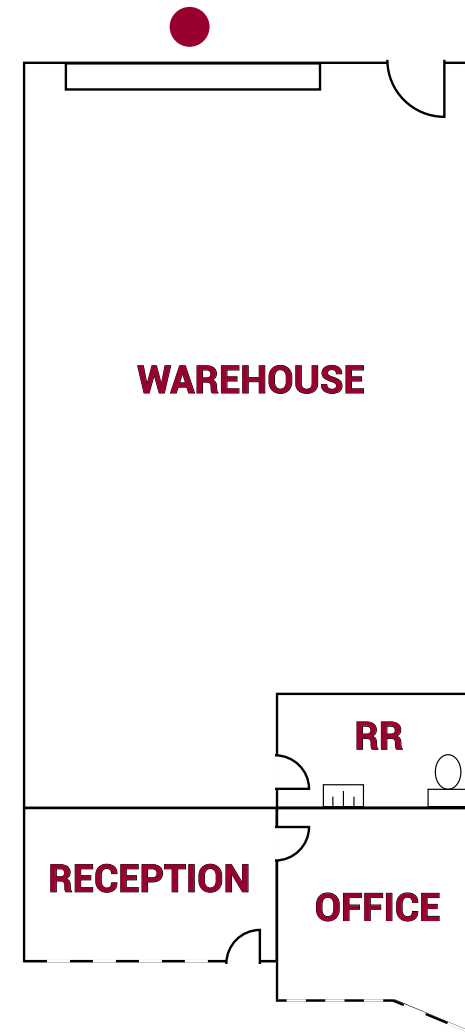

● Grade Level Door - - - - Glassline

No warranty or representation is made to the accuracy of the foregoing transaction. Terms of sale or lease and availability are subject to change or withdraw without notice.

location map

1,656 SF SUITE FOR LEASE

2605 TEMPLE HEIGHTS DRIVE, OCEANSIDE, CA 92056

