

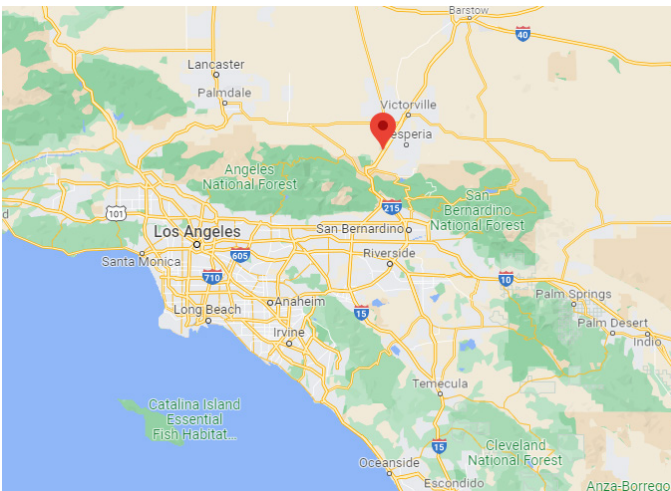

BUILDING SIZE 1,004,400 SF | AVAILABILITY 1,004,400 SF

Hesperia Commerce Center

8130 Caliente Road, Hesperia, CA



PROPERTY SPECIFICATIONS

- Total Building SF: 1,004,400 SF
- Office SF: 9,860 SF
- Building Dimensions: 1,620' x 620'
- Clear Height: 40'
- Column Spacing: 50' x 56' with 60' speed bays
- Car Parking: 524
- Trailer Stalls: 350
- Dock High Doors: 184 (9' x 10')
- Drive in Doors: 4 (10' x 14')
- Sprinklers: ESFR (K-25)
- Slab: 8"
- Power: 4,000 Amps, 480/270V, 3p4w
- Skylights: 1.5%
- Zoning: CIBP (Commercial/ Industrial Business Park – City of Hesperia)
- Utilities: Water – City of Hesperia, Sewer – City of Hesperia, Electric – SoCal Edison, Gas – Southwest Gas, Fiber – Verizon & Charter





BUILDING SIZE 1,004,400 SF | AVAILABILITY 1,004,400 SF

Hesperia Commerce Center

8130 Caliente Road, Hesperia, CA

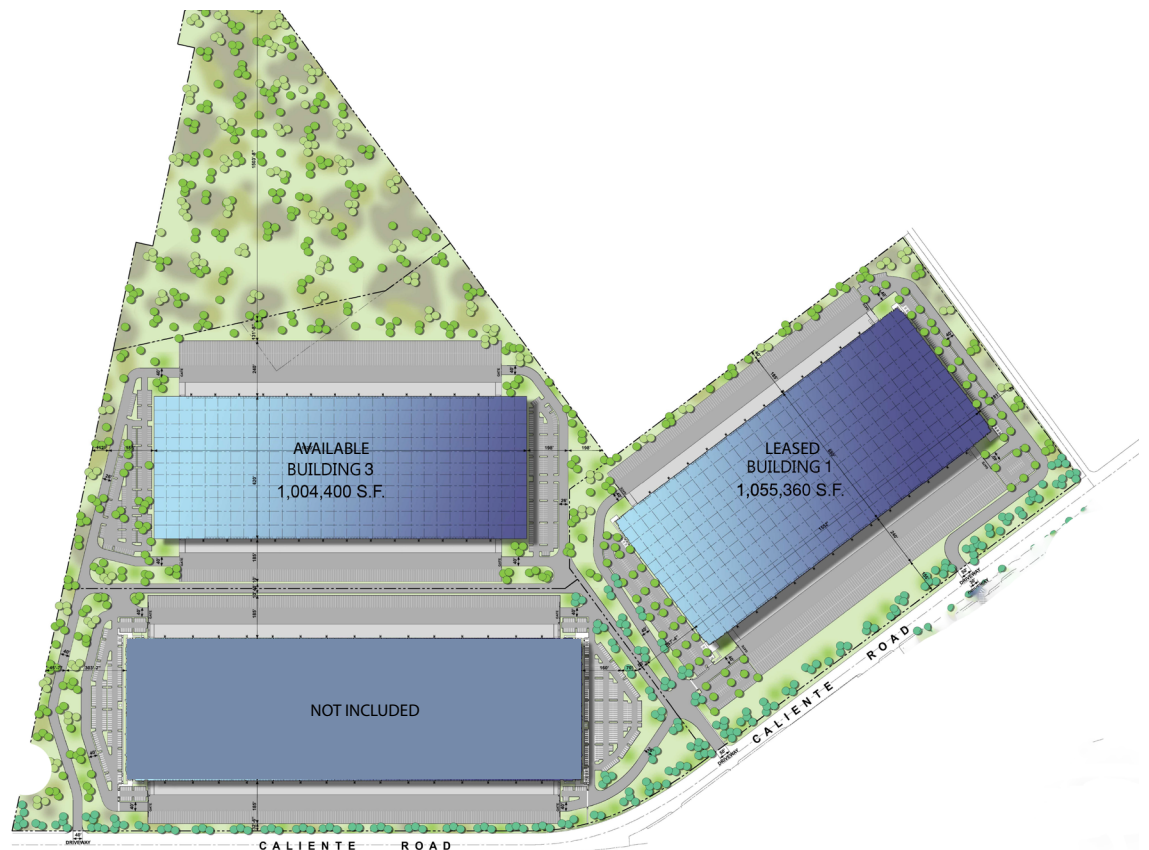

Hesperia Commerce Center

8130 Caliente Road, Hesperia, CA

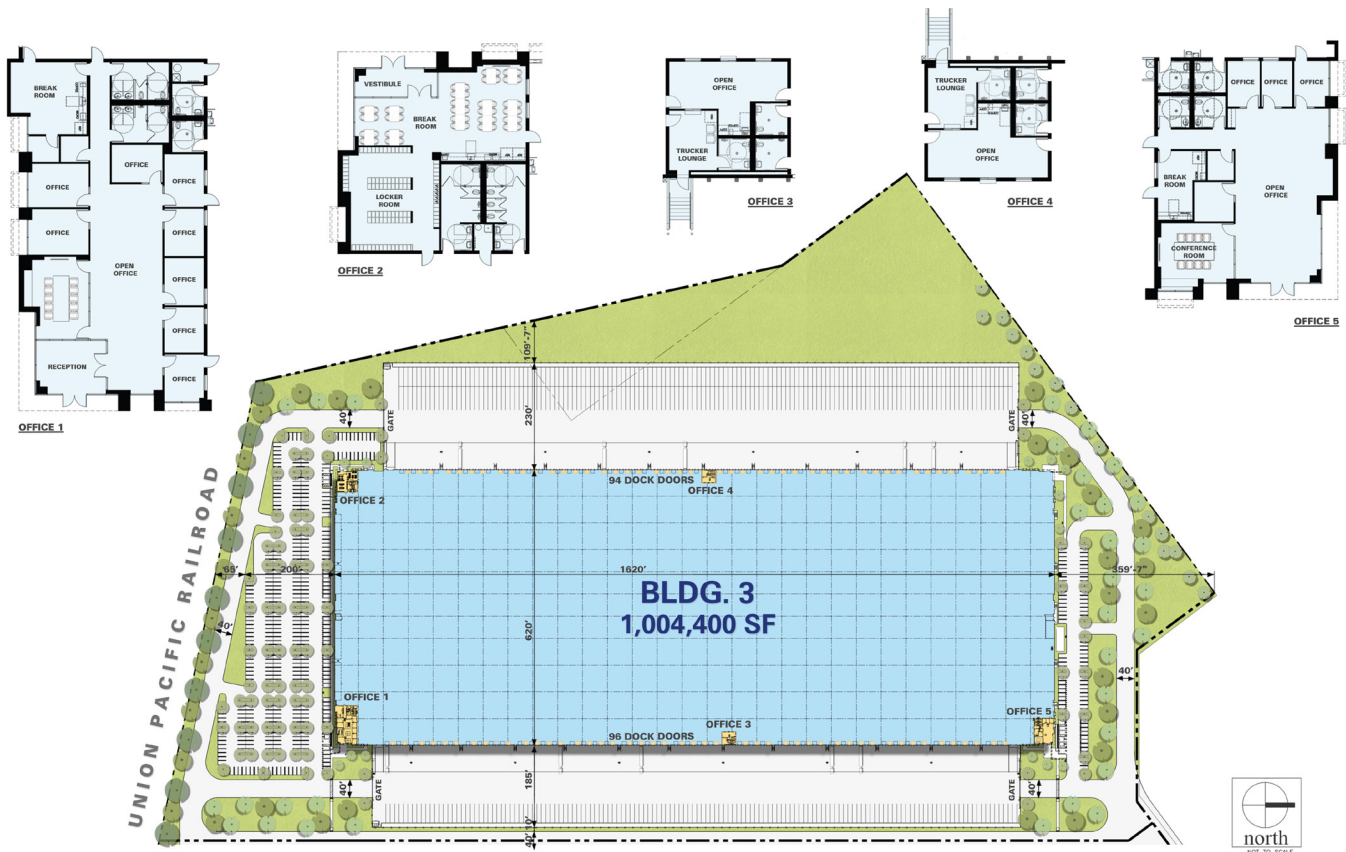

BUILDING IMPROVEMENTS

- LED warehouse lighting
- 9,860 SF Office
 - SW Office - Breakroom, locker room, restrooms = 2,130 SF
 - SE Office - Open office, (4) private offices, (1) conference, (1) break room, restrooms = 3,280 SF
 - NE Office - Open office (1) private office, (1) conference, (1) break room, restrooms = 2,560 SF
- Shipping Office - Office, trucker lounge, restrooms = 950 SF
- Receiving Office - Office, trucker lounge, restrooms = 940 SF
- 50% (95) 6'x8' 40,000 lb mechanical pit levelers
- 50% (95) 30,000 lb edge of dock levelers
- MM80 all joints