

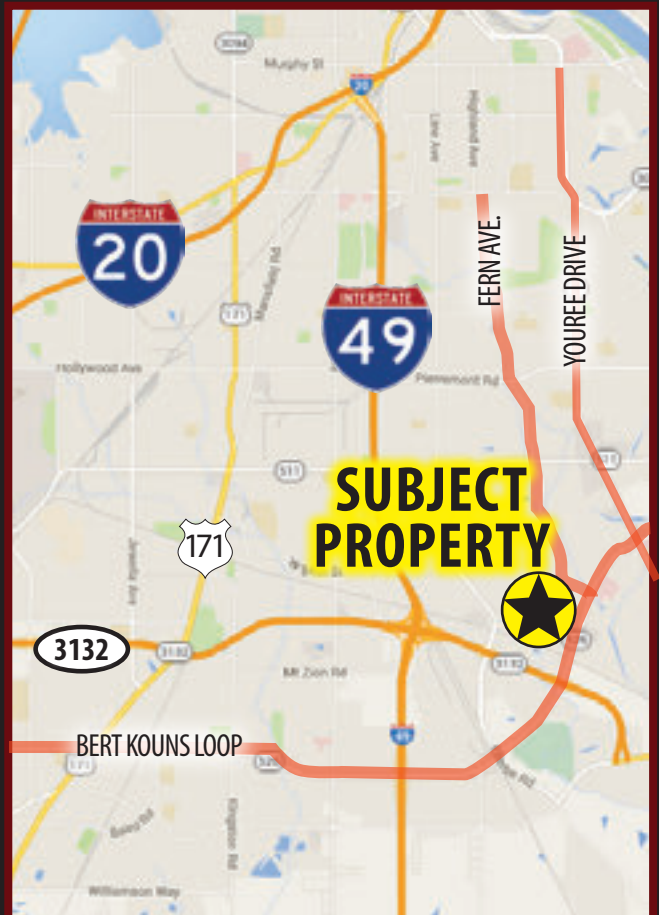

BUSINESS PARK LOT FOR SALE/BUILD TO SUIT

BUSINESS PARK DR., LOT 6, PIERRE PLACE
SUBDIVISION, SHREVEPORT, LA 71105

- 1,654 Square Feet
- GREAT Location In Southeast Shreveport
- Easy Access To Fern Avenue, 70th Street, Bert Kouns Loop and Highway 3132
- 49,556 Average Cars Per Day on Bert Kouns @ Business Park Drive
- Build To Suit
- Sale Price: \$58,500



For more information, contact:

Jason Brady | 318.222.2244 | jbrady@vintagerealty.com

ALL INFORMATION CONTAINED HEREIN IS BELIEVED TO BE ACCURATE, BUT IS NOT WARRANTED AND NO LIABILITY OF ERRORS OR OMISSIONS IS ASSURED BY EITHER THE PROPERTY OWNER OR VINTAGE REALTY COMPANY OR ITS AGENTS AND EMPLOYEES. PRICES AS STATED HEREIN AND PRODUCT AVAILABILITY IS SUBJECT TO CHANGE AND/OR SALE OR LEASE WITHOUT PRIOR NOTICE, AND ALL SIZES AND DIMENSIONS ARE SUBJECT TO CORRECTION. REV 9/2020



BUSINESS PARK LOT FOR SALE/BUILD TO SUIT

BUSINESS PARK DR., LOT 6, PIERRE PLACE
SHREVEPORT, LA 71105

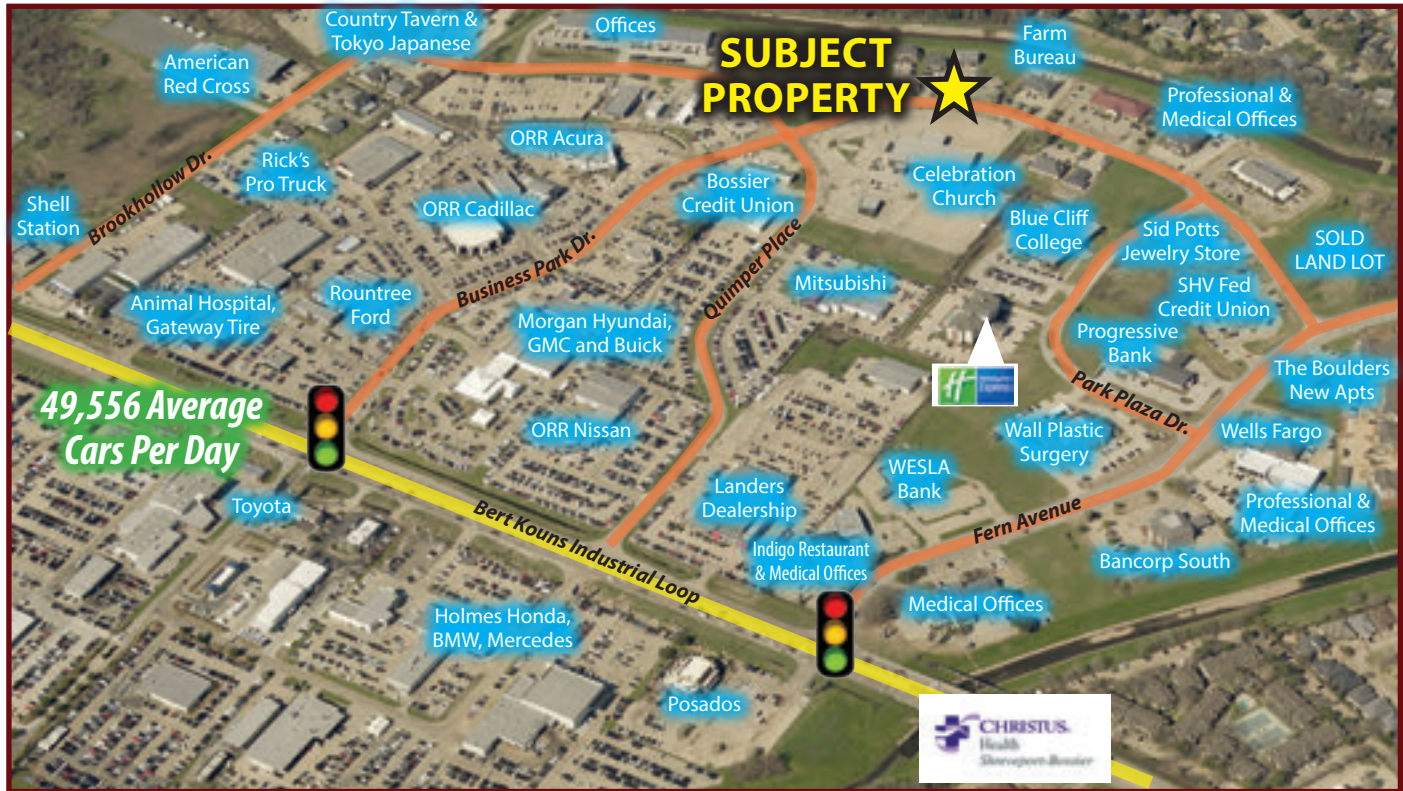

2020 DEMOGRAPHICS

	Population	Avg Household Income	Households
1 mile	8,207	\$83,613	3,406
3 mile	49,827	\$76,343	20,032
5 mile	132,156	\$68,099	51,049

Source: U.S. Census Bureau, Census 2010 Summary File 1. Esri forecasts for 2020



For more information, contact:

Jason Brady | 318-222-2244

jbrady@vintagerealty.com | vintagerealty.com

ALL INFORMATION CONTAINED HEREIN IS BELIEVED TO BE ACCURATE, BUT IS NOT WARRANTED AND NO LIABILITY OF ERRORS OR OMISSIONS IS ASSURED BY EITHER THE PROPERTY OWNER OR VINTAGE REALTY COMPANY OR ITS AGENTS AND EMPLOYEES. PRICES AS STATED HEREIN AND PRODUCT AVAILABILITY IS SUBJECT TO CHANGE AND/OR SALE OR LEASE WITHOUT PRIOR NOTICE, AND ALL SIZES AND DIMENSIONS ARE SUBJECT TO CORRECTION. 9/2020