



GLACIER STREET
Coquitlam, BC
150

FOR LEASE
DEVELOPMENT-READY
10 ACRE BUILD-TO-SUIT SITE



THE OPPORTUNITY

On behalf of QuadReal, JLL is proud to introduce 150 Glacier Street, Coquitlam, an innovative, purpose-built last-mile distribution facility designed to meet the warehousing and transportation needs of e-commerce and logistics providers.

This planned 128,000 square-foot building on 10.3 acres is located in the Pacific Reach area of Coquitlam, BC, the foremost distribution location in the Greater Vancouver Area, serving 2.9 million people with over \$138 billion in annual consumption. 150 Glacier offers unparalleled access to the largest concentration of consumers and businesses in Western Canada, with excellent proximity to highways 1, 7, and 7B.

 **Building Size**
~128,000 sq. ft.

 **Dock Doors**
25

 **Site Size**
10.3 acres

 **Drive-in Doors**
2

 **Clear Heights**
32.0'

 **Truck Court**
186

Property Highlight

Site is development ready

Freestanding building with **efficient building configuration at 32' clear height**

Separate passenger vehicle **parking lot**

Ability to fence/**secure loading court**

Conveniently located with direct access to **Lougheed Highway and Highway 1**

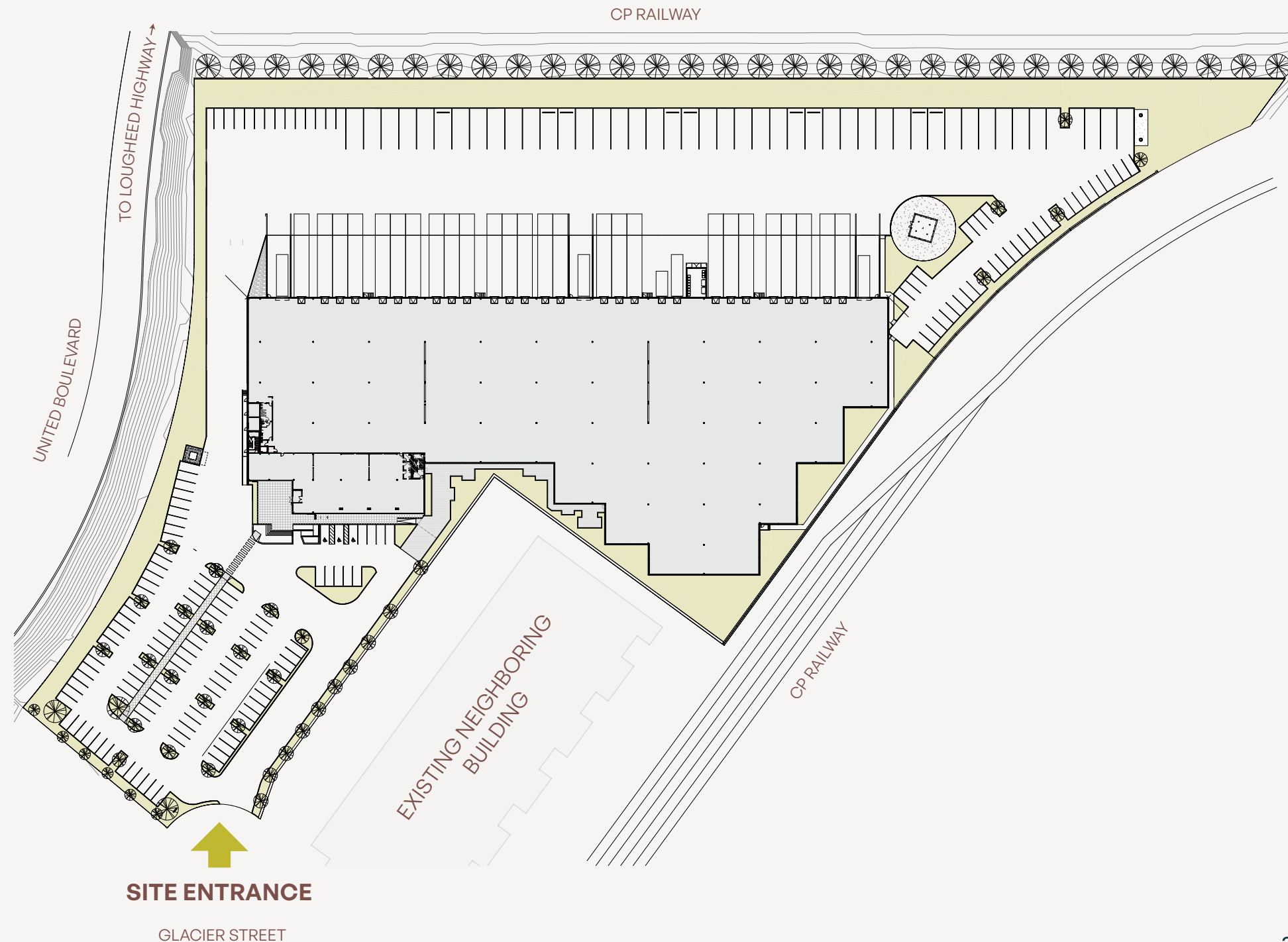

30 KILOMETERS

2.9 MILLION
POPULATION

1.74 %
ANNUAL POPULATION
GROWTH

\$138 BILLION
ANNUAL
CONSUMPTION

40
MEDIAN
AGE

1.5 MILLION
TOTAL
LABOUR FORCE

United Blvd	~2.0 Minutes	~0.35 KM
Highway 7	~2.0 Minutes	~0.75 KM
Highway 7B	~2.0 Minutes	~1.0 KM
Highway 1	~4.0 Minutes	~3.0 KM
Guildford Town Centre	~10.0 Minutes	~7.4 KM
Downtown Vancouver	~35.0 Minutes	~27.7 KM
Vancouver Intl Airport	~43.0 Minutes	~33.1 KM
US Border	~45.0 Minutes	~34.4 KM

RICHMOND

NORTH
VANCOUVER

PORT MOODY

COQUITLAM

PORT
COQUITLAM

PITT MEADOWS

LOUGHEED HWY

BURNABY

HWY1

150ST
GLACIER

HWY 7

HWY 7B

NEW
WESTMINSTER

HWY1

SURREY

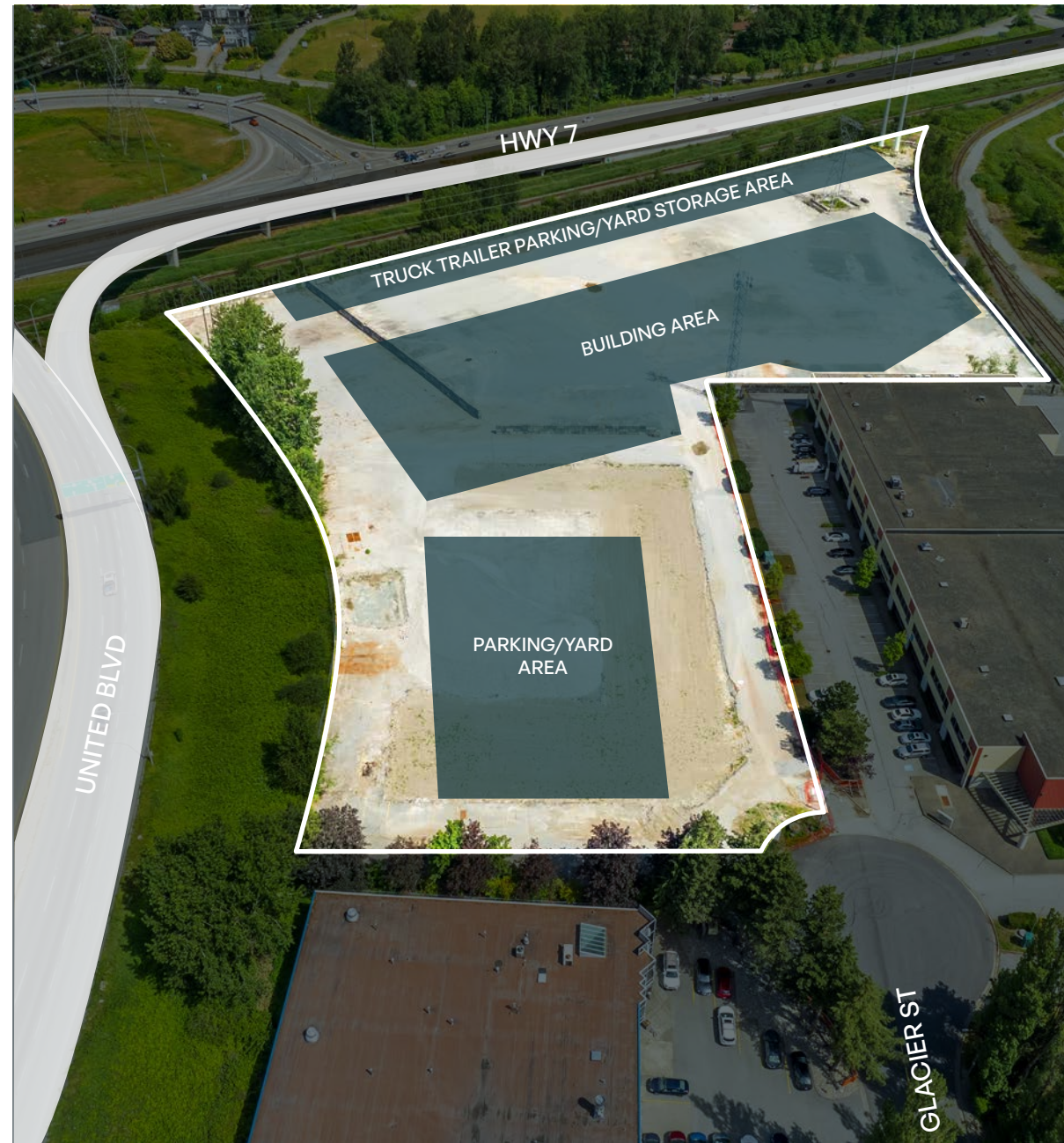



jll.com

510 West Georgia Street, Suite 2150

Vancouver, BC V6B 0M3

Jones Lang LaSalle Real Estate Services, Inc.

GLACIER STREET
Coquitlam, BC
150

BAKTASH KASRAEI, SIOR

Executive Vice President

+1 604 998 6016

baktash.kasraei@jll.com

MIKE THOMPSON*

Executive Vice President

+1 604 809 5836

mike.thompson@jll.com

*Personal Real Estate Corporation

© 2024 Jones Lang LaSalle Real Estate Services, Inc. All rights reserved. Information set out herein (the "Information") has not been verified by Jones Lang LaSalle Real Estate Services, Inc., Brokerage and any and all of its real estate agents/staff, and to all other divisions of the company (collectively "JLL"). JLL does not represent, warrant or guarantee the accuracy, correctness and completeness of the Information. Given the limitations of the investigations, inquiries and verification that JLL have undertaken, the reliability of this Information must be treated with a suitable degree of caution and neither JLL or any of their affiliates accept any liability or responsibility for the accuracy or completeness of the information contained herein and no reliance should be placed on the information contained in this document. JLL does not accept or assume any responsibility or liability, direct or consequential, for the Information or the recipient's reliance upon the Information. The recipient of the Information should take such steps as the recipient may deem necessary to verify the Information prior to placing any reliance upon the Information. The Information may change and any property described in the Information may be withdrawn from the market at any time without notice or obligation to the recipient from JLL.