



# FOR LEASE/SALE

12838 Weber Way, Hawthorne, CA 90250

**11,685 SF Industrial Building**

**\$1.39/SF Gross / \$4,260,000**



## FEATURES

Available Square Footage	11,685
Land Square Footage	22,712
Office Square Footage	1,952
Parking	15
Loading	3 Ground Level Doors
Minimum Ceiling Clearance	13'-18'
Power	600 Amps, 120/240 Volts, 3P, 4W
Sprinkler System	Yes
Year Built	1949
Construction	Concrete Tilt-Up
Zoning	M2

## HIGHLIGHTS

- Fenced Concrete Yard Area
- Excellent Single Tenant Building
- Excellent Hawthorne Location
- Asking Lease Rate is for a 2 Year Lease Term

## ACCESSIBILITY

### MILES TO

Los Angeles International Airport	7.0
Long Beach Airport	18.0
Los Angeles & Long Beach Ports (both)	20.5
Intermodal Container Transfer Facility	14.0

### IMMEDIATE ACCESS TO

- 405, 110, 105, Freeways
- Alameda Corridor



### COLIN LANCASTER

Cal DRE Lic# 02197733

310.436.6488

clancaster@lareminc.com



### DIMITRI PETRAKIS

Cal DRE Lic# 02208946

310.620.8770

dpetrakis@lareminc.com



### WESLEY BABI

Cal DRE Lic# 01822752

310.436.6481

wbabi@lareminc.com

310.719.1585 // [www.lareminc.com](http://www.lareminc.com)

165 Savarona Way, Carson, California 90746

**TRUSTED INDUSTRIAL REAL ESTATE SOLUTIONS SINCE 1993**

The information above has been obtained from sources believed reliable. While we do not doubt its accuracy, we have not verified it and make no guarantee, warranty or representation about it. It is your responsibility to independently confirm its accuracy and completeness. Any projections, options, assumptions or estimates used are for example only and do not represent the current or future performance of the property. The value of this transaction to you depends on tax and other factors which should be evaluated by your tax, financial and legal advisors. You and your advisors should conduct a careful, independent investigation of the property to determine to your satisfaction the suitability of the property for your needs.



# FOR LEASE

12838 Weber Way, Hawthorne, CA 90250

## SITE PLAN

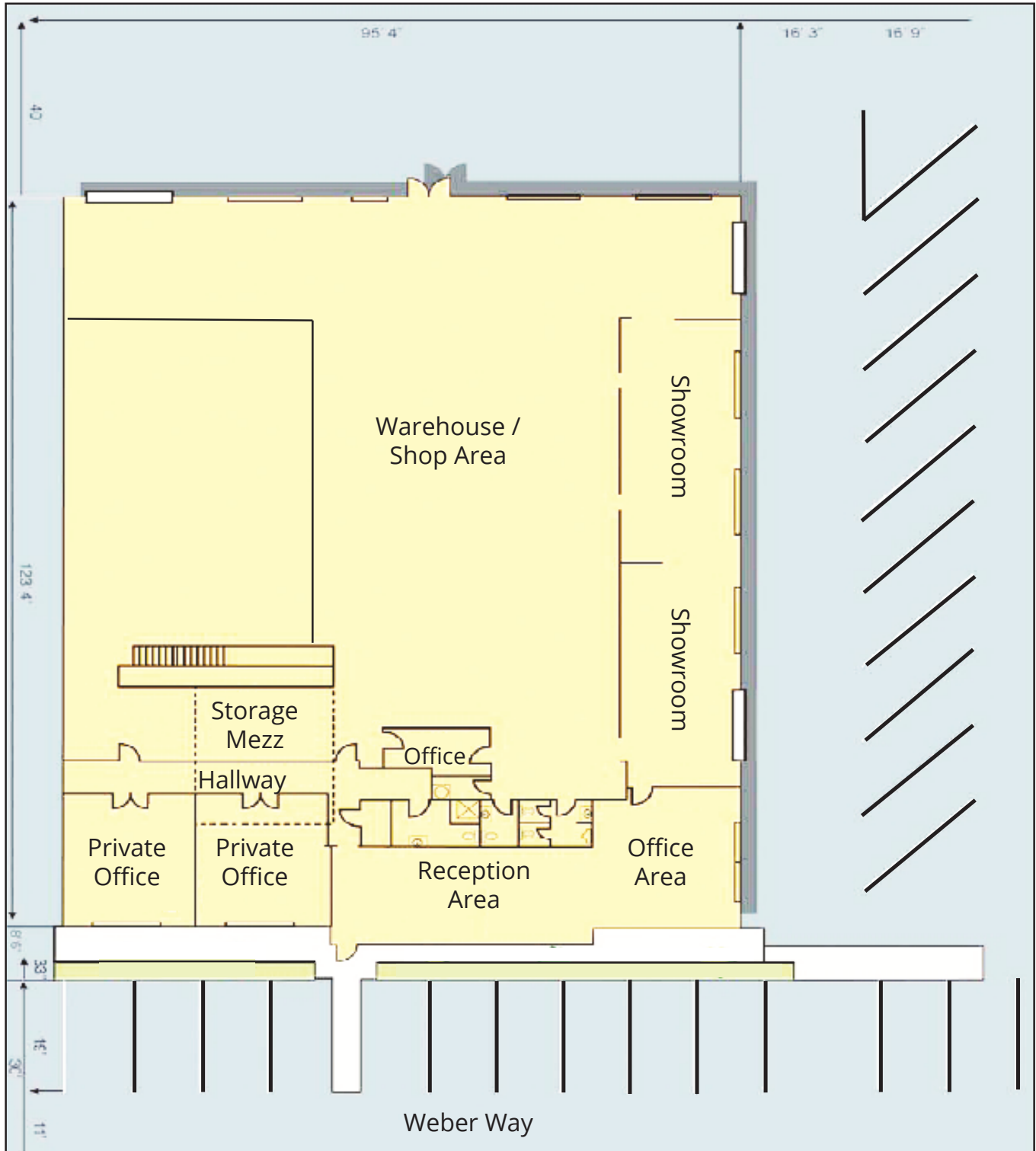

The information above has been obtained from sources believed reliable. While we do not doubt its accuracy, we have not verified it and make no guarantee, warranty or representation about it. It is your responsibility to independently confirm its accuracy and completeness. Any projections, options, assumptions or estimates used are for example only and do not represent the current or future performance of the property. The value of this transaction to you depends on tax and other factors which should be evaluated by your tax, financial and legal advisors. You and your advisors should conduct a careful, independent investigation of the property to determine to your satisfaction the suitability of the property for your needs.

310.719.1585 // [www.lareminc.com](http://www.lareminc.com)  
165 Savarona Way, Carson, California 90746

TRUSTED INDUSTRIAL REAL ESTATE SOLUTIONS SINCE 1993