

BISSELL HILLS SHOPPING CENTER

10009 BELLEFONTAINE RD, ST. LOUIS, MO 63040



About The Property

- Located at the intersection of Chambers Rd and Bellefontaine Rd, which carries a combined traffic count of 25,000 VPD
- Total square footage is 36,294 SF
- 3,743 SF and 3,444 SF suites available
- Property is accessible from both Chambers Rd and Bellefontaine Rd
- Site benefits from surrounding population density with over 10,000 people within one mile
- New façade and parking improvements
- Ideal for retail and service oriented users

RETAIL SPACE NEXT TO RULER FOODS AVAILABLE FOR LEASE

Paul Fusz

First Vice President
+1 314 655 6046
paul.fusz@cbre.com

Charlie Faron

Associate
+1 314 655 5922
Charlie.faron@cbre.com

LISTED BY



PROPERTY MANAGED BY



BISSELL HILLS SHOPPING CENTER

10009 BELLEFONTAINE RD, ST. LOUIS, MO 63040

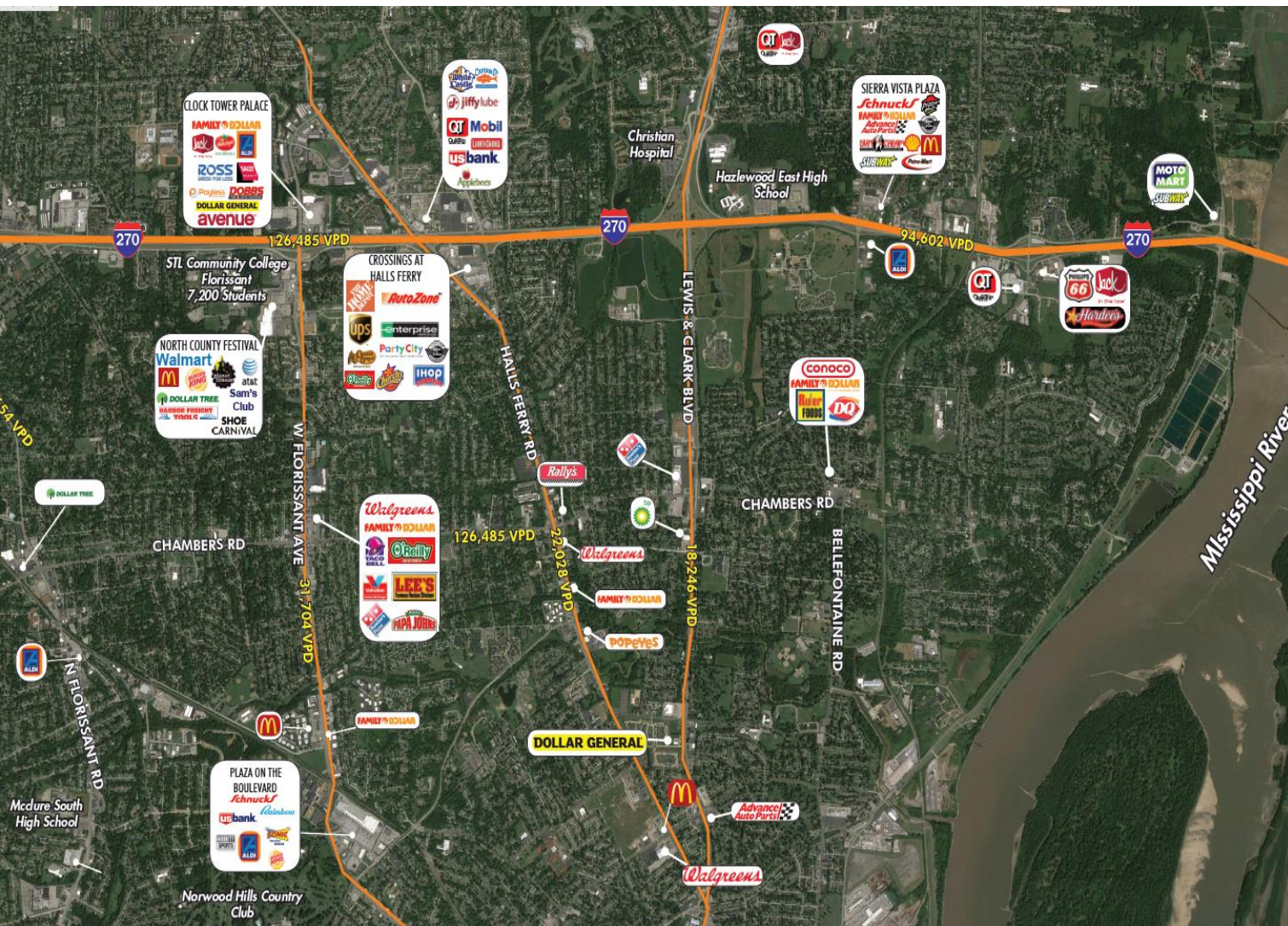

Property Description

- **Total Square Footage**
36,294 SF
- **Lease Rate**
Call Broker For Details
- **Zoning**
Commercial

Paul Fusz
First Vice President
+1 314 655 6046
paul.fusz@cbre.com

Charlie Faron
Associate
+1 314 655 5922
Charlie.faron@cbre.com

LISTED BY **CBRE**

PROPERTY MANAGED BY **1045 LLC**

BISSELL HILLS SHOPPING CENTER

10009 BELLEFONTAINE RD, ST. LOUIS, MO 63040

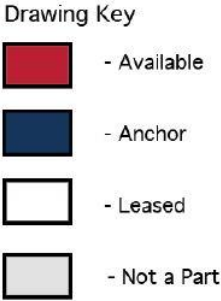
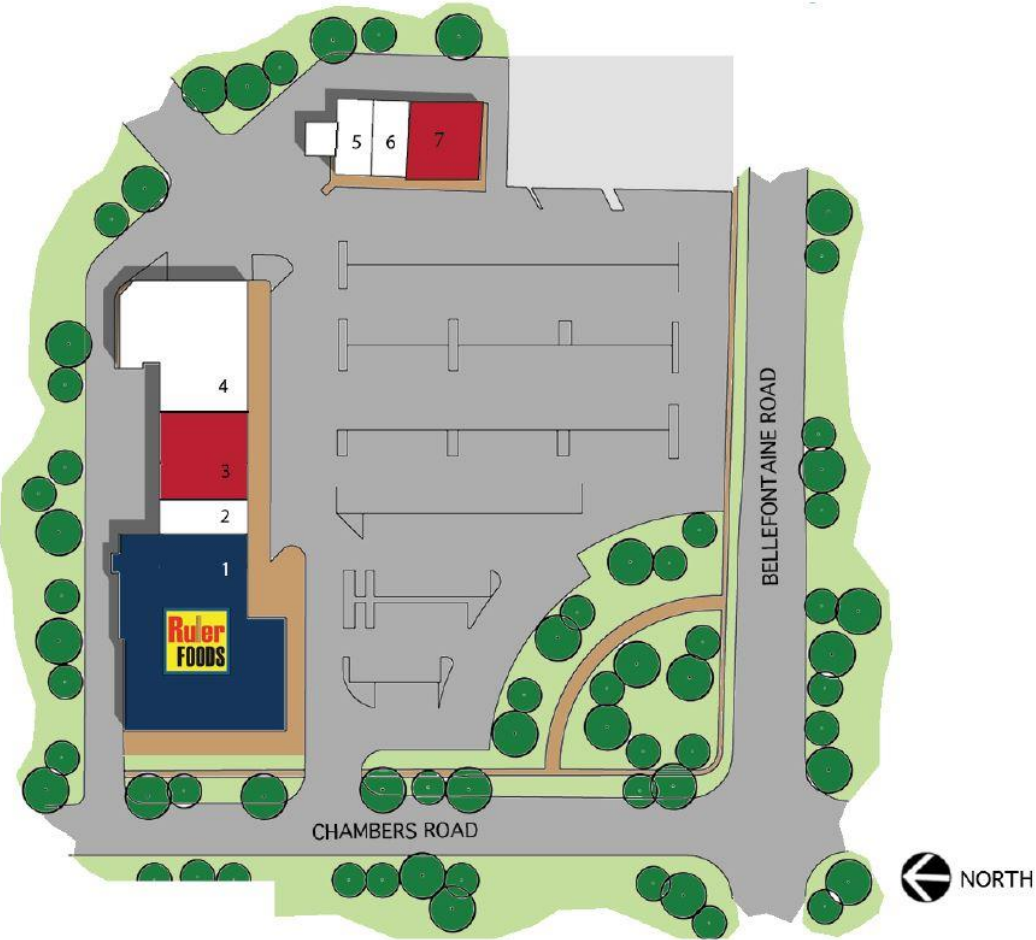

Center Details

UNIT	TENANT	SQ. FT.
1	Ruler Foods	15,000 SF
2	Boost Mobile	1,584 SF
3	AVAILABLE	3,743 SF
4	Family Dollar	11,079 SF
5	Rosa Nails	1,921 SF
6	St. Louis Fish & Chicken	1,523 SF
7	AVAILABLE	3,444 SF

Paul Fusz
 First Vice President
 +1 314 655 6046
paul.fusz@cbre.com

Charlie Faron
 Associate
 +1 314 655 5922
Charlie.faron@cbre.com



BISSELL HILLS SHOPPING CENTER

10009 BELLEFONTAINE RD, ST. LOUIS, MO 63040

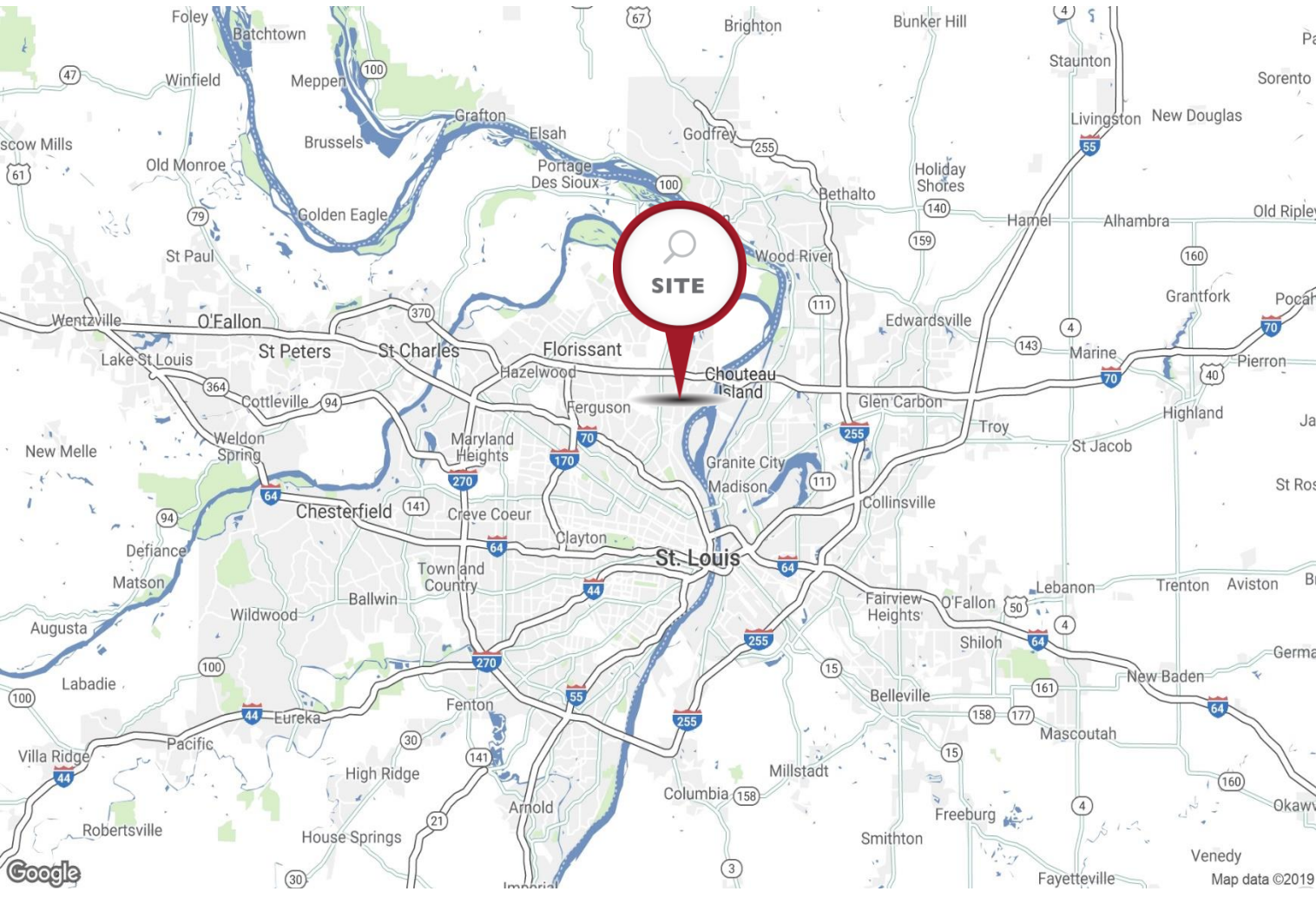

2018 Demographics

POPULATION

1 Mile	3 Miles	5 Miles
10,823	84,335	177,042

MEDIAN AGE

1 Mile	3 Miles	5 Miles
39.6	35.5	36.7

COLLEGE EDUCATION

1 Mile	3 Miles	5 Miles
26%	27%	28%

MEDIAN HH INCOME

1 Mile	3 Miles	5 Miles
\$39,858	\$38,099	\$39,824

DAYTIME POPULATION

1 Mile	3 Miles	5 Miles
7,917	68,090	152,315

Paul Fusz
 First Vice President
 +1 314 655 6046
paul.fusz@cbre.com

Charlie Faron
 Associate
 +1 314 655 5922
Charlie.faron@cbre.com

LISTED BY **CBRE**

PROPERTY MANAGED BY



©2019 CBRE, Inc. All rights reserved. This information has been obtained from sources believed reliable, but has not been verified for accuracy or completeness. You should conduct a careful, independent investigation of the property and verify all information. Any reliance on this information is solely at your own risk. CBRE and the CBRE logo are service marks of CBRE, Inc. All other marks displayed on this document are the property of their respective owners. Photos herein are the property of their respective owners. Use of these images without the express written consent of the owner is prohibited.