

# 8801 RESEARCH DRIVE

**NEWMARK**

FOR LEASE 6,000 RSF | IRVINE, CA





# 8801 RESEARCH DRIVE

8801 Research Drive is a one of a kind opportunity to lease a piece of Irvine history. The building was the showcase office and sales office of the developer, Bacchus Development. The building features extensive glass line on all four sides with timeless creative office finishes. Users will enjoy the fully operable kitchen with Viking appliances; a mechanized roll up door; and free surface drive up parking. The building is located minutes away from the Irvine Spectrum and the Los Olivos retail center.





Rental Rate/Month  
\$1.90/SF NNN



Single-Story  
Standalone Building



High End Finishes with  
Operable Kitchen



Building Top Signage



5.4B Design  
Professional Zoning



Minutes from the  
Irvine Spectrum



DRIVE

807  
RESEARCH



## 6,000 RSF

Vacant high-end creative office featuring five (5) individual offices, a conference room, a fully operable kitchen, open common area, private restrooms and a roll-up door.

[Click here for video tour](#)

**8801** **DRIVE**  
RESEARCH

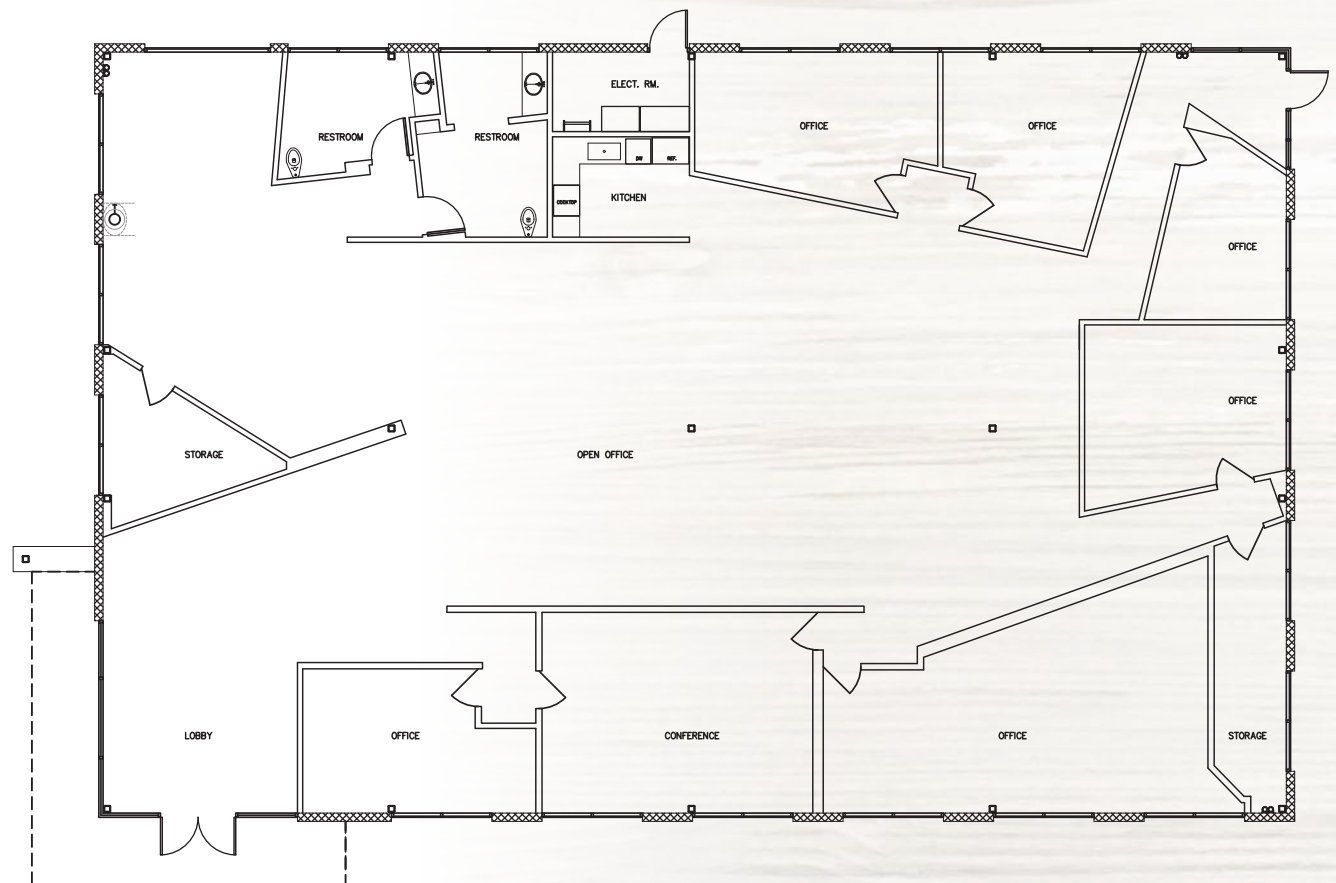



**Richard P. Sung**  
*Managing Director*

t 949-608-2178  
m 408-205-3412  
richard.sung@nmrk.com  
CA RE Lic. #01953211

**Andrew Robben**  
*Senior Managing Director*

t 949-608-2073  
m 949-400-5855  
andrew.robben@nmrk.com  
CA RE Lic. #01372891

8801  
RESEARCH DRIVE



**NEWMARK**

18401 Von Karman Avenue  
Suite 150  
Irvine, CA 92612

CORPORATE LICENSE #01355491

The distributor of this communication is performing acts for which a real estate license is required. The information contained herein has been obtained from sources deemed reliable but has not been verified and no guarantee, warranty or representation, either express or implied, is made with respect to such information. Terms of sale or lease and availability are subject to change or withdrawal without notice.

**nmrk.com**