

# PROFESSIONAL OFFICE BUILDING FOR SALE

## Owner/User or Investment

- Beautiful Well-Maintained Center
- Easy Access to I-10 via Cook St.
- Zoning: SI (Service Industrial)
- APN: 634-260-029

**For Sale!!**  
**\$1,799,000**



75150 Sheryl Avenue, Palm Desert, CA 92211

**Baxley**  
Properties, Inc.

www.baxleyproperties.com  
Phone: 760-773-3310  
Fax: 760-773-3013  
73712 Alessandro Drive, Ste B-4,  
Palm Desert, CA 92260

**Building Size: 7,800 SF**

**Matthew Longstreth**  
matthew@baxleyproperties.com  
**Ofc: 760-773-3310**  
**Cell: 949-293-1314**  
DRE# 01322594

# PROFESSIONAL OFFICE BUILDING FOR SALE

75150 Sheryl Avenue, Palm Desert, CA 92211

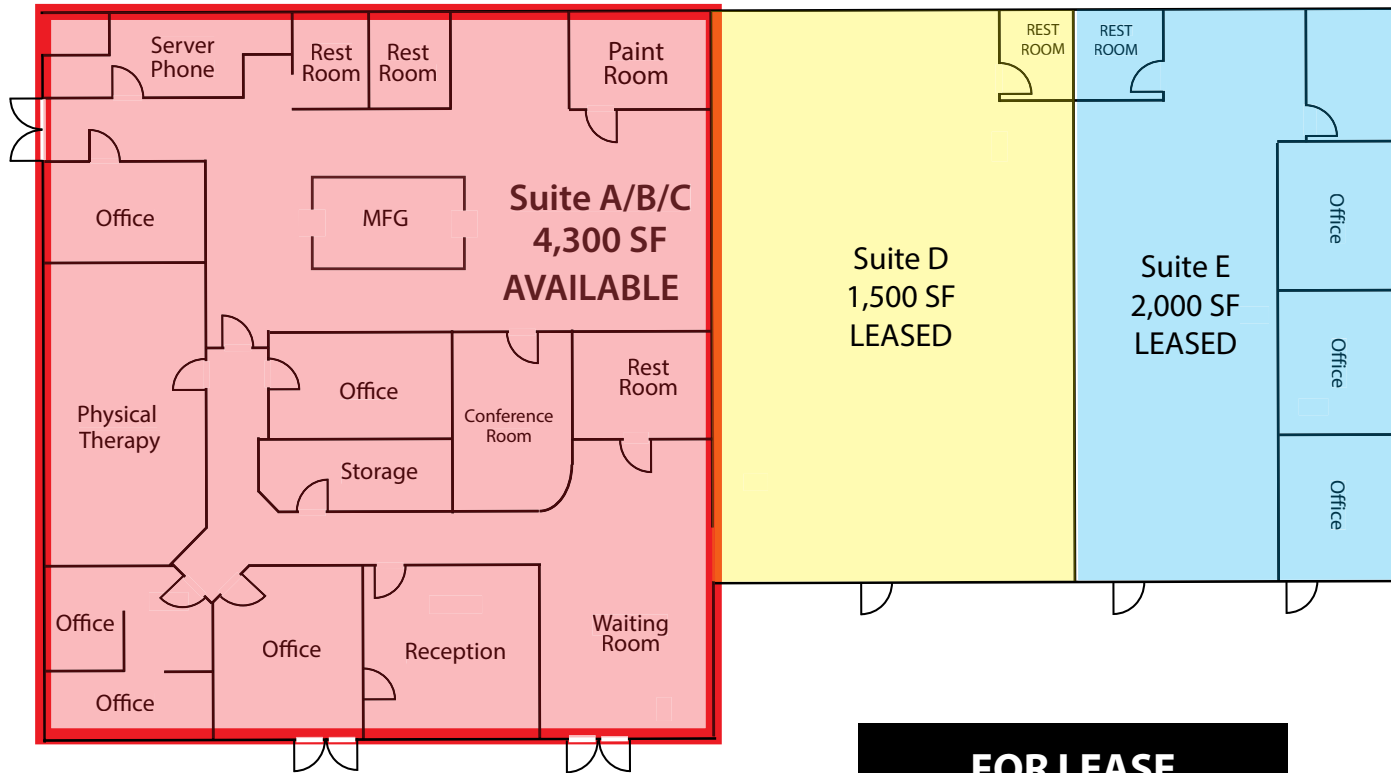

## Suites / Tenants

Suites A/B/C	4,300 SF	Vacant
Suite D	1,500 SF	Leased
Suite E	2,000 SF	Leased

## FOR LEASE

Suites A/B/C - 4,300 SF  
**\$1.50/SF Mod. Gross**

**Available Now!**