

FOR SALE OR LEASE | BRAND-NEW CONSTRUCTION!

Colliers

# +/- 40,000 SF Industrial Warehouse

1980 EASTRIDGE AVENUE, RIVERSIDE, CA



## Property Features:

- > +/- 40,000 SF Available on 2.31 Acres
- > +/-1,000 SF of Pre-Built Office Area
- > Class A Industrial Brand-New Construction
- > Located in High-Profile Sycamore Canyon
- > Direct Freeway Access near I-215 and 60 interchange
- > 32' Warehouse Clearance Height
- > 4 (9' x 10') DH Doors, 2 w/ 35k lb Mechanical Pit Levelers
- > 1 (16' x 14') Grade Level Door
- > Secured Concrete Truck Court w/Motorized Gates
- > LED Lighting Throughout, 3% Warehouse Skylights
- > 2,000 Amps w/ 480 volt 3-phase, EV & Solar Ready
- > Part of Sycamore Canyon Business Center
- > Corporate Neighbors include: Cardinal Health, Pepsi, Kroger, DSC Logistics, & Big5 Sporting Goods
- > [City of Riverside Favorable Utility Rates - Click Here](#)

## Location Map

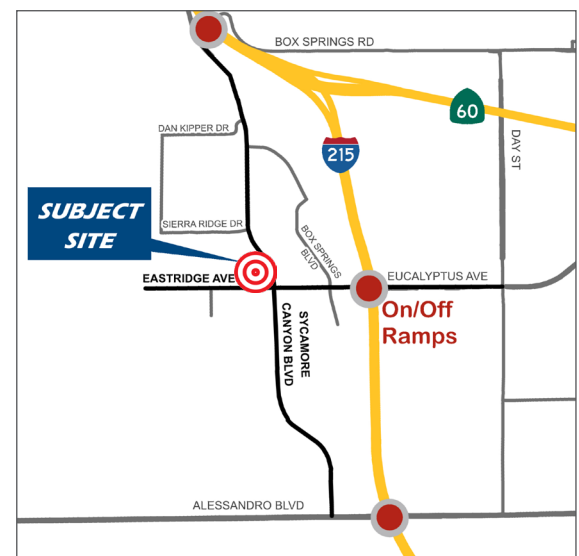

COLLIERS INTERNATIONAL  
3 Park Plaza, Suite 1200  
Irvine, CA 92614  
www.colliers.com

IAN DEVRIES  
VICE CHAIRMAN  
LICENSE NO. 01019686  
949 724 5509  
ian.devries@colliers.com

CHRIS DEVRIES  
SIOR, EXECUTIVE VP  
LICENSE NO. 01867314  
949 724 5504  
chris.devries@colliers.com

FOR SALE OR LEASE | BUILDING COMPLETED

# +/- 40,000 SF Industrial Warehouse

Under Construction

1980 EASTRIDGE AVENUE, RIVERSIDE, CA

Another Quality Project by:

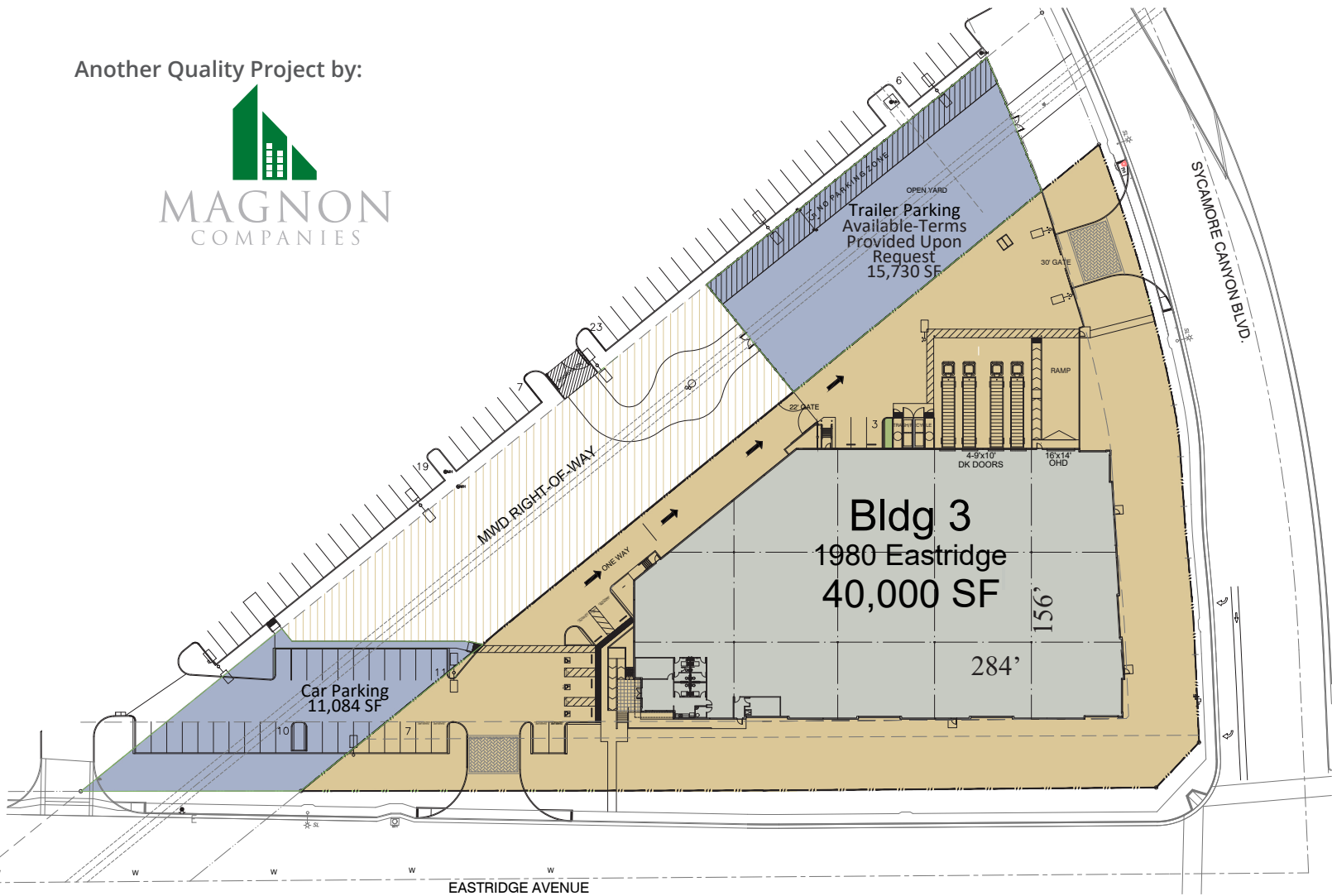

This document has been prepared by Colliers International for advertising and general information only. Colliers International makes no guarantees, representations or warranties of any kind, expressed or implied, regarding the information including, but not limited to, warranties of content, accuracy and reliability. Any interested party should undertake their own inquiries as to the accuracy of the information. Colliers International excludes unequivocally all inferred or implied terms, conditions and warranties arising out of this document and excludes all liability for loss and damages arising there from. This publication is the copyrighted property of Colliers International and/or its licensor(s). ©2024.. All rights reserved.

COLLIERS INTERNATIONAL  
3 Park Plaza, Suite 1200  
Irvine, CA 92614  
www.colliers.com

IAN DEVRIES  
VICE CHAIRMAN  
LICENSE NO. 01019686  
949 724 5509  
ian.devries@colliers.com

CHRIS DEVRIES, SIOR  
EXECUTIVE VP  
LICENSE NO. 01867314  
949 724 5504  
chris.devries@colliers.com

FOR SALE OR LEASE



# +/- 40,000 SF Industrial Warehouse

1980 EASTRIDGE AVENUE, RIVERSIDE, CA



COLLIERS INTERNATIONAL  
 3 Park Plaza, Suite 1200  
 Irvine, CA 92614  
 www.colliers.com

IAN DEVRIES  
 LICENSE NO. 01019686  
 949 724 5509  
 ian.devries@colliers.com

CHRIS DEVRIES  
 LICENSE NO. 01867314  
 949 724 5504  
 chris.devries@colliers.com

FOR SALE OR LEASE | BRAND-NEW CONSTRUCTION!

# +/- 40,000 SF Industrial Warehouse

1980 EASTRIDGE AVENUE, RIVERSIDE, CA

Colliers

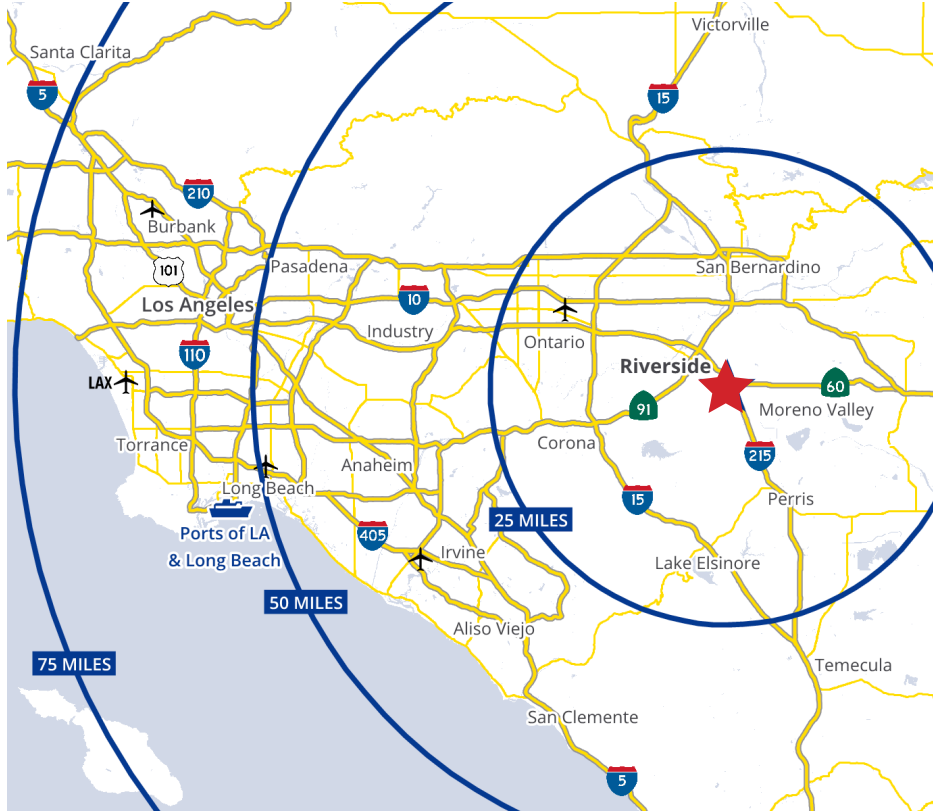

Another Quality Project By:



COLLIERS INTERNATIONAL  
3 Park Plaza, Suite 1200  
Irvine, CA 92614  
www.colliers.com

IAN DEVRIES  
VICE CHAIRMAN  
LICENSE NO. 01019686  
949 724 5509  
ian.devries@colliers.com

CHRIS DEVRIES, SIOR  
SENIOR VP  
LICENSE NO. 01867314  
949 724 5504  
chris.devries@colliers.com