



10 CAPE ROAD | TAUNTON, MA

SOUTHWAY VILLAGE

6,842 SF AVAILABLE (SUBDIVIDABLE)



PROJECT DETAILS

SOUTHWAY VILLAGE • 6,842 SF AVAILABLE (SUBDIVIDABLE)

PROPERTY HIGHLIGHTS

- Brand new facade almost complete
- Great visibility on Route 44
- Abundant parking field

DEMOGRAPHICS	1 MILE	3 MILES	5 MILES
TOTAL POPULATION	3,097	50,830	82,117
DAYTIME POPULATION	4,741	51,359	78,186
MEDIAN HH INCOME	\$94,435	\$71,018	\$86,380
HOUSEHOLDS	1,214	20,723	32,384



ZOOM OUT
AERIAL

SOUTHWAY VILLAGE • 6,842 SF AVAILABLE (SUBDIVIDABLE)

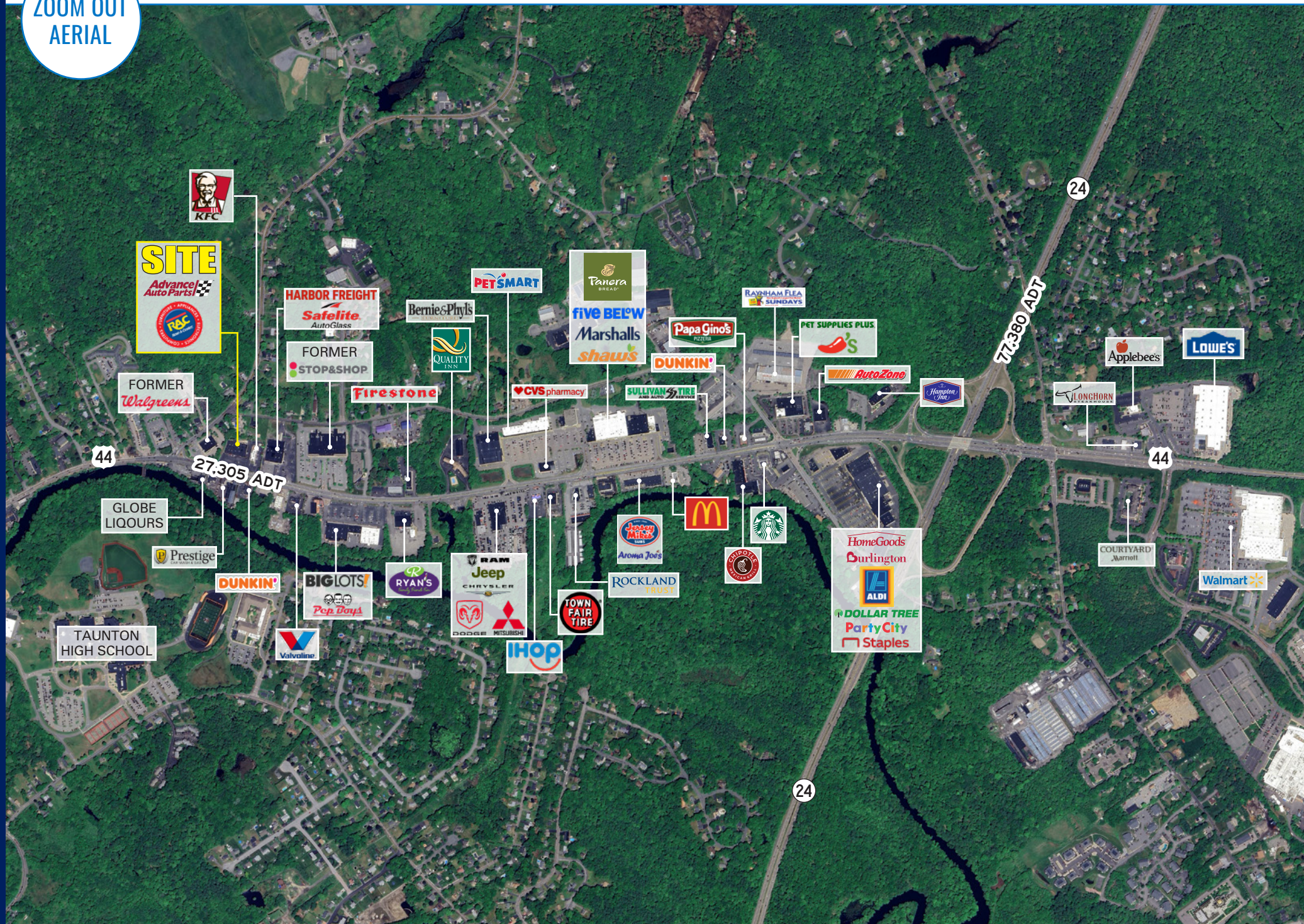

SITE PLAN

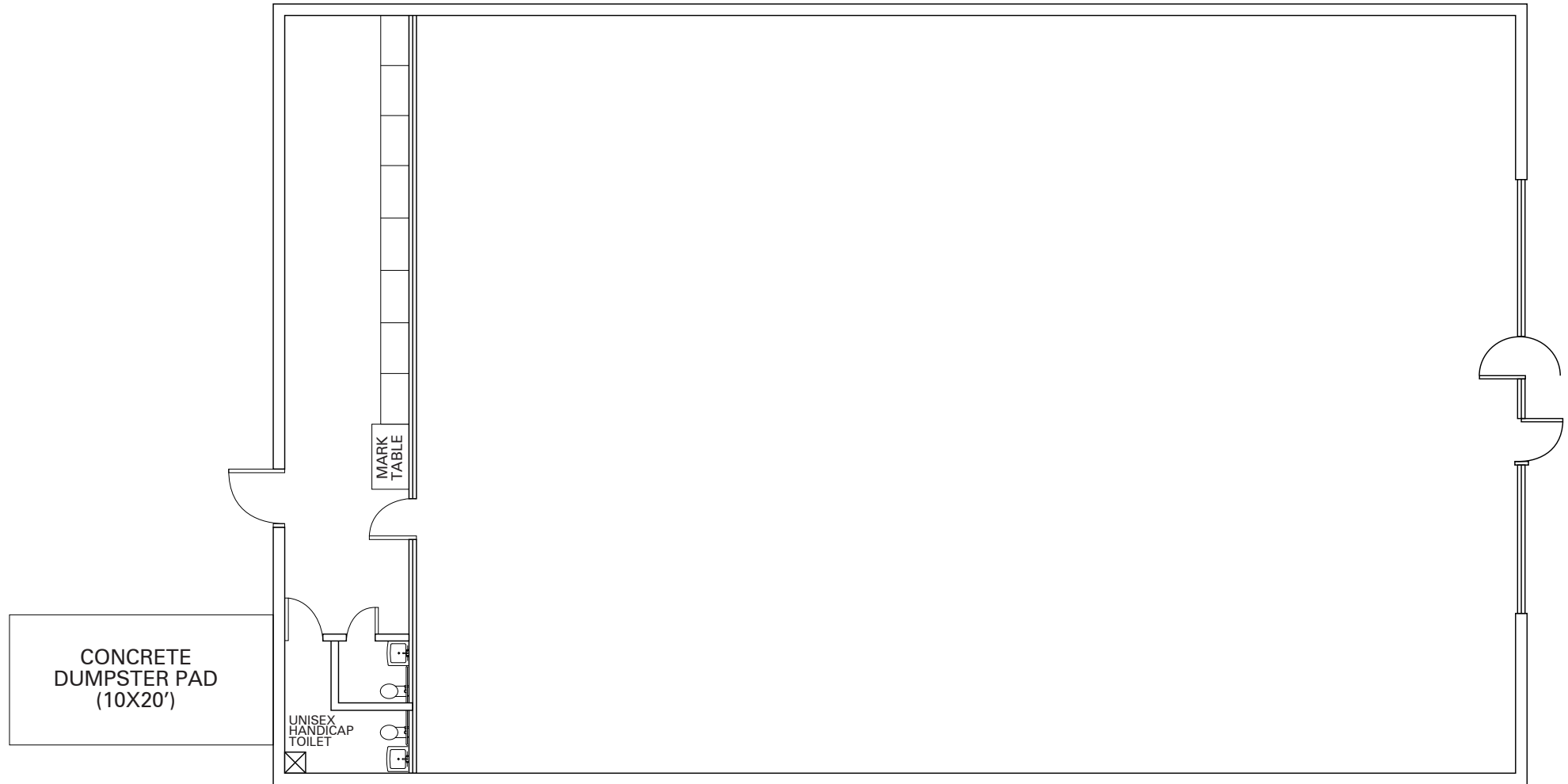

10 CAPE ROAD | TAUNTON, MA

SOUTHWAY VILLAGE

6,842 SF AVAILABLE (SUBDIVIDABLE)

MICHAEL ALBERICO

617.239.3605

MALBERICO@ATLANTICRETAIL.COM



BOSTON

THE PRUDENTIAL CENTER
BOSTON, MA 02199
617.239.3600

ALBANY

ATLANTA

CHARLOTTE

LOS ANGELES

NEW YORK CITY

ORLANDO

PITTSBURGH

WEST PALM BEACH

WWW.ATLANTICRETAIL.COM



LINKEDIN.COM/COMPANY/ATLANTIC-RETAIL-PROPERTIES



INSTAGRAM.COM/ATLANTIC_RETAIL/



CHAINLINKS
RETAIL ADVISORS