

±3,269 - 29,195 Square Feet Total 5 INDUSTRIAL BUILDINGS FOR SALE



COMPLETELY REFURBISHED BUILDINGS!

10925-10950 VULCAN ST., SOUTH GATE, CA

Voit

REAL ESTATE SERVICES



DAN BERKENFIELD
Senior Vice President, Partner
(562) 833-7011
dberkenfield@voitco.com
Lic. # 01706467







MATT PETERS
Vice President
(949) 263-5305
mpeters@voitco.com
Lic. # 02065503



RACHEL BURNERY
Associate
(562) 533-4225
rburney@voitco.com
Lic. # 02217852

AVAILABLE UNITS AND SALE PRICES

	Address	Bldg SF	Land SF	Availability	APN	Pricing
	10925 Vulcan St.	±6,478	±15,003	Now	6234-004-021	\$1,810,000
	10935 Vulcan St.	±3,269	±7,770	Now	6234-004-022	\$980,000
	10932 Vulcan St.	±6,478	±17,097	Now	6234-004-032	\$1,825,000
	10940 Vulcan St.	±6,490	±18,923	Now	6234-004-031	\$1,850,000
	10950 Vulcan St.	±6,480	±19,650	Now	6234-004-030	\$1,875,000
Totals		±29,195	±78,443			\$8,340,000



Address:	10925 Vulcan St
Bldg Size:	±6,478 SF
Available:	Now
Pricing:	\$1,810,000

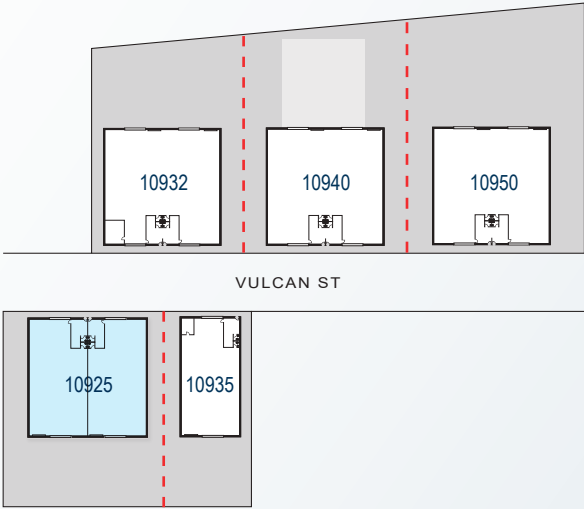

Building Features



±6,478 SF Building on ±15,003 SF of Land



43% Building Coverage



Minimum 14' Clear Height / Clearspan



Upgrades: LED Lights, Tex-Cote Roof Paint, Interior Finishes, Electrical Upgrades



Four (4) Restrooms



Four (4) Oversized Grade Level Doors (12' x 14')



400 Amps, 240 Volts, 3-Phase Electrical (verify)



Existing Crane



Fenced and Paved Yard with Outdoor Lighting



Drive Through and Drive Around Access



Divisible to Two (2) Clearspan Units, Separately Metered

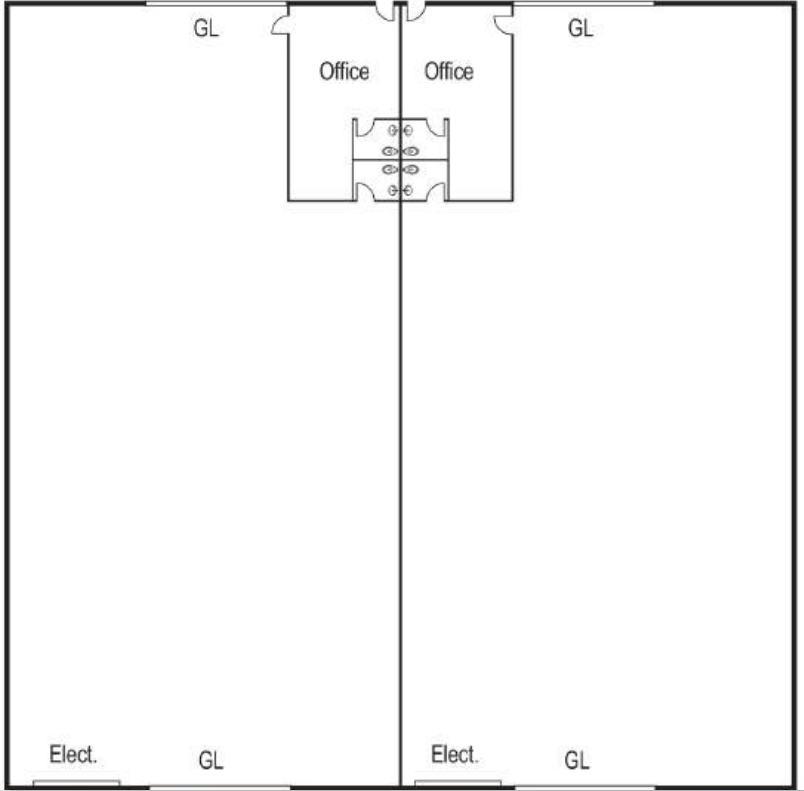

Address:	10935 Vulcan St
Bldg Size:	±3,269 SF
Available:	Now
Pricing:	\$980,000

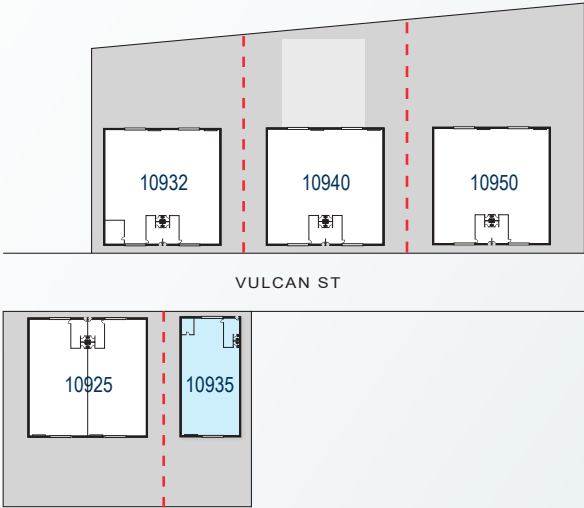

Building Features



±3,269 SF Building on ±7,770 SF of Land



42% Building Coverage



Minimum 14' Clear Height / Clearspan



Upgrades: LED Lights, Tex Cote Roof Paint, Interior Finishes, Electrical Upgrades



Two (2) Restrooms



Two (2) Oversized Grade Level Doors (12' x 14')



400 Amps, 240 Volts, 3-Phase Electrical (verify)



Existing Crane



Fenced and Paved Yard with Outdoor Lighting



Drive Through



Divisible to Two (2) Clearspan Units, Separately Metered

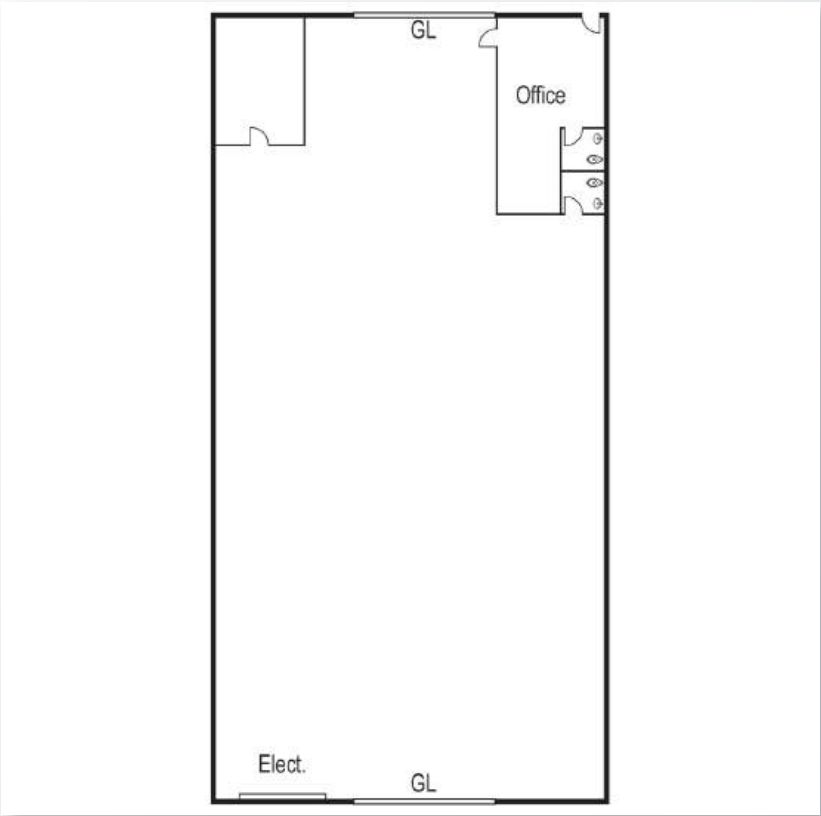

Address: 10932 Vulcan St
Bldg Size: ±6,478 SF
Available: Now
Pricing: \$1,825,000

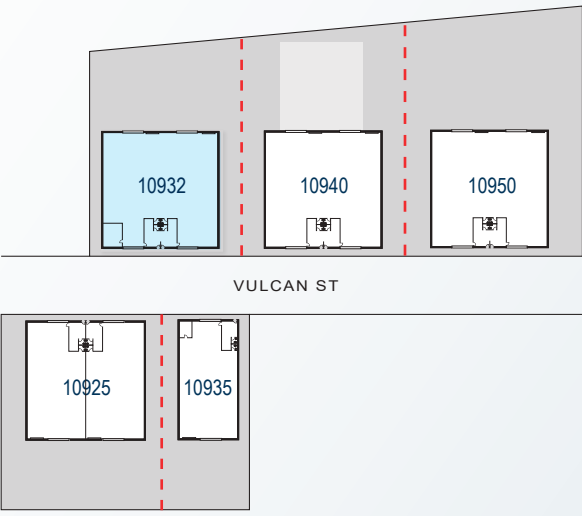

Building Features



±6,478 SF Building on ±17,097 SF of Land



38% Building Coverage



Minimum 14' Clear Height / Clearspan



Upgrades: LED Lights, Tex Cote Roof Paint, Interior Finishes, Electrical Upgrades



Four (4) Restrooms



Four (4) Oversized Grade Level Doors (12' x 14')



400 Amps, 240 Volts, 3-Phase Electrical (verify)



Fenced and Paved Yard with Outdoor Lighting



Drive Through and Drive Around Access



Divisible to Two (2) Clearspan Units, Separately Metered

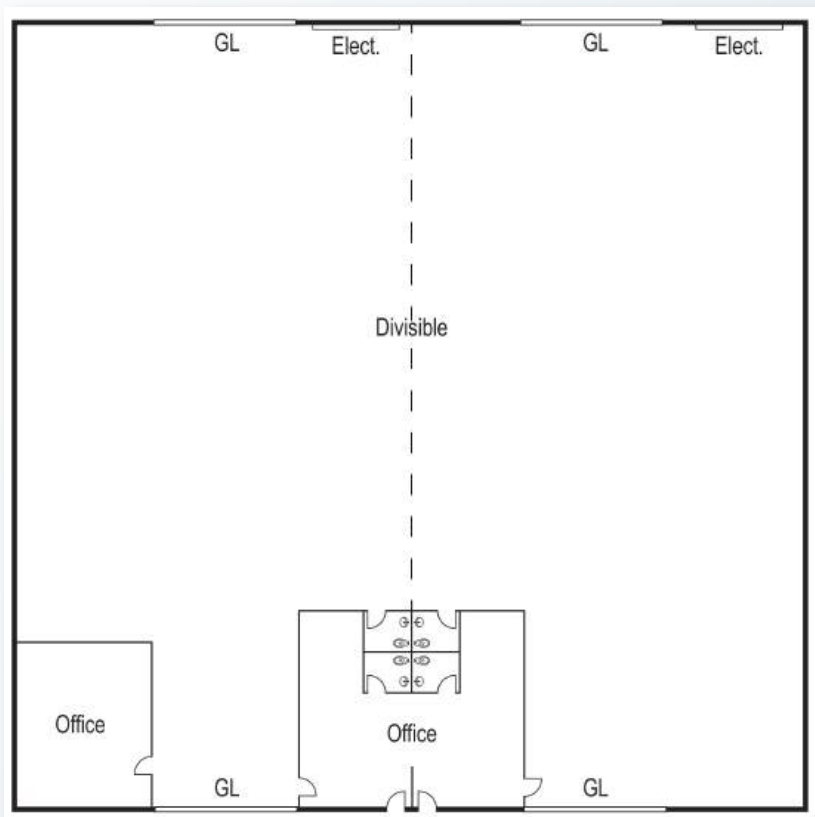

Address: 10940 Vulcan St
Bldg Size: ±6,490 SF
Available: Now
Pricing: \$1,850,000

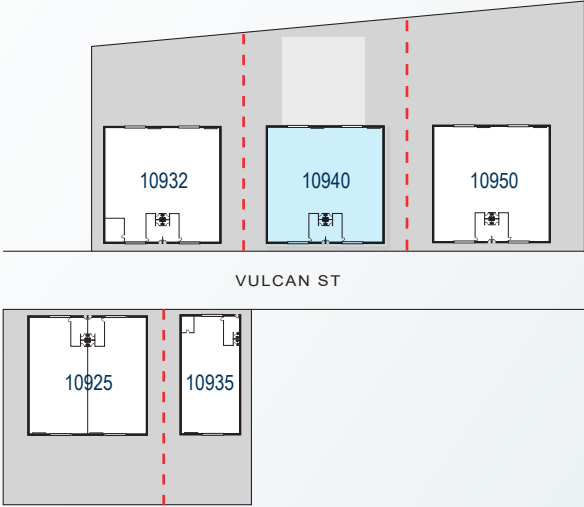

Building Features



±6,490 SF Building on ±18,923 SF of Land



34% Building Coverage



Minimum 14' Clear Height / Clearspan



Upgrades: LED Lights, Tex Cote Roof Paint, Interior Finishes, Electrical Upgrades



Four (4) Restrooms



Four (4) Oversized Grade Level Doors (12' x 14')



400 Amps, 240 Volts, 3-Phase Electrical (verify)



Fenced and Paved Yard with Outdoor Lighting



Drive Through and Drive Around Access



Divisible to Two (2) Clearspan Units, Separately Metered

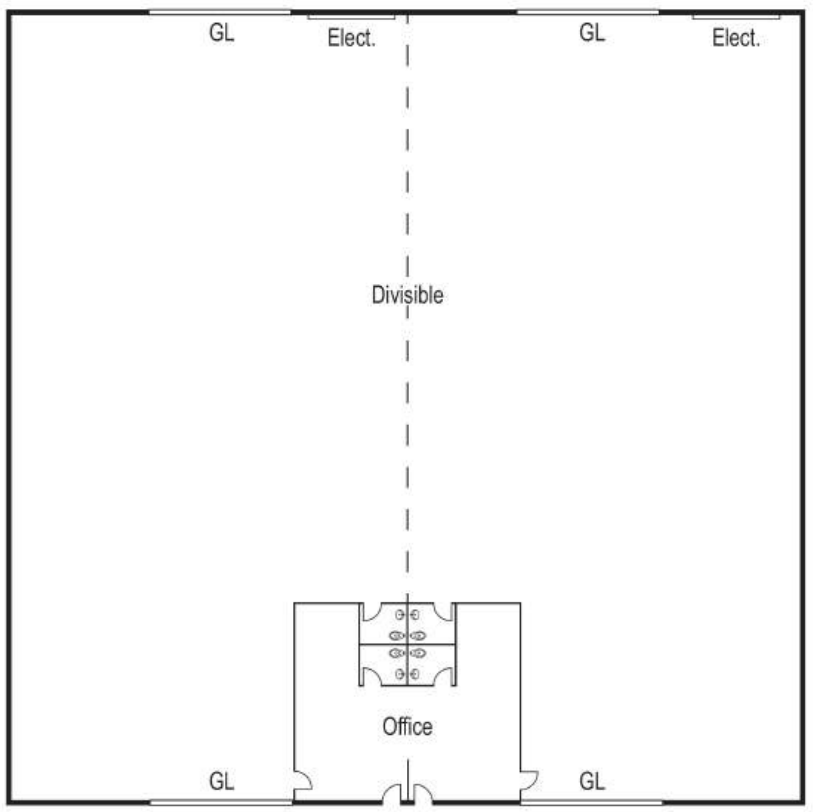

Address: 10950 Vulcan St
Bldg Size: ±6,480 SF
Available: Now
Pricing: \$1,875,000

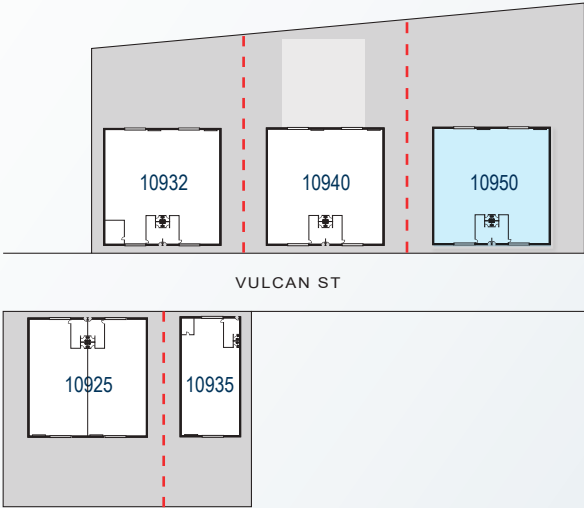

Building Features



±6,480 SF Building on ±19,650 SF of Land



33% Building Coverage



Minimum 14' Clear Height / Clearspan



Upgrades: LED Lights, Tex Cote Roof Paint, Interior Finishes, Electrical Upgrades



Four (4) Restrooms



Four (4) Oversized Grade Level Doors (12' x 14')



400 Amps, 240 Volts, 3-Phase Electrical (verify)



Fenced and Paved Yard with Outdoor Lighting



Drive Through and Drive Around Access



Divisible to Two (2) Clearspan Units, Separately Metered

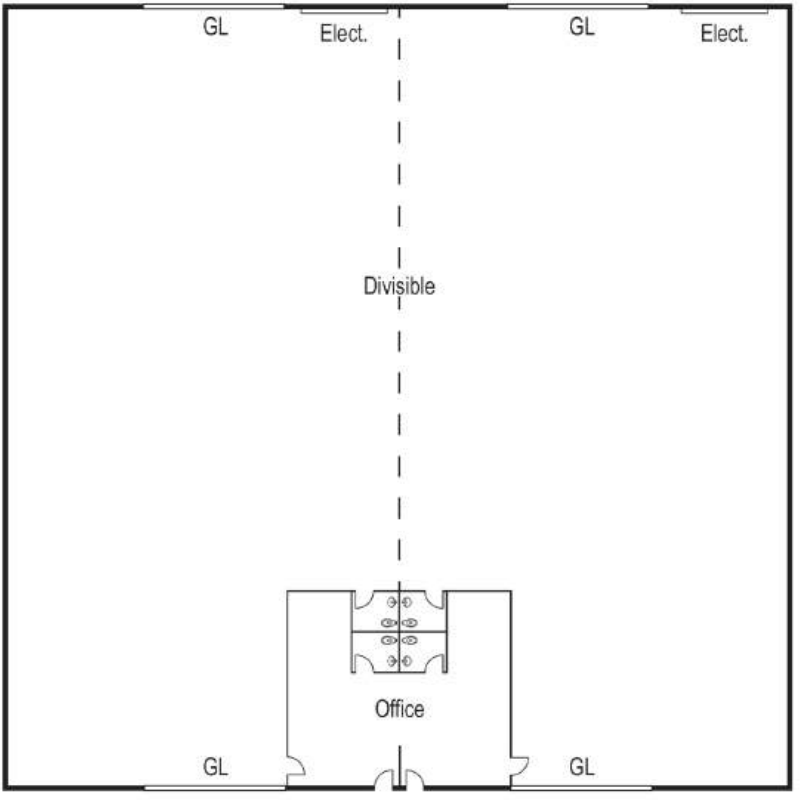





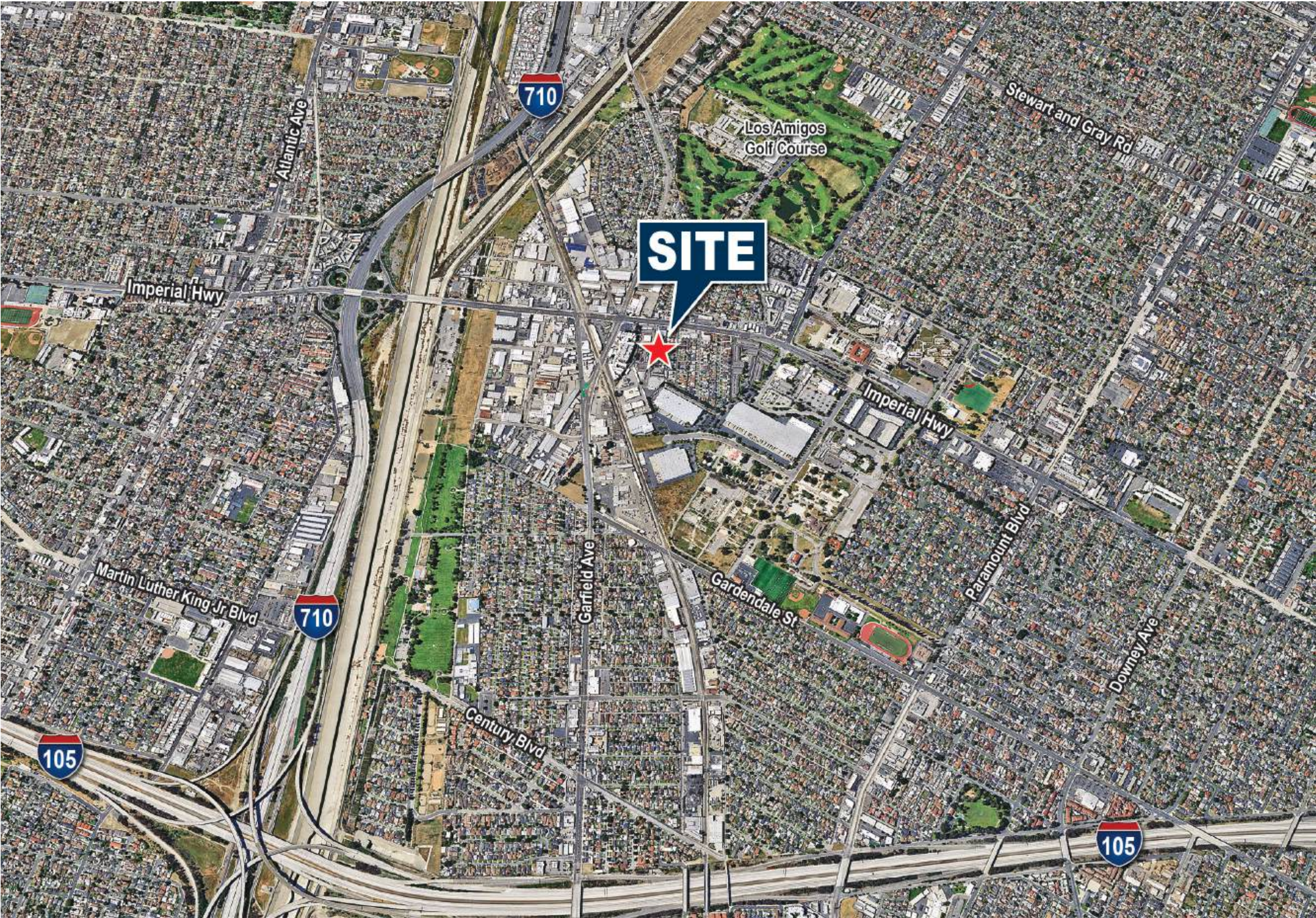

±3,269 - 29,195 Square Feet Total 5 INDUSTRIAL BUILDINGS FOR SALE

10925-10950 VULCAN ST., SOUTH GATE, CA

For More Information, Please Contact:

Voit

REAL ESTATE SERVICES



DAN BERKENFIELD

Senior Vice President, Partner
(562) 833-7011
dberkenfield@voitco.com
Lic. # 01706467



MATT PETERS

Vice President
(949) 263-5305
mpeters@voitco.com
Lic. # 02065503



RACHEL BURNEY

Associate
(562) 533-4225
rburney@voitco.com
Lic. # 02217852