 **JLL** SEE A BRIGHTER WAY

For sublease

10,161 SF available



West End Office Park building highlights

- Mix of indoor and outdoor workspaces
- Remarkable 5-story atrium
- Extensive parking options
- On-site dining and catering freshly made from Ed's kitchen
- Activated courtyard
- Fitness center
- Conference training rooms
- Dozens of shops, bars, and restaurants within 1 mile
- Bike and running trails nearby

Space details

- Fully furnished, like new space
- 6 offices, 2 conference rooms, 2 phone rooms, 46 workstations, mother's room, open break area/ kitchen with catering areas

Location	West End Plaza 1660 Hwy 100 S St. Louis Park, MN
Size	10,161 s.f.
Term	Sublease through June 2027
Rental rate	Negotiable

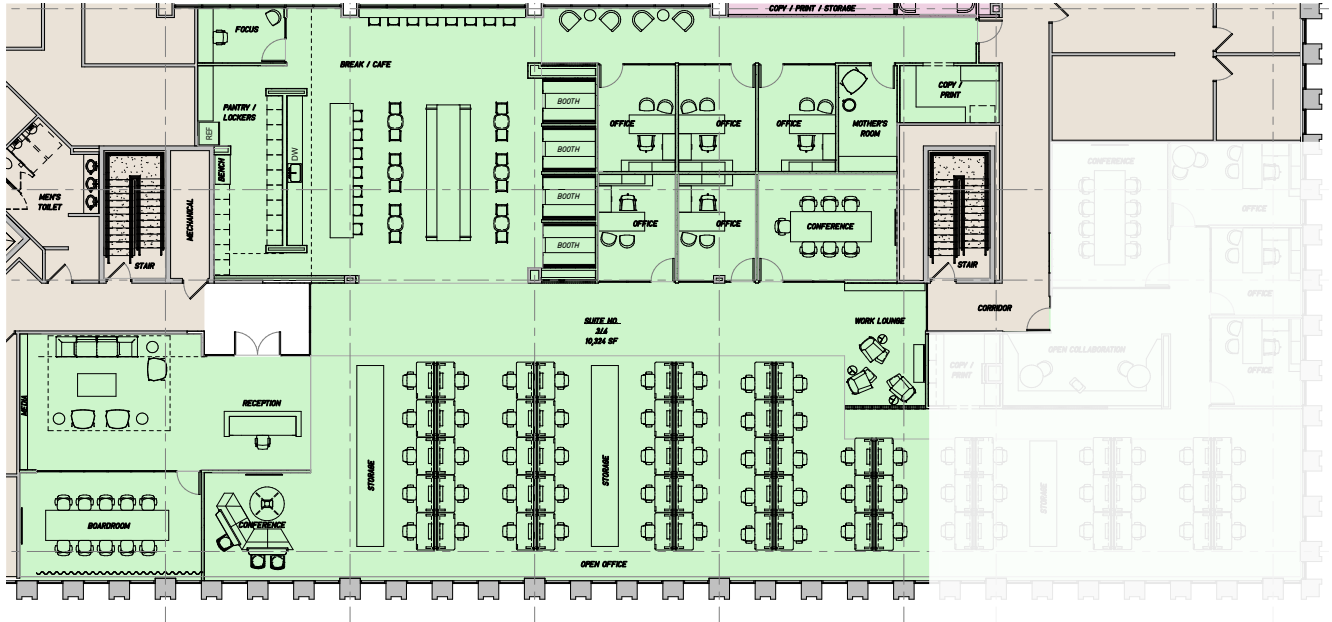

Eddie Rymer

Managing Director

eddie.rymer@jll.com

+1 (651) 226 7835