

1.3 ACRE FENCED OUTDOOR STORAGE

3,000 - 9,000 SF INDUSTRIAL WAREHOUSE FOR LEASE

Lease Rate: \$15.00/SF NNN | NNN Expenses: \$4.38/SF

PROPERTY FEATURES

Building Size	12,000 SF
YOC	1984
Electrical	200 Amps, 3-phase (per unit)
Loading	(4) 12' x 14' Overhead doors
Clear Height	16'
Tenancy	Multiple

PROPERTY HIGHLIGHTS

- Units A & B: Available June 1, 2025
- Unit C: Available with 30-day notice
- One 12' x 14' overhead door, office and private restroom in each unit
- Floor drains
- Overhead gas heat

TRAFFIC COUNTS		Costar, 2024
Intersection	Vehicles Per Day	
US Highway 85 @ E. 168th Avenue	30,709	
US Highway 85 @ Colorado Road 2 ½	27,768	
East 168th Avenue @ Ida Street	8,655	

DEMOGRAPHICS	Costar, 2024		
	1 Mile	3 Miles	5 Miles
2024 Population (Pop.)	3,488	32,836	60,184
2029 Projected Pop.	3,670	34,443	64,536
2024 Households (HH)	1,045	10,954	20,282
Avg. HH Income	\$80,550	\$95,905	\$108,642

FLOOR PLAN

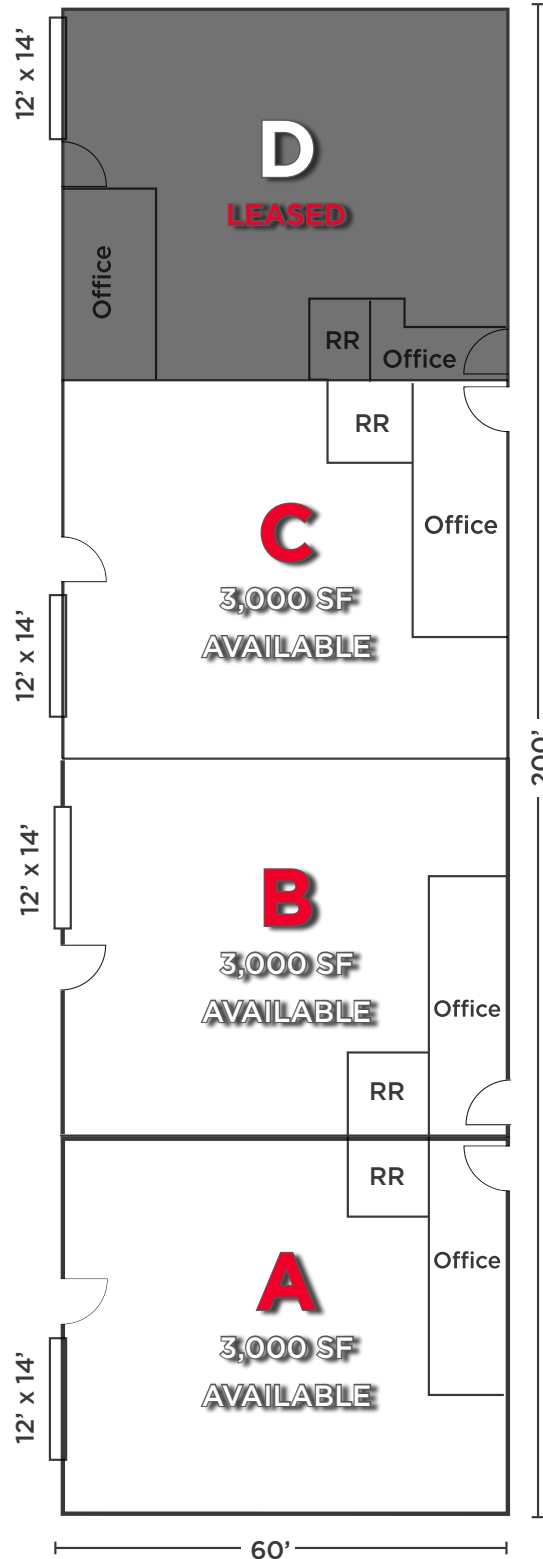

PROPERTY PHOTOS





For more information, please contact:

TYLER MURRAY
Senior Director

+1 970 267 7404

tyler.murray@cushwake.com

TRAVIS ACKERMAN
Executive Managing Director

+1 970 267 7720

travis.ackerman@cushwake.com

TY MASHEK
Senior Associate

+1 303 525 3125

ty.mashek@cushwake.com

772 Whalers Way, Suite 200
Fort Collins, Colorado 80525

T +1 970 776 3900

F +1 970 267 7419

cushmanwakefield.com