

601 - 615 Hiesters Lane

Reading PA

FIRST FLOOR PLAN

Overall 96,635 SF

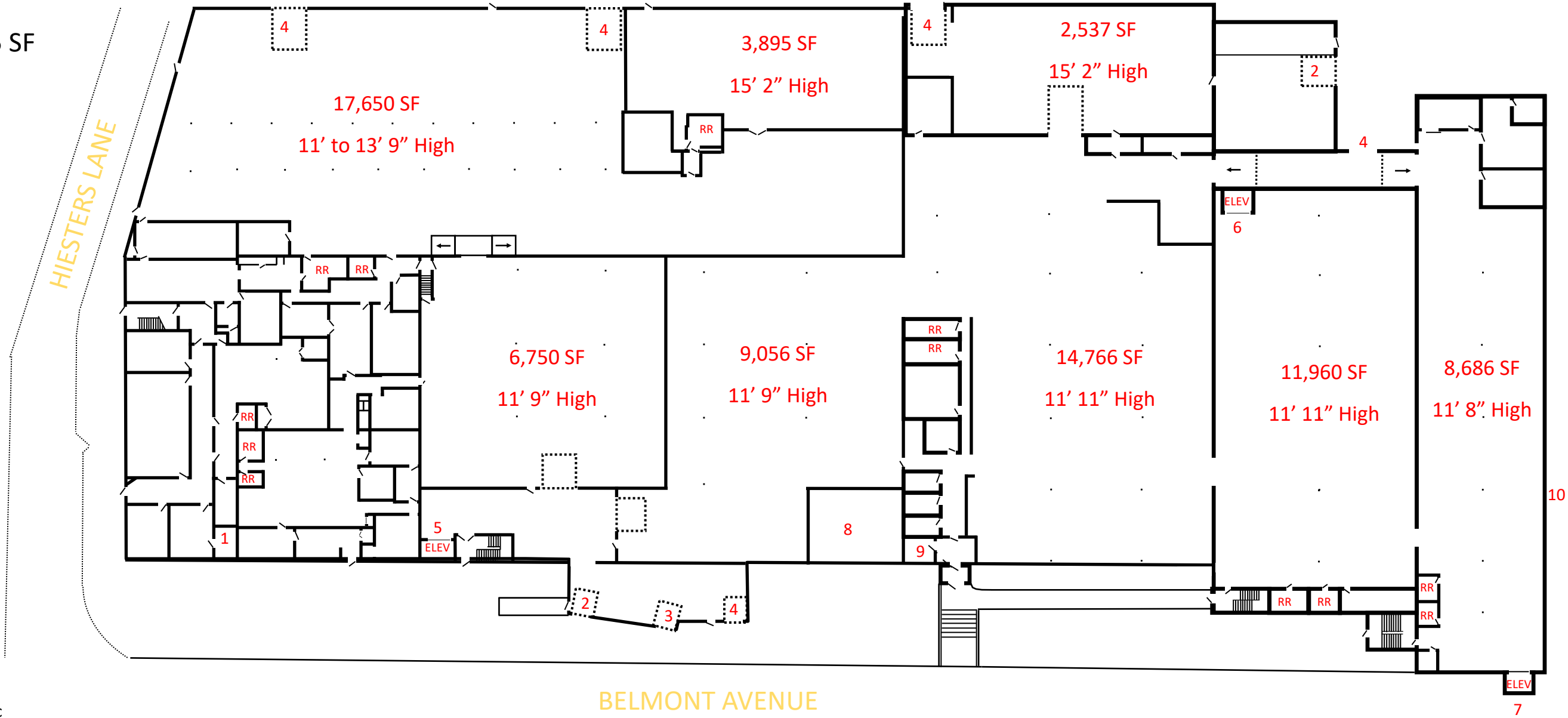

- 1 Telephone demarc
- 2 Truck Dock
- 3 UPS Height Truck Dock
- 4 At-Grade Door
- 5 Freight Elevator 2-Stops, 2,000 lb. cap.
- 6 Freight Elevator 2-Stops, 2,000 lb. cap.
- 7 Freight Elevator 4-Stops (one exterior), not in operation
- 8 Cluster of offices
- 9 Electric Main
- 10 (7) Natural Gas Meters

40 Scale when printed on 11" 17" Ledger Paper - all measurements approximate.

NO WARRANTY OR REPRESENTATION, EXPRESS OR IMPLIED, IS MADE AS TO THE ACCURACY OF THE INFORMATION CONTAINED HEREIN, AND THE SAME IS SUBMITTED SUBJECT TO ERRORS, OMISSIONS, CHANGE OF PRICE, RENTAL OR OTHER CONDITIONS, PRIOR SALE, LEASE OR FINANCING, OR WITHDRAWAL WITHOUT NOTICE, AND OF ANY SPECIAL LISTING CONDITIONS IMPOSED BY OUR PRINCIPALS NO WARRANTIES OR REPRESENTATIONS ARE MADE AS TO THE CONDITION OF THE PROPERTY OR ANY HAZARDS CONTAINED THEREIN ARE ANY TO BE IMPLIED

601 - 615 Hiesters Lane
Reading PA
SECOND FLOOR PLAN
Overall 65,248 SF

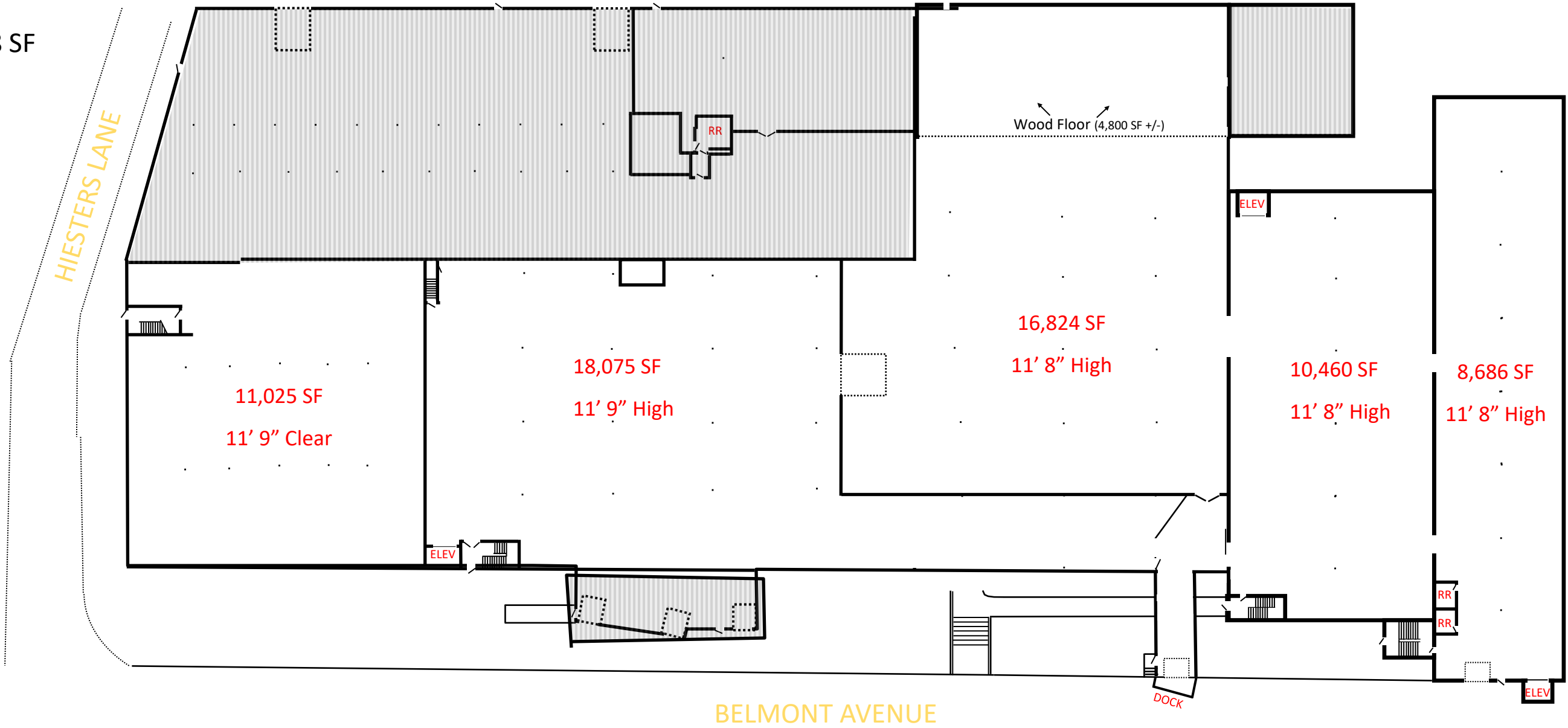

601 - 615 Hiesters Lane

Reading PA

THIRD FLOOR PLAN

Overall 9,298 SF Gross

