

AVAILABLE FOR LEASE OR SALE

4345 WEST DIVISION STREET, CHICAGO, IL 60651



OFFERING SUMMARY

Building Size	12,500 SF
Parking Lot Size	0.29 ACRES
Ceiling Height	10' - 12'
Loading	1 Drive-in door
Lease Rate	Subject to Offer
Sale Price	Subject to Offer

PROPERTY HIGHLIGHTS

- USDA buildout
- \pm 1,068 SF of Freezer
- \pm 4,030 SF of Cooler
- Ample parking



ALI NIX | Associate | 773.714.2128 | anix@darwinpw.com
MARC HALE | Associate | 773.714.2119 | mhale@darwinpw.com



AVAILABLE FOR LEASE OR SALE

4345 WEST DIVISION STREET, CHICAGO, IL 60651



ALI NIX | Associate | 773.714.2128 | anix@darwinpw.com
MARC HALE | Associate | 773.714.2119 | mhale@darwinpw.com



AVAILABLE FOR LEASE OR SALE

4345 WEST DIVISION STREET, CHICAGO, IL 60651



DARWINPW

R E A L T Y

4345 W Division

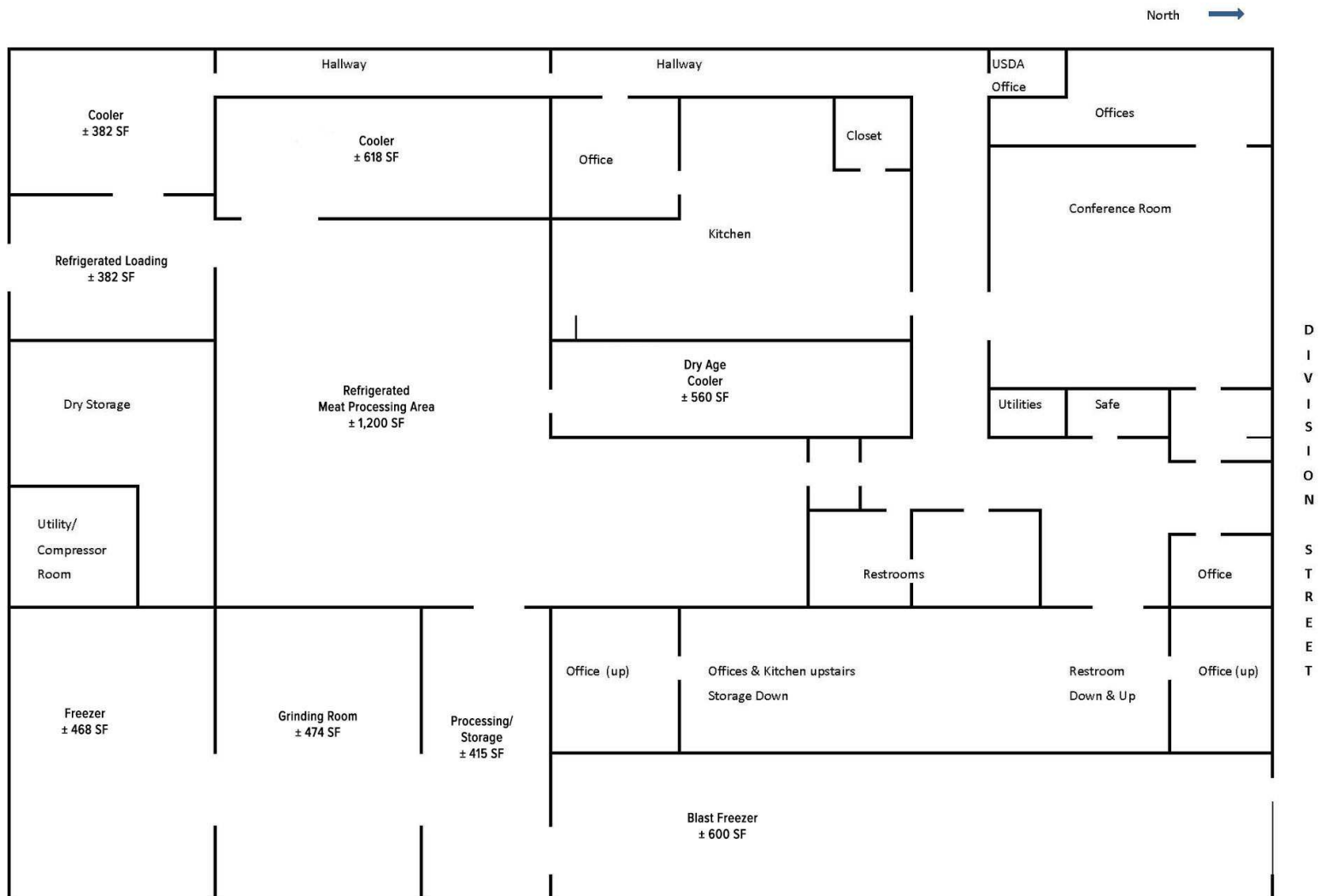

ALI NIX | Associate | 773.714.2128 | anix@darwinpw.com

MARC HALE | Associate | 773.714.2119 | mhale@darwinpw.com



AVAILABLE FOR LEASE OR SALE

4345 WEST DIVISION STREET, CHICAGO, IL 60651

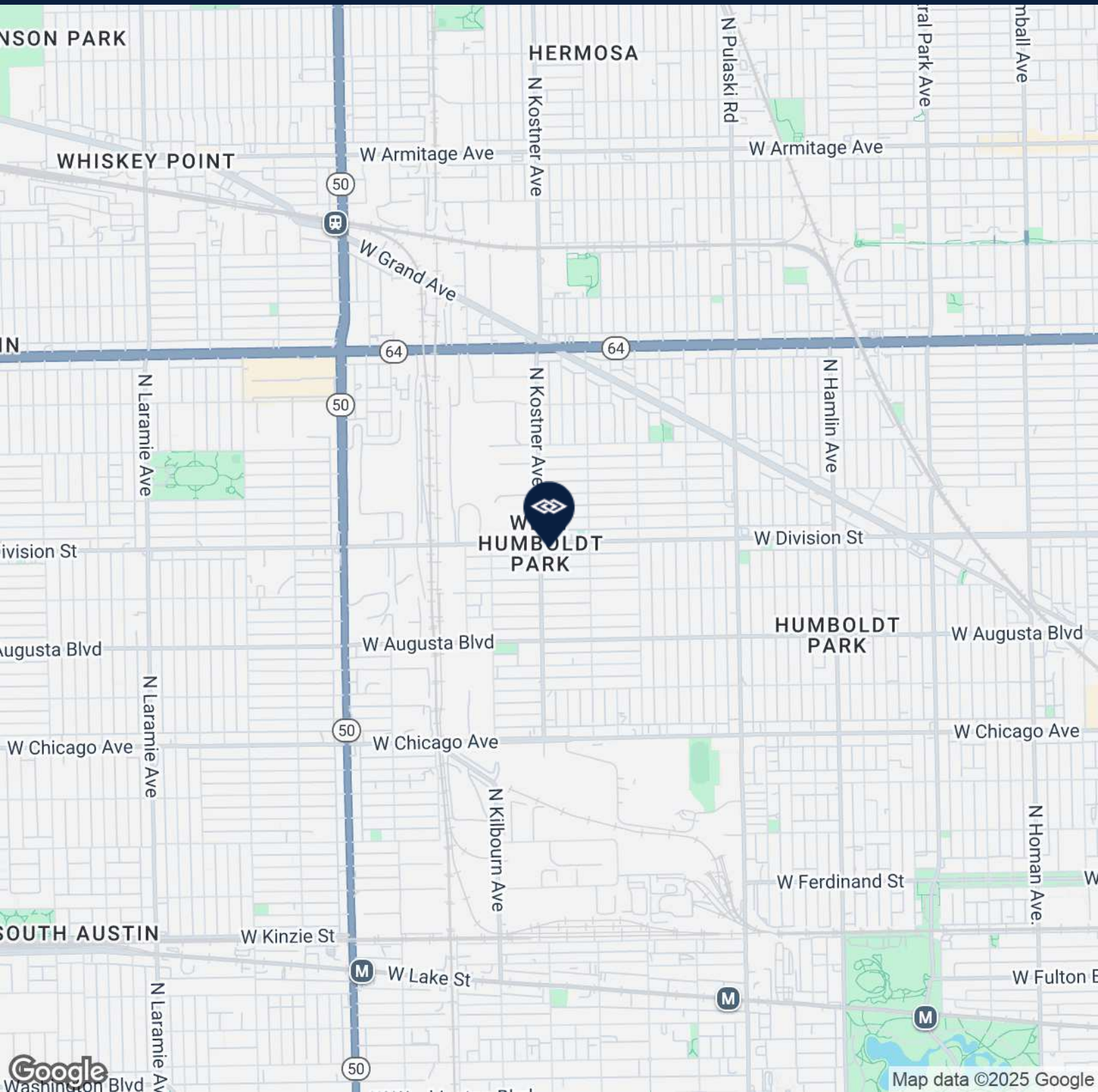

ALI NIX | Associate | 773.714.2128 | anix@darwinpw.com

MARC HALE | Associate | 773.714.2119 | mhale@darwinpw.com



970 N Oaklawn, Suite 100 | Elmhurst, IL 60126 | Tel: 630.782.9520 | darwinpw.com

Submitted subject to error, change in status, or withdrawal without notice.