



# 11189 Sorrento Valley Rd

San Diego, CA 92121

**Promo Rate** Available on leases signed before 2Q25:

## \$3.90 NNN

4,543 SF Available

### Lab Space Available Now



End unit in a private setting. Building & Monument signage.



Across the street from the Sorrento Valley Coaster station.



Move-in ready. Above-market percentage of lab to office ratio.



Connectivity to nature. Lush landscaping & seating on the banks of Los Penasquitos Creek.

Accelerating success.

# Property Profile



## Lab

- Furnished with benches and hoods
- Four 6' and two 8' fume hoods
- All hoods with racks and 22 A&F storage
- House DI water and gas
- Lab support rooms
- Separate 100 SF vented chemical storage
- Single-pass air in labs

## Office

- Mix of private offices and lab support rooms. Upgraded finishes to accommodate maximum flexibility for office or lab users.
- Conference room, two restrooms, multiple private offices, and kitchen/break room
- New interior paint, ceiling tiles, and flooring
- Complete HVAC refurbishing with 1 year warranty

## Premium Site

Conveniently situated within the **Venture Sorrento Office Park**, just west of I-5, in the Sorrento Valley Lab submarket, it stands directly opposite from the Sorrento Valley Coaster Station.



# Floorplan

4,543 SF Available

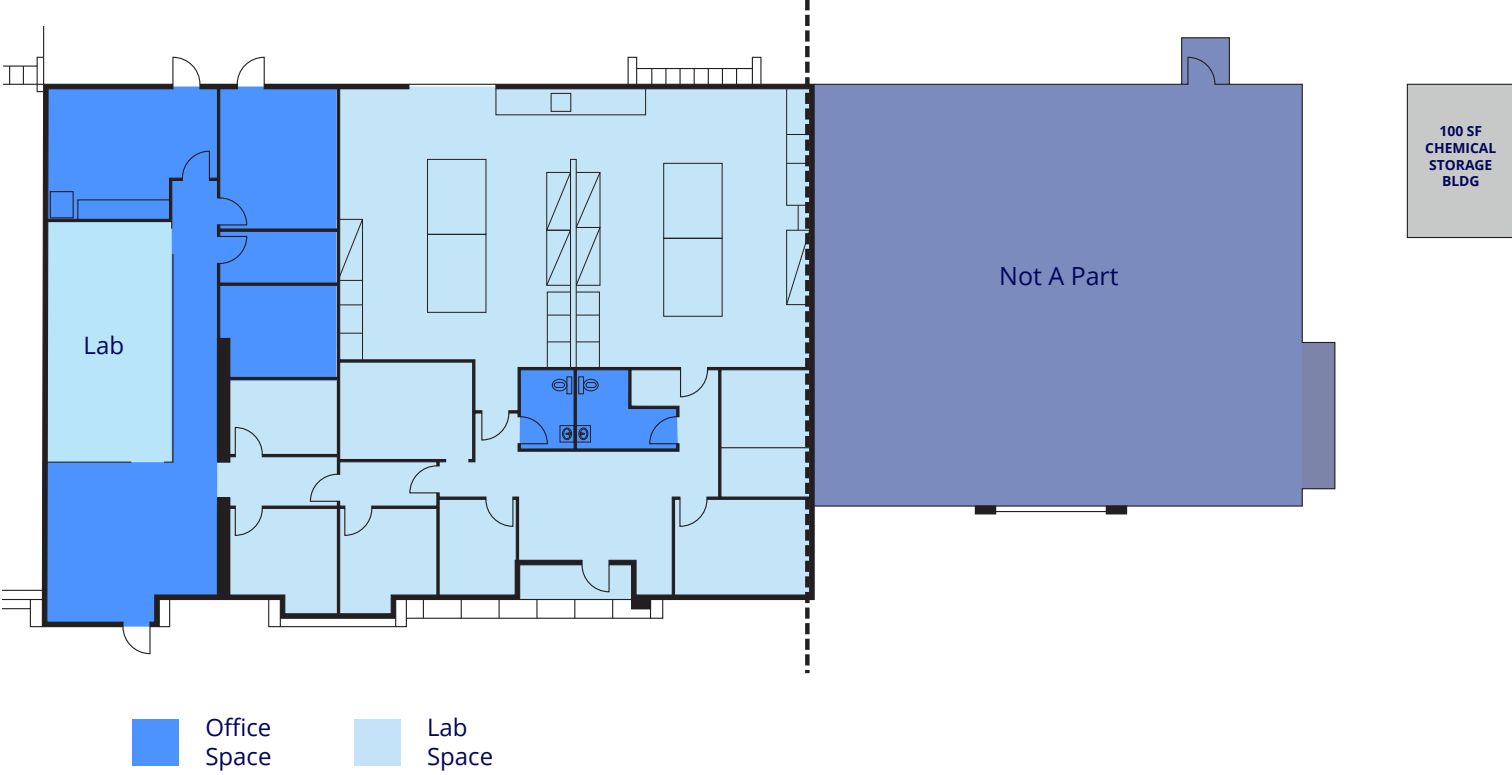

# Property Gallery

Hallway



Lab



Lab with existing fume hoods



Entry



Kitchen/Break Room





PACIFIC OCEAN



CARMEL VALLEY



11189 Sorrento Valley Rd

SORRENTO VALLEY



UTC



Copyright © 2024 Colliers International.  
Information herein has been obtained from sources deemed reliable, however its accuracy cannot be guaranteed. The user is required to conduct their own due diligence and verification.

# Contact

**Conor Evans**

Vice President

t 858-291-1415

conor.evans@colliers.com

CA RE Lic. #01963596

