

SALE

Shovel-Ready Development Outlot

1301A N PLUM GROVE ROAD

Schaumburg, IL 60173



PRESENTED BY:

ALBERT M. LINDEMAN

O: 312.756.7352

lindemana@svn.com

KAREN KULCZYCKI, CCIM

O: 630.330.3352

kkulczycki@svn.com

IL #471020279



PLUM GROVE RD

PROPERTY SUMMARY

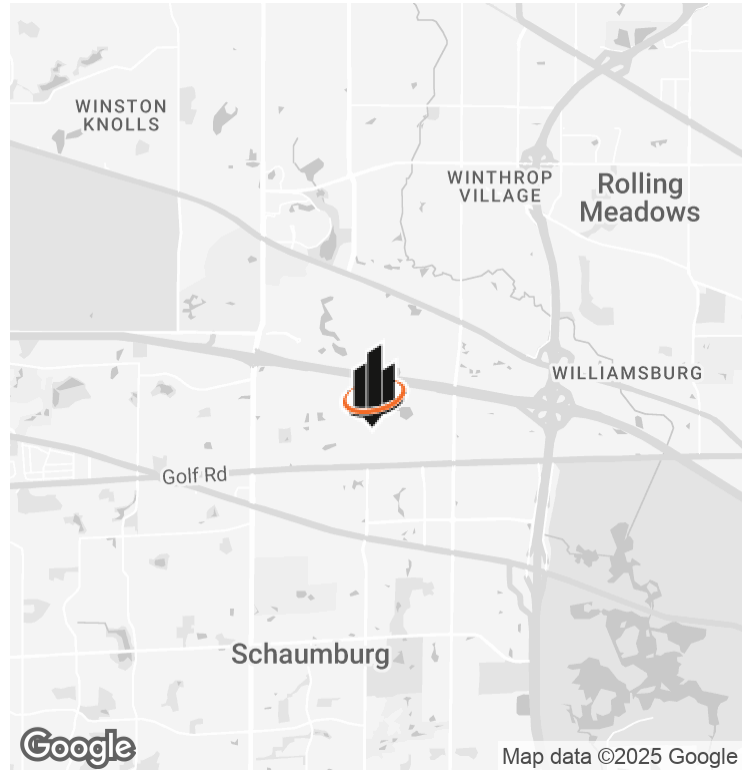

OFFERING SUMMARY

SALE PRICE:	\$350,000
LOT SIZE:	±33,841 SF
PRICE/SF:	\$10.34
COOK COUNTY PIN:	07-11-400-087-0000
TAXES (2024):	\$21,510.46

PROPERTY DESCRIPTION

Discover an exceptional investment opportunity with this ±33,841 Shovel-Ready Land Site, strategically zoned M-1 and ideally situated in the thriving Northwest Suburban area. Boasting high visibility just .2 miles from Golf Road, with an impressive 28,000 CPD, this property offers immense potential for a range of commercial endeavors. This shovel ready site is located adjacent to Horizon Medical Center which primary care physicians provides care from urgent care or emergency visits to routine checkups, and aesthetic medical services. Additionally, its close proximity to four major hospitals and the presence of strong Northwest Suburban demographics make it an attractive prospect for Land users, developers seeking a prime location with promising growth prospects. Embrace the potential to make a lasting impact in the dynamic commercial real estate landscape with this strategically positioned asset.

PROPERTY HIGHLIGHTS

- Located Next to Horizon Medical Center
- ±33,841 Shovel Ready Land Site and Parking
- Strong Northwest Suburban Demographics
- High Visibility 0.2 miles from Golf Road 28000 CPD

ALBERT M. LINDEMAN **KAREN KULCZYCKI, CCIM**
O: 312.756.7352 O: 630.330.3352
lindemana@svn.com kkulczycki@svn.com
IL #471020279

SITE PLAN

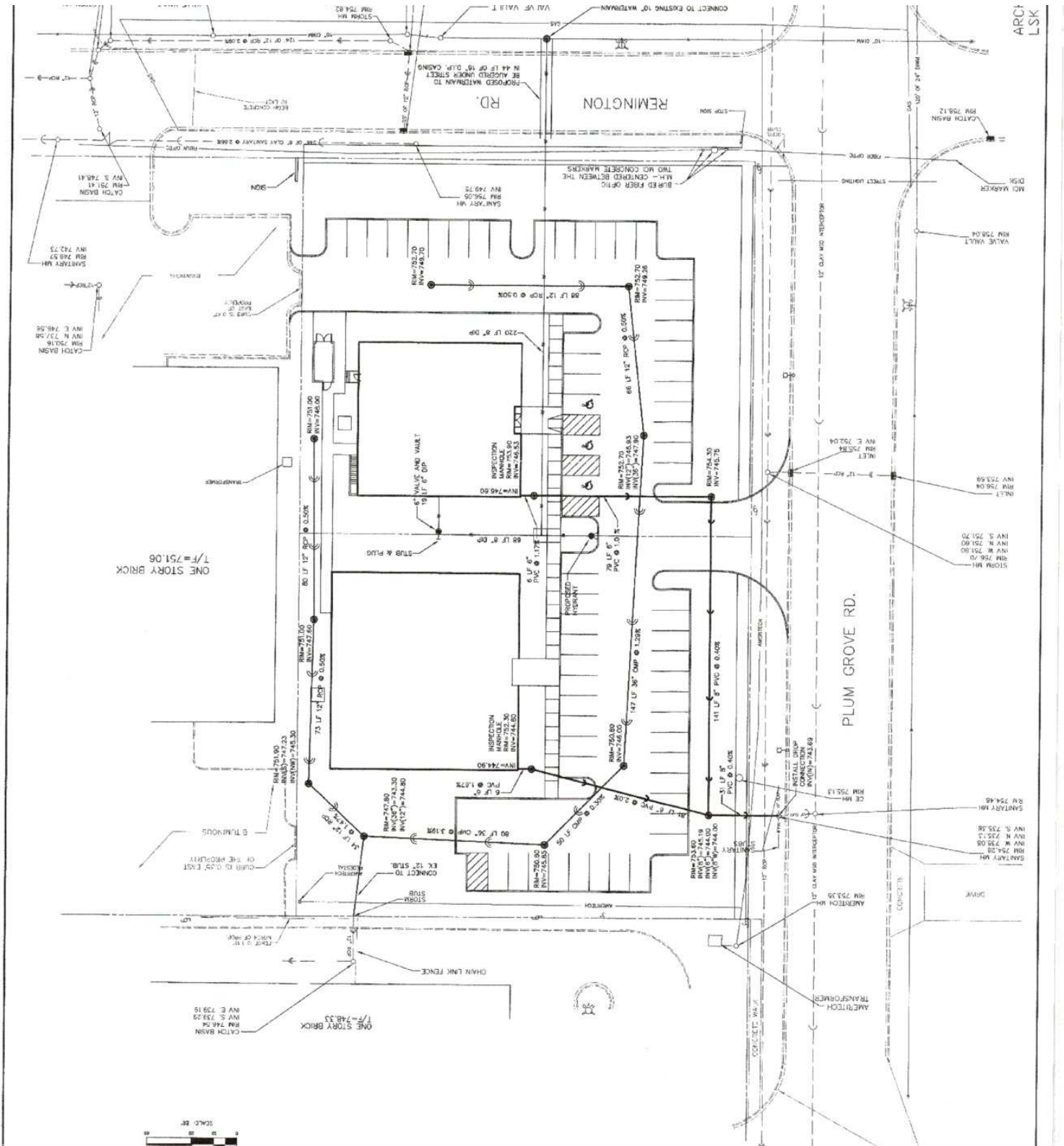

ALBERT M. LINDEMAN **KAREN KULCZYCKI, CCIM**
O: 312.756.7352 O: 630.330.3352
lindemana@svn.com kkulczycki@svn.com
IL #471020279

AERIAL VIEW



ALBERT M. LINDEMAN **KAREN KULCZYCKI, CCIM**
O: 312.756.7352 O: 630.330.3352
lindemana@svn.com kkulczycki@svn.com
IL #471020279

AREA LOCATION MAP



ALBERT M. LINDEMAN **KAREN KULCZYCKI, CCIM**
O: 312.756.7352 O: 630.330.3352
lindemana@svn.com kkulczycki@svn.com
IL #471020279

NEARBY HOSPITALS



ALBERT M. LINDEMAN

O: 312.756.7352

lindemana@svn.com

KAREN KULCZYCKI, CCIM

O: 630.330.3352

kkulczycki@svn.com

IL #471020279

HORIZON MEDICAL CENTER



ALBERT M. LINDEMAN

O: 312.756.7352

lindemana@svn.com

KAREN KULCZYCKI, CCIM

O: 630.330.3352

kkulczycki@svn.com

IL #471020279

LOCATION MAP

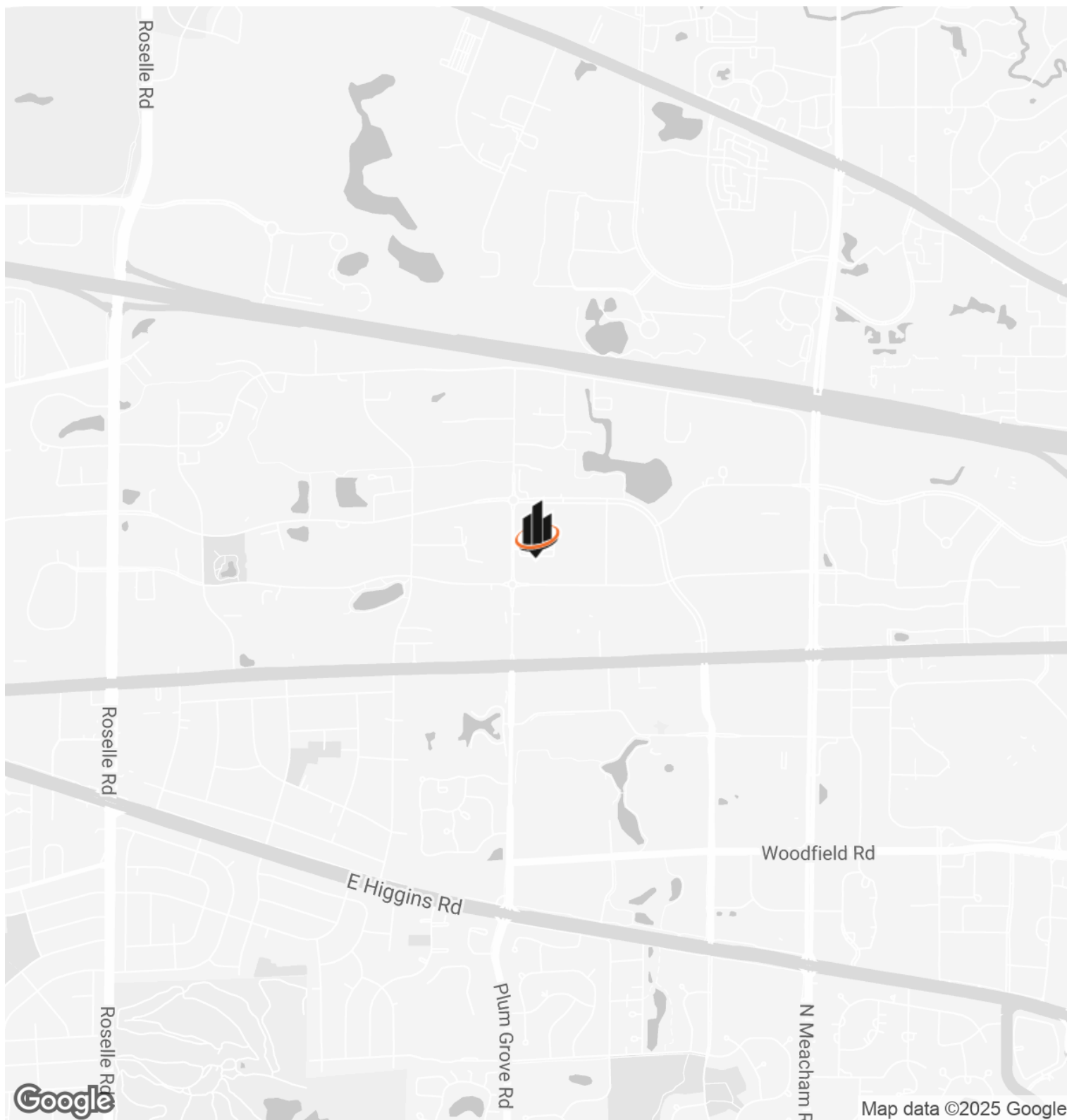

ALBERT M. LINDEMAN

O: 312.756.7352

lindemana@svn.com

KAREN KULCZYCKI, CCIM

O: 630.330.3352

kkulczycki@svn.com

IL #471020279

AREA ANALYTICS

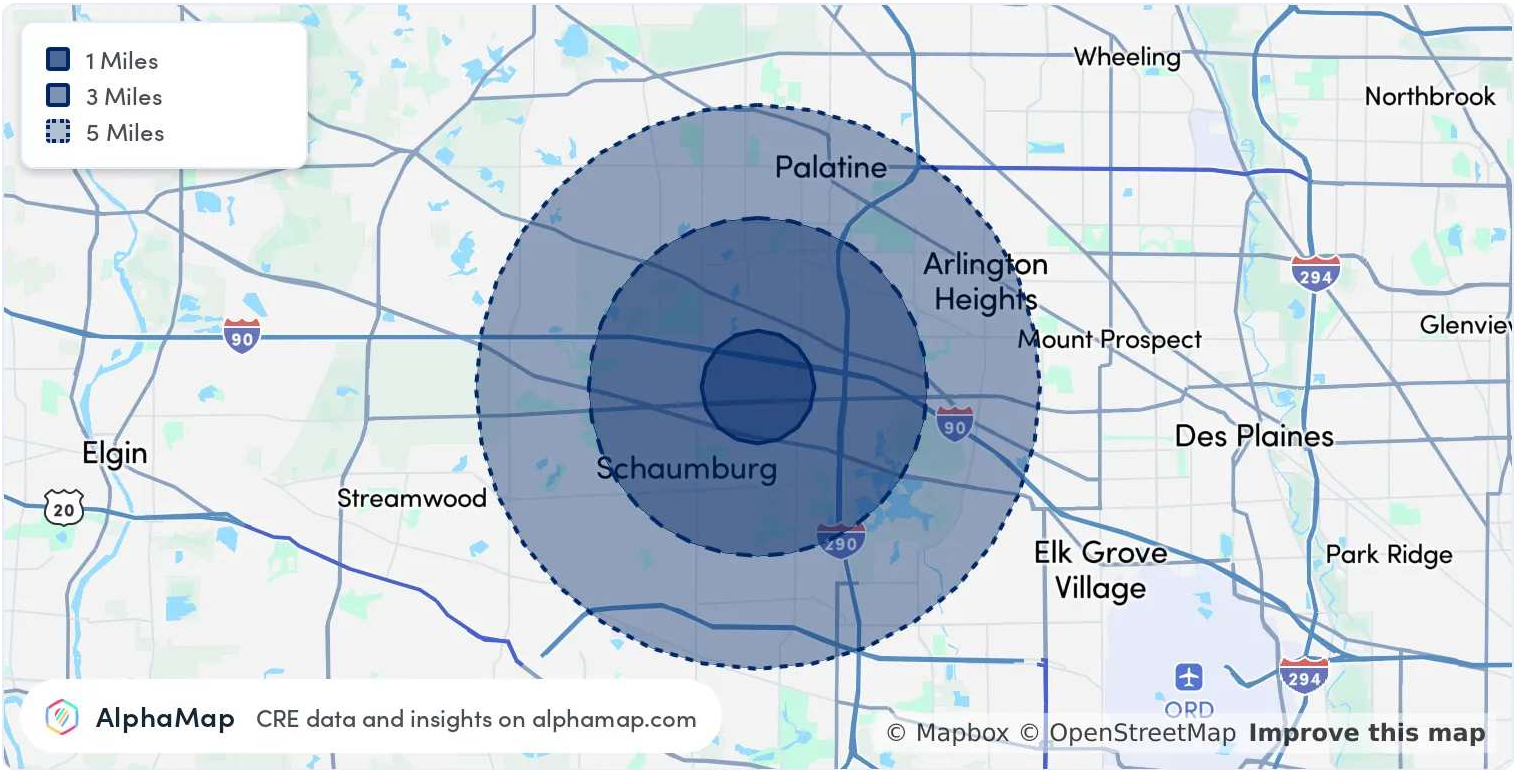

POPULATION	1 MILE	3 MILES	5 MILES
TOTAL POPULATION	2,799	90,238	274,819
AVERAGE AGE	38	41	42
AVERAGE AGE (MALE)	37	40	41
AVERAGE AGE (FEMALE)	40	42	43

HOUSEHOLD & INCOME	1 MILE	3 MILES	5 MILES
TOTAL HOUSEHOLDS	1,236	35,611	108,584
PERSONS PER HH	2.3	2.5	2.5
AVERAGE HH INCOME	\$108,431	\$130,511	\$135,014
AVERAGE HOUSE VALUE	\$326,116	\$368,099	\$391,551
PER CAPITA INCOME	\$47,143	\$52,204	\$54,005

Map and demographics data derived from AlphaMap

ALBERT M. LINDEMAN
O: 312.756.7352
lindemana@svn.com

KAREN KULCZYCKI, CCIM
O: 630.330.3352
kkulczycki@svn.com
IL #471020279

DISCLAIMER

The material contained in this Offering Brochure is furnished solely for the purpose of considering the purchase of the property within and is not to be used for any other purpose. This information should not, under any circumstances, be photocopied or disclosed to any third party without the written consent of the SVN® Advisor or Property Owner, or used for any purpose whatsoever other than to evaluate the possible purchase of the Property.

The only party authorized to represent the Owner in connection with the sale of the Property is the SVN Advisor listed in this proposal, and no other person is authorized by the Owner to provide any information or to make any representations other than contained in this Offering Brochure. If the person receiving these materials does not choose to pursue a purchase of the Property, this Offering Brochure must be returned to the SVN Advisor.

Neither the SVN Advisor nor the Owner make any representation or warranty, express or implied, as to the accuracy or completeness of the information contained herein, and nothing contained herein is or shall be relied upon as a promise or representation as to the future representation of the Property. This Offering Brochure may include certain statements and estimates with respect to the Property. These Assumptions may or may not be proven to be correct, and there can be no assurance that such estimates will be achieved. Further, the SVN Advisor and the Owner disclaim any and all liability for representations or warranties, expressed or implied, contained in or omitted from this Offering Brochure, or any other written or oral communication transmitted or made available to the recipient. The recipient shall be entitled to rely solely on those representations and warranties that may be made to it in any final, fully executed and delivered Real Estate Purchase Agreement between it and Owner.

The information contained herein is subject to change without notice and the recipient of these materials shall not look to Owner or the SVN Advisor nor any of their officers, employees, representatives, independent contractors or affiliates, for the accuracy or completeness thereof. Recipients of this Offering Brochure are advised and encouraged to conduct their own comprehensive review and analysis of the Property.

This Offering Brochure is a solicitation of interest only and is not an offer to sell the Property. The Owner expressly reserves the right, at its sole discretion, to reject any or all expressions of interest to purchase the Property and expressly reserves the right, at its sole discretion, to terminate negotiations with any entity, for any reason, at any time with or without notice. The Owner shall have no legal commitment or obligation to any entity reviewing the Offering Brochure or making an offer to purchase the Property unless and until the Owner executes and delivers a signed Real Estate Purchase Agreement on terms acceptable to Owner, in Owner's sole discretion. By submitting an offer, a prospective purchaser will be deemed to have acknowledged the foregoing and agreed to release the Owner and the SVN Advisor from any liability with respect thereto.

To the extent Owner or any agent of Owner corresponds with any prospective purchaser, any prospective purchaser should not rely on any such correspondence or statements as binding Owner. Only a fully executed Real Estate Purchase Agreement shall bind the property and each prospective purchaser proceeds at its own risk.

ALBERT M. LINDEMAN	KAREN KULCZYCKI, CCIM
O: 312.756.7352	O: 630.330.3352
lindemana@svn.com	kkulczycki@svn.com
	IL #471020279