

440 RUTHERFORD ST

GOLETA, CA 93117

Two-Warehouse Complex Near Santa Barbara Airport



FOR SUBLEASE

±33,395 - ±53,000 SF | \$0.85 PSF GROSS

Austin Herlihy

Executive Vice President
Lic. 01518112
Direct: +1 805 518 1491
Mobile: +1 805 705 1149
austin.herlihy@colliers.com

Miles Waters

Vice President
Lic. 02047288
Direct: +1 805 518 1493
Mobile: +1 805 729 6784
miles.waters@colliers.com

Mike Chung

Associate
Lic. 02156327
Direct: +1 805 518 3254
Mobile: +1 805 453 3953
mike.chung@colliers.com

Chris Parker

Vice President
Lic. 01887788
Direct: +1 805 518 1492
Mobile: +1 805 403 4735
chris.parker@colliers.com

Colliers

Opportunity to sublease flexible industrial space in a two-warehouse facility in the heart of Goleta, CA.
Centrally located, 440 Rutherford St offers two roll-up doors, a private entrance, and abundant parking.



Leasing Availability

±33,395 SF | \$0.85 PSF GROSS

Sublease Space - Warehouse

±53,000 SF

Sublease Space - Entire Building | CONTACT LISTING AGENTS

Property Details

50+ On-site Spaces in a Gated Parking Lot
Parking

Yes

HVAC

BP

Zoning

14'-17.5'

Clear Heights

Yes

Restrooms

3-Phase, 1,000 amps

Power

Site Plan WAREHOUSE

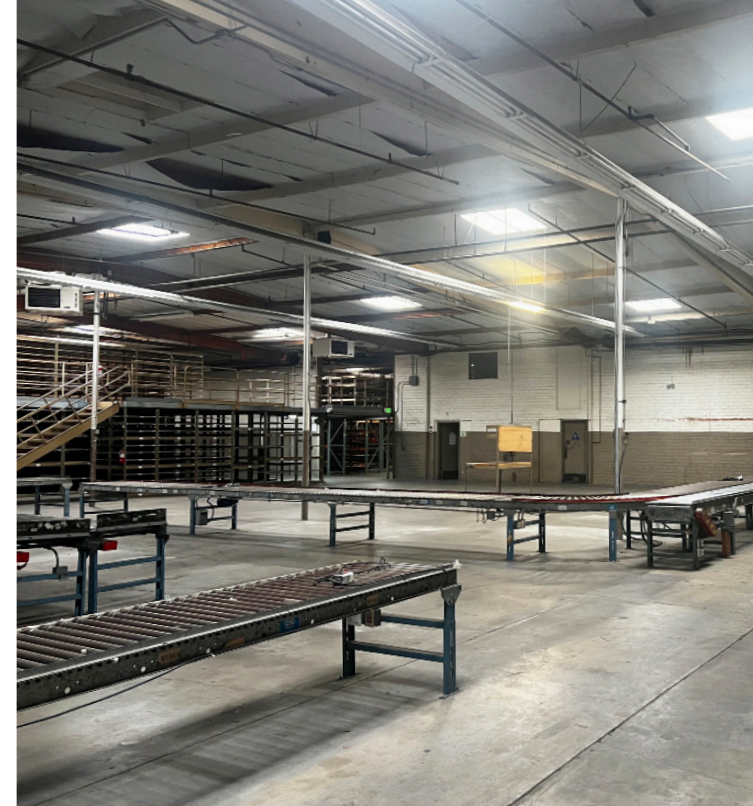
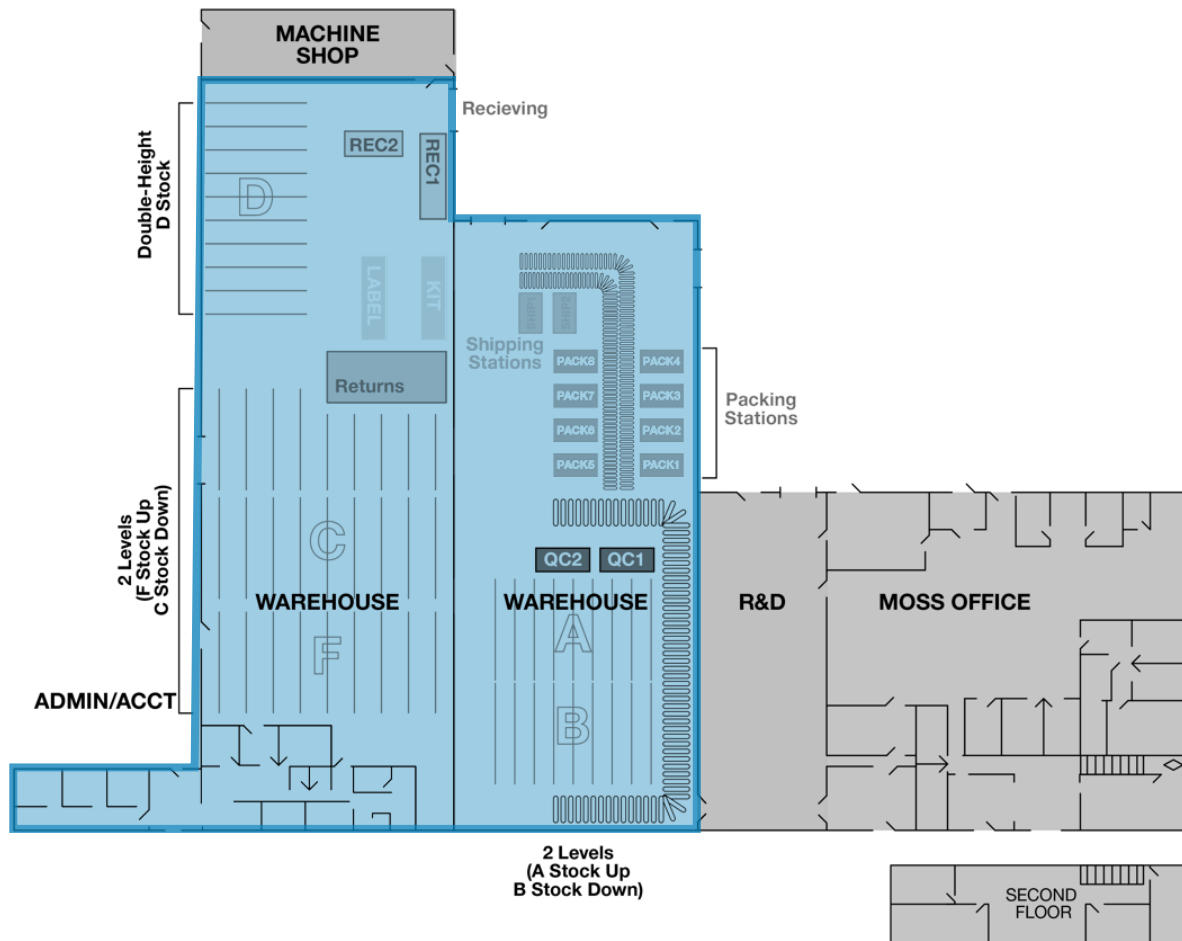

Site Plan ENTIRE BUILDING

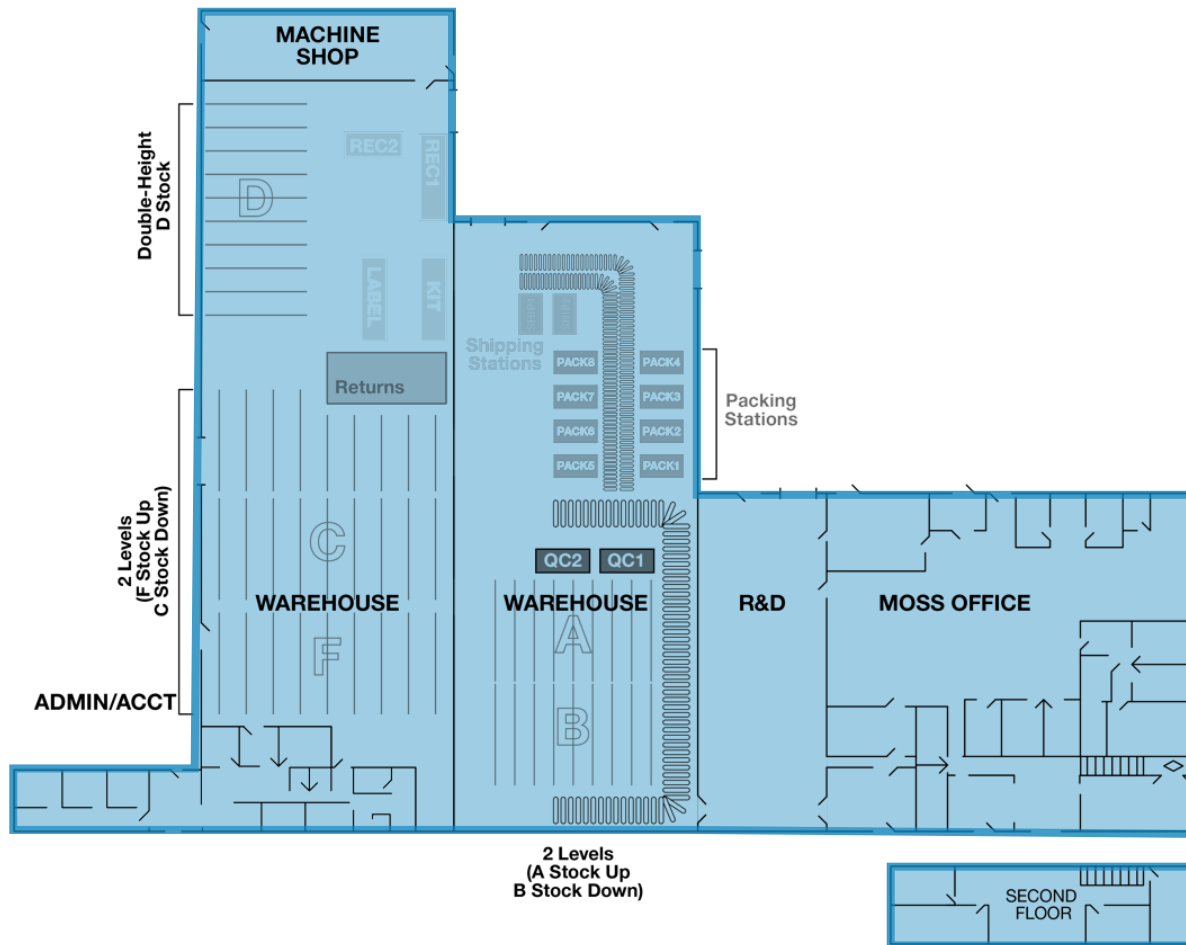



Goleta Tech Corridor



Goleta

The Good Land

The city of Goleta rests a few minutes north of Santa Barbara in the South Coast region of Santa Barbara County, roughly 330 miles south of San Francisco and 90 miles north of Los Angeles.

Goleta and the Gaviota Coast to the north make up 12 picturesque miles of the Santa Barbara coastline. In fact the area is known as The Good Land for its sprawling ranches, fertile farms, lemon orchards and sustainable gardens that supply local restaurants and farmers markets year round. From the Goleta pier to Point Arguello, the area is a recreational paradise. Whether fishing off the pier, hiking the bluffs, surfing Campus Point or getting up close and personal with wildlife while kayaking in the Goleta Slough, there is something for everyone.

The South Coast region's central location, year-round mild climate, proximity to the University of California, Santa Barbara (UCSB), high quality of living, bustling technology industry and wealth of outdoor amenities are but a few of the reasons Goleta and Santa Barbara are regularly selected among the best places to live and work by numerous sources including livability.com, Money Magazine and Sunset Magazine.



The More Mesa Loop Trail

More Mesa offers more: defacto nature preserve, network of walkinghiking, access to Santa Barbara's most isolated beach, and breathtaking views of the Pacific Ocean and the Channel Islands. A mile-long walk up a residential street, across the bluffs, and down the cliffs on a combo stairspathway leads to a clean, mellow and sandy beach. More Mesa is a great walk without going down to the beach. The property is honeycombed with trails.

440 RUTHERFORD ST

GOLETA, CA 93117



Austin Herlihy

Executive Vice President
Lic. 01518112
Direct: +1 805 518 1491
Mobile: +1 805 705 1149
austin.herlihy@colliers.com

Miles Waters

Vice President
Lic. 02047288
Direct: +1 805 518 1493
Mobile: +1 805 729 6784
miles.waters@colliers.com

Mike Chung

Associate
Lic. 02156327
Direct: +1 805 518 3254
Mobile: +1 805 453 3953
mike.chung@colliers.com

Chris Parker

Vice President
Lic. 01887788
Direct: +1 805 518 1492
Mobile: +1 805 403 4735
chris.parker@colliers.com

Colliers