

# SHELDON PLACE

15185 N. Sheldon Road / Plymouth, MI



MID-AMERICA<sup>®</sup>  
Real Estate-Michigan, Inc.

FOR LEASE



RETAIL OPPORTUNITY

# SHELDON PLACE



## Address

15185 N. Sheldon Road  
Plymouth, MI 48170

## Availability

1,708 SF

## Features

Last retail space available for lease in a Busch's anchored center on the corner of 5 Mile and Sheldon Roads. The site features multiple points of ingress/egress and signage on both main roads. Sheldon Place is located 1/2 mile north of the M-14 Expressway, the main artery between Metro Detroit and Ann Arbor. 5 Mile and Sheldon Roads boasts a strong daytime population and strong residential area.

## Area Tenants

## Demographics (2025)



	1 MILES	3 MILES	5 MILES
POPULATION	3,030	60,304	162,370
HOUSEHOLDS	1,151	25,680	65,698
AVG HOUSEHOLD INCOME	\$271,459	\$173,492	\$160,015
DAYTIME POPULATION	9,701	81,132	197,493

# SHELDON PLACE

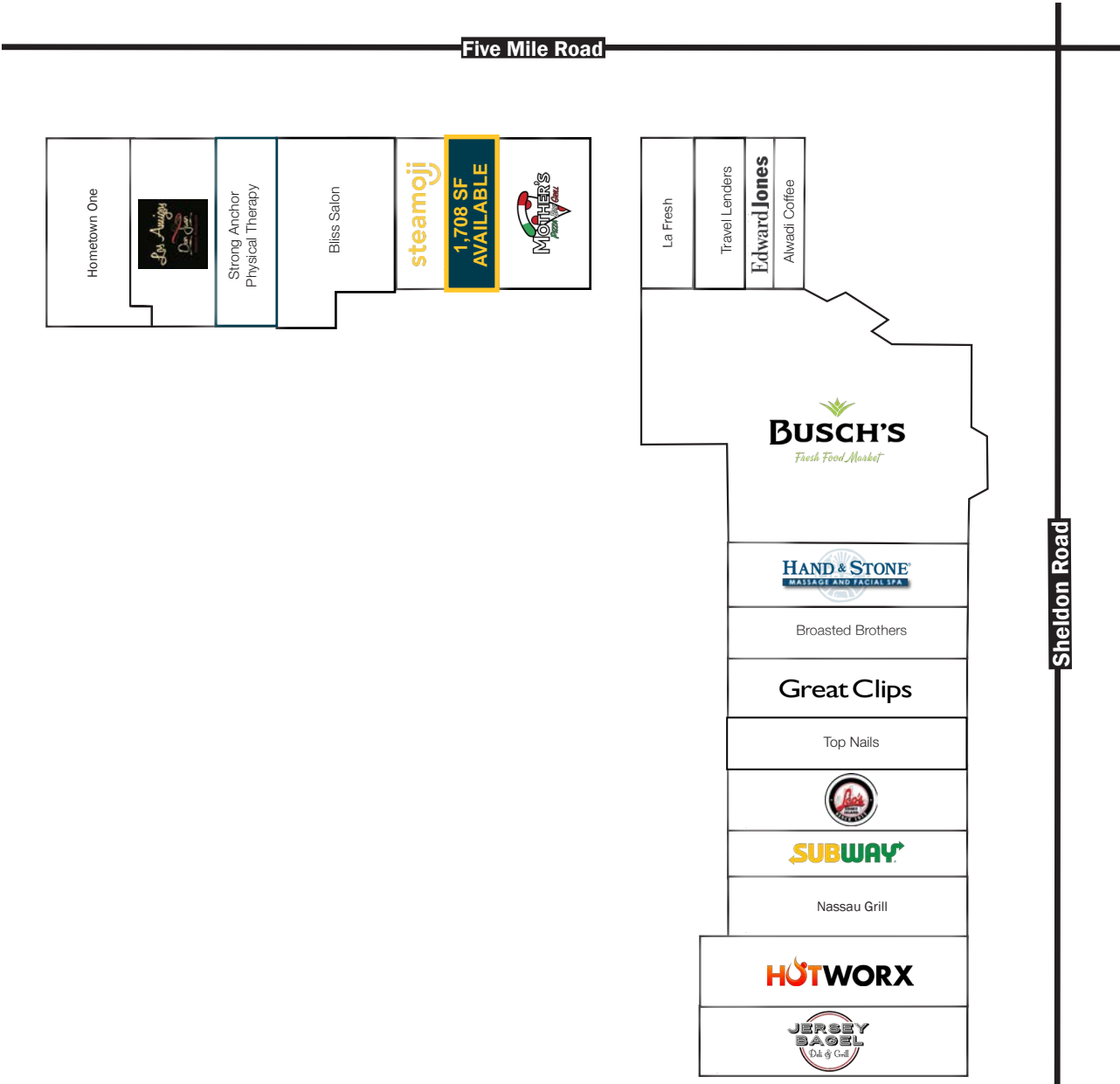

# SHELDON PLACE



# SHELDON PLACE

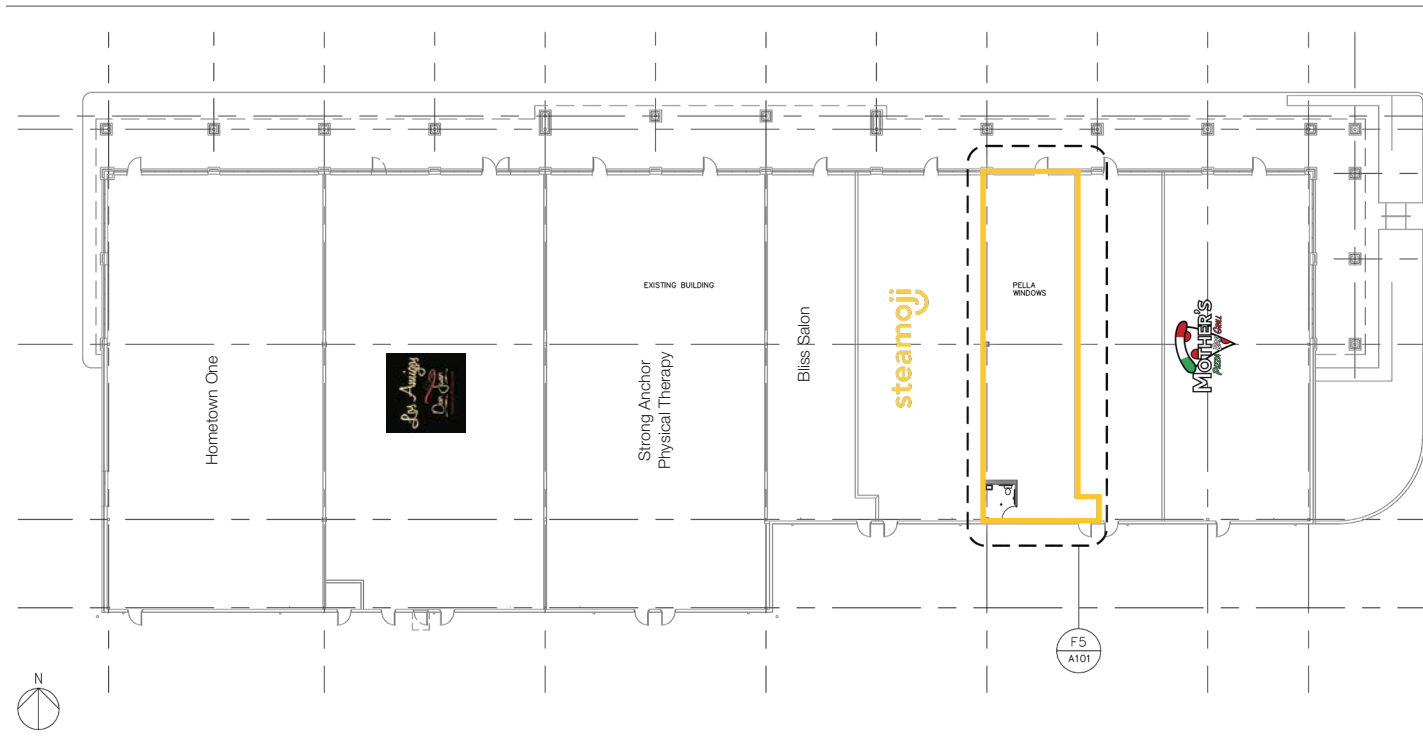

D7 ENTIRE FLOOR PLAN

1/16"=1'-0" A101

WALL TYPES	
1	5/8" GYPSUM BOARD EACH SIDE OF 3 5/8" METAL STUD @ 16" O.C. WITH 5/8" GYPSUM BOARD AND BATT. INSUL.
2	5/8" GYPSUM BOARD ON ONE SIDE OF 6" METAL STUD @ 16" O.C. WITH 5/8" MOISTURE RESISTANT GYPSUM BOARD TOILET ROOM SIDE, AND ACOUSTIC BATT INSULATION.
3	5/8" GYPSUM BOARD ONE SIDE OF 3 5/8" METAL STUD @ 16" O.C. WITH 5/8" MOISTURE RESISTANT GYPSUM BOARD TOILET ROOM SIDE, AND ACOUSTIC BATT INSULATION.

**FLOOR PLAN LEGEND**

- ELECTRICAL OUTLET (DUPLEX)
- ELECTRICAL OUTLET (GF1)
- ELECTRICAL OUTLET (DEDICATED)
- TELEPHONE & DATA (3/4" CONDUIT)
- FLOOR MOUNTED RECEPTACLE W/ ELECTRICAL, PHONE AND DATA
- EXISTING PARTITION WALL
- NEW PARTITION WALL

**FLOOR PLAN LEGEND**

- 2' x 4' CEILING GRID
- FLOURESCENT LIGHT FIXTURE
- EXIT LIGHT
- EMERGENCY LIGHT

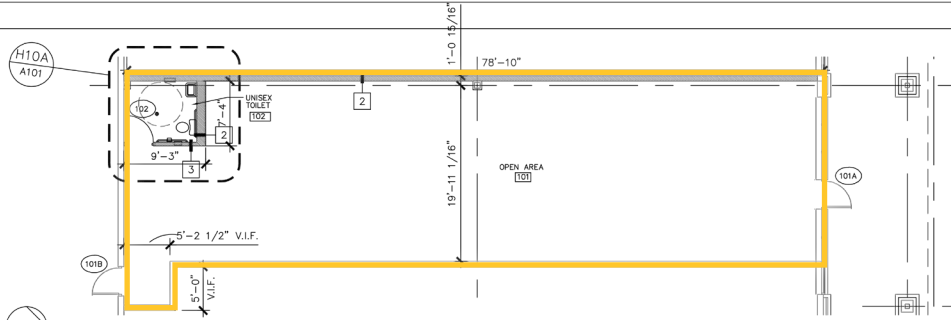

F5 ENLARGED FLOOR PLAN

1/8"=1'-0" A101

# SHELDON PLACE



# SHELDON PLACE



SITE PLAN

# SHELDON PLACE



AERIAL

# SHELDON PLACE



Brooke  
Wolf

Mid-America Real Estate -  
Michigan, Inc.

T: 248.855.6800

**BWolf@MidAmericaGrp.com**

George  
Sheena

Mid-America Real Estate -  
Michigan, Inc.

T: 248.855.6800

**GSheena@MidAmericaGrp.com**



38500 Woodward Ave, Suite 100  
Bloomfield Hills, Michigan 48304  
248.855.6800

**MidAmericaGrp.com**

CONTACT